

# > Instructions

Thule FastRide Ø9-15mm Axle  
Adapter Kit  
564100

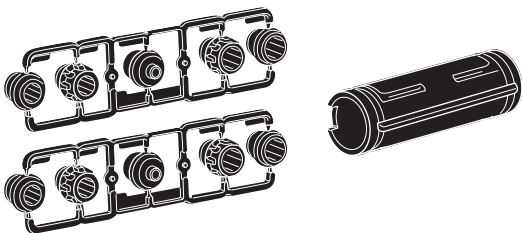

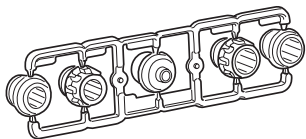
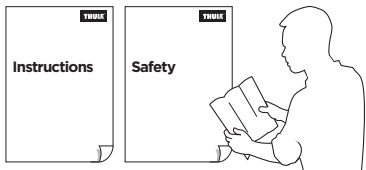

x2

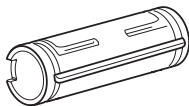

x1

**i** For Thule FastRide  
564001, 564005

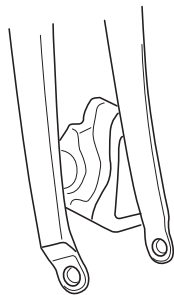

Bikes with  $\varnothing 9 - 15$  mm Axles

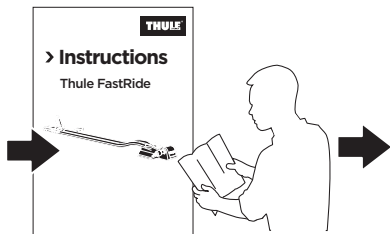
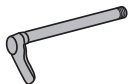

# 1

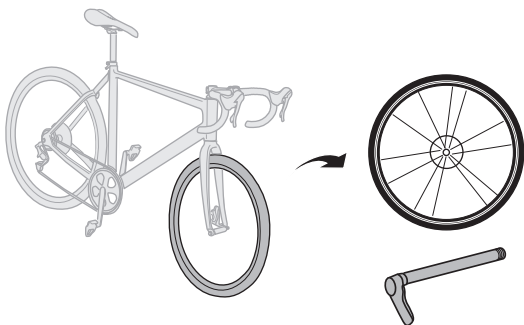

# 2

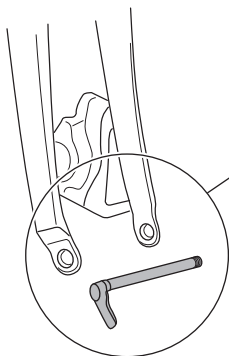

- ➔ ① Ø12 x 100mm Thru-Axle
- ➔ ② Ø12 x 110mm Thru-Axle
- ➔ ③ 9mm captive
- ➔ ④ Ø15 x 110mm Thru-Axle
- ➔ ⑤ Ø15 x 100mm Thru-Axle

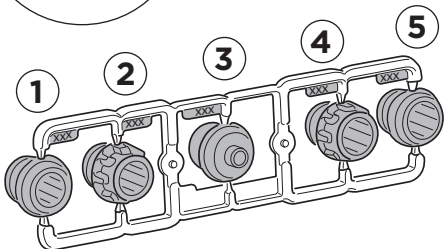

**3**

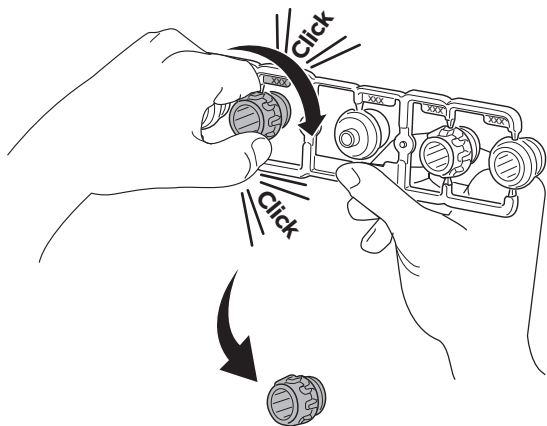

**4**

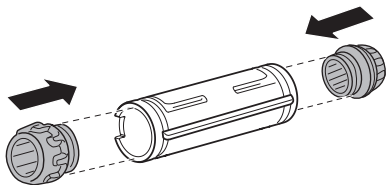

**5**

**A**

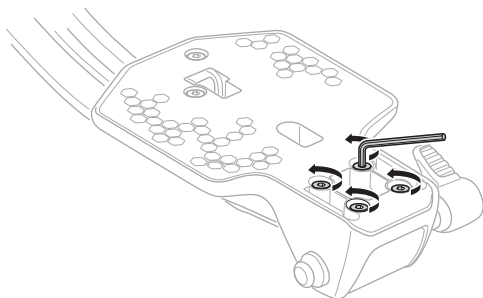

**B**

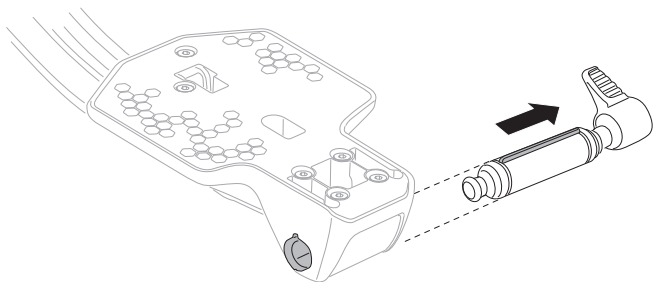

**C**

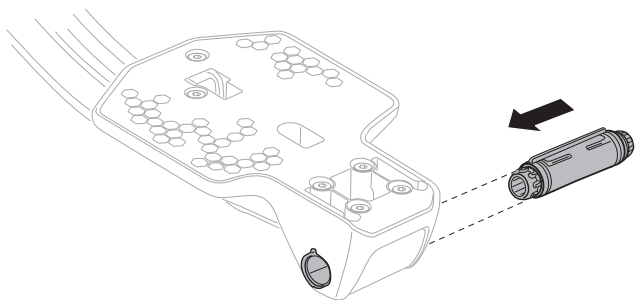

**D**

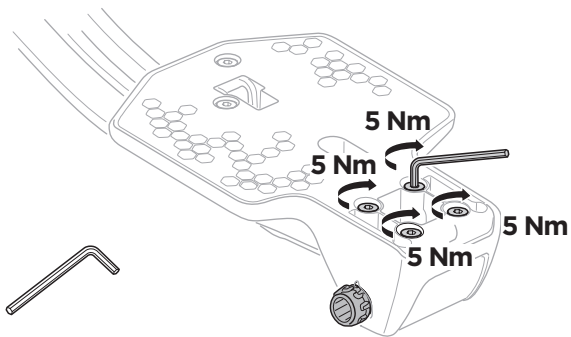

**6**

**A**

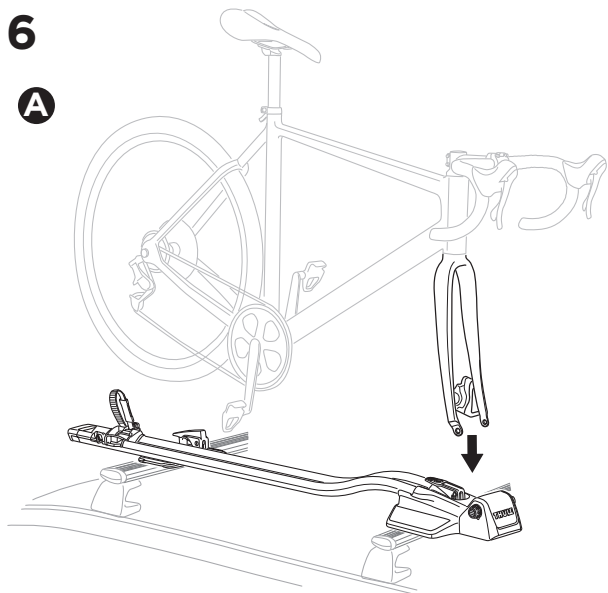

**B**

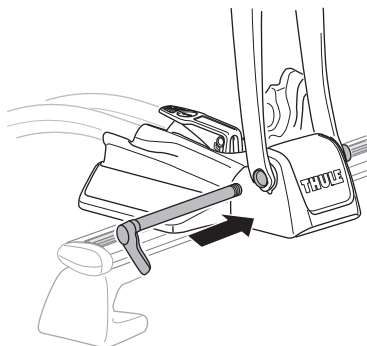

C

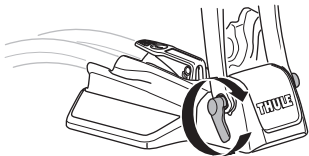

Follow bike manufacturer's recommendation for tightening torque!

Learn more about roof racks on our website.