

**PARTS INCLUDED**

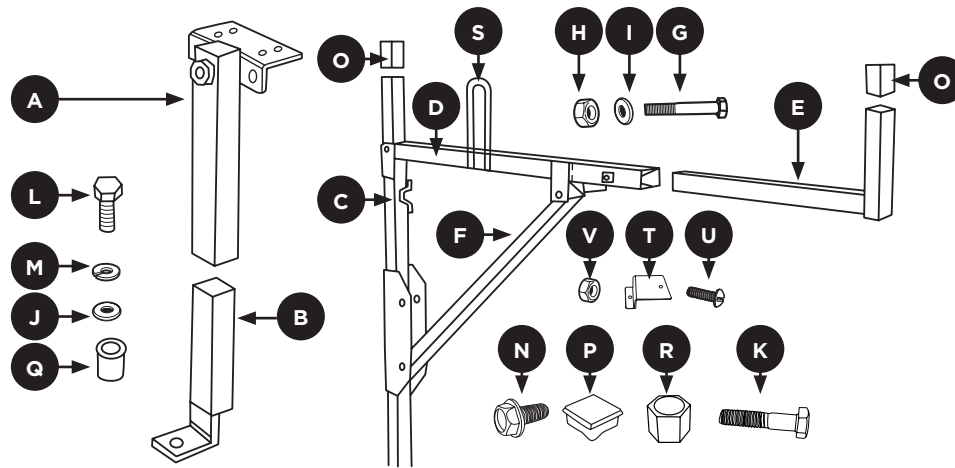

part	description	qty.
A	side mount tube	2
B	bottom mount tube	2
C	leg post	2
D	tilt arm	2
E	extension arm	2
F	angle brace	2
S	ladder bracket assembly	1
T	ladder bracket	1
<b>MOUNTING HARDWARE PARTS BAG</b>		<b>1</b>
G	3/8"-16 x 2-1/2 hex cap screw	6
H	3/8"-16 nylon insert nut	6
I	3/8" flat washer	12
J	5/16" flat washer	10
K	5/16"-18 x 1-3/4 tap bolt	1
L	5/16"-18 x 1-1/2 fully threaded bolt	10
M	5/16" split lock washer	10
N	3/8"-16 x 3/4 self tap screw	4
O	1-1/2" square vinyl cap	4
P	1-1/2" square cap plug	6
Q	5/16"-18 insert nut	10
R	insert tool	1
<b>LADDER BRACKET PARTS BAG</b>		<b>1</b>
U	1/4"-20 x 5/8 screw	2
V	1/4"-20 nylon insert nut	2

## TOOLS THAT YOU WILL NEED

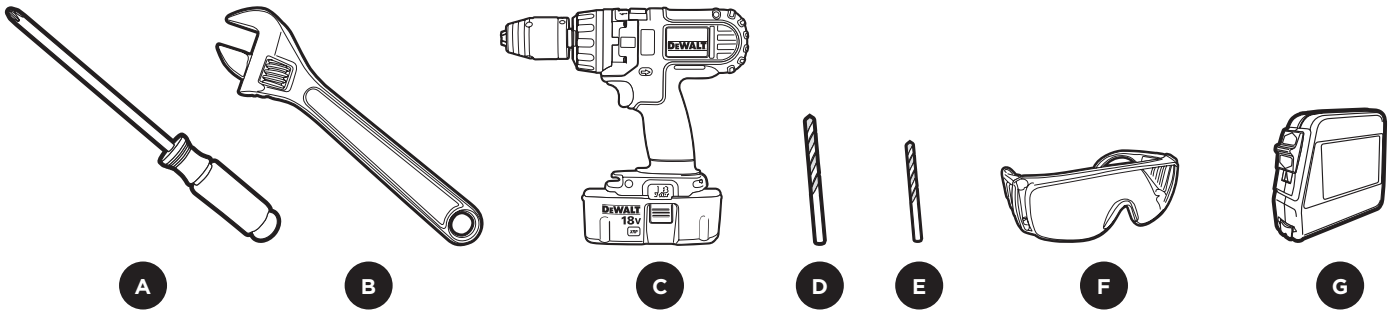

part	description
A	screwdriver
B	adjustable wrench
C	drill
D	17/32" drill bit
E	5/16" drill bit
F	safety glasses
G	tape measure



Before drilling into the truck bed or sidewalls check for the location of fuel lines, brake lines and electrical wires.

## WARNINGS / LIMITATIONS

- Install parts as shown on illustrations.
- Carrying high loads over rough roads with excess speed may damage the system. Good judgment must be exercised at all times.

# 1

## ASSEMBLING THE SIDE MOUNT TUBES

1. Place bottom mount tubes (B) in side mount tubes (A).
2. Place assemblies as close to the front and back of the truck without interfering with the tailgate.
3. Using the upper plate of the side mount tube (A) as a template, mark the positions of two of the mounting holes, using whichever set fits your vehicle best.
4. Mark the two horizontal mounting holes and the holes for the bottom mount tubes.

NOTE: Thule Tracrac recommends racks to be a minimum of 60" apart.

5. Lay assembly aside. Drill  $17/32$ " diameter hole at all marked positions.

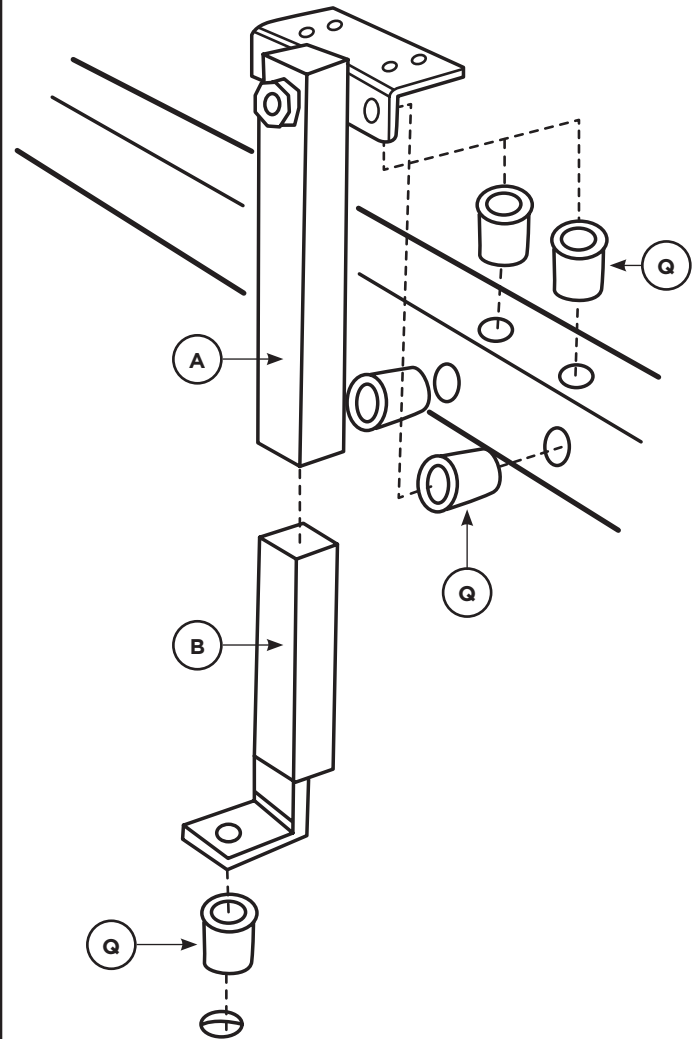

# 2

## INSTALLING INSERT NUTS

1. Hold insert tool (R), scored side down, with wrench to prevent any turning.
2. Turn  $1-3/4$ " tap bolt (K) clockwise until bottom of insert flares out completely.
3. Turn tap bolt counter clockwise and remove.
4. Repeat for all locations.

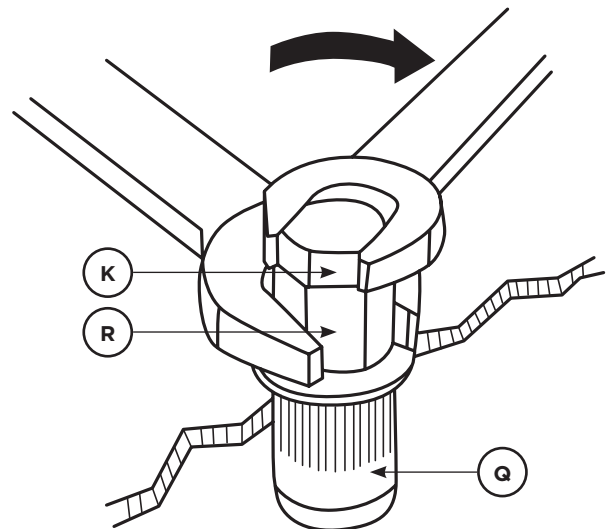

# 3

## ASSEMBLING THE SIDE MOUNT TUBES

1. Install both side tube assemblies (A) and (B) by using 1-1/2" bolt (L), lock washer (M), 5/16" washer (J) and attaching housing to insert nut (Q).
2. Repeat for all locations.

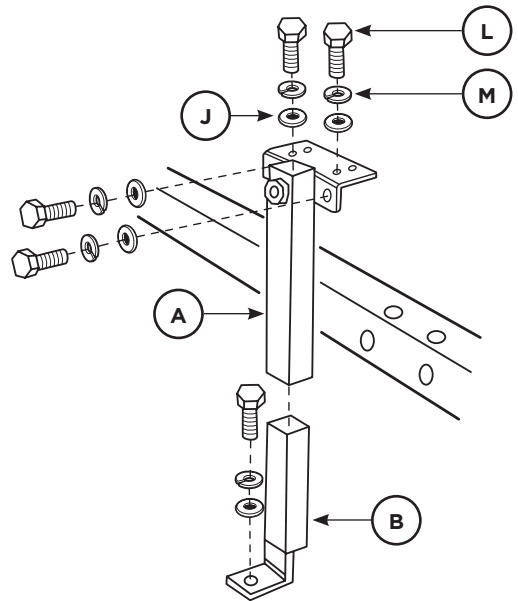

# 4

## ASSEMBLING UPPER RACKS

1. Install leg post (C) through side mount tube (A) and bottom mount tube (B). Let (C) bottom out to track bed. You will adjust for height at a later time.

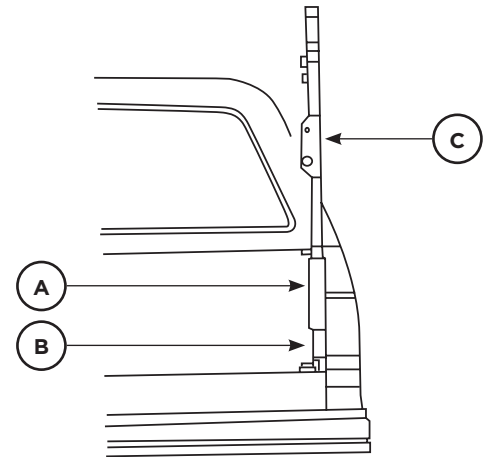

# 5

## ASSEMBLING UPPER RACKS

1. Install end plugs (P) into bottom of extension arm (E) and top and bottom of angle brace (F). Set aside for the time being.

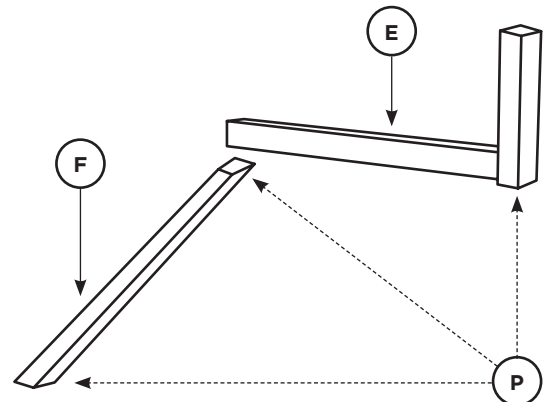

# 6

## ASSEMBLING UPPER RACKS

1. Assemble the tilt arm assembly (D) to the leg post assembly (C) using 3/8-16 x 2-1/2" hex cap screw (G), 3/8 flat washer (I) x 2, 3/8-16 nylon lock nut (H).

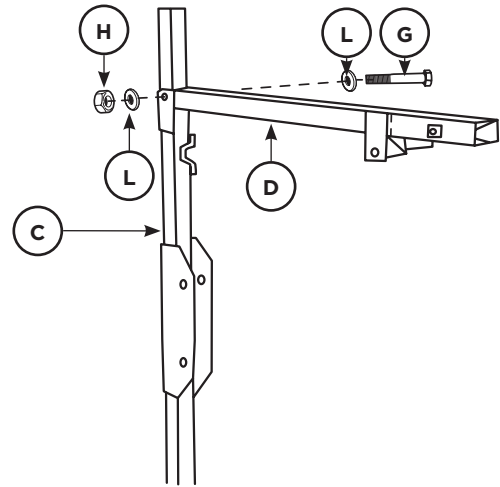

# 7

## ASSEMBLING UPPER RACKS

1. Assemble angle brace (F) to tilt arm assembly (D) using 3/8-16 x 2-1/2" hex cap screw (G), 3/8 flat washer (I) x 2, 3/8-16 nylon lock nut (H).

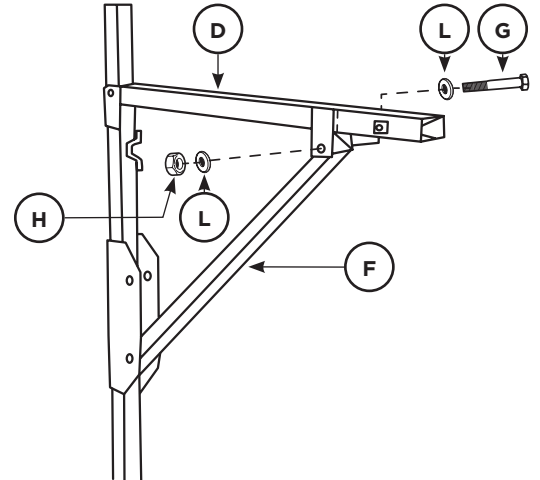

# 8

## ASSEMBLING UPPER RACKS

1. Assemble angle brace (F) to leg post assembly (C) in the lower position using 3/8-16 x 2-1/2" hex cap screw (G), 3/8 flat washer (I) x 2, 3/8-16 nylon lock nut (H).

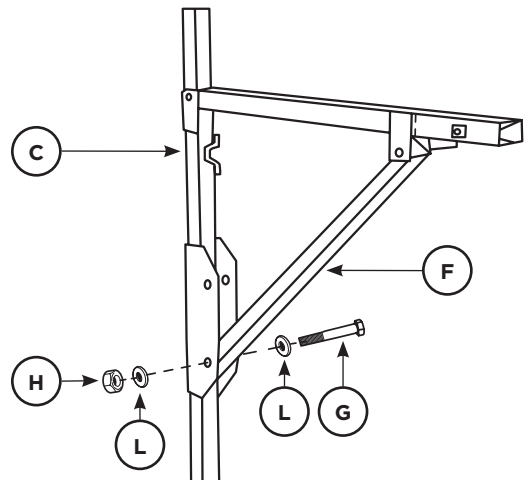

# 9

## ASSEMBLING UPPER RACKS

1. Insert extension arm (E) into tilt arm (D) and set to desired extended length (maximum 37").
2. Mark position on extension arm (E), then remove and set aside.
3. Drill 5/16" hole through one wall of the extension arm (E) as marked.
4. Place extension arm (E) back into tilt arm (D) lining up drilled hole with the welded nut.
5. Install 3/8-16 x 3/4" self tap screw (N) and tighten securely.

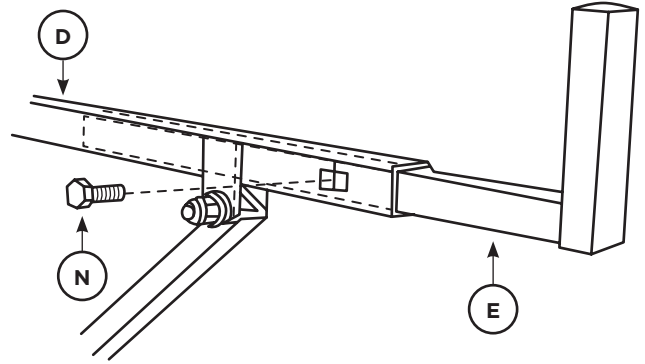

# 10

## RACK INSTALLATION

1. Measure the height of the extension arms. They should be a minimum of 2" above the height of the cab roof when in the horizontal position.
2. Install vinyl caps (O) onto top of leg post (C) and top of extension arm (E).

**NOTE:** If you desire to shorten the rack, cut tubing from bottom of the leg posts while in the horizontal position.

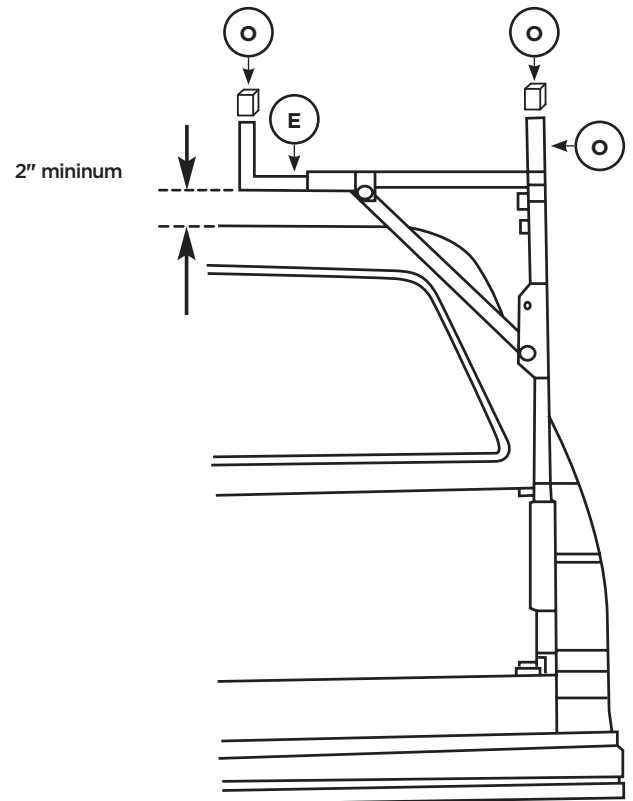

# 11

## RACK INSTALLATION

1. With the rack assembly at the desired height, mark position of rack assembly through welded nut on side mount tube (A).
2. Remove rack and drill 5/16" hole through one wall.
3. Insert the rack assemblies back into the side mount tubes (A), lining up drilled hole with the welded nut.
4. Install 3/8-16 x 3/4" self tap screw (N) and tighten securely.
5. Securely tighten all hardware.

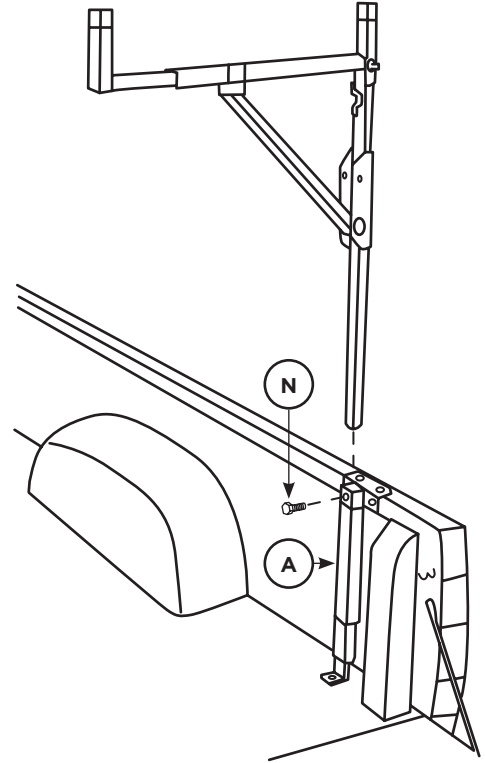

# 12

## RACK INSTALLATION

1. If you want the racks set at 15 degrees up from the horizontal position, reset the angle brace (F) to the top mounting hole and re-tighten all hardware.

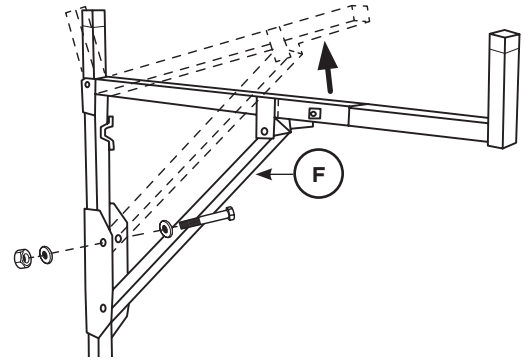

# 13

## RACK INSTALLATION

1. Mount the ladder bracket assembly (S) on the tilt arm (D) in the desired position using 1/4-20 x 5/8" screw (U), ladder bracket (T) and 1/4-20 nylon lock nut (V), tighten securely.

