

PARTS INCLUDED

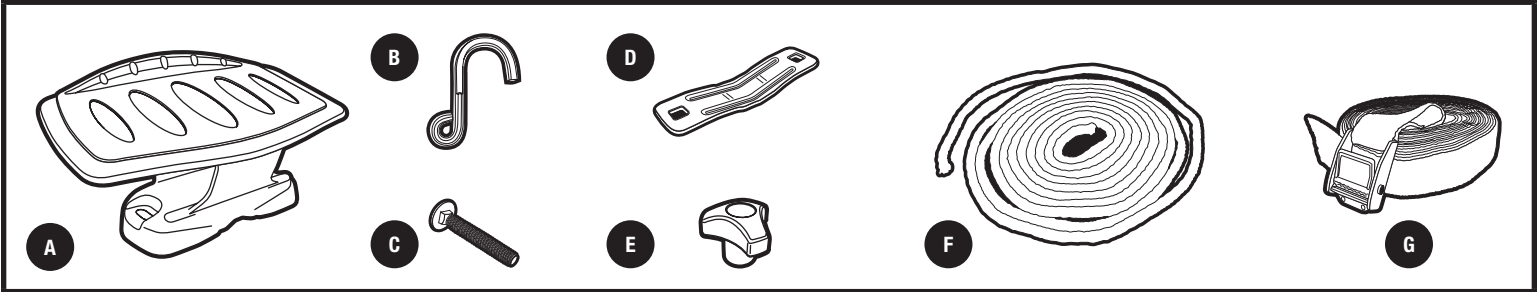

part	description	part number	qty.
A	saddle /	753-3565	4
B	hook /	853-5465	2
C	carriage bolt M6 x 50mm /	915-0650-31	8
D	metal bracket /	853-5513	4
E	3 wing knob /	753-0745	8
F	1/4" rope /	853-5466	2
G	strap /	753-2030-04	2

WARNINGS / LIMITATIONS

- Load bars must be at least 24" (610mm) apart for safe use.
- Ensure that boat does not contact vehicle while loading or unloading; otherwise, damage to vehicle or boat could occur.
- For extra vehicle protection, place the Thule Water Slide mat (#854, sold separately) or a towel on the edge of the vehicle's roof during loading/unloading.
- Ensure bottom of hull is clean before loading to avoid damaging boat surface.
- Always tie down bow and stern of boat to vehicle bumpers or tow hooks.
- Do not exceed weight limitation of racks or factory installed bars.
- Ensure load carrier is properly installed and tight to vehicle.
- Failure to follow above guidelines voids warranty.

NOTE: After kayak use in salt water conditions, please rinse off kayak carrier with fresh water to keep salt residue off the rack.

1

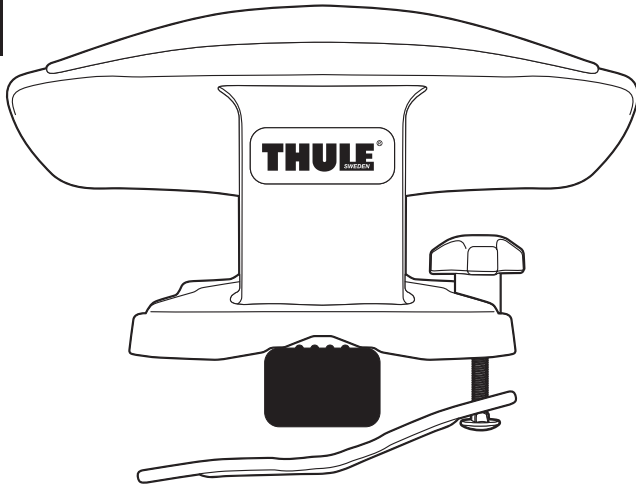

- Insert carriage bolt through bracket and assembly base into wing knob. Tighten loosely.
- Place assembly onto bar as shown.

2

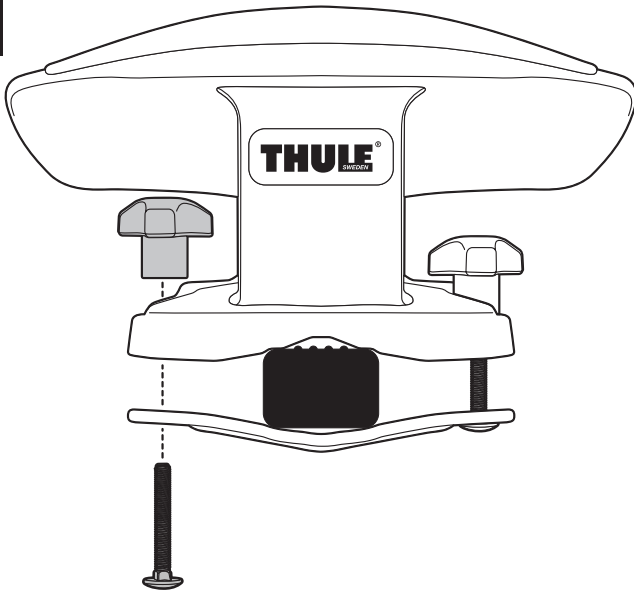

- Loosely attach other carriage bolt and knob as shown.
- Repeat above steps for all 4 saddle assemblies.

NOTE: Load bars must be at least 24" (610mm) apart for safe use.

3



- Position saddles for the approximate width of your boat.

4

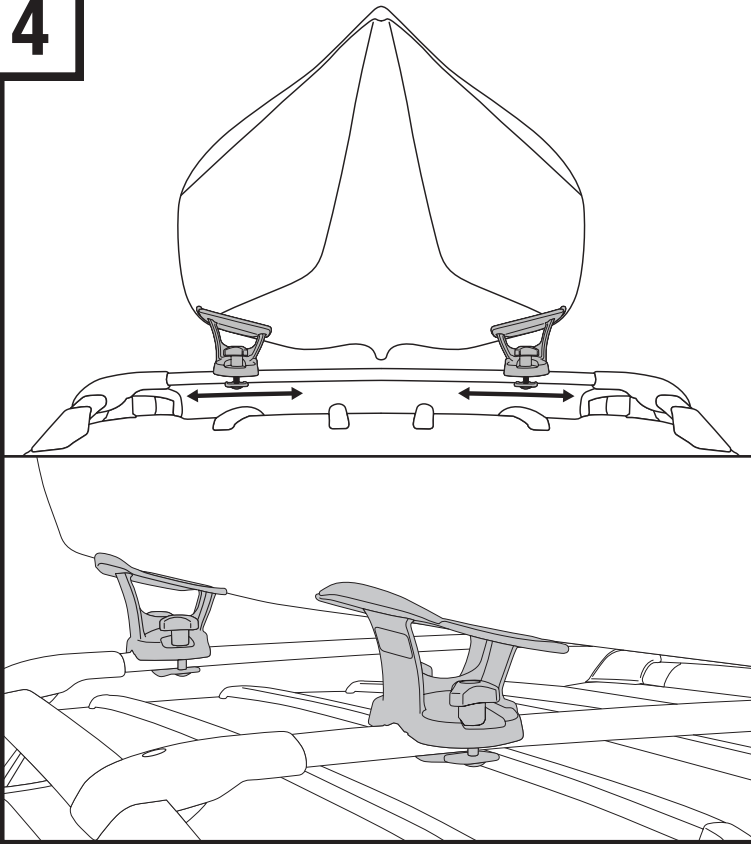

- Load boat onto saddles. It may be necessary to readjust the distance between your saddles for a snug fit. Make sure boat is in line with vehicle.
- Ensure that there is clearance between load bars & hull.
- Position saddles so top edge contacts side of boat.
- Securely tighten knobs. Ensure space between bracket and saddle is equal on both sides of each assembly as you tighten the knobs.

5

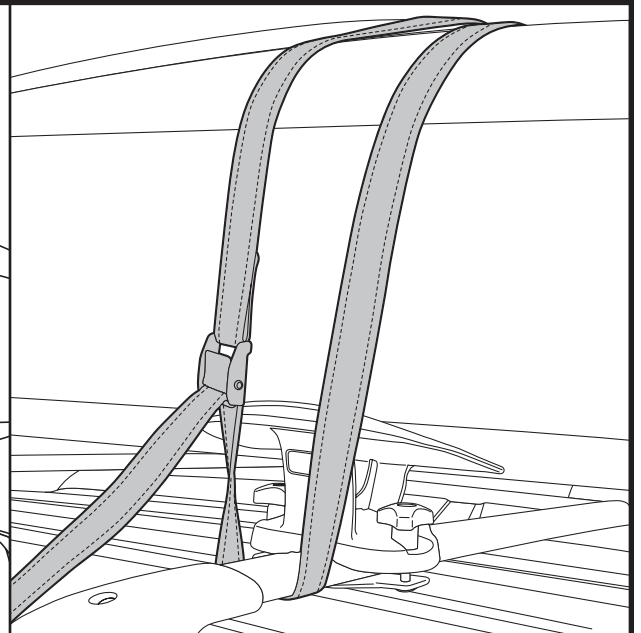
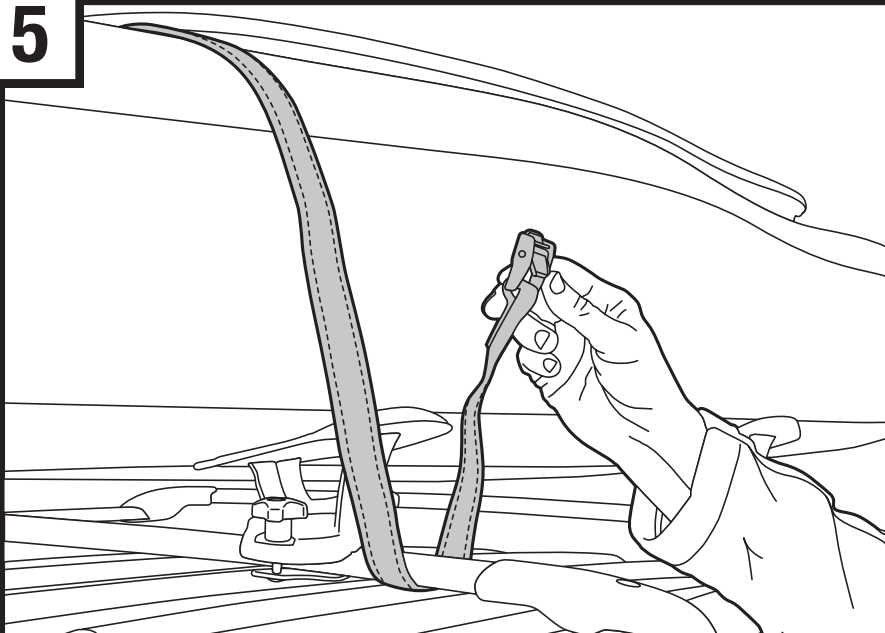

- Always route straps under the bar as shown.

NOTE: Never route straps through saddle.

- Ensure straps do not go over cockpit cowling or other non-load bearing boat details before cinching straps.

6

BOW / STERN TIE DOWN

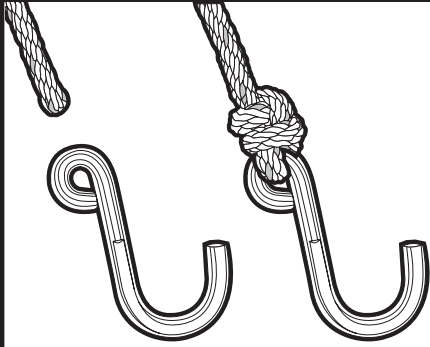

- Carefully and securely attach hook to end of rope.

7

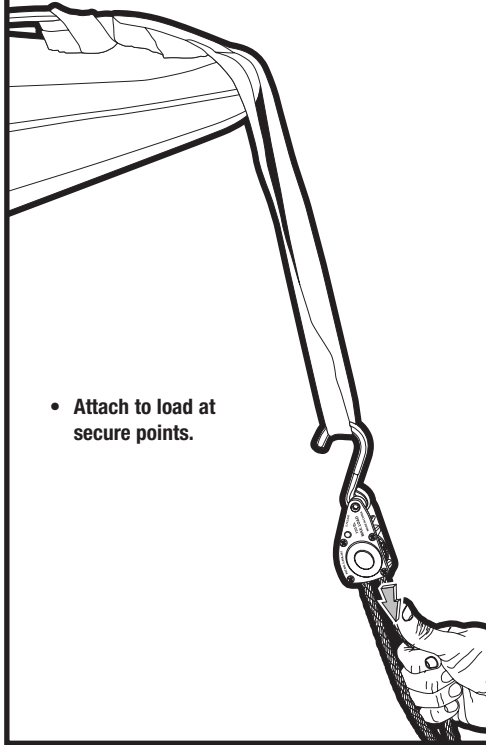

- Attach to load at secure points.

8

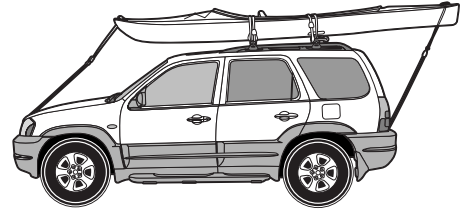

- Secure end of rope to front and rear of vehicle and tie tightly.

NOTE: For easier tie down to vehicle, the QuickDraw ratcheting tie down is available at your local Thule dealer or online at thule.com