

PARTS INCLUDED

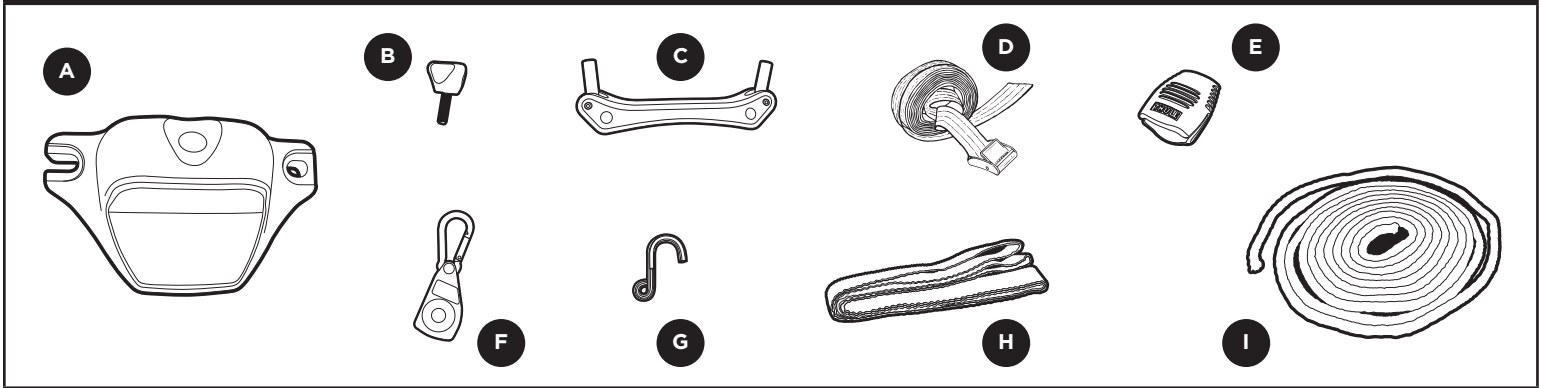

part	description	part number	qty.
A	base with pad /	7521604001	4
B	3-wing knob with bolt /	7521606001	8
C	Flip-Fit bracket /	7521605001	4
D	strap /	753203002	2
E	buckle bumper /	8535593	2
F	ratchet with carabineer hook /	8522883001	2
G	hook /	8535465	2
H	attachment strap /	8535467	2
I	1/4" rope /	8535466	2

WARNINGS / LIMITATIONS

- Load bars must be at least 24" (610mm) apart for safe use.
- Ensure that boat does not contact vehicle while loading or unloading; otherwise, damage to vehicle or boat could occur.
- For extra protection to vehicle place towel on edge of roof when loading and unloading.
- Ensure bottom of hull is clean before loading to avoid damaging boat surface.
- Always tie down bow and stern of boat to vehicle bumpers or tow hooks.
- Do not exceed weight limitation of racks or factory installed bars.
- Ensure load carrier or factory cross bars are properly installed and tight to vehicle.
- Failure to follow above guidelines voids warranty.

1

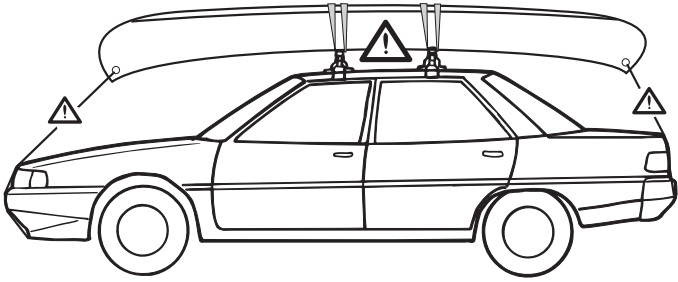

- Mount the load carrier bars as far apart as possible with a maximum of 36" apart.
- An XAdapt 12 kit may be purchased to mount canoe carrier flush to Aeroblade bars.

2

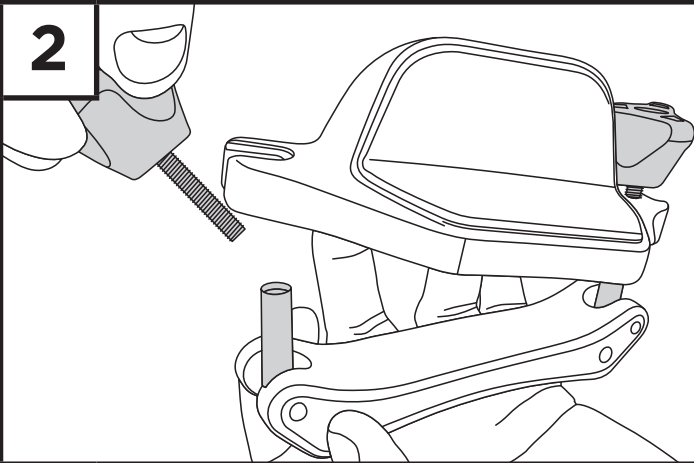

- Attach two 3-wing knobs with bolt to Flip-Fit bracket.

3

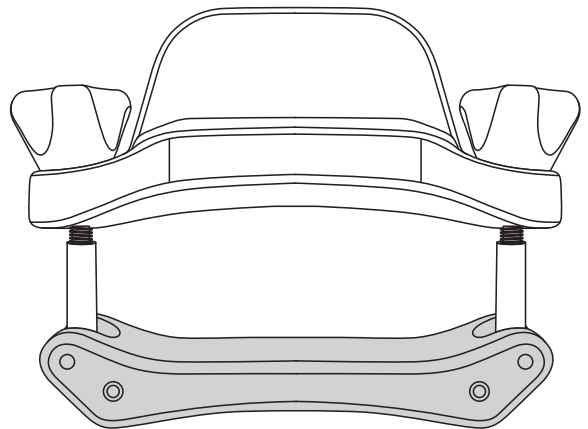
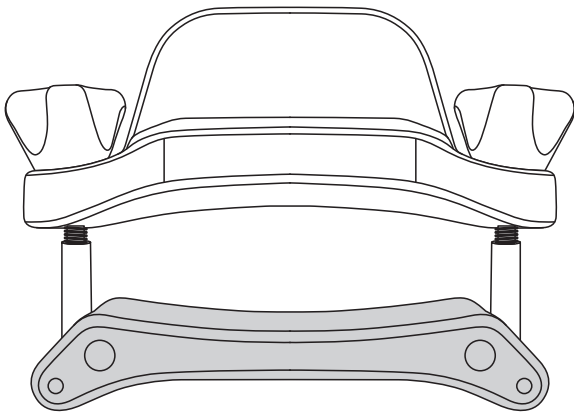

- The Flip-Fit bracket can be rotated and flipped to fit different width load bars. The tips on the Flip-Fit bracket should face down to fit thinner load bars (Figure A) and up to fit wider load bars (Figure B).

4

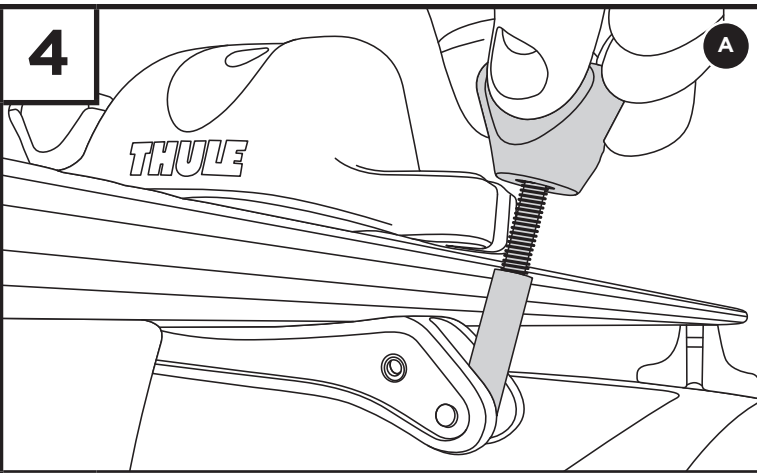

- Place bracket on load bar with Thule brand logo facing outwards. Slide Flip-Fit bracket under load bar and rotate knob into slot on side of base.

NOTE: Canoe carrier bases must be placed inside of four load bar feet that are attached to the vehicle.

B

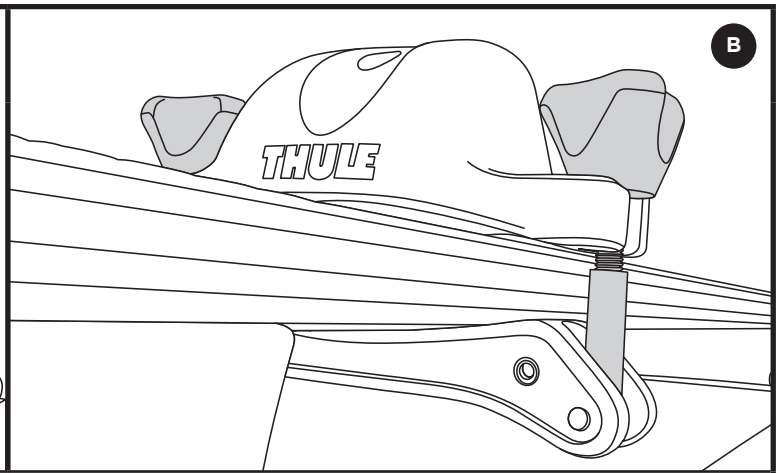

- Tighten both knobs so that bracket is held in place. Bracket will likely need to be moved to fit canoe.

5

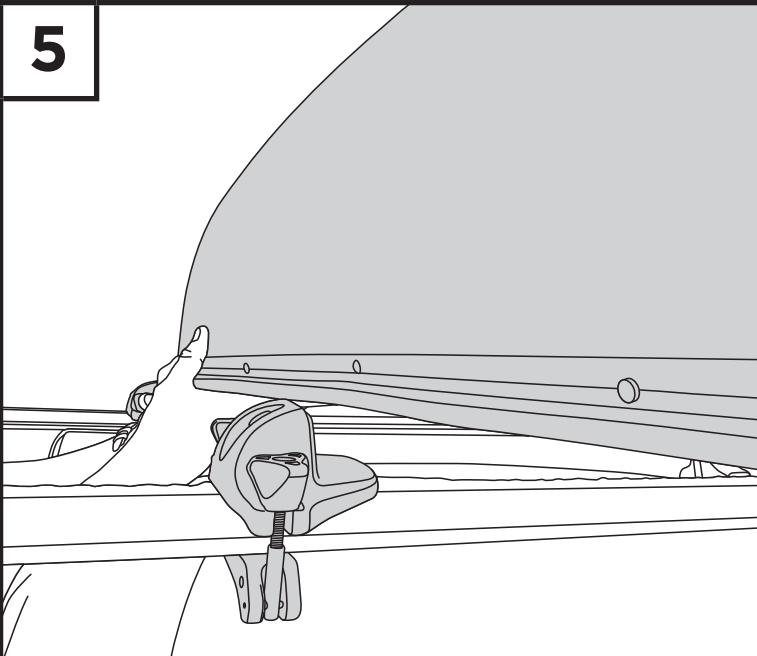

- Lift canoe, turn upside down and place canoe gunwales onto cushioned grey pads of base. Loosen knobs and adjust spacing of bases on load bar to fit canoe properly. Tighten all eight knobs firmly so that bases do not move.

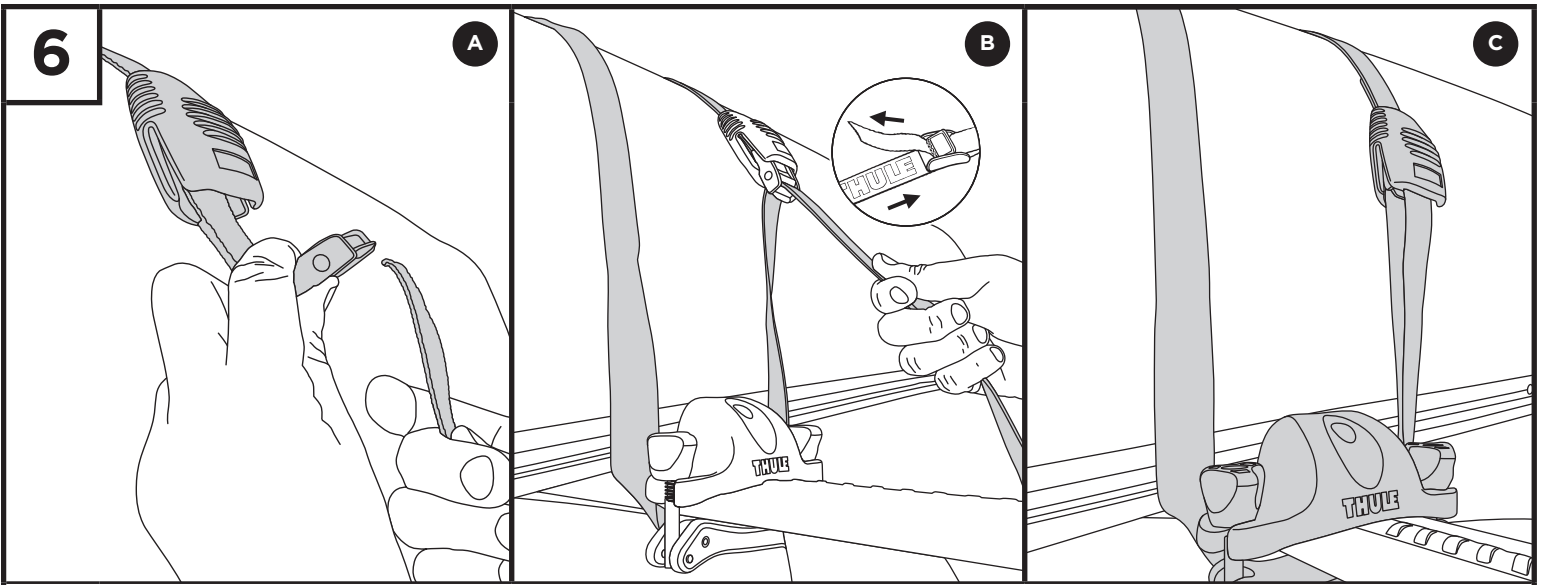

- Wrap strap over canoe and under load bar on both sides of canoe. Slide buckle bumper over metal buckle to prevent vehicle and canoe scratches. Thread end of strap through metal buckle by pushing down on lever and then pulling down to tighten. Re-cover buckle with buckle bumper.

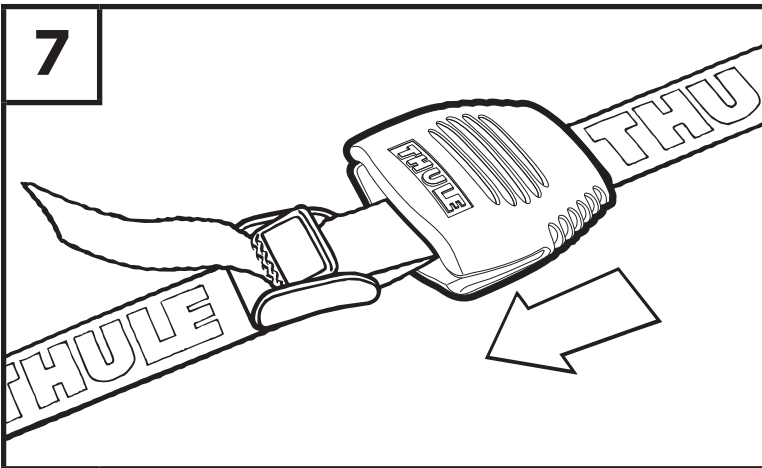

- No scratches with Buckle Bumper

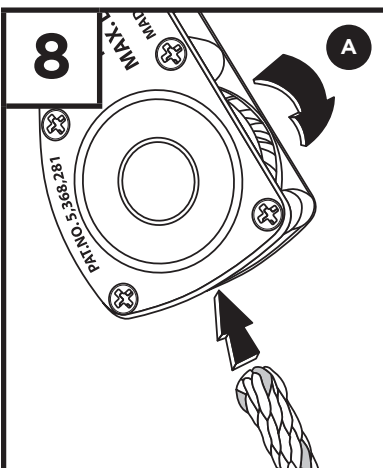

- Feed end of rope up through the bottom while rotating the spool clockwise.

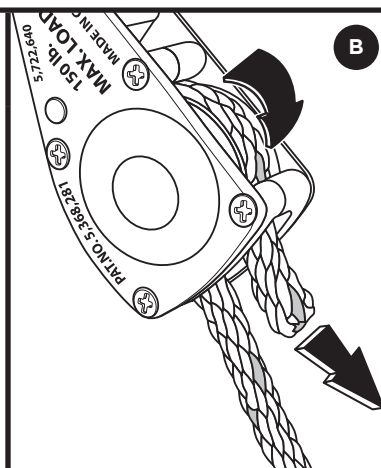

- Keep rotating the spool until rope exits at the bottom.

9

BOW / STERN TIE DOWN

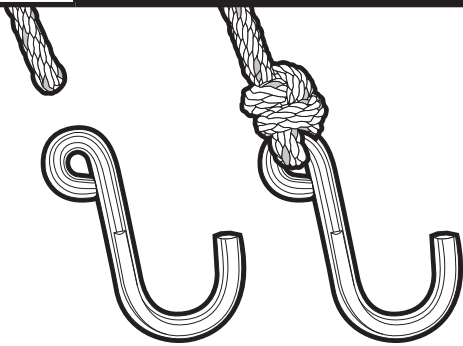

- Carefully attach hook to end of rope.
- Attach hook to vehicle undercarriage or tow hooks. If no attachment points are available, purchasing a Thule Hood Loop strap (part 529) or Quick Loop strap (part 530) may provide a solution.

10

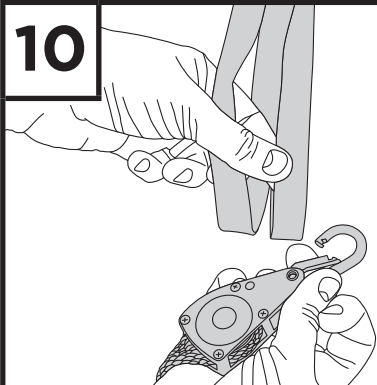

A

- Loop black strap around canoe cross bar or handle. Attach ratchet to both ends of black strap.

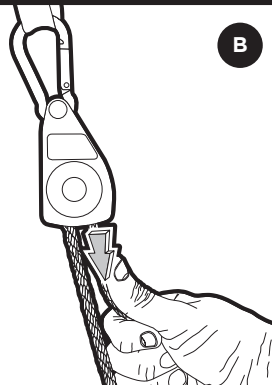

B

- Pull free end of rope until desired tightness is reached.
- Do not overtighten as this could deform boat.

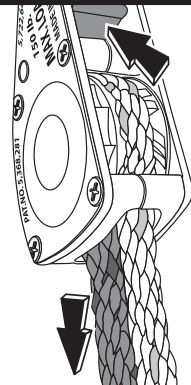

C

- To release, press lever located above ratchet spool.

WARNING:

Do not exceed load 150lb. limit of QuickDraw. Inspect rope and ratchet before each use. Do NOT use if damaged. Avoid sharp edges, pinch points, abrasive or hot surfaces.

11

