

PARTS INCLUDED

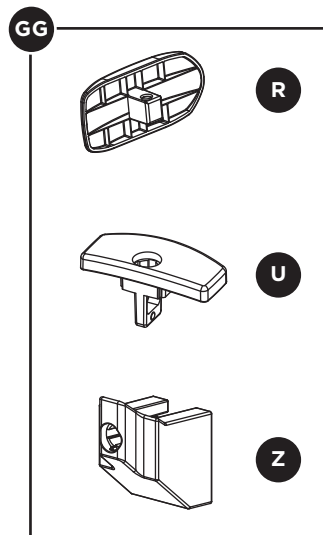
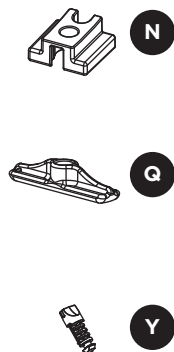
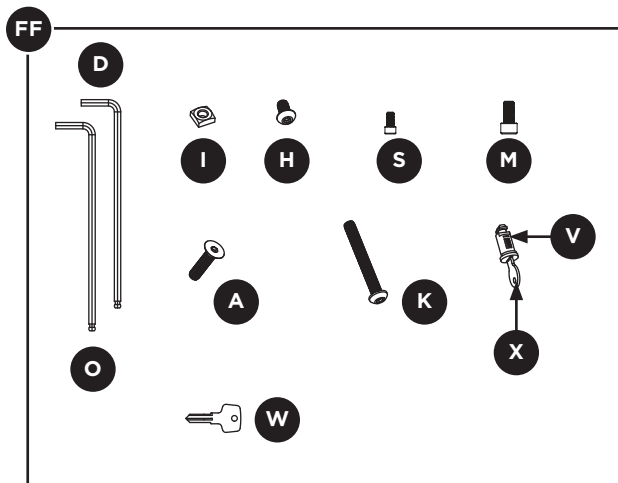
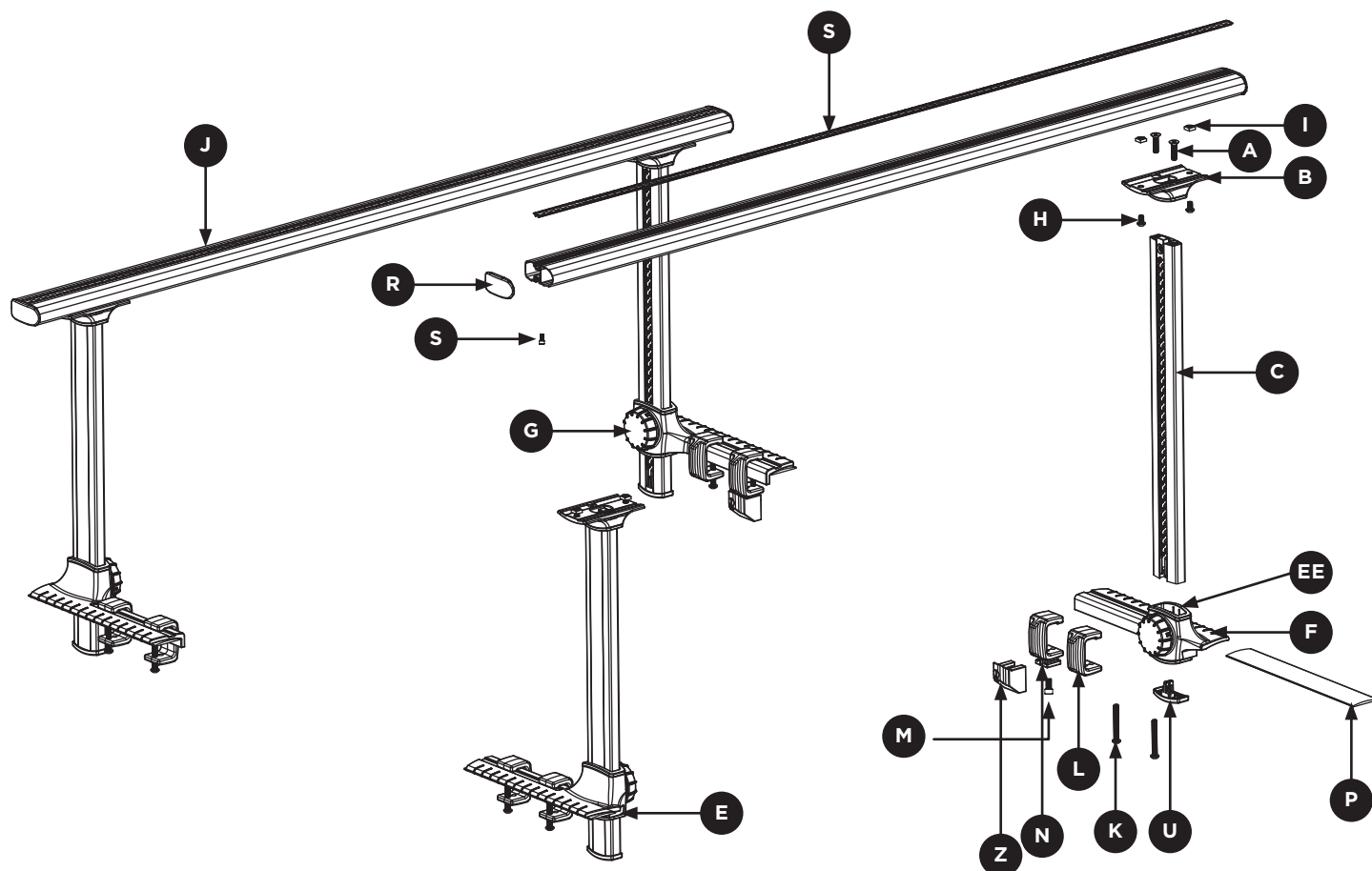

part	description	part number	qty.
B	Saddle	7521369001	4
C	Upright	7521388001	4
E	Base Assembly (front right, rear left)	7521367001	2
F	Base Assembly (front left, rear right)	7521368001	2
G	Rack Clamp Knob /	8523170001	4
J	Crossbar /	7521364001	2
L	Base Clamp /	7521459001	8
N	T-Slide Casting /	8523164001	2
P	Rubber Shim /	RX110343	4
Q	Clamp Foot /	PT27300	8
T	Crossbar Rubber Strip /	8525402013	2
V	Lock Cylinder /	—	4
W	Change key /	8531251	1
X	N-Series Key /	—	2
Y	Lock Plug /	8536395	2
AA	load stop /	8537165	4
BB	knob /	8535714	4
CC	t-bolt M8 x 26 mm /	853571503	4
DD	washer M8 /	951082054	4
EE	Base Assembly Cap /	8523168001	4
FF	Fastener Hardware Bag /	7521391001	1
A	FHCS (Flat Head Cap Screw) 3/8 - 16 x 1.5"	HD27024FCHS	8
H	BHCS (Button Head Cap Screw) 3/8 - 16 x 5/8"	HD27051	8
I	UNC Square Nut 3/8 - 16 /	HD80088	8
K	BHCS (Button Head Cap Screw) 3/8 - 16 x 3"	HD27065	8
M	SHCS (Socket Head Cap Screw) 3/8 - 16 x 3/4"	8523233001	2
S	SHCS (Socket Head Cap Screw) M6 - 1 x 14 mm	HD27059	4
D	7/32" Ball Point Hex Key /	—	1
O	5/16" Ball Point Hex Key /	—	1
GG	Plastics Hardware Bag /	7521629001	1
R	Crossbar Endcap /	8523214001	4
U	Upright Locking Cap /	8523166001	4
Z	Clamp Lock Housing /	8523163001	2

WARNINGS / LIMITATIONS •

- This system has been designed with a maximum load capacity of 450lbs. Do not exceed vehicle manufacturer's load limits.
- If used in conjunction with another type of load carrying system the lower weight capacity of the two systems should be followed.
- Tie down front and rear of all long loads to the vehicles bumpers for safe transport.
- Excessive rust in bed decreases carrying capacity and could result in system failure.
- Vehicles with bed liners could require modifications. Read through the instructions prior to beginning installation.

1

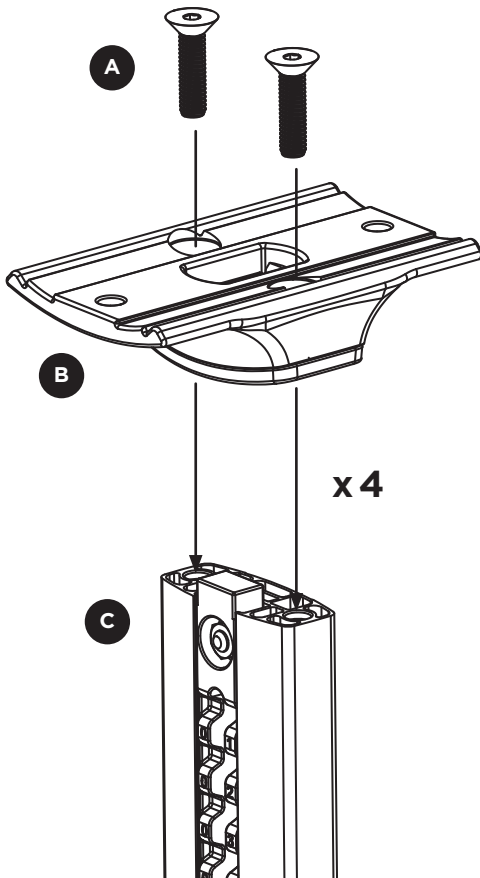

- Attach Saddles (B) to tops of Uprights (C) and secure with two 1 1/2" Flat Head Cap Screws (A). Torque to 32 ft-lbs using 7/32" Allen Key (D).

NOTE: Thread Flat Head Cap Screws by hand first to avoid cross threading bolt. When tightening, ensure Allen Key is fully seated to avoid stripping.

2

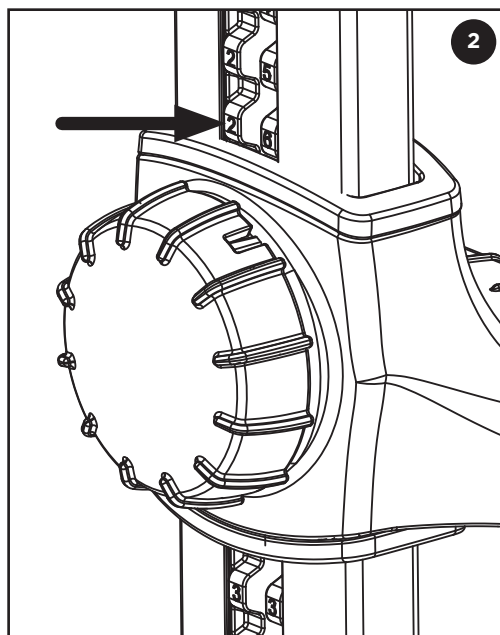
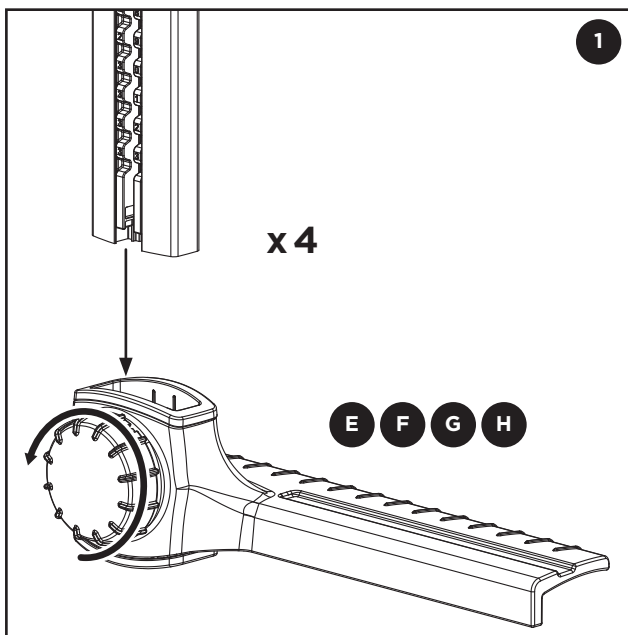

1. On Base Assemblies (E/F/G/H), loosen QuickDials and insert pre-assembled Uprights with black Gear Rack facing towards QuickDial. Make sure Base Assembly T-Bolts slide into Gear Rack channels.

2. Using numbered gears on Gear Rack (1-33), identify a temporary height setting and tighten QuickDial.

TIP: While inserting Upright, slowly move QuickDial back and forth to help seat T-Bolt into Gear Rack Track.

3

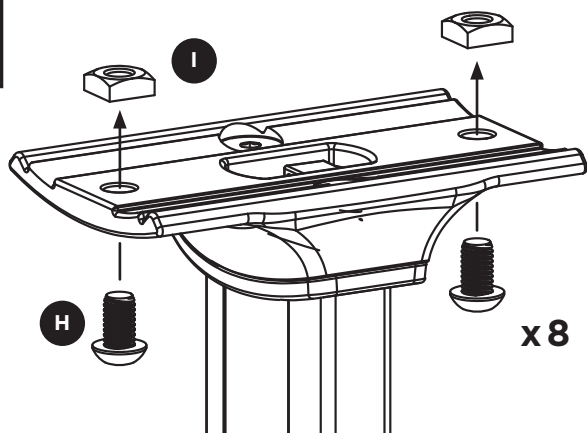

- Insert 5/8" Button Head Cap Screws (H) through bottoms of Saddles and thread loosely into Square Nuts (I). Make sure flat sides of Square Nuts are facing down towards Saddles.

4

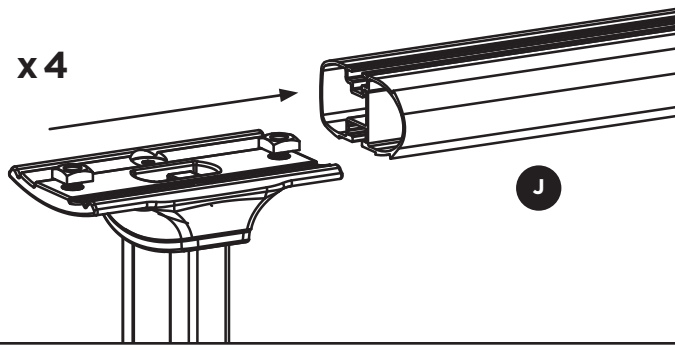

- Slide Square Nuts at top of Saddle onto bottom Crossbar (J) t-slot. Make sure tapered side of crossbar is facing towards the truck cab. Crossbar should remain loosely assembled for later adjustment.
- Repeat at other side of Crossbar, and follow same steps for second Crossbar and Base Assembly. See instructions p.1 for correct orientation of Crossbars and Base Assemblies.

NOTE: Crossbars will be fully secured to Saddles once Crossbar/Upright assemblies are installed and adjusted on truck.

5

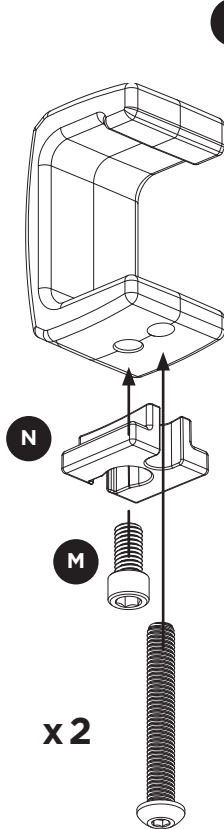
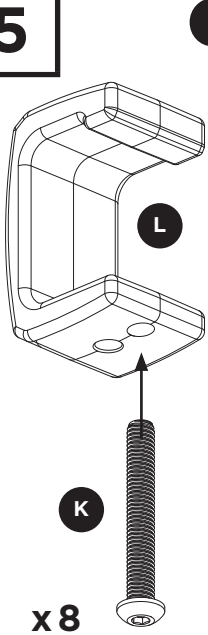

NOTE: XK3 adapter required for Toyota Tacoma (not included).

1. Thread 3" Button Head Cap Screws (K) loosely through front hole of Clamps (L).
2. Add T-Slides (N) to two of the Clamps by threading 3/4" Socket Head Cap Screws (M) up through rear hole. Tighten fully using 5/16" Allen Key (O). Front slot on T-Slide will index on 3" clamp bolt.

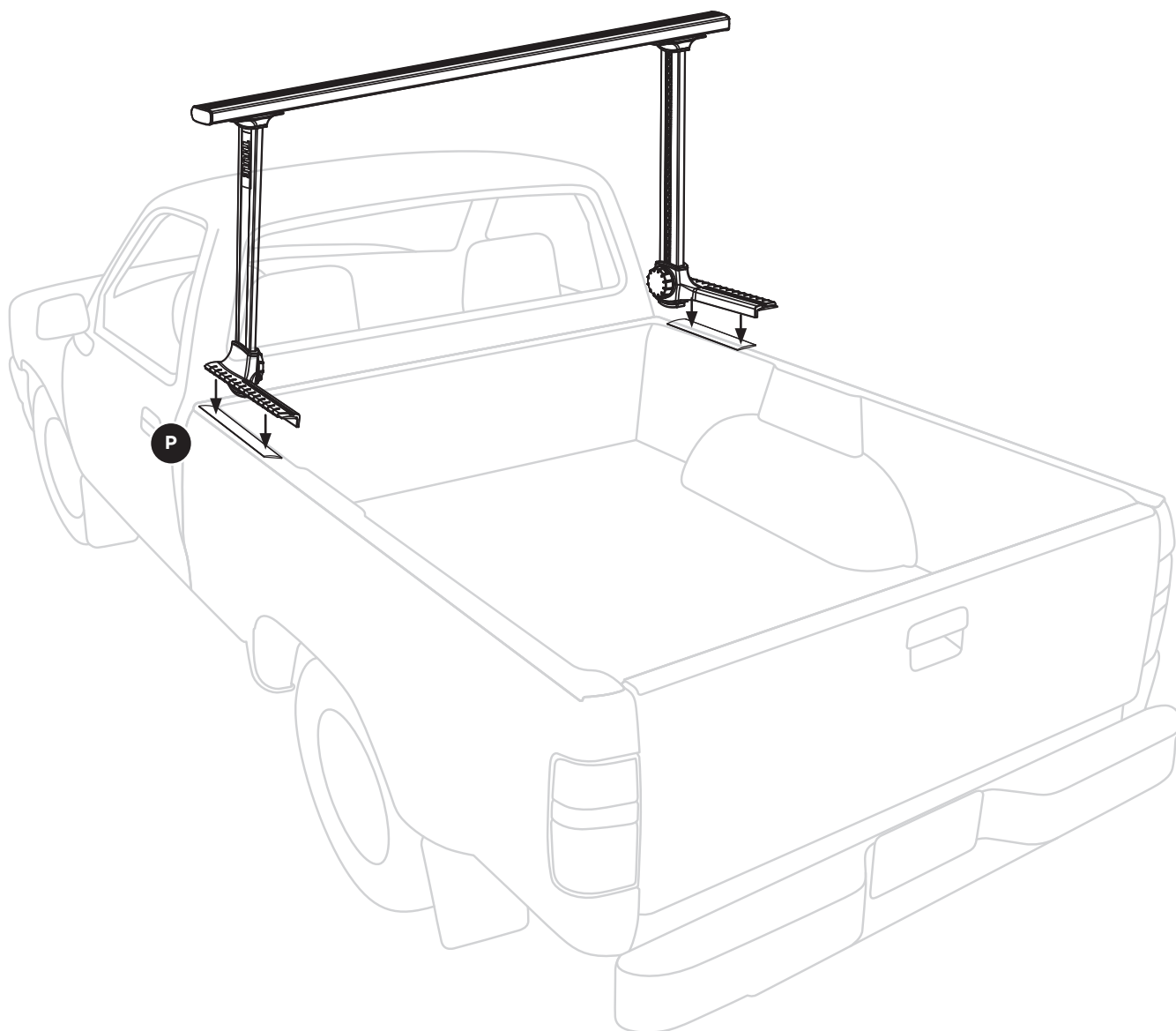

- Clean bedrails.
- Position Shims (P) and entire front Crossbar assembly on bedrails as close to cab as possible. Carefully align Shims under Crossbar bases.

TIP: Mount location is different for each bed design and may require adjustment to avoid interference with hardware mounting.

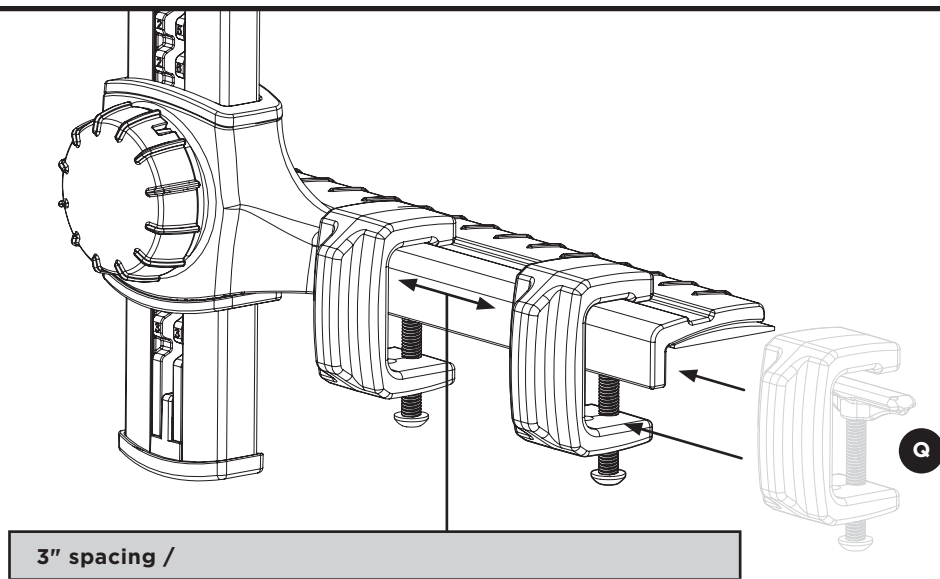

- Place Clamp Foot (Q) on top of Clamp bolt. Slide Clamp onto Base top groove, with Clamp Foot under bedrail. Locate Clamp as close to upright as possible and hand tighten bolt. Repeat with second clamp, placing as far back on Base as possible, and hand tighten.
- Repeat on other side of front Crossbar assembly using one standard clamp and one clamp equipped with T-Slide.
- Using a tape measure, ensure Bases are spaced evenly off cab or end of bed. Tighten Clamp bolts to 10 ft-lbs using 7/32" Allen Key.

NOTE: Some bedliners may need to be modified. Cutting bedliners in area of mounting hardware may be necessary.

WARNING: Clamp spacing of less than 3" (76.2mm) reduces rack load capacity. If truck bed design prevents 3" Clamp spacing, move Base Assembly along bedrail until proper Clamp spacing is possible.

8

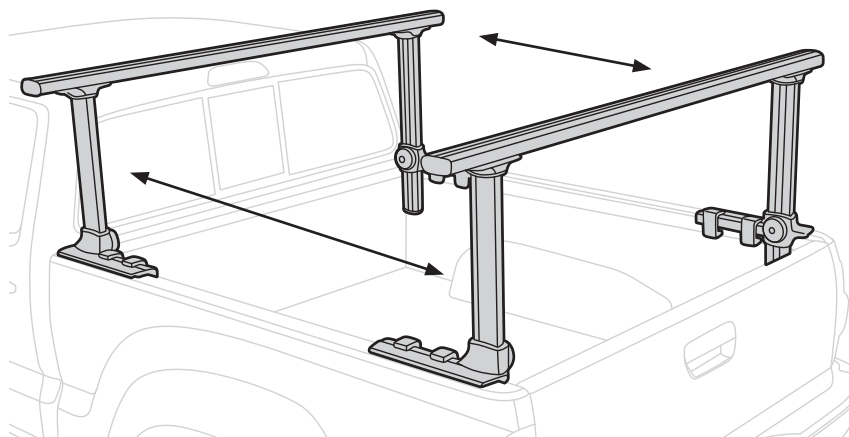

- Position rear Crossbar assembly and Shims as close as possible to tailgate and repeat steps 6 + 7.
- Using a tape measure, ensure equal front-rear Crossbar spacing and tighten rear Clamp bolts.

NOTE: Some accessories require a specific distance between crossbars. If installing secondary accessories, check accessory fit prior to positioning and securing.

9

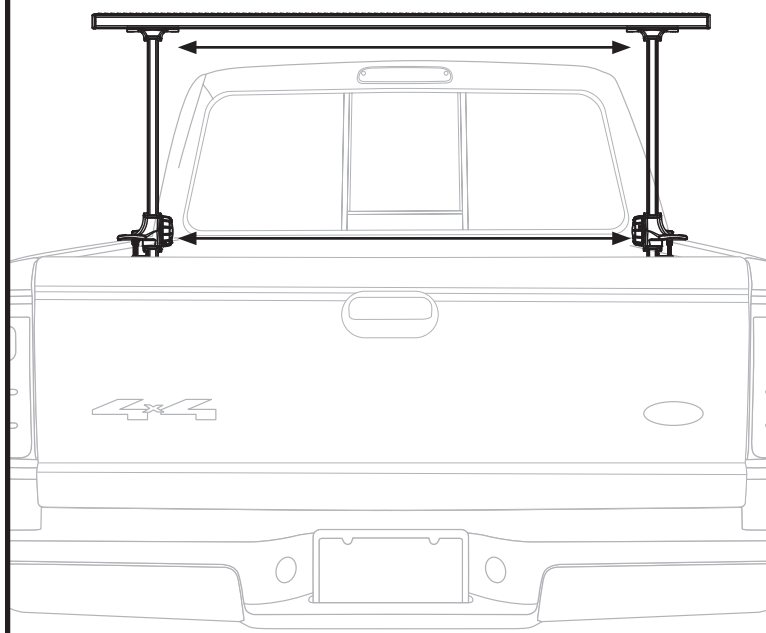

- Using tape measure, center Crossbars side-to-side at ends, and ensure Uprights are at 90-degrees.
- Use 7/32" Allen Key to secure Saddles to Crossbars and torque to 27 ft-lbs.

10

x 4

AA

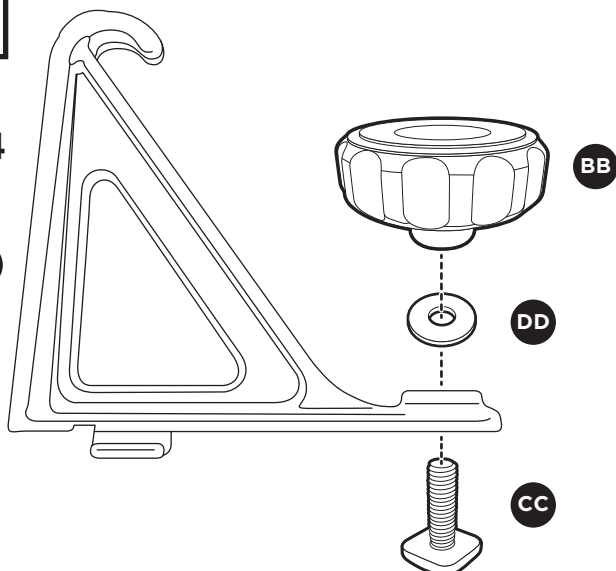

1

- Pre-assemble all load stops as shown. Attach knob loosely.

2

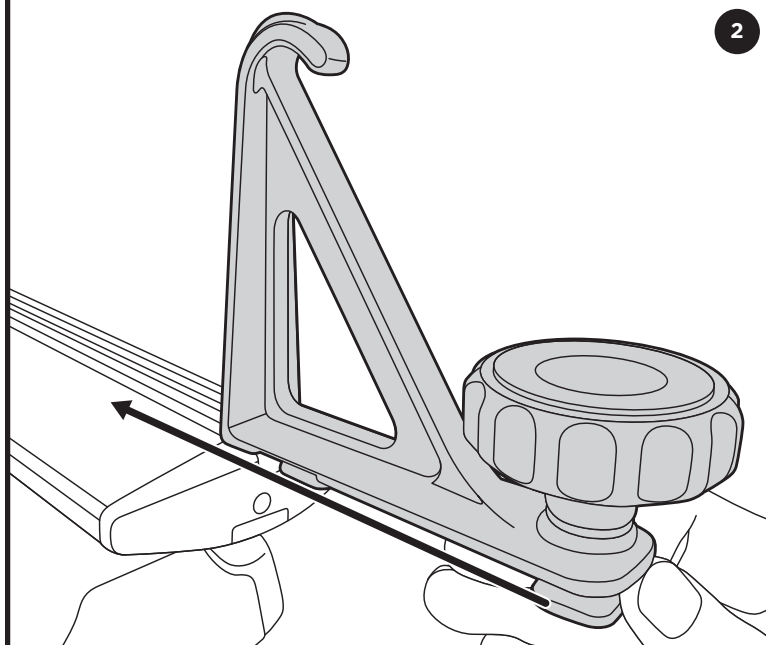

- Install load stops by inserting tab on underside of load stop and t-bolt into t-track on top of crossbar. Make sure both the tab and t-bolt have engaged the t-track before continuing.

3

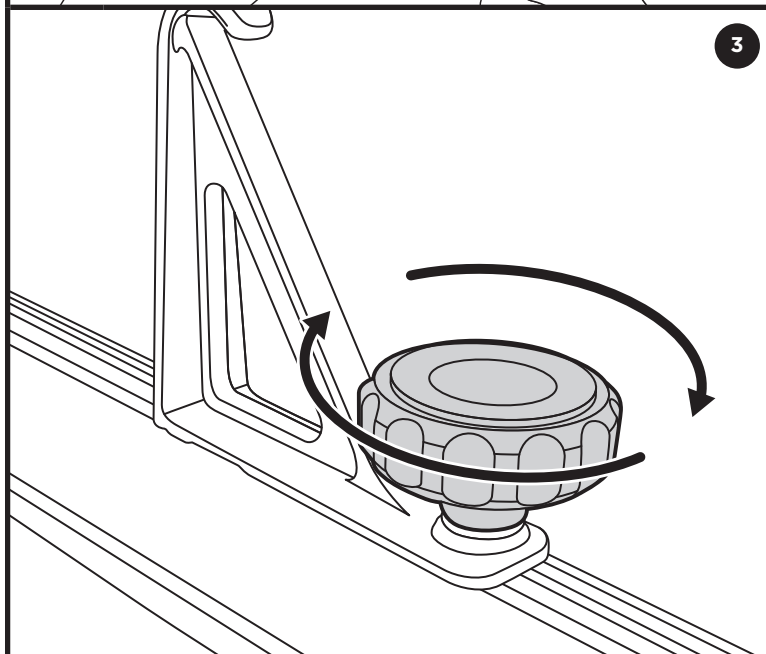

- Tighten knob firmly to set load stop position.

11

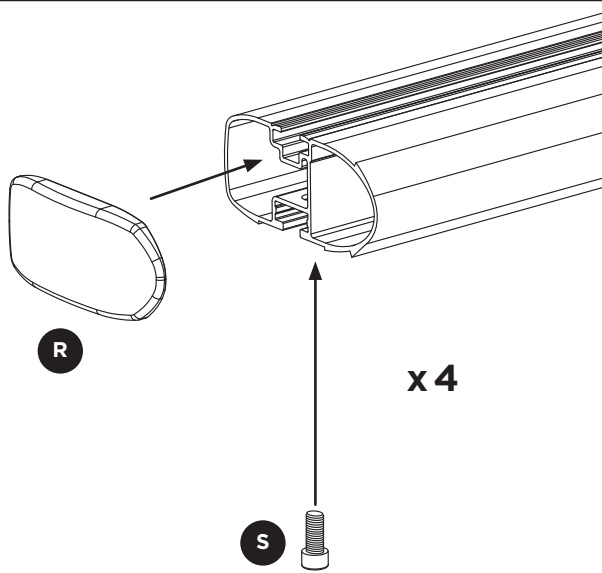

- Insert End Caps (R) into Crossbar ends and secure with 14mm Socket Head Cap Screws (S). Do not over-tighten.

12

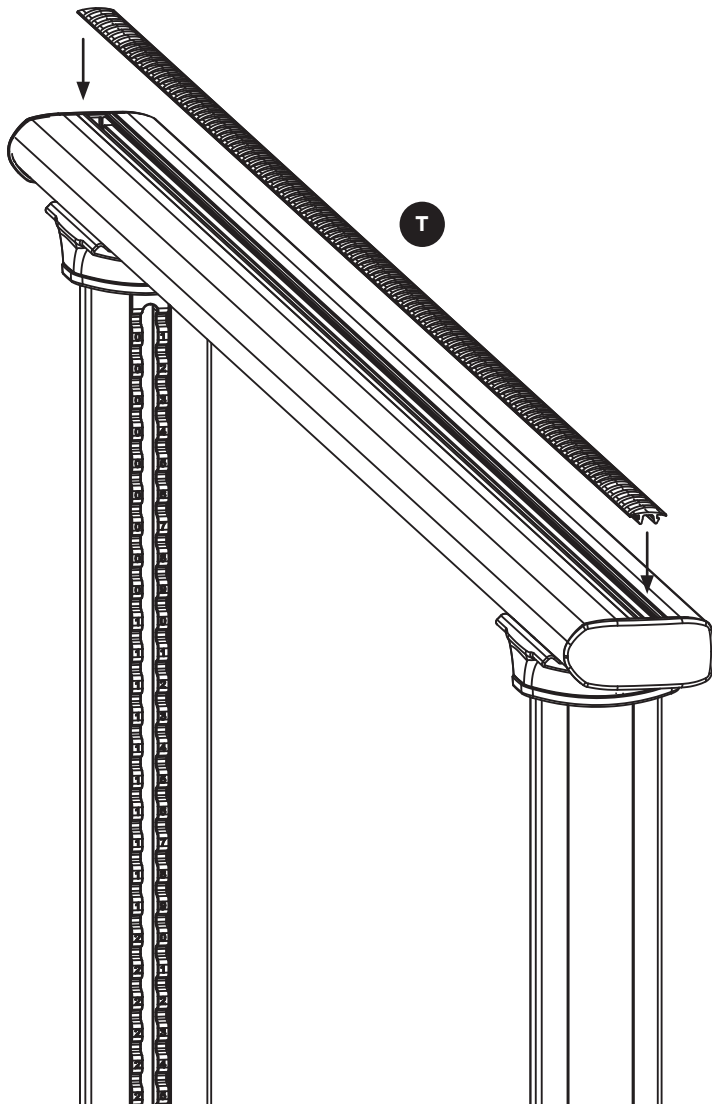

- Installation of Crossbar Rubber Strips (T) is optional. To install, place rubber strip on the top Crossbar t-slot with ribbed side facing up. If Load Stops have been installed, Rubber Strips may be left off or cut to fit around Stops.

- Starting at one end of Crossbar, insert end of Rubber Strip into t-slot by pushing down until Rubber Strip fully seats into slot. Continue across bar.

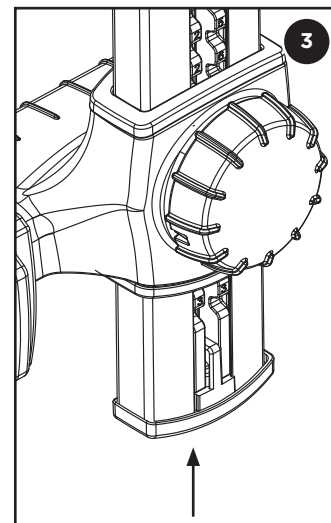
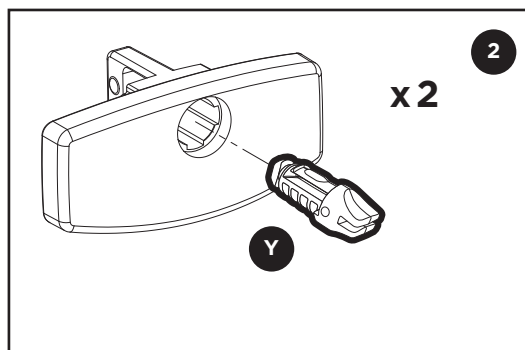
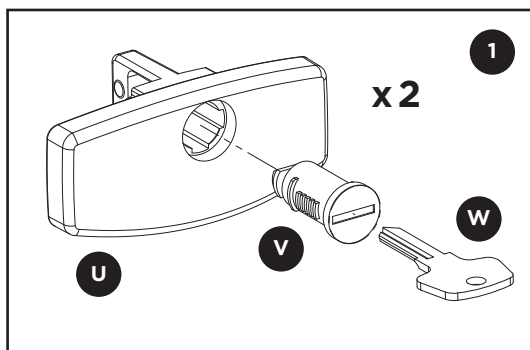

1. Install Lock Cylinders (V) into two Locking End Caps (U) by inserting Change Key (W) into Lock Cylinder and inserting Cylinder into End Cap. Hold Cylinder in place and remove Change Key to complete install.

NOTE: Ensure Cylinder is properly aligned with tabs in Cap before inserting.

2. Install plastic Lock Plugs (Y) into remaining two End Caps.

3. Slide one Locking End Cap assembly into bottom of a front Upright. Secure in place by inserting and turning N-Series Key (X) 90-degrees. Repeat with second Locking End Cap on a rear Upright. Finish by pressing remaining End Caps into remaining Uprights. Turn Lock Plugs 90-degrees to secure in place.

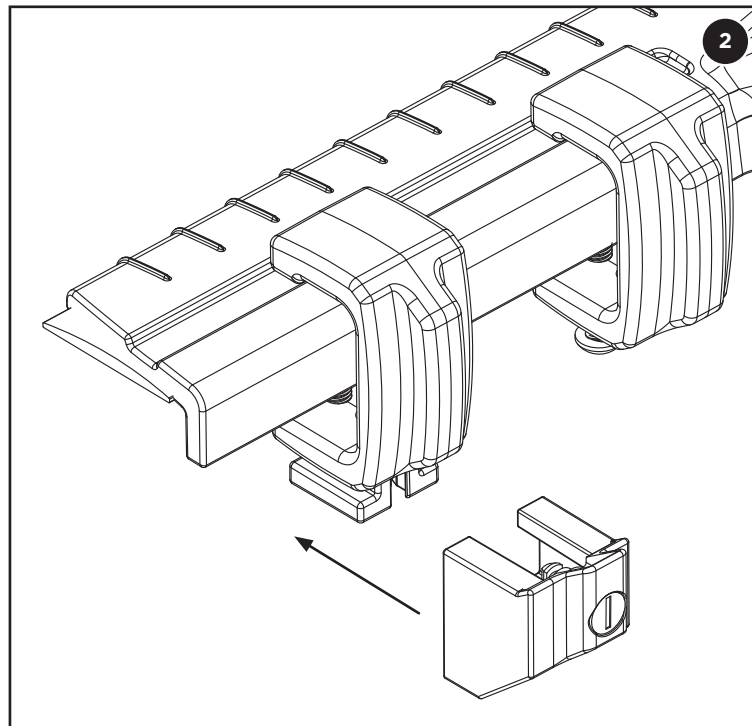
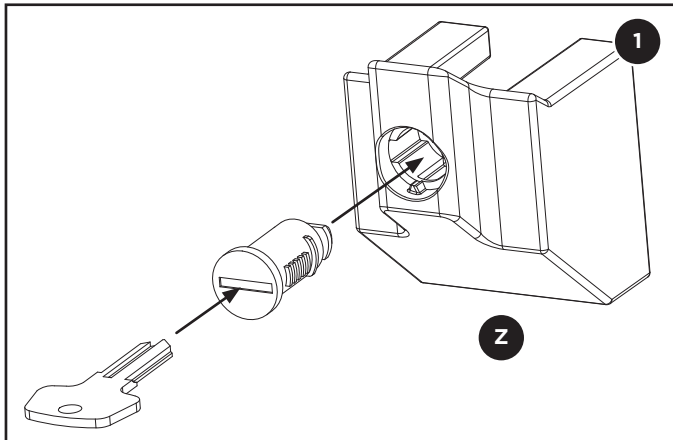

1. Install Lock Cylinders into two Locking Clamp Covers (Z) by inserting Change Key into Lock Cylinder and inserting Cylinder into Clamp Cover. Hold Cylinder in place and remove Change Key to complete install.

2. Slide Locking Clamp Covers onto bottom of two Clamps equipped with T-Slides. Secure in place by inserting and turning N-Series Key (X) 90-degrees.