



JK FRONT SWAY BAR QUICK DISCONNECTS

#1753000

#1753010

#1756000

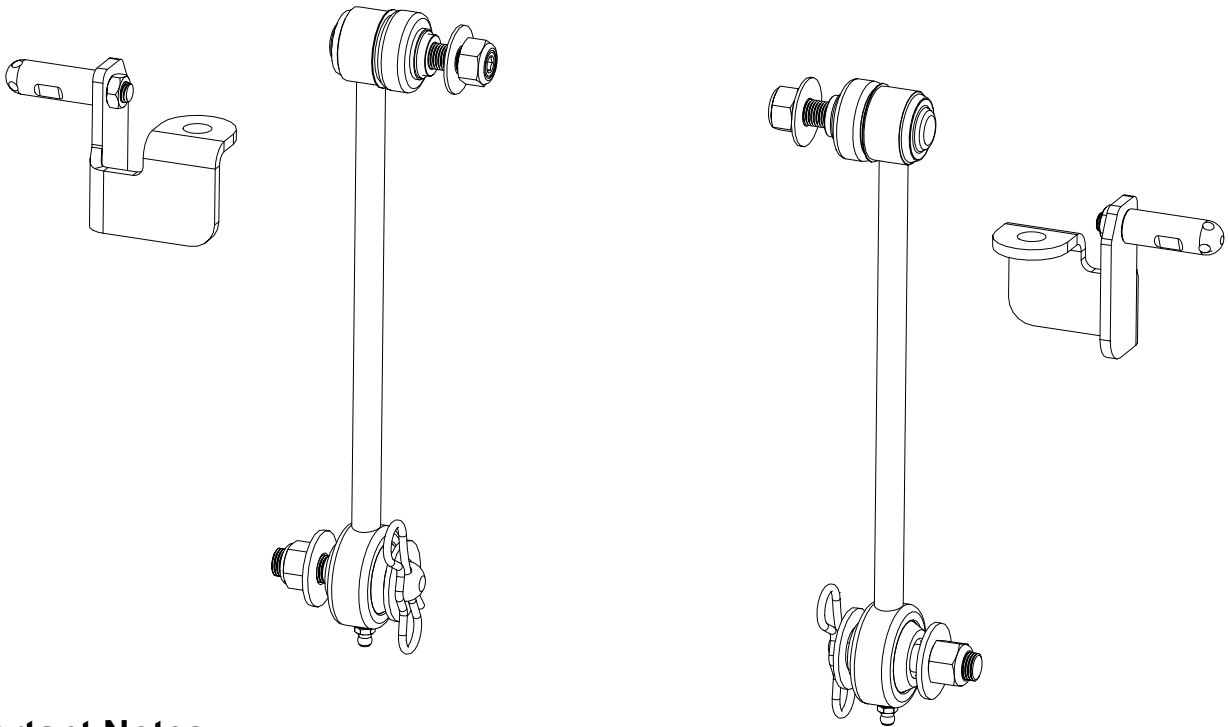

Important Notes:

Prior to beginning this or any installation read these instructions to familiarize yourself with the required steps and evaluate if you are experienced and capable to personally perform these modifications. A factory service manual should be used in conjunction with these installation instructions.

Refer to the parts list to ensure that all necessary components and hardware has been included. If any parts are missing please contact your local TeraFlex dealer for assistance.

Tools needed:

- Basic Mechanic's Tool Set
- Thread Locking Compound

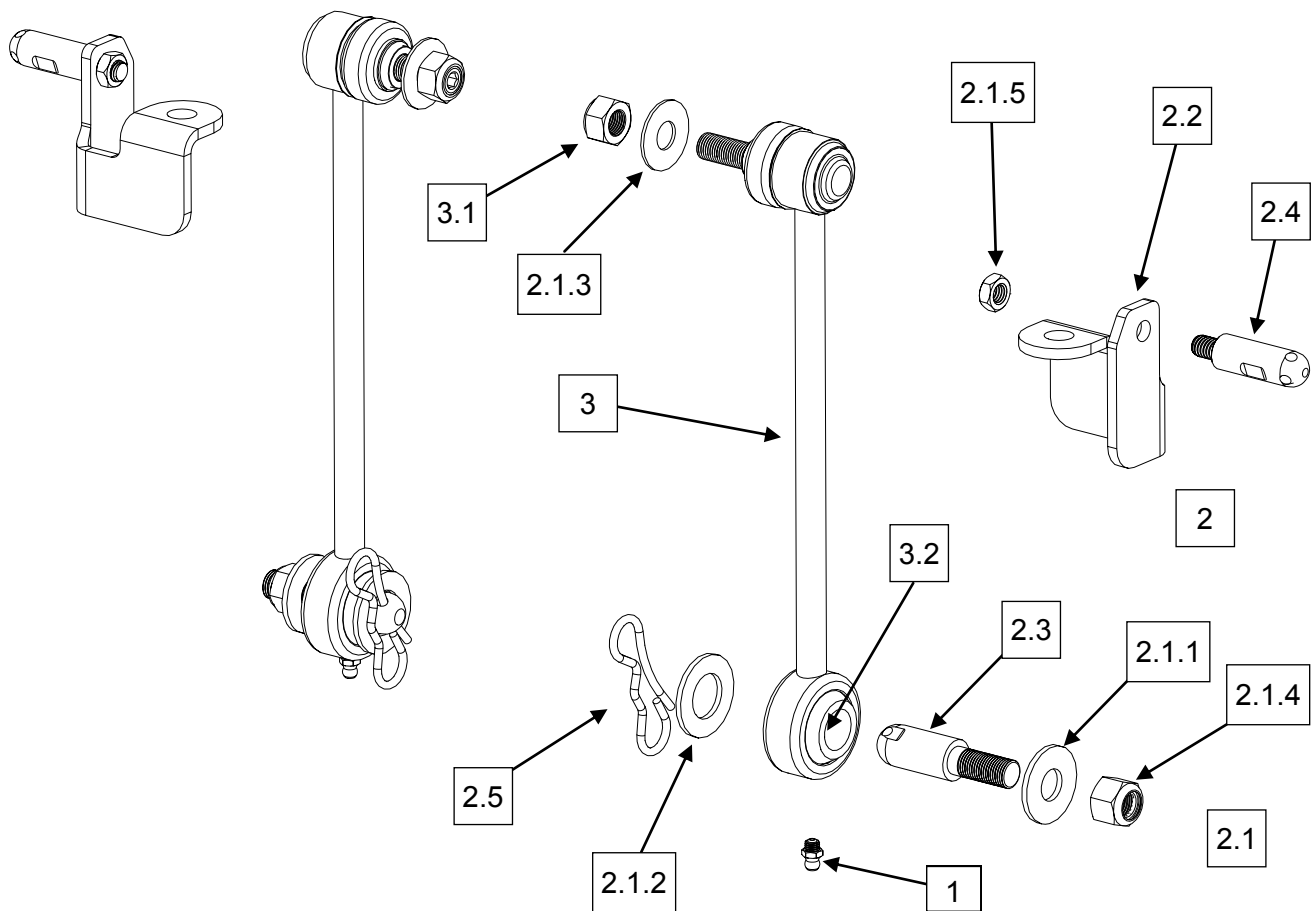

Item Number	Part Number	Description	Qty
1	308	Grease Zerk 1/4"-28 UNF Straight	2
2	600093	Hardware JK Quick Disconnect	1
2.1	5021	Hardware Pack for JK Quick Disconnect	1
2.1.1	37	Washer 1/2" Flat Zinc Plated	2
2.1.2	3801	Washer 3/4" Flat Zinc Plated for QD Link Pin	2
2.1.3	477	Washer 7/16" Flat Stainless Steel	2
2.1.4	488	Nut 1/2"-20 UNF Nylock Nut Stainless	2
2.1.5	73	Nut 3/8"-16 UNC Thin Jam Nut	2
2.2	600277	JK Quick Disconnect Retainer Bracket	2
2.3	600499	Universal 3/4" Diameter Axle Side Quick Disconnect Stud	2
2.4	600503	5/8" Diameter Upper Quick Disconnect Parking Stud	2
2.5	600504	Quick Disconnect Bow Tie Pin	2
3	753005 -or- 753006 -or- 753020	JK 3-4" Front Quick Disconnect Swaybar Link w/ Upper Swivel Stud JK 0-3" Front Quick Disconnect Swaybar Link w/ Upper Swivel Stud JK 6" Front Quick Disconnect Swaybar Link w/ Upper Swivel Stud	2
3.1	44	Nut M12 x1.25 Zinc-Plated Nylock Nut for Swivel Stud	2
3.2	600498	Quick Disconnect Bushing Ball	2

Remove the factory sway bar link with an 18mm.

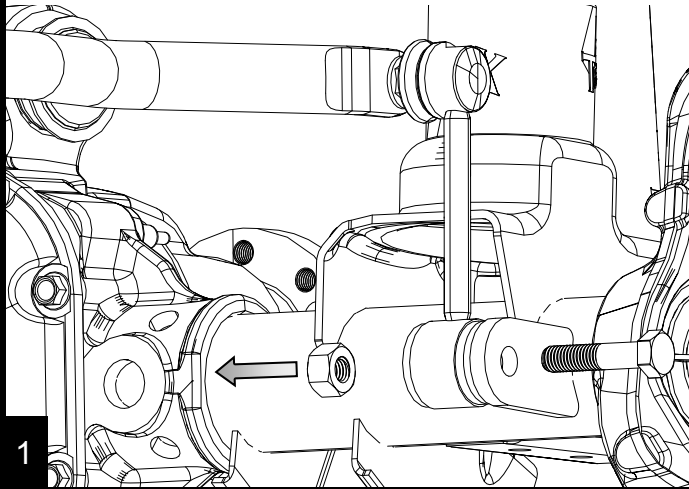

1

Save the nut from the upper stud of the factory link, it will be used in Step 8

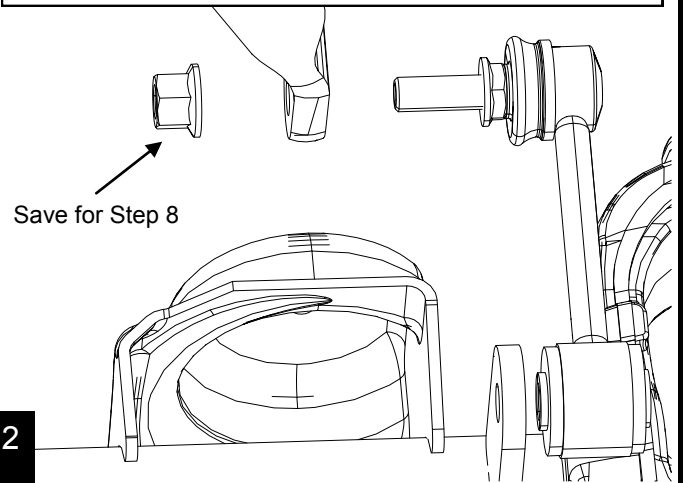

2

Insert lower stud 600499 into axle bracket as shown. Place washer 37 and nylock nut 488 onto the lower stud.
Note: The stud is stainless steel and the threads are soft.
Take care to not over tighten the nut.

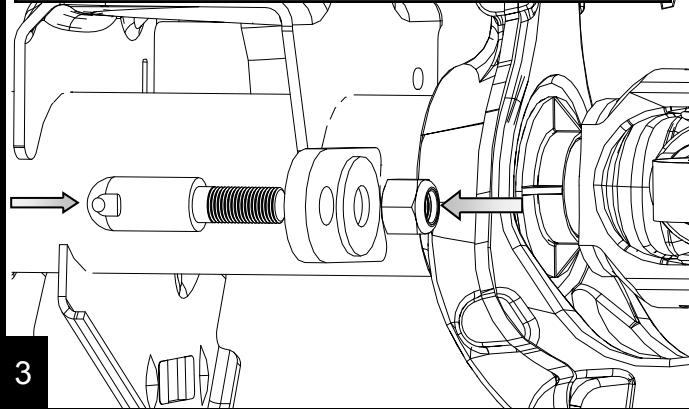

3

Torque nylock nut to **75 ft-lbs**

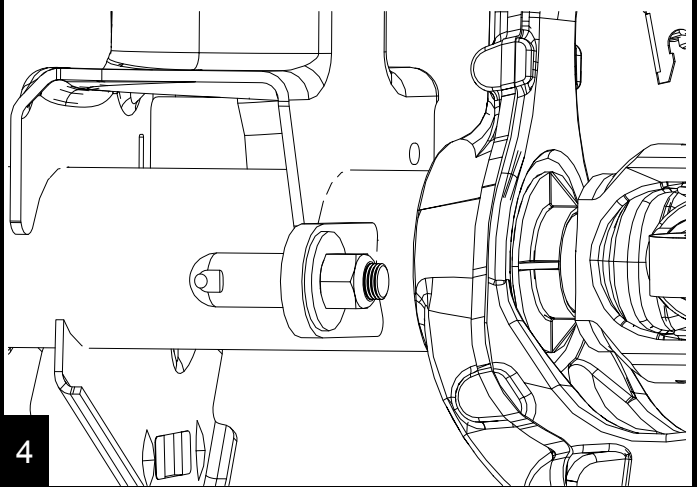

4

Insert the upper stud of the quick disconnect sway bar linkage into the factory sway bar. Place washer 477 and nylock nut 44 onto the stud.

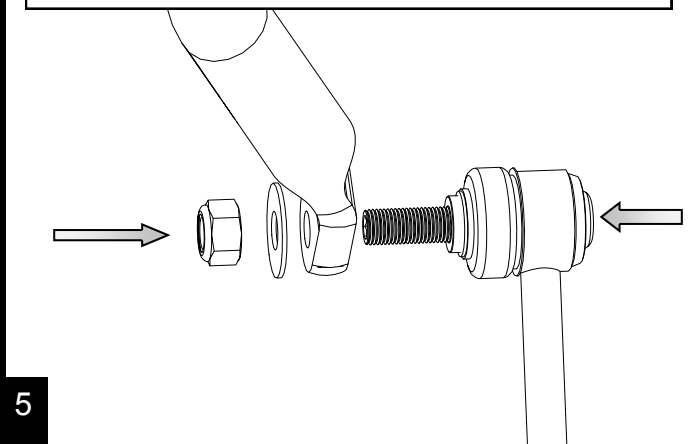

5

Use a 6mm allen to hold the stud, tighten down the nut with a 18mm wrench. Torque nylock nut to **75 ft-lbs**

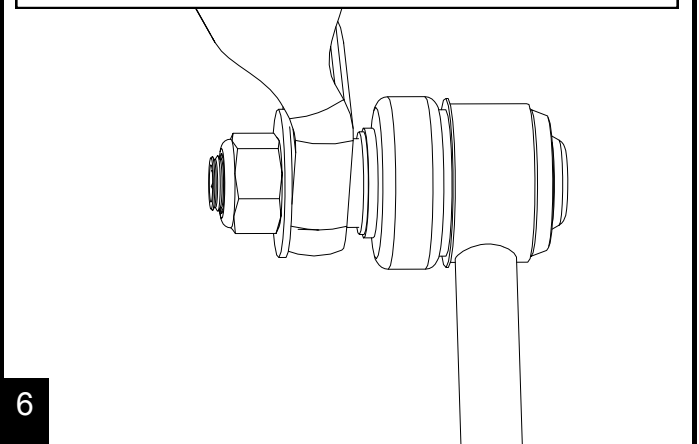

6

Slide the lower end of sway bar link onto the stud installed in Step 3. Place washer 3801 on stud and insert Bow Tie Pin. Note: This should be a tight fit for better sway bar function. Applying a bit of grease to the stud and bushing will help with install.

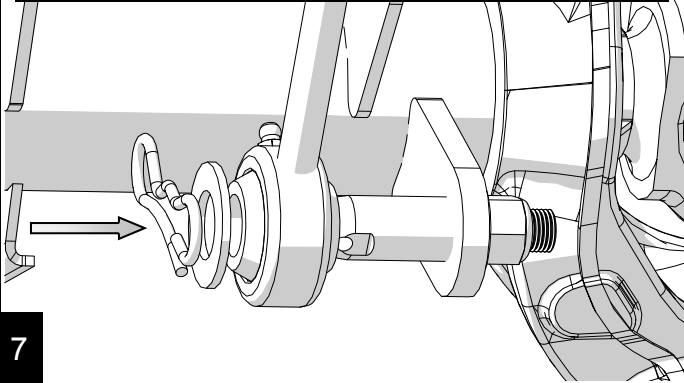

7

Remove the front body mount nut from the stud and slide on retaining bracket 600277. Then using the nut saved from Step 2 secure the bracket. Next insert stud 600503 into retaining bracket and install jam nut 73.

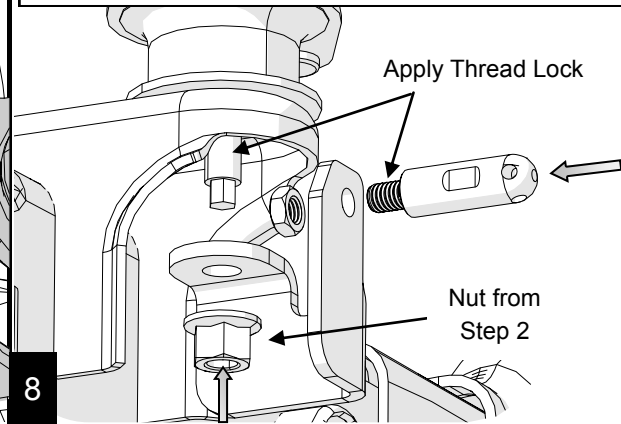

8

Torque the body mount to **80 ft-lb** and jam nut to **75 ft-lb**.

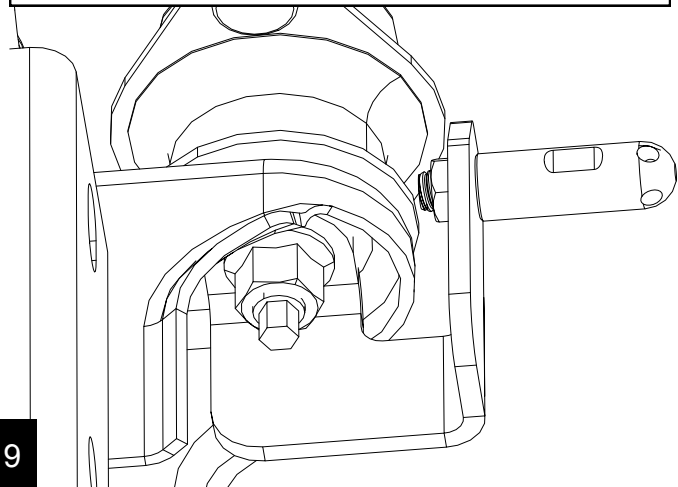

9

Repeat Steps 1 through 9 for the other side.

10