

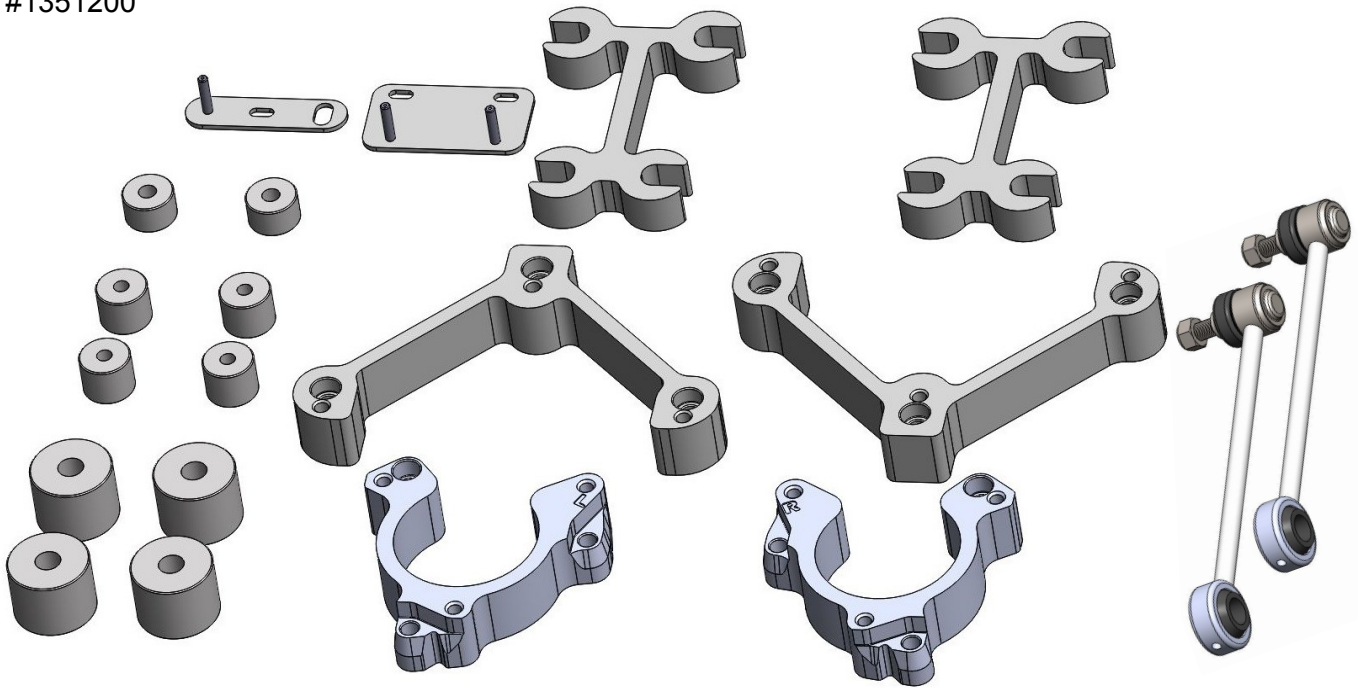

Renegade Budget Boost Instructions

#1351200



Important Notes:

Prior to beginning this or any installation read these instructions to familiarize yourself with the required steps and evaluate if you are experienced and capable to personally perform these modifications. A factory service manual should be used in conjunction with these installation instructions.

Refer to the parts list to ensure that all necessary components and hardware has been included. If any parts are missing please contact your local TeraFlex dealer for assistance.

Tools needed:

- Basic mechanics tool set
- E-12 Reverse Torx Socket
- E-14 Reverse Torx Socket
- E-16 Reverse Torx Socket
- E-20 Reverse Torx Socket
- T-40 Torx
- Blue Thread Locker
- Drill and 17/32 " Drill Bit

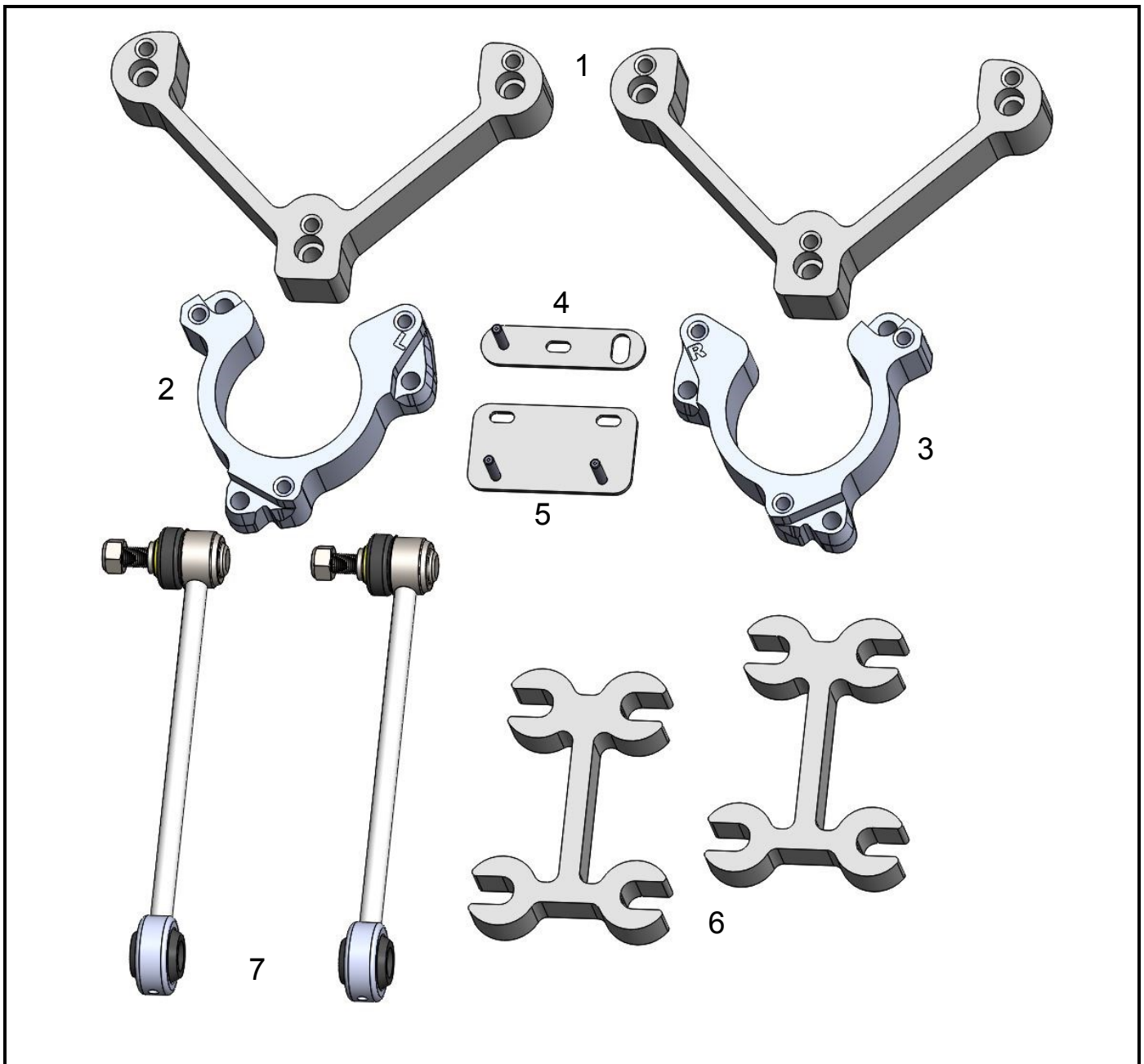

ITEM #	PART #	DESCRIPTION	QTY.
1	351210	Jeep Renegade Budget Boost Rear Aluminum Strut Spacer	2
2	351220	Jeep Renegade Budget Boost Front Aluminum Strut Spacer / Driver	1
3	351225	Jeep Renegade Budget Boost Front Aluminum Strut Spacer / Passenger	1
4	351231	Upper Charcoal Canister Relocation Bracket For Renegade, Aluminum	1
5	351241	Lower Charcoal Canister Relocation Bracket For Renegade Aluminum	1
6	351270	Control Arm Spacer for Renegade Budget Boost	2
7	753005	JK 3"-4" Front Quick Disconnect Swaybar Link w/ Upper Swivel Stud	2

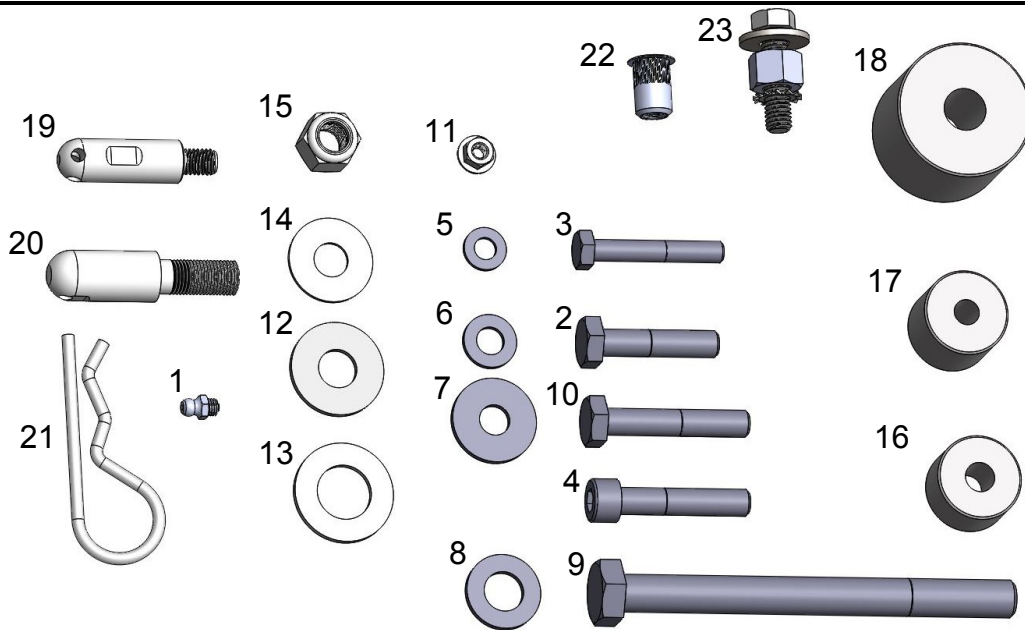

ITEM #	PART #	1753100 RENEGADE HARDWARE & SPACER KIT	QTY.
1	308	Grease Zerk 1/4"-28 UNF Straight	2
2	11396	Bolt, M10-1.25 X 45mm, EcoGuard, Hex Cap Screw	2
3	38621	Bolt, M8-1.25 X 50mm, EcoGuard, Hex Cap Screw	4
4	39623	Bolt, M10-1.5 X 50mm, EcoGuard, Socket Cap Screw	12
5	40357	Washer, M8 X 16mm OD, EcoGuard, Flat Washer	4
6	40358	Washer, M10 X 20mm OD, EcoGuard, Flat Washer	10
7	40359	Washer, 7/16" x 1.250" OD, Ecoguard, Flat Washer	8
8	40360	Washer, M14 X 28mm OD, EcoGuard, Flat Washer	4
9	43745	Bolt, M14-2.0 X 150mm, EcoGuard, Hex Cap Screw	4
10	53991	Bolt, M10-1.5 X 55mm, EcoGuard, Hex Cap Screw	8
11	90700	Nut, M6-1.0, EcoGuard, Flange Nut	3
12	37	Washer 1/2" Flat Zinc Plated	2
13	3801	Washer 3/4" x .124" Thick Flat Zinc Plated for QD Link Pin	2
14	477	Washer 7/16" Flat Stainless Steel	2
15	488	Nut 1/2"-20 UNF Stainless Nylock for QD4 SS	2
16	56-13-08-438-2-1	Spacer, 1.25" OD, 0.75" Length, .438" ID, Aluminum 6061-T6, No Finish	2
17	56-13-10-375-2-1	Spacer, 1.25" OD, 1.00" Length, .375" ID, Aluminum 6061-T6, No Finish	4
18	56-20-15-063-2-1	Spacer, 2.00" OD, 1.50" Length, .625" ID, Aluminum 6061-T6, No Finish	4
19	600499	Universal 3/4" Diamater Axle Side Quick Disconnect Stud	2
20	600503	5/8" Diameter Upper Quick Disconnect Parking Stud	2
21	600504	Quick Disconnect Bow Tie Pin	2
22	616	Nutsert 3/8"-16, .150-.312" Grip Length, Carbon Steel, Zinc Yellow Plus Lubricant	2
23	746	Nutsert Installation Tool for 3/8" Nutsert, Jeep Renegade	1

Refer to the factory service manual for lift locations. Raise and support the vehicle with jack stands. Note, jack stands must not be under suspension components.

Remove the tires and wheels.

1

Raise the hood. Mark the orientation and side (LH and RH) of the windshield wipers, then remove using a 17mm.

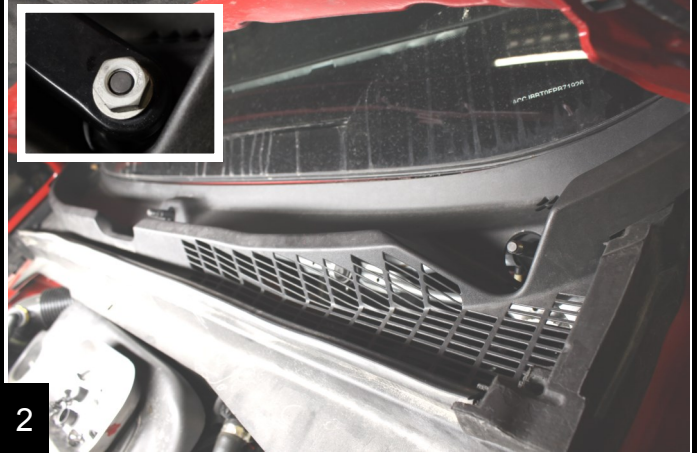

2

Remove the 7 plastic clips that attach the cowl. Then remove it to gain access to the strut mounts.

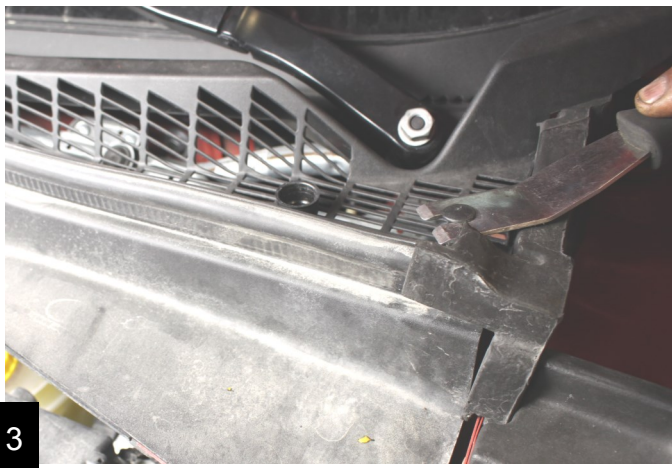

3

After cowl and wipers are removed the wiper arm assembly will need to be cycled partially to gain access to one of the strut bolts being blocked by it. To do this, turn the ignition to the on position and turn on the wind shield wipers. Before the motor can cycle back to its resting position turn the ignition off. This will leave the arm assembly out of the way.



4

Starting with the right side, remove the brake line and the ABS wiring from the front strut.

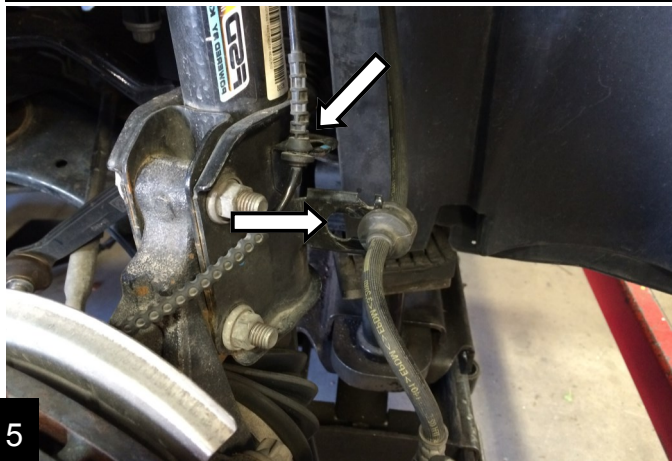

5

Using a T-40 torx and an 18mm box end wrench, remove the front sway bar link.



6

With a punch and hammer, bend the keyway nut tabs out of the axle keyway. Then remove nut and press shaft only enough to free it of the hub assembly.

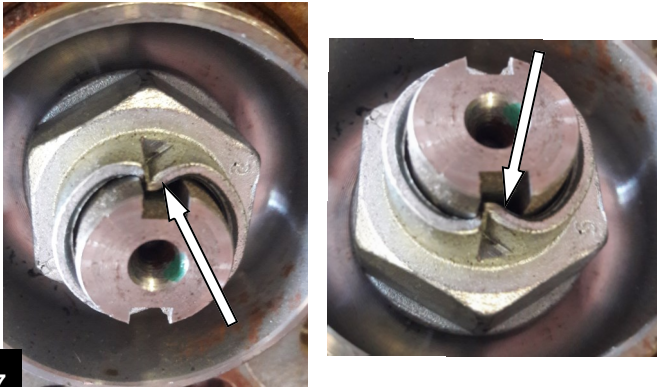

7

With an E-16 Reverse Torx and a 16mm, remove the 2 bolts that attach the steering knuckle to the strut and separate.

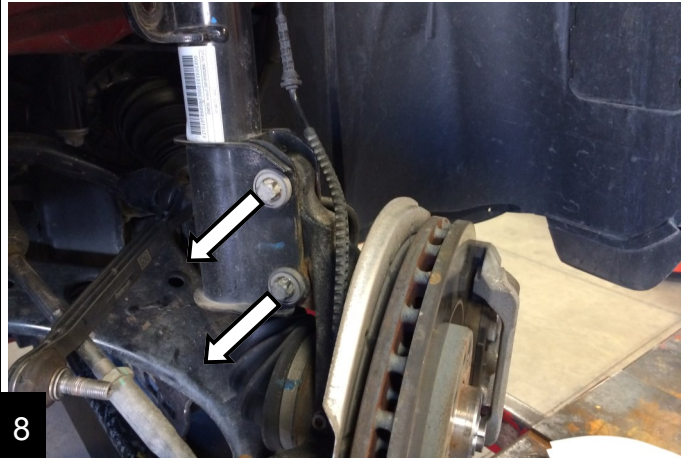

8

Remove the 3 upper strut bolts with an E-14 Reverse Torx and remove the strut.

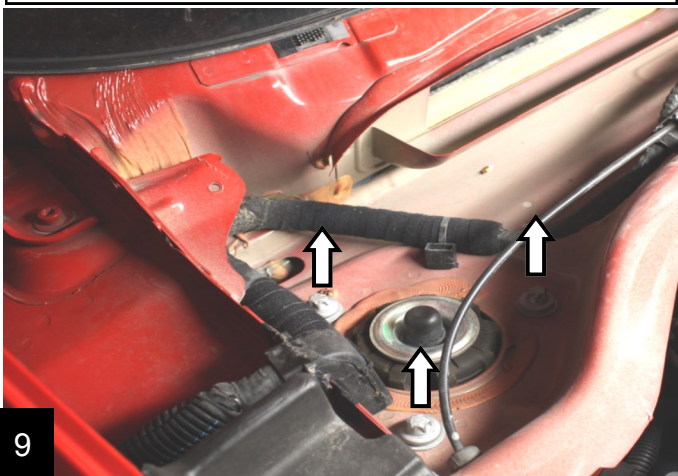

9

Place the front right spacer (spacer with the R) on top of the strut. Apply blue loctite to and install three 10M X 50mm Allen Bolts into strut through recessed holes. With a 8mm Allen torque bolts to 70 ft-lbs.

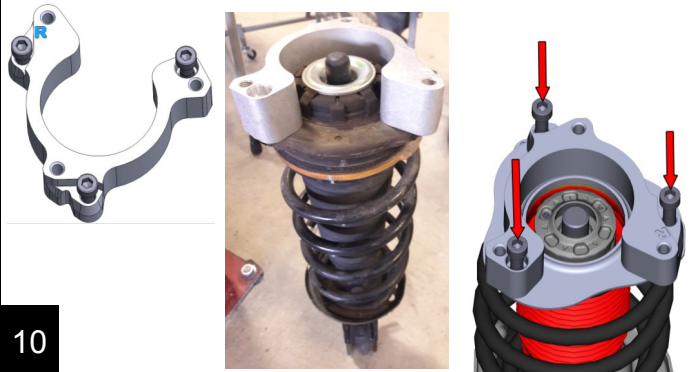

10

Re-install the strut using the factory bolts in the bolt holes of the spacer. The letter R will go toward the front of the Jeep. Do not apply loctite to these bolts. **Torque to 50 ft-lbs.**

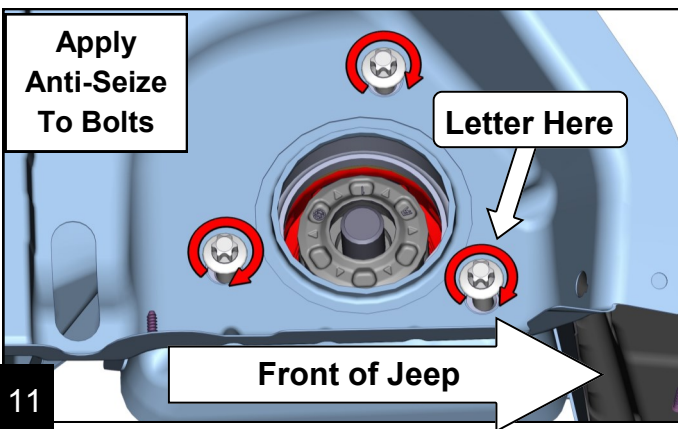

11

Reconnect the knuckle to the strut and axle shaft using the original hardware. **Torque knuckle to strut bolts to 90 ft-lbs. Torque axle nut to 148 ft-lbs.** Bend keyway tabs into keyway. Repeat steps 5-12 for the driver side.

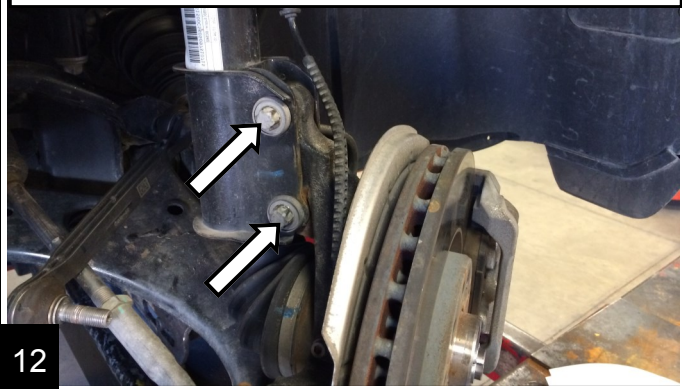

12

Insert the lower stud of the quick disconnect sway bar linkage into the factory sway bar. Place 7/16" washer and M12 nylock nut onto the stud. Use a 6mm allen to hold the stud, tighten down the nut with a 18mm wrench.

Torque to 75 ft-lbs.

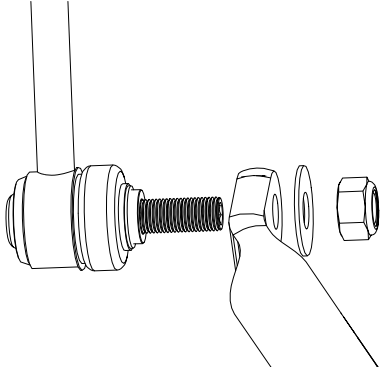

13

Insert 3/4" upper stud onto strut bracket as shown. Place 1/2" washer and nylock nut onto the upper stud. Note: The stud is stainless steel and the threads are soft. Take care to not over tighten the nut.

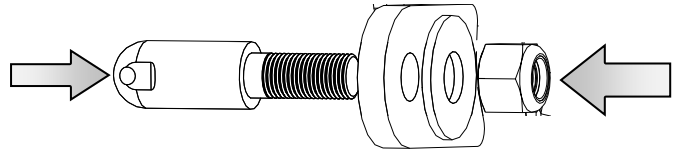

14

Slide the upper end of sway bar link onto the stud installed into strut. Place 3/4" washer on stud and insert Bow Tie Pin.

Note: This should be a tight fit for better sway bar function. Applying a bit of grease to the stud and bushing will help with install.

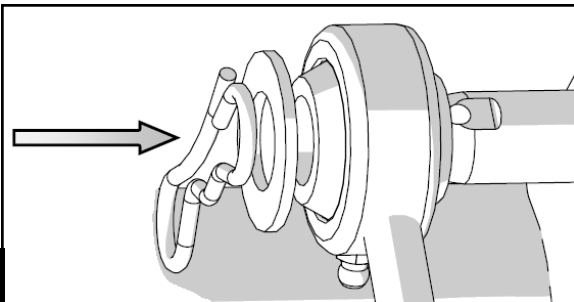

15

Trim fender liner as shown.



16

Use template cut out on second to last page of instructions to mark location for nutsert. Use a center punch to help center the drill bit when drilling. Drill a pilot hole in marked location. Drill hole out to 25/64".

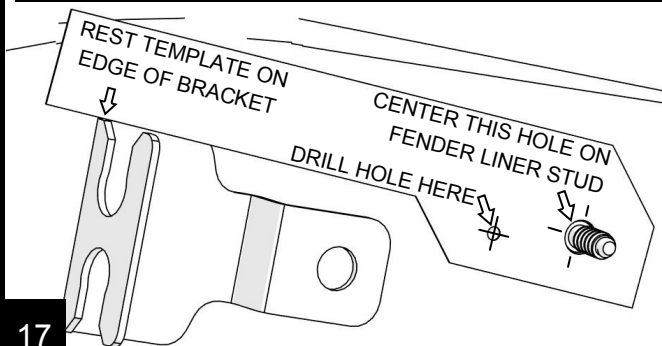

17

Paint the drilled hole to help prevent rust from forming. Use supplied nutsert tool to install nutsert. Install upper 5/8" park stud into nutsert as shown. Note: The stud is stainless steel and the threads are soft. Take care to not over tighten the park stud. Repeat steps for other side.

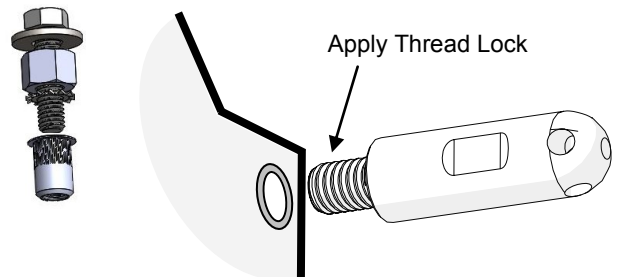

18

Reattach brake and ABS lines to strut.

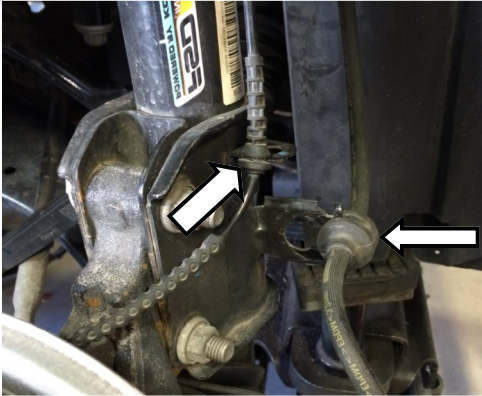

19

Before installing the wipers turn the key on with wiper switch in the off position. This will allow wiper motor to cycle back to it's off and down position. Other wise **damage may occur**. Reinstall cowl and windshield wipers.



20

Starting with the right rear side, remove the plastic inner fender. There are five Philips screws, one plastic nut and four 10mm nuts.



21

Disconnect the charcoal canister lines and remove the canister with a 10mm.

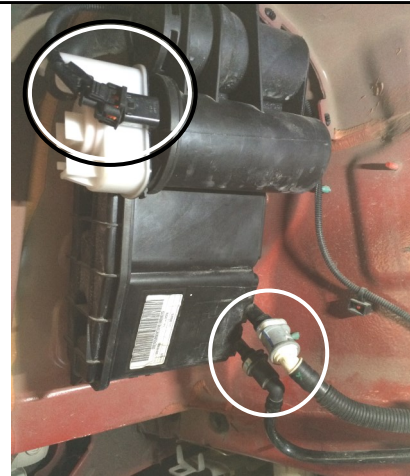

22

Disconnect the sway bar link from the strut with a T-40 Torx bit and an 18mm.



23

Loosen the unibody side lower control arm bolt with an E-20 Reverse Torx and a 17mm. Do not remove.



24

With an E-14 Reverse Torx, unbolt the lower control arm bracket from the frame.

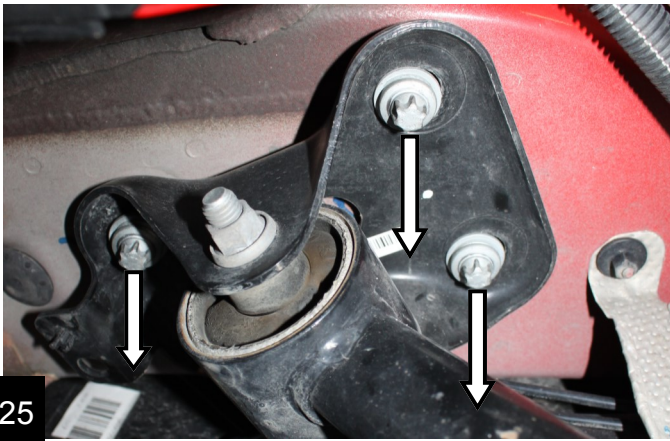

25

Install the spacers and four M10 x 55mm bolts (with loctite), M10 washers and 7/16" x 1.25" OD washers. Larger washer goes up against control arm bracket.

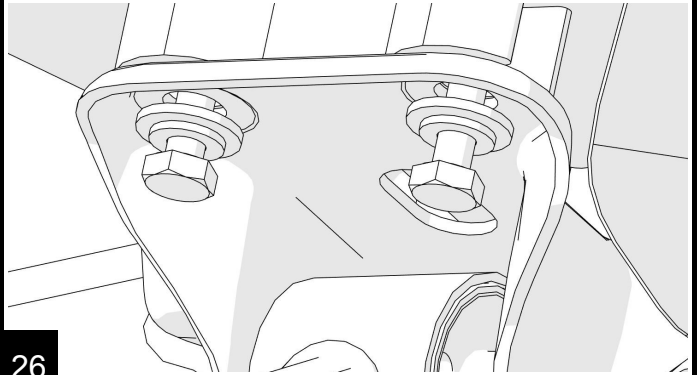

26

While tightening M10 bolts press the control arm bracket to the rear of the Jeep. *See illustration below*
With a 19mm torque bolts 75 ft-lbs.

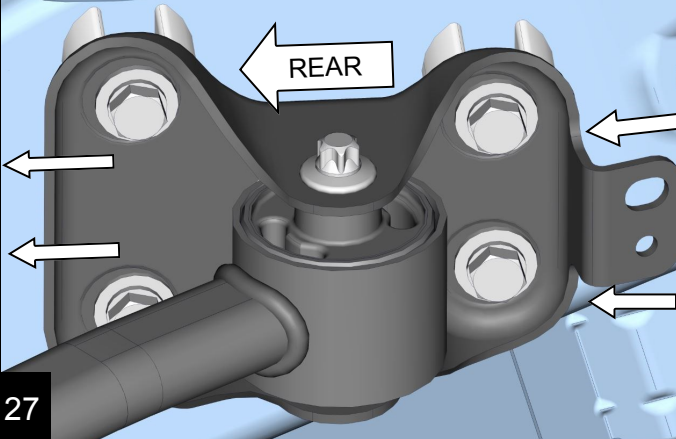

27

Remove the bolt supporting the exhaust bracket. Insert provided 1.00" spacers and install M8 X 50mm bolt with washer. Apply blue loctite and use a 13mm to tighten.



28

Remove the bolt supporting the brake/abs lines bracket. Insert provided 1.00" spacers and install M8 X 50mm bolt with washer. Apply blue loctite and use a 13mm to tighten.

Repeat steps 16-22 for the left side.



29

Support the lower sub-frame on a jack. Remove the 4 bolts with an E-20 Reverse Torx.



30

Lower the sub-frame enough to install 1.50" spacers. Install the supplied M14 x 150mm and **torque to 120 ft-lbs** with a 22mm.

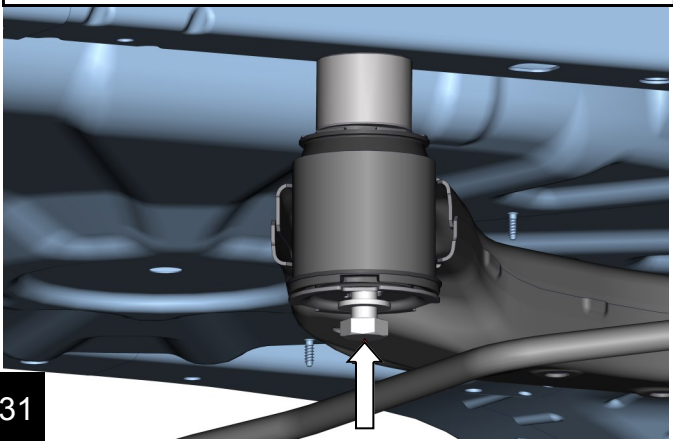

31

Loosen the 2 bolts supporting the driveline carrier bearing with a E-12 Reverse Torx. Apply blue loctite to two M10 X 45mm bolts. Remove one bolt, insert 0.75" spacers above support and install a M10 bolt with a washer. Repeat for other bolt and tighten new bolts with a 17mm.



32

Remove ABS line, e-brake cable and hydraulic brake line from passenger side knuckle.



33

With an E-16 Reverse Torx and a 16mm, remove the 2 bolts that attach the knuckle to the strut.



34

Remove the 3 upper bolts with an E-16 Reverse Torx and remove strut. Install spacer using 10M x 50mm Allen Bolts, **with blue loctite**, into recessed holes (no washers). With an 8mm allen **torque bolts to 70 ft-lbs**.

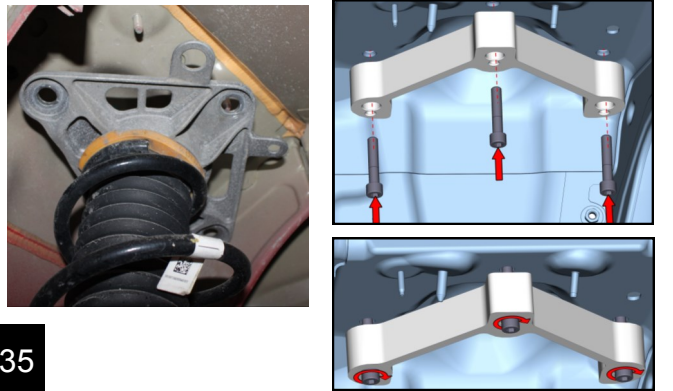

35

Re-install strut with factory hardware. ***No Loctite*** While tightening upper bolts press top of strut toward the center of the Jeep. This will help with alignment. **Torque upper strut bolts to 50 ft-lbs. Torque knuckle bolts to 90 ft-lbs.** Repeat steps 33-36 for the left side.



36

Install the upper charcoal canister bracket using the supplied M6 nut, oriented as shown, and tighten nut

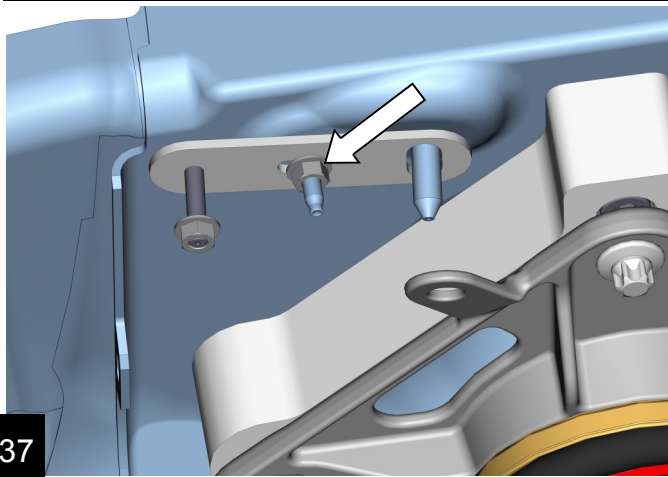

37

Install the lower charcoal canister bracket using the supplied M6 nut, oriented as shown, and tighten nuts.

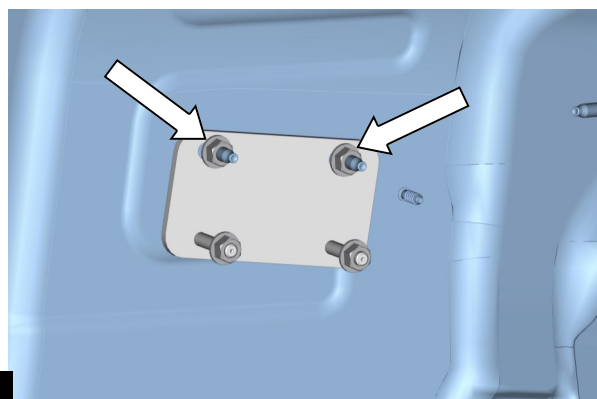

38

Mount the charcoal canister to the new brackets using factory hardware and tighten the nuts. Re-attach the lines.



39

Re-connect the sway bar links. **Torque to 59 ft-lbs.**



40

Reinstall the inner fenders.



41

Install the tires and torque lug bolts.
Lower Jeep to the ground.

Steel Wheels	63 ft-lbs	86 N-m
Aluminum Wheels	89 ft-lbs	120 N-m

42

With Jeep on the ground torque lower control arm bolts to 110 ft-lbs.

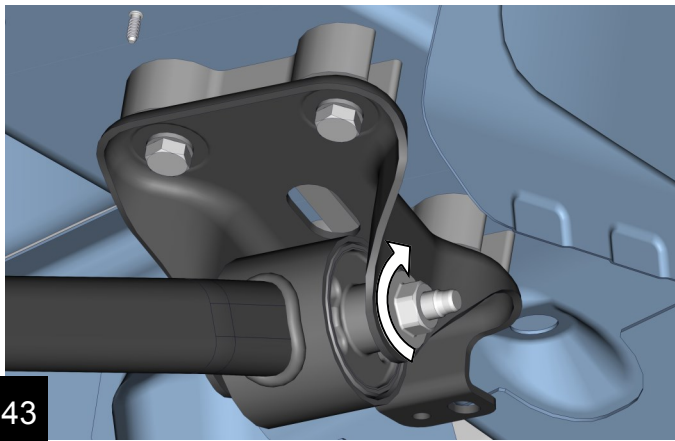

Check to make sure all bolts and nuts are torqued according to specification.

Jeep is safe to drive but **to avoid excessive tire wear an alignment is necessary** and needs to be done as soon as possible.

Note: Re-torque all components after 100 miles and inspect every 3000 miles after that.

CUT OUT TEMPLATE



REST TEMPLATE ON
EDGE OF BRACKET



CENTER THIS HOLE ON
FENDER LINER STUD

DRILL HOLE HERE

