

Installation Instructions

T-Connector



Honda Odyssey

⚠ WARNING



ALWAYS read and follow all warnings and instructions included with purchase before beginning installation. Keep for future reference.

DO NOT exceed lower of towing manufacturing rating (including in your vehicle owner's manual) or specific amperage ratings stated on product.

ALWAYS read, understand and follow all warnings and instructions printed on tow vehicle's battery.

ALWAYS wear safety glasses and use all safety precautions during installation.

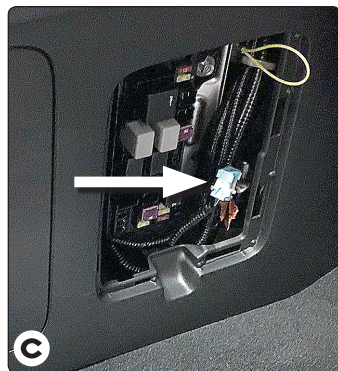
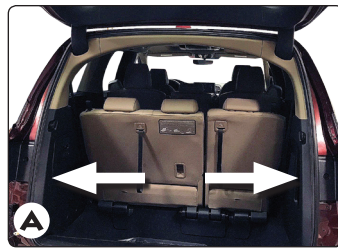

D

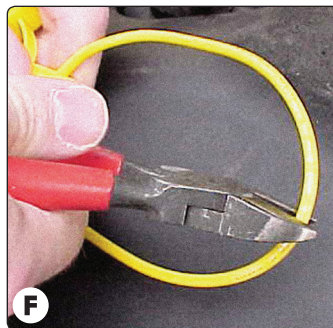
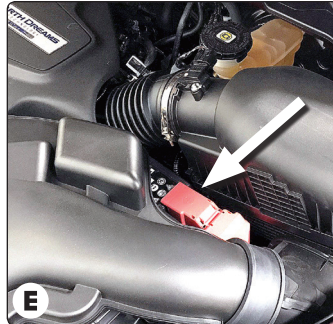
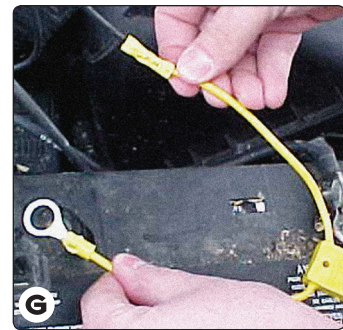
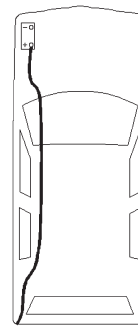

TOOLS REQUIRED:

Trim Panel Remover, 10mm Socket & Ratchet or 10mm Wrench, Drill (3/32" Drill Bit), 1/4" Socket, Wire Crimpers, Wire Cutters, Philips Head Screwdriver, Test-probe

1. Open rear hatch and push forward the rear seat. Temporarily remove the vehicle's access panel on the passenger side to gain access to the vehicle's trailer wiring harness (A, B).
2. Locate the blue tow plug by opening the access panel inside of the storage compartment, which is taped to the vehicle wiring harness. Insert the tow plug into the connector. Be careful not to damage the locking tabs and be sure that connectors are fully inserted with locking tabs in place (C).
3. Locate a suitable grounding point near the connector such as the vehicle's frame or crossmember. (Do not drill into vehicle floor or bed.) Clean dirt and rustproofing from area. Drill a 3/32" hole and secure **white** wire using eyelet and screw provided.

⚠ CAUTION

Verify what is behind any surface prior to drilling to avoid damage to the vehicle and/or personal injury. Do not drill into any exposed surfaces.

4. On the driver's side, mount the T-Connector black box using the double-sided tape provided. Secure the remainder of the T-Connector harness with the cable ties provided, to prevent damage or rattling and being careful to avoid any areas that would cut or pinch the wire.

5. On the driver's side, locate the **black** 12 ga. Power wire from the T-Connector box. Attach the **black** 12 ga. wire provided. Route the **black** wire along the exterior frame or follow the existing wiring along the thresholds into the engine compartment up to the battery avoiding areas that may pinch or break the wire (D).

⚠ WARNING

If routing the wire thru a grommet and along the exterior of the vehicle, be careful to avoid any hot pipes, heat shields, the fuel tank or any other points that may pinch or break the wire.

6. Disconnect the vehicle's negative (-) battery cable. If not removed, remove the fuse from the yellow fuse holder (provided) (E). After cutting the fuse holder wire (F), attach the ring terminal and secure to the vehicle's positive (+) battery cable. Connect the other end of the fuse holder to the **black** 12 ga. wire, using the yellow butt connector (provided) (G).

⚠ WARNING

Read and follow all warnings and cautions printed on the tow vehicle's battery.

7. Reconnect the vehicle's Negative (-) battery cable and install the 15 amp fuse into the fuse holder from step 8.

⚠ WARNING

All connections must be complete for the T-One® T-Connector to function properly. Test and verify installation with a test light or trailer once installed. For initial test, reset vehicle electrical system by temporarily removing the key from the ignition.

8. Secure the remainder of the T-One® T-Connector harness with the cable ties provided, to prevent damage or rattling and being careful to avoid any areas that would pinch, cut or melt the wire.
9. Near the access panel, push trim panel out slightly to route the 4-Flat to the cargo area by routing out and underneath the trim panel (H).

NOTE

Store 4-Flat in rear cargo area when not in use.



⚠ WARNING

Overloading circuits can cause fires. **DO NOT** exceed stated product ratings. Read vehicle's owner's manual & instruction sheet for additional information.