

advanced FLOW engineering Stage-2 Cold Air Intake System

Instruction Manual P/N: 56-70023D / 56-70023R

Make: Honda Model: CR-V Year: 2017-2020 Engine: I4-1.5L Turbo



- Please read the entire instruction manual before proceeding.
- Ensure all components listed are present.
- Ensure you have all necessary tools before proceeding.
- Do not attempt to work on your vehicle when the engine is hot.
- Retain factory parts for future use.

Label	Qty.	Description	Part Number
A1	1	Air Filter (Pro 5R)	24-91103
A2	1	Air Filter (Pro DRY S)	21-91103
B	1	Tube	05-T1026B1
C	1	Housing	05-5610023B2
D	1	Coupling, Silicone Reducer: (2-3/8X2-1/2)"ID x 2-1/2"L	05-01410
E	2	Clamp, 044 (2-5/16"- 3-1/4")	03-50019
F	2	Screw, Torx: M4	05-50491
G	2	Retainerr Clip	05-01407

Installation will require the following tools:

T-20 Torx driver, 8mm nut driver, small flat-head screwdriver, Philips screwdriver, 10mm deep socket, extension and ratchet.

Emissions Disclaimer: This product is not currently CARB exempt and is not available for purchase in California or for use on any vehicle registered with the California Department of Motor Vehicles

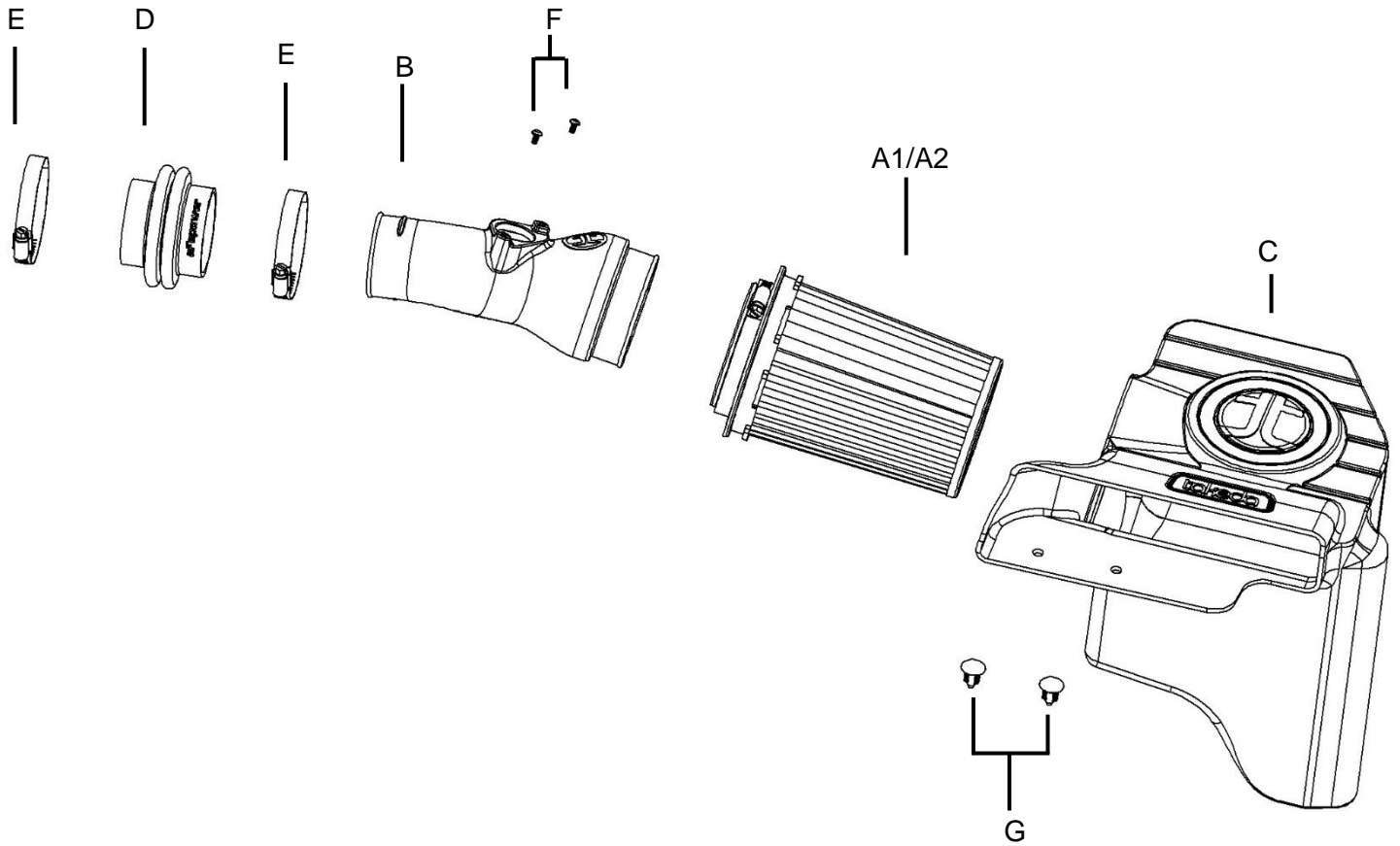



Refer to Figure A for Steps 1-4

Step 1: Disconnect the Mass Air Flow (MAF) sensor harness (1), Unclip the harness holder and release from the factory air box (2).

Step 2: Loosen the clamp on the factory intake tube connecting to the turbo inlet tube (3)

Step 3: Remove the two 10mm (4) screws retaining the factory housing.

Step 4: With an upward motion remove the factory intake system out of the vehicle.

**Figure B****Refer to Figure B for Step 5-6**

Step 5: Transfer the factory grommet from the factory intake system to the Takeda housing with the metal inserts (5).

Step 6: Transfer the factory pop grommet (6).



Figure C

Refer to Figure C for Step 7-8

Step 7: Install the coupling onto the turbo inlet with clamps, assure the smaller end goes on the turbo inlet side (7). Do not tighten clamps at this time.

Step 8: Install the Takeda housing into the vehicle by locating it on the push grommet mount, securing it with the factory screw (8) along with the supplied push clips (9).

**Figure D****Refer to Figure D for Step 9**

Step 9: Slide the Takeda Air filter into the Takeda housing, assure the filter tabs are locked on the housing **10** .

**Figure E****Refer to Figure E for Step 10**

Step 10: Transfer the MAF sensor from the factory housing to the Takeda intake tube. Secure it with the M4 screws provided.



Refer to Figure F for Step 11-13

Step 11: Slide the intake tube into the coupling then into the air filter. Align coupling, tube and air filter then tighten all clamps.

Step 12: Re-connect MAF sensor harness.

Step 13: Make sure all clamps and connections are secured. Your installation is now completed.

NOTE: Check all bolts, clamps and connectors after 100-200 miles.



Pro DRY S Air Filter



P/N: 21-91103

Pro 5R Air Filter



P/N: 24-91103

Pre-Filter



P/N: 28-10083

Blue Squeeze Restore Kit



P/N: 90-50501

Pro DRY S Restore Kit



P/N: 90-59999