



INSTALLATION INSTRUCTIONS

Axle-Back Exhaust

MAKE: Hyundai
MODEL: Veloster Turbo
YEAR: 2019-2020
ENGINE: L4-1.6L

49-37012-P
49-37012-B
49-37012-L
49-37012-C

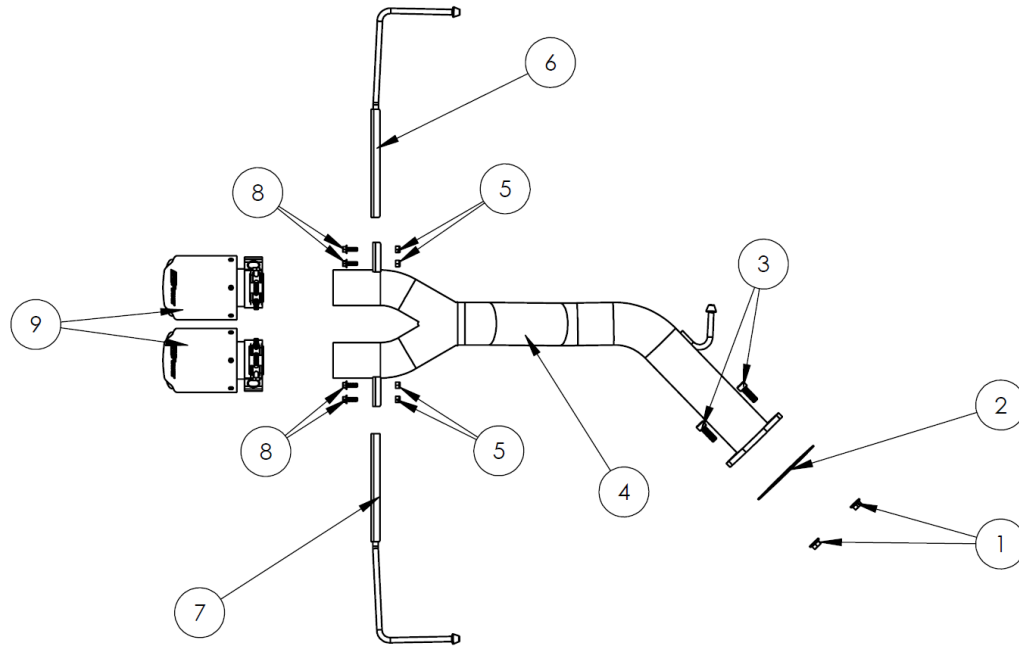

Item	Description	Part Number	Quantity
1	M10 Nut	03-50189	2
2	Gasket	05-46300	1
3	10mm Hex Head Cap Bolt	03-50452	2
4	Axle-Back Assembly	05-145899	1
5	1/4-20 Nylon Insert Locknut	03-50073	4
6	Bracket Assembly, PS	05-46435	1
7	Bracket Assembly, DS	05-46436	1
8	1/4-20 Serrated Hex Flange Screw	03-50100	4
9	4-1/2" Polished Clamp on Tips	49T25454-P07	2
	4-1/2" Black Clamp on Tips	49T25454-B07	
	4-1/2" Blue Flame Clamp on Tips	49T25454-L07	
	4-1/2" Carbon Clamp on Tips	49T25454-C07	

aFe POWER recommends professional installation on this product. Thoroughly inspect the aFe POWER exhaust system to make sure there is no damage from shipping (if damage is noted, immediately contact aFe POWER customer service). Allow time for your vehicle to cool down prior to installation. When working on your vehicle proceed with caution. Wear protective safety equipment; eye goggles and gloves to ensure a safe installation.

Install band clamps to proper torque specifications of 40-45 ft-lb.



INSTALLATION INSTRUCTIONS

Axle-Back Exhaust

MAKE: Hyundai
MODEL: Veloster Turbo
YEAR: 2019-2020
ENGINE: L4-1.6L

49-37012-P
49-37012-B
49-37012-L
49-37012-C

1. **(Read instructions prior to installation.)** It is recommended to not fully tighten the exhaust until it has been fully installed. Leave loose for adjustability.
2. Secure vehicle on jack stands (refer to your manual for specified jack stand positions).
3. For faster installation, spread out the parts of the exhaust alongside your vehicle as shown in the diagram above.
4. Secure the stock exhaust with jack/stands.
5. Remove the stock axle back exhaust by unbolting it from the first flanged joint and removing it from the stock rubber isolation mounts.
6. Using the provided (x2) 10mm bolts, (x2) M10 nuts, and gasket, install the Takeda Axle-Back Assembly and slide hanger into the rubber isolation mount.
7. Install the driver and passenger side hanger bracket assemblies onto the Takeda Axle-Back Assembly using the supplied ¼-20 hardware.
8. Install the clamp on tips and adjust to your liking, but do not tighten.
9. Ensure that all the components of the Takeda exhaust system are aligned and are at a safe clearance from all wires, hoses, brake lines, body parts, and tires.
10. Start from the front of the Takeda exhaust system and evenly tighten all clamps and fasteners.
11. Start the vehicle and check for any leaks. If any leaks are found, determine cause and repair as necessary.
12. Remove vehicle from jacks stands.
13. It is recommended to re-tighten all clamps and hardware after 50-100 miles.



Learn more about performance exhaust systems we have.