

START HERE The ZROADZ Series Grilles comes into 2 different configurations. One style features the LED Light Bar mounting hidden on the backside, while the other style has exposed mounting provisions on the face side of the grille. Please note this and identify your ZROADZ Grille Series configuration and follow the instruction version that corresponds with your grille.

GRILLE CONFIGURATION STYLE 1

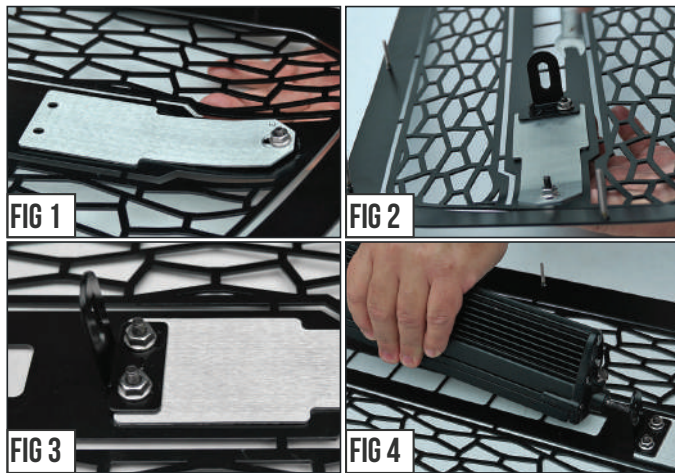

STEP 1 Lay out your parts. From the backside of the grille, put into place the ZROADZ Logo Backing Plate.



STEP 2 Put into place one of the Bracket Tabs and secure with provided Hardware as seen in Fig. # 2-4 and then from the backside of grille position LED Light Bar.

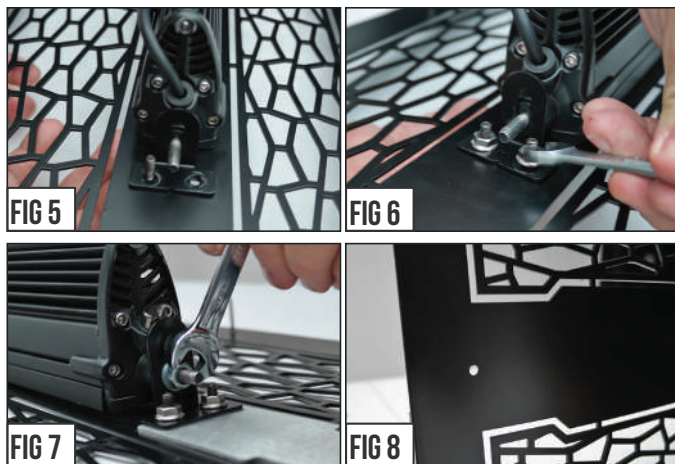

STEP 3 With LED Light placement set, put into position the remaining bracket and the finally tighten LED and all Mounting Brackets into their final secured position.

GRILLE CONFIGURATION STYLE 2



STEP 1 Lay out your parts. From the backside of the grille, put into place the ZROADZ Logo Backing Plate.

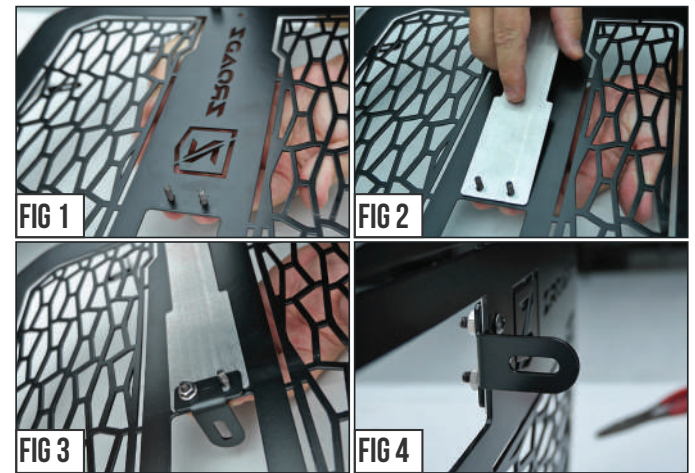

STEP 2 Put into place one of the Bracket Tabs and secure with provided Hardware as seen in Fig. # 1-4.

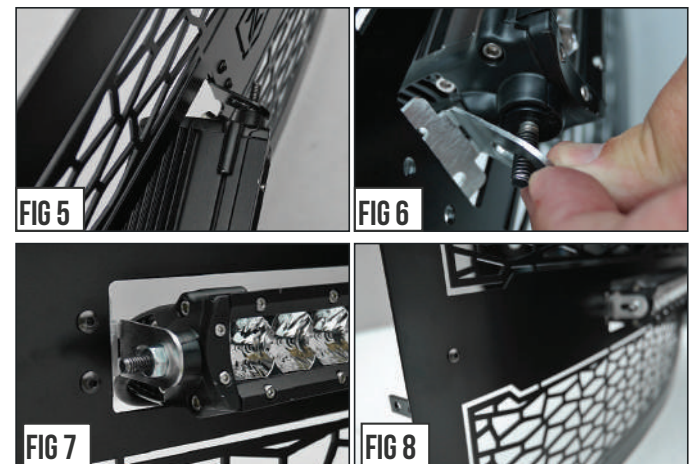

STEP 3 From the face side of grille slip the LED Light bar into place. On the opposite side, position the remaining bracket and finally tighten LED and Brackets into position.

STEP 4 There is a final step for both styles of ZROADZ Grilles. See both of the Figure #8 Images and note that there is an exposed hole. Use the Provided Hardware Button Head Screw and fill the hole and tightened down with Nut. This will create symmetrical look from side to side.

GRILLE ASSEMBLY - COMPLETE

Z314831-10C
Z314831-10T
Z314831-20T



Z314831-10C
Z314831-10T
Z314831-20T

**07-16 JEEP
WRANGLER**

**07-16 JEEP
WRANGLER**

07-16 JEEP WRANGLER
ZROADZ Series Main Grille 1 Pc.
For off-road use only

Tools Required:

Phillip/ Slotted Screwdriver
Needle Nose Pliers
8mm Socket
Die Grinder/Cut off Wheel

Hardware / Parts List:

1 Grille
7 1/2" x 135 L Brackets
7 6-32 Nylon Lock Nuts

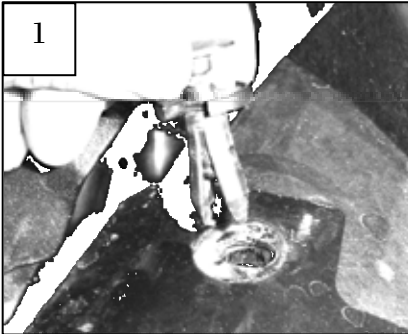

Step 1

Read and understand all instructions before attempting the install of this grille. Be sure that the package of hardware matches the hardware list as listed above. Next, test fit the T-REX grille to the vehicles factory openings. You are now ready for the install:

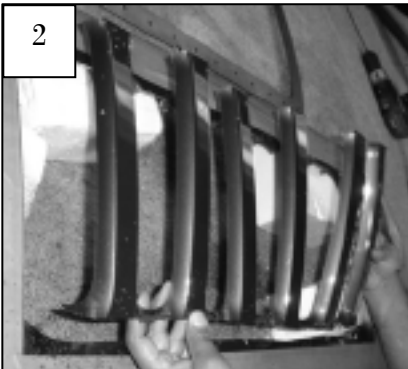

Step 2

Using the needle nose pliers; unclip the harness to the factory turn signals. These can be accessed through the wheel wells. Remove the upper factory pop clips holding the grille to the vehicles core support (1). By pulling on the bottom center of the grille; this will release the four lower grille clips. Remove the grille from the vehicle and place on a soft surface to prevent damaging your factory grille.

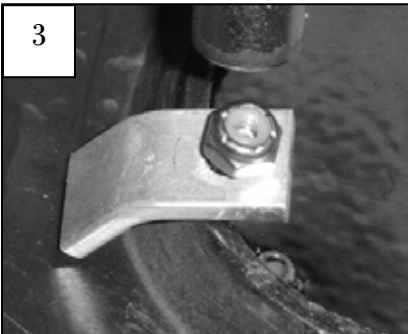

Step 3

If the grille is equipped with a one piece factory mesh; remove the mesh by removing the screws and U clips on the bottom of the grille. Cut the center vertical bars from the grille shell (2). Sand the edges of your cut marks till smooth. Check your grille insert in the shell. Trim the necessary areas for the insert to fit properly. From the backside of the grille; place an L bracket and nylon lock nut on each stud (3). With the grille centered; tighten all of the hardware.

Step 4

Replace the grille and all hardware. Reconnect the fog lights. Make sure all hardware is secure.

Thank you for purchasing your T-Rex grille.