

T-REX

Billet Grilles

54825

08-09 SATURN

VUE

54825

08-09 SATURN

VUE

SATURN VUE

UPPER CLASS SERIES MESH GRILLE

Tools Required:

Small Slotted Screwdriver
8mm Socket or Nut Driver
1/8" Drill & Drill Bit

Part List:

1	Upper Class Grille	1	Custom Hood Release
5	6-32 Nylon Lock Nuts	1	#6 Washer
4	135 Flange Bracket		
1	6/32x 1/2 Machine Screws		

Read and understand instructions before attempting installation

Step 1

Remove the retaining clips from the top of the plastic engine cover to gain access to the rear of the grille. Locate the center of the factory hood pop latch. Mark the center of the square finger hood pop and drill a 1/8" hole (1).

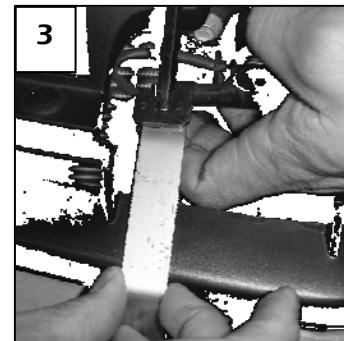
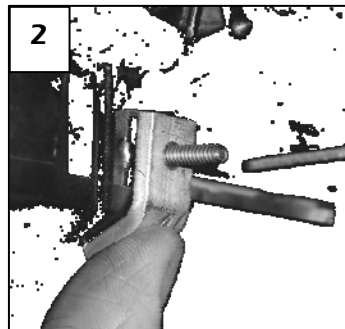
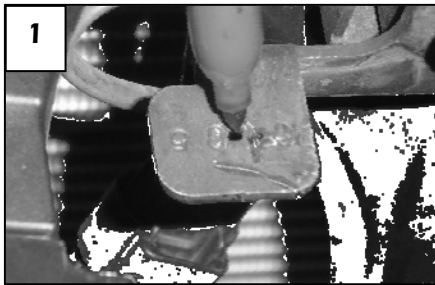

Step 2

Center the grille into the opening. From the rear of the grille; use the provided angle brackets and nylon nuts. Make sure the brackets hold to the factory grille (2). DO NOT OVERTIGHTEN. Install the new hood latch extension. Place the new extension on the bottom side of the factory hood release. While holding the extension in place; place the machine screw through factory hood latch, into the new extension and into the provided washer and nylon lock nut (3). Tighten the hardware.

Thank you for purchasing a T-Rex Billet Grille. 01/28/08