

INSTRUCTIONS

80515 Expanse Cargo Rack / Porte-bagages
Page 1 | 4



TOOLS / OUTILS



NO.	DESCRIPTION	QTY
1	2" RISER HITCH BAR	1
2	LEFT FRAME	1
3	RIGHT FRAME	1
4	CONNECTOR PLATE	2
5	M10X1.5 NYLOC NUT	2
6	M10X1.5X70 BOLT	2
7	M6X1 NYLOC NUT	8
8	M6X1X30 BUTTON HEAD CAP SCREW	4
9	M6X1X10 BUTTON HEAD CAP SCREW	4
10	5/8" THREADED HITCH PIN	1
11	COTTER PIN	1

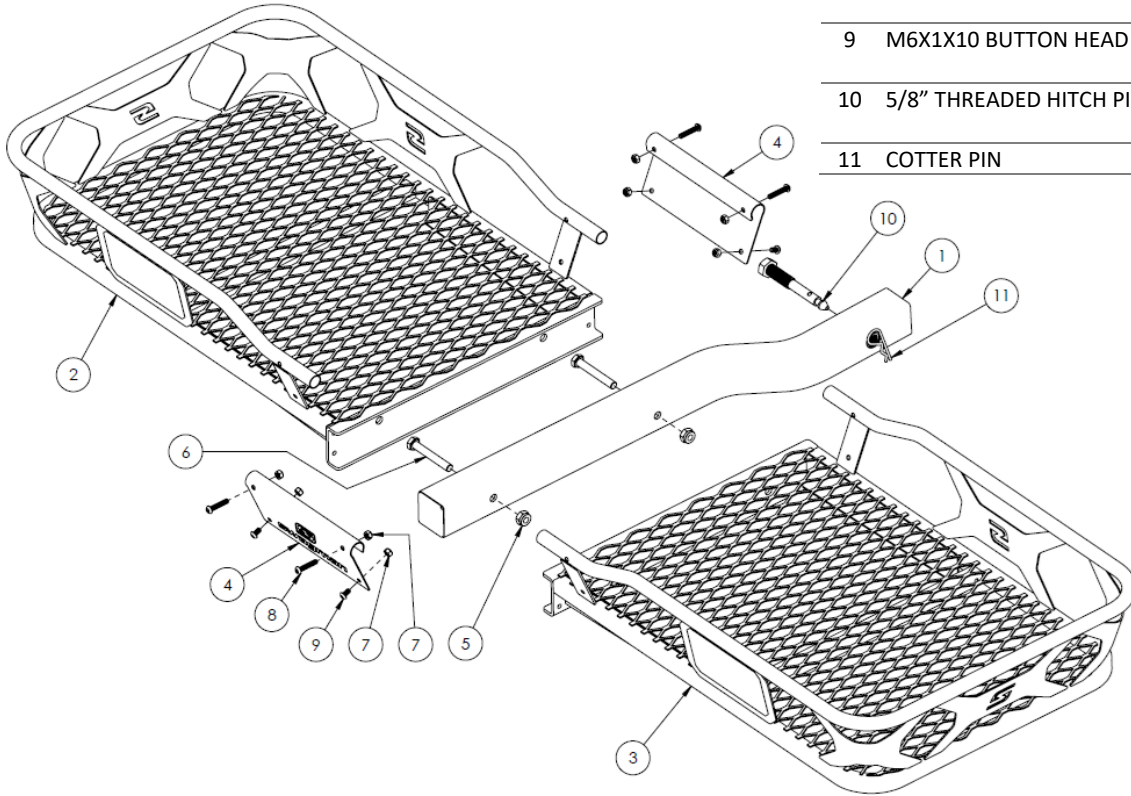

ASSEMBLY

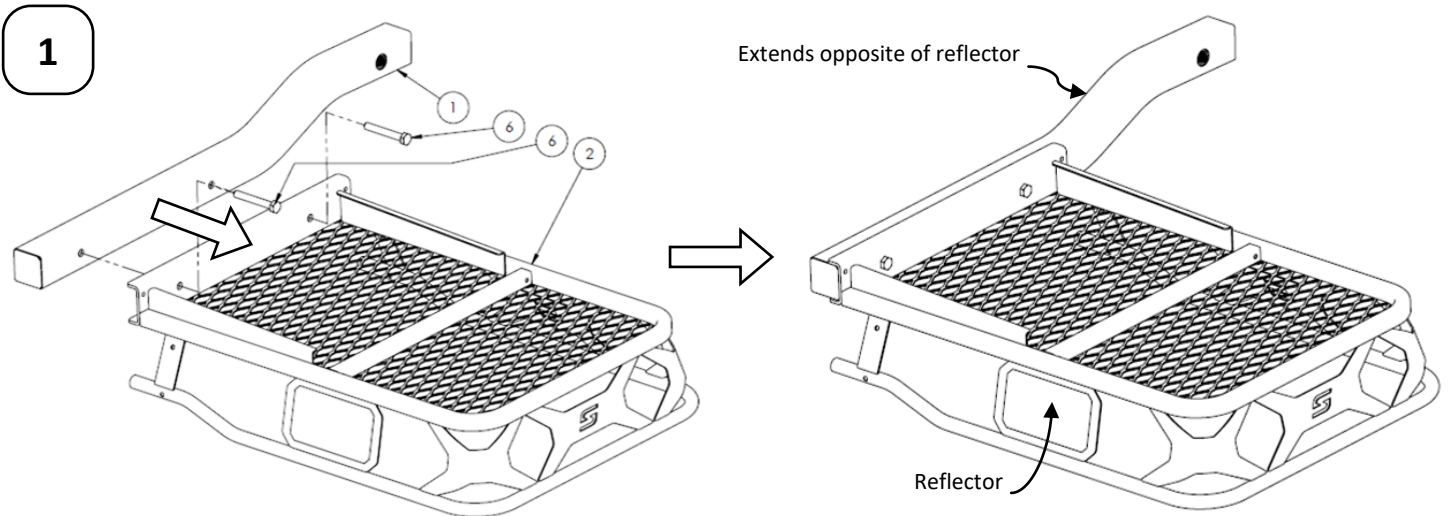

INSTRUCTIONS

80515 Expanse Cargo Rack / Porte-bagages
Page 2 | 4



2

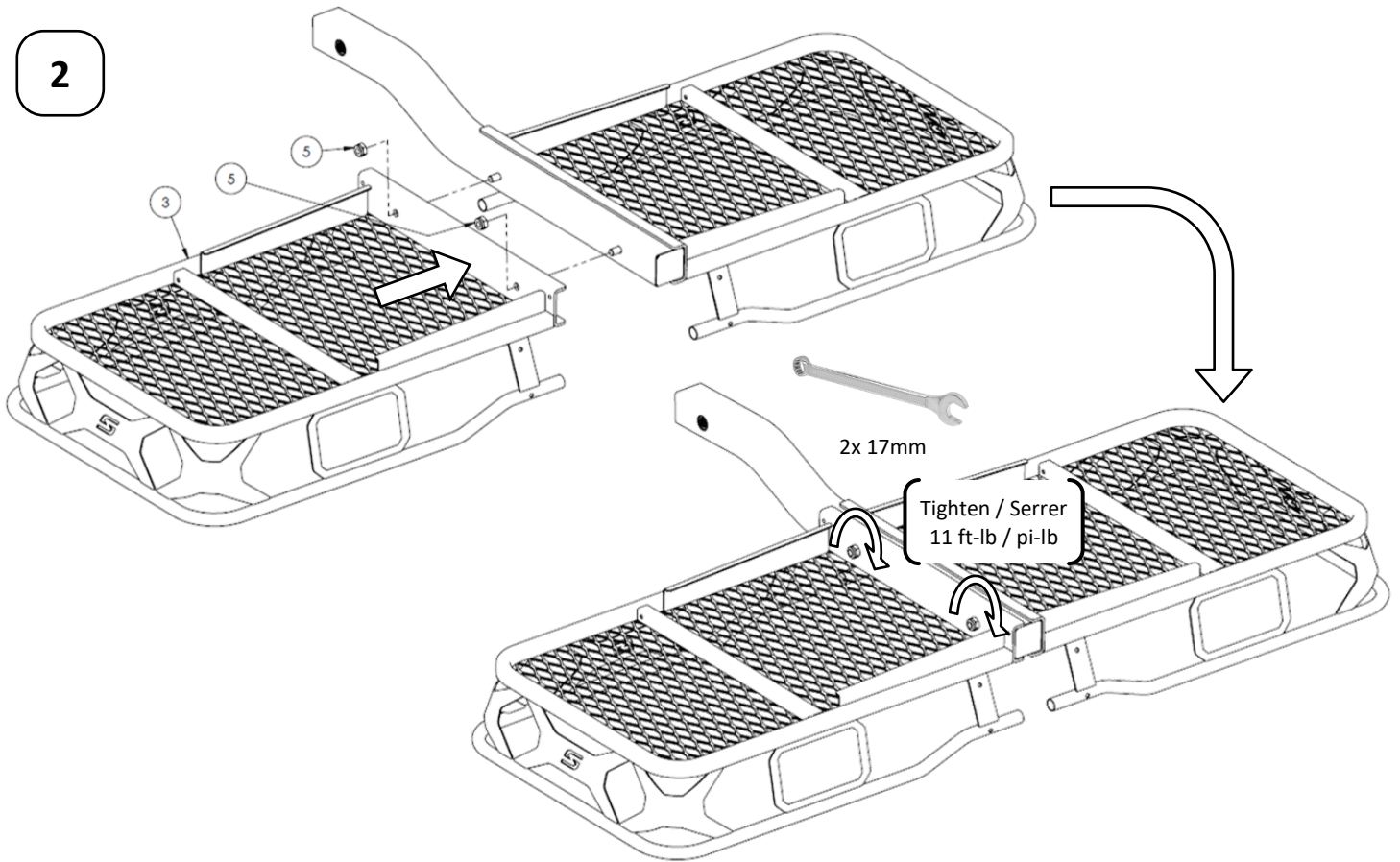

3

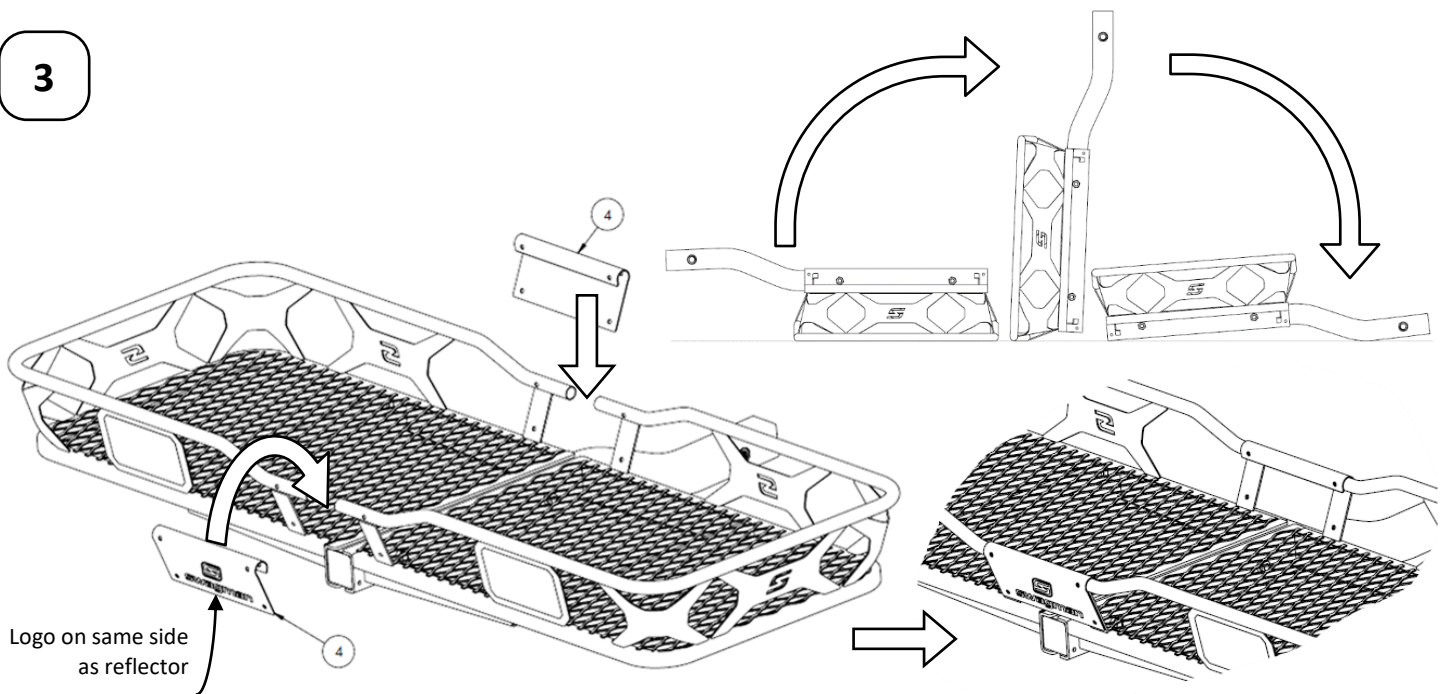

INSTRUCTIONS

80515 Expanse Cargo Rack
Page 3 | 4

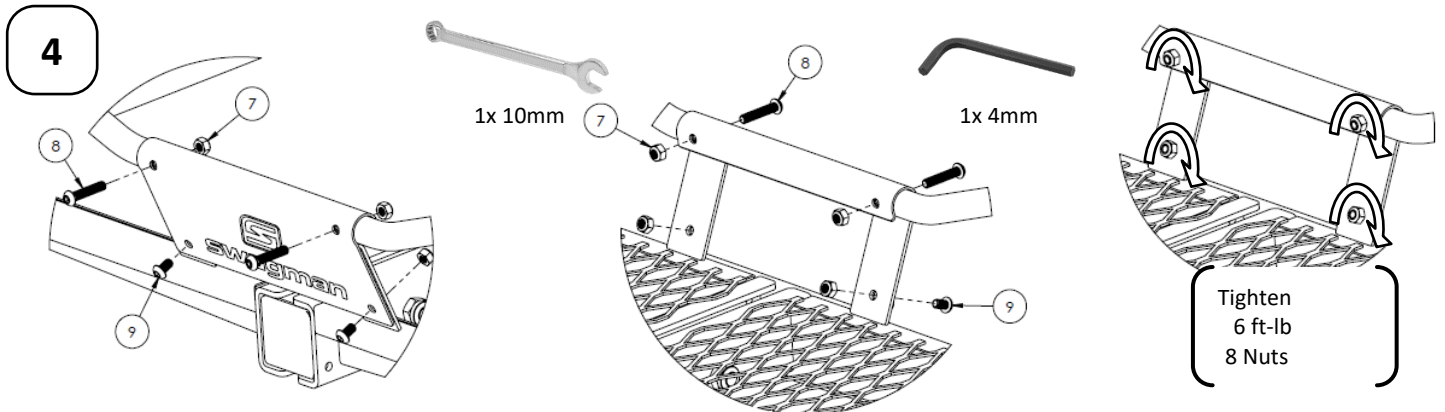

VEHICLE INSTALLATION

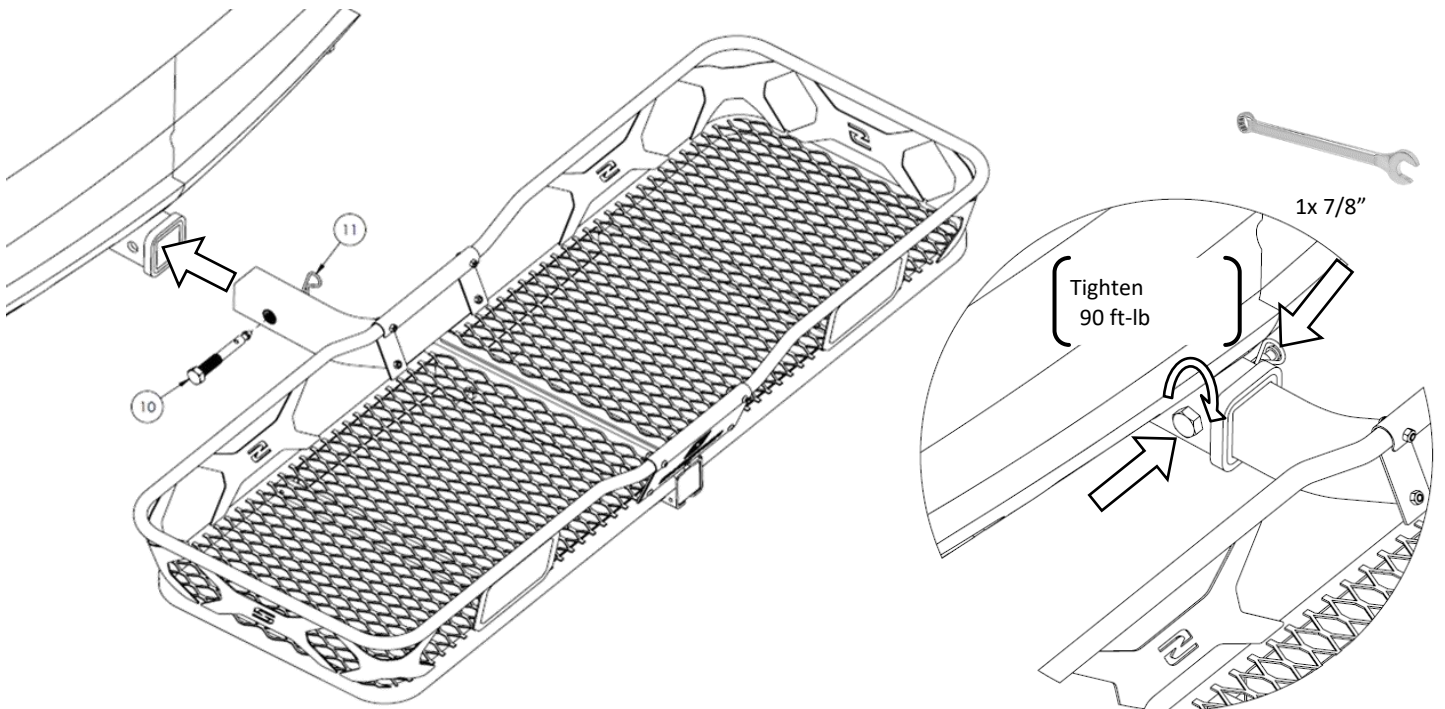

LOADING

- ⚠ DO NOT EXCEED MAXIMUM CAPACITY OF 400 LB
- Do not transport people or animals with the cargo rack.
- Do not carry loads wider or longer than the rack platform.
- Distribute load equally across width of the rack.
- Load heavier items on the bottom of the rack and stack lighter items on top.
- Load heavier items towards the middle and front of the rack (closest to the vehicle).
- Load lighter items towards the outside and rear of the rack (furthest from the vehicle).
- Avoid stacking the load too high. As a general guideline, the height should not exceed 1.5x the depth of the rack, or approximately 30".

INSTRUCTIONS

80515 Expanse Cargo Rack / Porte-bagages
Page 4 | 4



- Secure the load to the top round bar of cargo rack using appropriately rated cargo tie down straps or cargo net.
- Test the load's security by shaking the rack. Tighten or adjust until the load until the load is secure.
- Tighten and secure the load if it shifts during transport.
- Keep plastics, rubber, and other heat sensitive materials at least 6" away from the exhaust pipes of the vehicle. The high temperature exhaust exiting the exhaust pipes can melt or damage these materials.
- The cargo rack should also be kept away from the direct exhaust flow.

IMPORTANT NOTES

- This cargo rack has been designed to carry 400 lb maximum.
- This rack is designed for typical use and applications (on paved or smooth gravel roads). Do not use this rack on rough roads or where the rack (and load) will be subject to significant or constant jarring or shock, or any vehicle with very stiff springs that will directly transfer to the rack and load.
- Proper fitting and installation of this carrier to your vehicle is critical and is not the manufacturer's responsibility.
- Improper use of this product may result in damage to your rack, your vehicle, your load, or even other vehicles driving behind you because of colliding with or trying to avoid a fallen load and/or the rack.
- The purchaser should be aware that the load created by a rack and load can exceed the maximum rating on the hitch or bumper.
- Swagman racks are powder coated to help prevent rust. When leaving them outside for extended periods of time the finish will lose its luster. Keep the rack indoors when not in use.
- Add padding to any area of the load that may touch the vehicle. Damage can and will happen to your load and/or vehicle if care is not taken during the loading and transporting of your load.
- Racks loaded with large and/or tall equipment will greatly increase the wind resistance and therefore the pressure on the rack and all vehicle mounting points. Reducing vehicle speed will reduce the chance of any problems occurring because of this situation.
- After reading this manual, should you have any additional questions regarding the compatibility, fitting, and/or use of this rack, please call your nearest Swagman authorized retail dealer or Swagman Customer Service.

