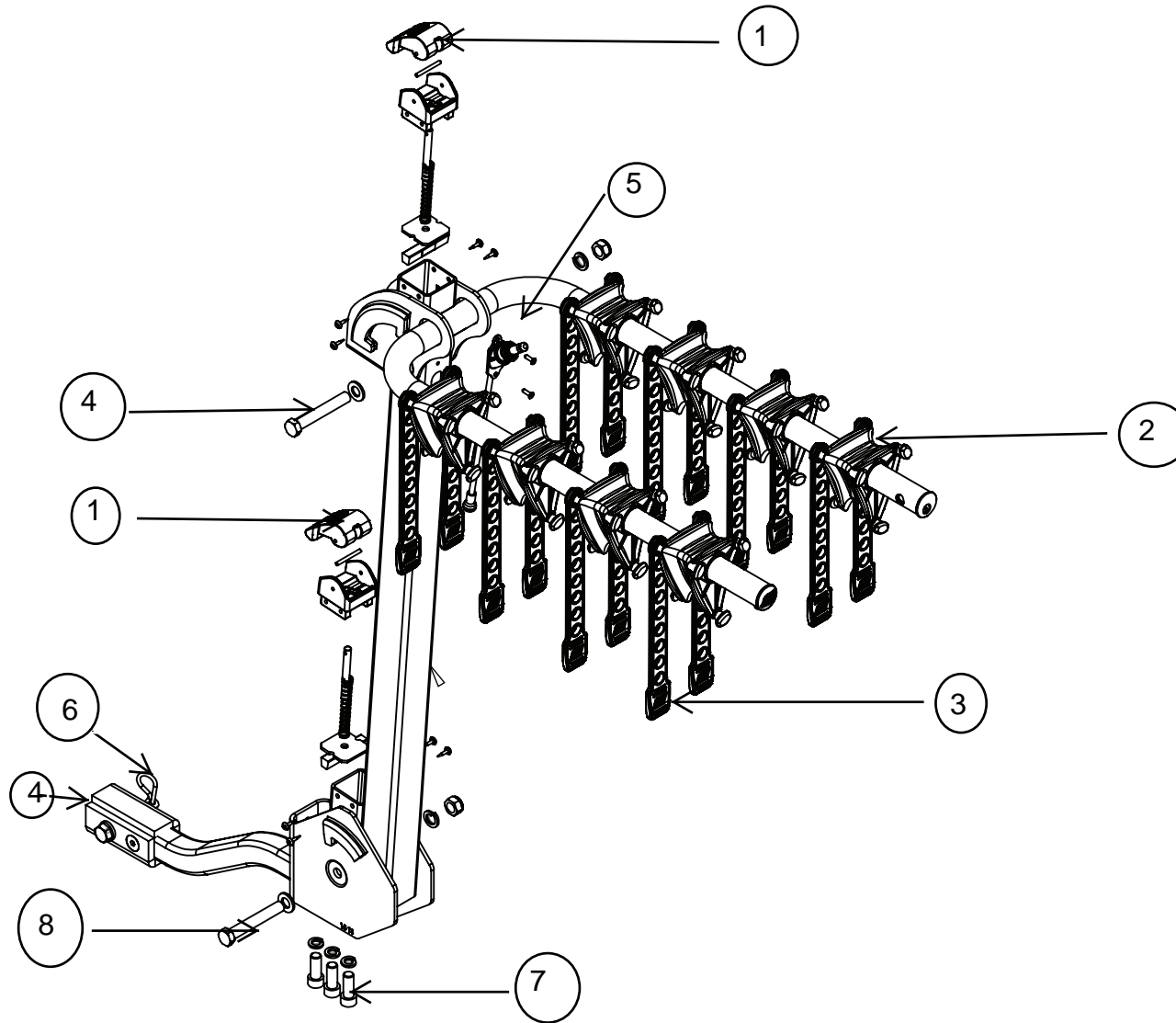

Bike Racks

- 1- Cam Lever
- 2- P350 Titan anti-sway cradle and two straps
- 3- P482 Titan replacement strap
- 4- P323 "L" bracket
- 5- 8mm Locking security cable
- 6- 5902 1/2" threaded hitch pin
- 7- 10mm Allen M10
- 8- 8mm Allen M6