

## Bike Racks

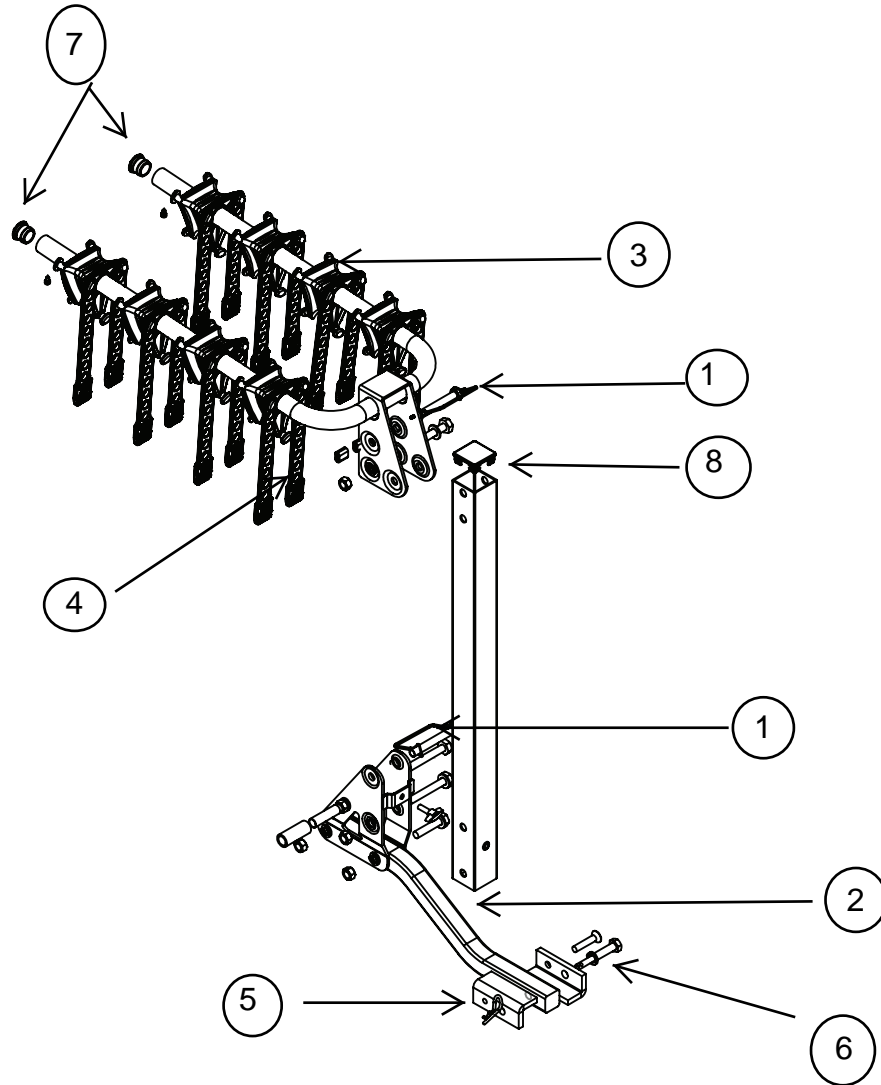

- 1- P322 Long Folding Pin
- 2- P355 Trailhead 2" x 1 1/4" receiver bar
- 3- P350 Trailhead anti-sway cradle and two straps
- 4- P482 Trailhead replacment strap
- 5- P323 "L" bracket
- 6- 5902 1/2" threaded hitch pin
- 7- End Cap
- 8- Upright Bar End Cap