

**A** SLIDE APPROPRIATELY SIZED FREEDOM PANELS FROM THE OUTSIDE INTO THE FREEDOM PANEL HOLDER BRACKETS.

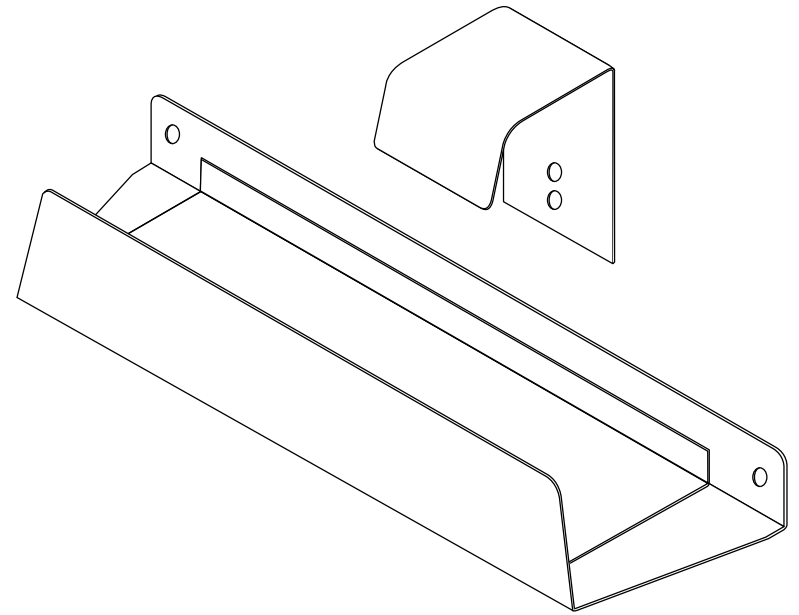
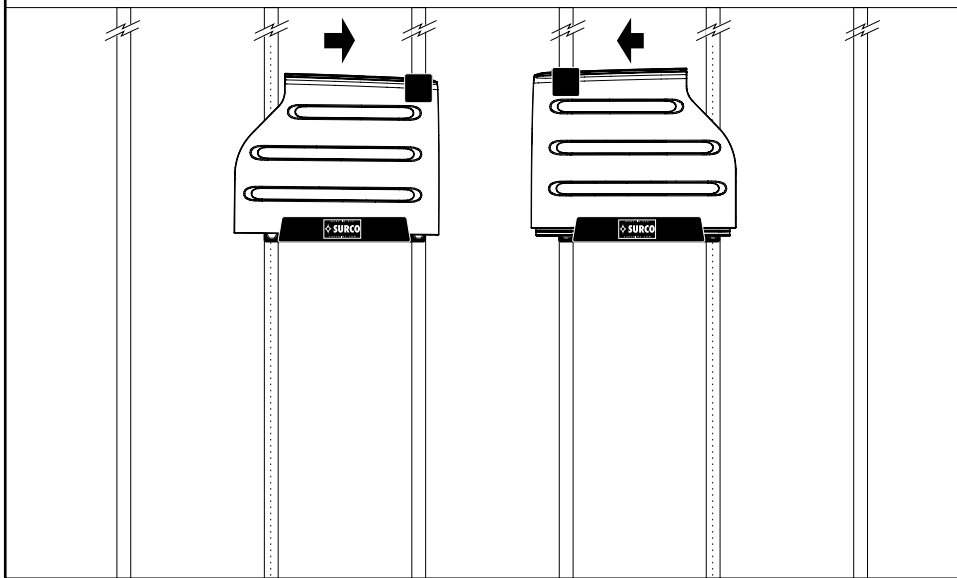

## FREEDOM PANEL HOLDER BRACKET

FOR JEEP WRANGLER, YJ, TJ, JK, AND JL WITH ORIGINAL EQUIPMENT DOORS.

CAREFULLY READ ALL INSTRUCTIONS BEFORE PROCEEDING WITH ASSEMBLY/USE. THIS PRODUCT IS DESIGNED TO BE MOUNTED TO A WALL THAT HAS STUDS SPACED 16" ON CENTER. DUE TO DIFFERENCES IN BUILDING MATERIALS, MOUNTING HARDWARE IS NOT SUPPLIED. FAILURE TO SECURE PRODUCT TO STUDS CAN RESULT IN DAMAGE TO PRODUCT, PROPERTY, OR SERIOUS INJURY.



**1** USING A STUD FINDER, LOCATE THE STUDS ON YOUR INSTALLATION WALL. FOR PROPER MOUNTING, STUDS SHOULD BE 16" ON CENTER.

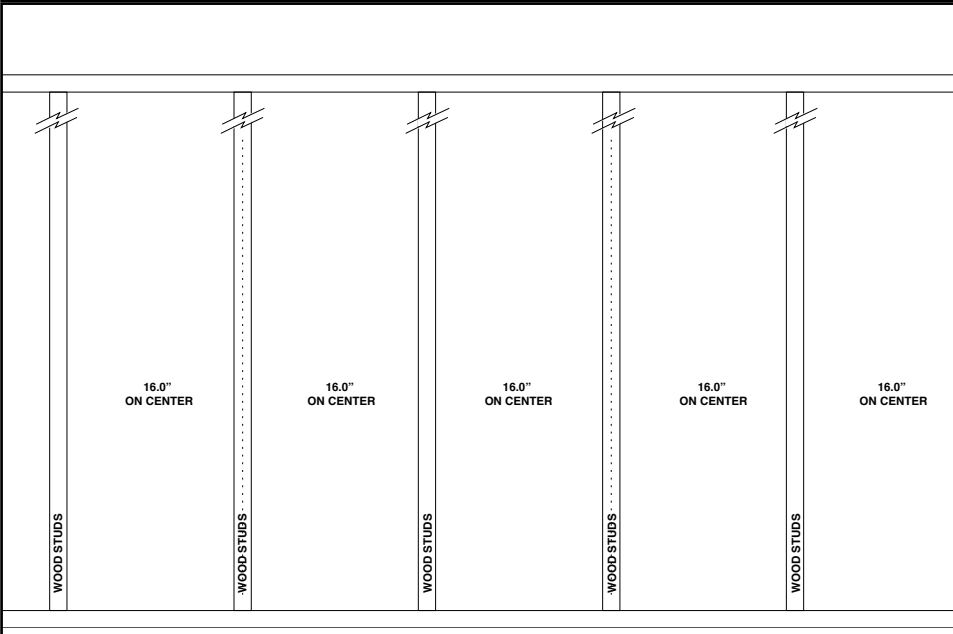

**3** POSITION AND MARK THE APPROPRIATE MOUNTING POSITION. USE THE BRACKET FOR REFERENCE AND DRILL TWO 1/4" PILOT HOLES IN THE CENTER OF EACH STUD. MAKE SURE PILOT HOLES ARE AT LEAST 2" INTO THE STUD.

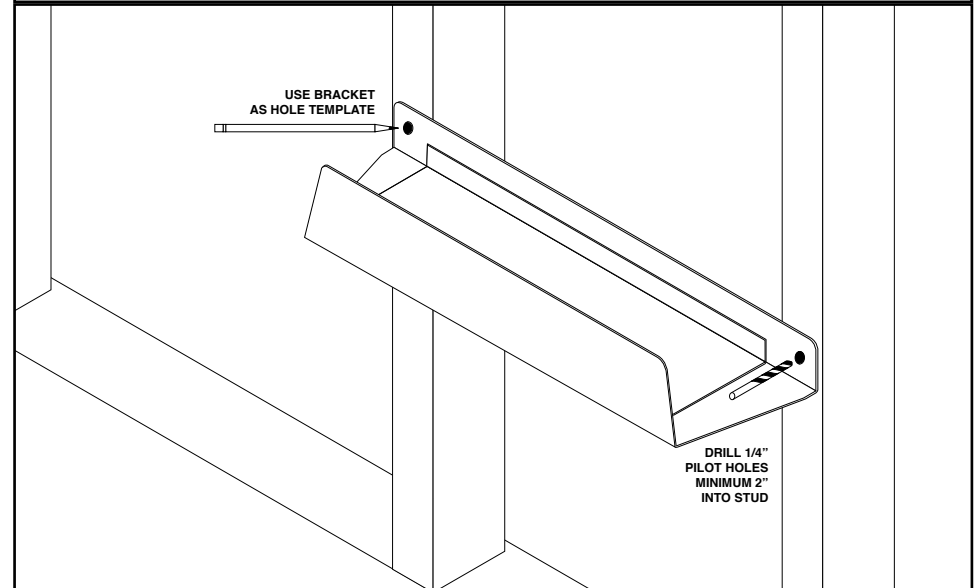

**2** THE JEEP FREEDOM PANEL SIZES DIFFER FROM EACH OTHER. MEASURE 29.5" FROM THE EDGE OF THE LOWER BRACKET TO THE TOP EDGE OF UPPER BRACKET. REPEAT WITH THE OTHER SIDE, MEASURING 30.5". BRACKETS SHOULD HAVE AT LEAST 16" DISTANCE FROM EACH OTHER.

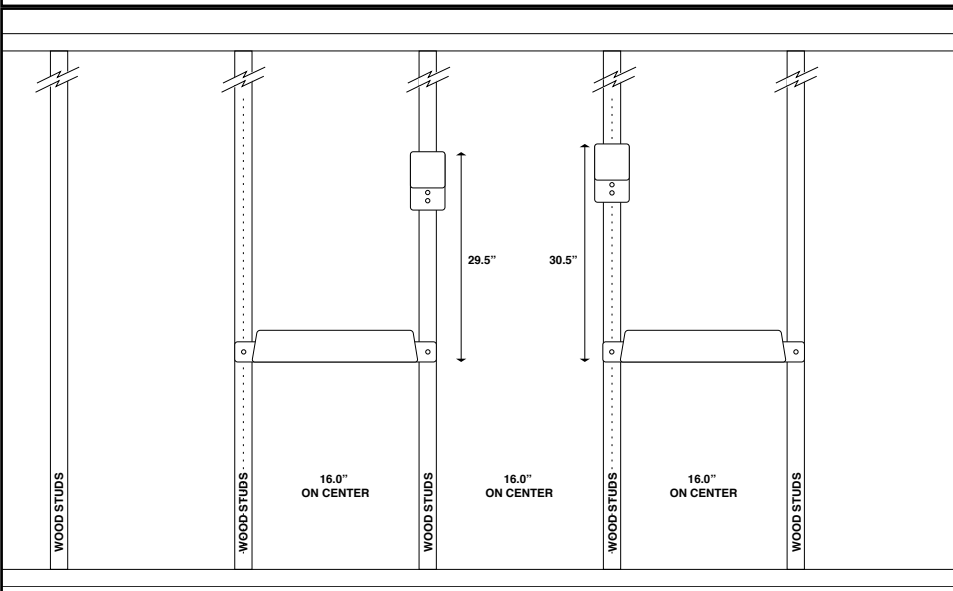

**4** DETERMINE THE PROPER LENGTH 5/16" LAG BOLTS FOR YOUR APPLICATION. BOLTS MUST BE EMBEDDED AT LEAST 2" INTO STUD. USING 5/16" LAG BOLTS AND 5/16" FLAT WASHERS, ATTACH THE DOOR HOLDER BRACKET TO THE WALL.

