

SuperGear. "SS" STAINLESS STEEL EXHAUST TIPS

Stainless Steel exhaust extensions give any vehicle that rugged yet distinctive look. This practical and customizing accessory improves the look of the vehicle, while at the same time prevents residue on bumpers by extending the exhaust system. Made of heavy gauge metal with brilliant chrome plating.

**Round Reso-Tube
Slanted Rolled Edge**

28-9750 - 2 1/2" - 3 1/2" x 24"
28-9760 - 3 1/8" - 3 1/2" x 24"

**Round Reso-Tube
Slanted Rolled Edge**

28-9700 - 2 1/2" - 3 1/2" x 18"
28-9710 - 3 1/8" - 3 1/2" x 18"

**Super Strong Slotted Muffler
Clamp Mounting Hardware**



**Round Twin Splitter Barrels
Straight Rolled Edges**

28-9800 - 2 1/2" - 3" x 11 1/2"

**Super Strong Slotted Muffler
Clamp Mounting Hardware**



**Round Twin Splitter Barrels
Slanted Rolled Edges**

28-9850 - 2 1/2" - 3 1/2" x 11 1/2"

**Super Strong Slotted Muffler
Clamp Mounting Hardware**



PRODUCT FEATURES

- Base Mount Merchandising System
- Color-Coded Labels
- SuperStrong Mounting Hardware

| | |
|--------------------|-----------------|
| FITS PIPE DIAMETER | 1 1/4" - 1 1/2" |
| FITS PIPE DIAMETER | 1 3/4" - 2" |
| FITS PIPE DIAMETER | 2 1/4" - 2 1/2" |
| FITS PIPE DIAMETER | 2 3/4" - 3" |
| FITS PIPE DIAMETER | 3 1/4" - 3 1/2" |
| FITS PIPE DIAMETER | 3 3/4" - 4" |

**Round Barrel
Straight Rolled Edge**

28-9000 - 1 5/8" x 4"
28-9010 - 2 1/8" x 6"
28-9020 - 2 5/8" x 7"
28-9030 - 3 1/8" x 7"
28-9040 - 3 5/8" x 8"

**Super Strong Six-Point
Mounting Hardware**



**Round Barrel
Slanted Rolled Edge**

28-9100 - 1 5/8" x 4"
28-9110 - 2 1/8" x 6"
28-9120 - 2 5/8" x 7"
28-9130 - 3 1/8" x 7"
28-9140 - 3 5/8" x 8"
28-9150 - 4 1/8" x 8"

**Super Strong Six-Point
Mounting Hardware**

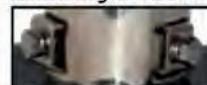

**Round Large Barrel
Slanted Rolled Edge**

28-9210 - 2 1/8" - 2 1/2" x 6"
28-9220 - 2 5/8" - 3" x 7"
28-9230 - 3 1/8" - 3 1/2" x 7"
28-9240 - 3 5/8" - 4" x 8"

**Super Strong Six-Point
Mounting Hardware**

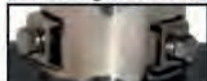

**Oval Barrel
Slanted Rolled Edge**

28-9310 - 2 1/8" x 2" x 3" x 6"
28-9320 - 2 5/8" x 2 1/2" x 4" x 7"
28-9330 - 3 1/8" x 3" x 5" x 9"

**Super Strong Six-Point
Mounting Hardware**



**Round Turned Down Barrel
No Rolled Edge**

28-9410 - 2 1/8" x 6"
28-9420 - 2 5/8" x 7"

**Super Strong Six-Point
Mounting Hardware**

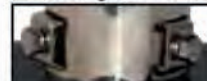

**Double Walled, Round Barrel
Resonated, Straight Rolled Edge**

28-9510 - 2 1/8" - 3 1/2" x 8"
28-9520 - 2 5/8" - 4" x 9"

**Super Strong Six-Point
Mounting Hardware**

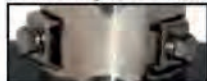

**Double Walled, Round Barrel
Resonated, Slanted Rolled Edge**

28-9610 - 2 1/8" - 3 1/2" x 8"
28-9620 - 2 5/8" - 4" x 9"

**Super Strong Six-Point
Mounting Hardware**



***SuperGear.* SPORT SERIES STAINLESS STEEL EXHAUST TIPS**

Original Equipment Style, Heavy Gauge Mirror Polished Stainless Steel



Round Straight

28-6101 - 2" x 6" Fits: 1 1/2" - 1 7/8"
28-6102 - 2 1/2" x 7" Fits: 1 3/4" - 2 1/2"



Round Slant

28-6201 - 2 1/2" x 6" Fits: 1 1/2" - 2"
28-6202 - 3" x 7" Fits: 1 3/4" - 2 1/2"



Oval Slant

28-6301 - 3 1/2" x 6" Fits: 1 1/2" - 2"
28-6302 - 4" x 7" Fits: 1 3/4" - 2 1/2"



Short Round Slant

28-6502 - 2 1/2" x 4 3/4" Fits: 1 3/4" - 2 1/8"



Short Oval Straight

28-6602 - 2 1/2" x 4 1/2" Fits: 1 3/4" - 2 1/8"



Short Oval Slant

28-6701 - 1 7/8" x 4" Fits: 1 1/4" - 1 3/4"
28-6702 - 3 1/4" x 4" Fits: 1 3/4" - 2 1/8"



Dual Splitter Round Straight

28-6905 - Inlet 2 1/2"
Outlet 2 3/4" Length 9"



Dual Splitter Square Slant

28-6908 - Inlet 2 1/2"
Outlet 2 1/4" Length 11"



Dual Splitter Oval Slant

28-6901 - Inlet 2 1/2" - Length 8 3/4"
Fits: 1 3/4" - 2 3/8" 3 Point Clamp

Dual Splitter Round Slant

28-6910 - Inlet 2 1/2" - Outlet 3 1/2" Length 10"
Muffler Style clamp

SuperGear. STAINLESS STEEL - PERFORMANCE SERIES RESONATED EXHAUST TIPS

Easy Bolt-On Application - Double Wall Performance Resonated Premium Mirror Polished Stainless Steel



Round
28-4101
1 1/2" - 2 1/2" x 3 1/2" x 8"



Rectangle Slant
28-4201
1 1/2" - 2" x 2 3/4" x 7"



Slant
28-4301
1 1/2" - 2 1/2" x 4" x 9"



Round
28-4102
2 1/2" - 3 1/4" x 4" x 10"



Round
28-4202
1 1/2" - 2" x 3" x 7"



Round
28-4302
1 3/4" - 2 1/4" x 3 1/2" x 6"

SuperGear. CHROME - PERFORMANCE SERIES RESONATED EXHAUST TIPS

Easy Bolt-On Application - Double Wall Performance Resonated Triple Nickel Plated Steel



Round
28-5101
1 1/2" - 2 1/2" x 3 1/2" x 8"



Rectangle Slant
28-5201
1 1/2" - 2" x 2 3/4" x 7"



Slant
28-5301
1 1/2" - 2 1/2" x 4" x 9"



Round
28-5102
2 1/2" - 3 1/4" x 4" x 10"



Round
28-5202
1 1/2" - 2" x 3" x 7"



Round
28-5302
1 3/4" - 2 1/4" x 3 1/2" x 6"

SuperGear. CLASSIC CHROME EXHAUST TIPS

Chrome exhaust extensions give any vehicle that rugged yet distinctive look. This practical and customizing accessory improves the look of the vehicle, while at the same time prevents residue on bumpers by extending the exhaust system. Made of heavy gauge metal with brilliant chrome plating.



Silentip Custom Straight

- 28-2091 - 2 1/2" x 9"
- 28-2121 - 1 3/4" x 9"
- 28-2131 - 2" x 9"
- 28-2151 - 1 1/2" - 1 3/4" x 7"
- 28-2171 - 2" x 14"
- 28-2431 - 2 1/8" x 9"
- 28-2441 - 2 1/2" x 12"



Silver Tip Custom - Turn Down

- 28-2531 - 2 1/8" x 9"
- 28-2551 - 1 3/4" x 9"
- 28-2561 - 2" x 9"



Silver Tip Turn Down Custom

- 28-2521 - 2 1/2" x 9"



Custom Fit Straight

- 28-2911 - 2 1/4" x 9"



Flared Bazooka

- 28-2371 - 2 1/2" x 9"



Slant Cut

- 28-2191 - 2" x 9"
- 28-2211 - 2 1/2" x 9"



Silver Tip Slant

- 28-2401 - 2 1/8" x 7"
- 28-2511 - 2" x 7"
- 28-2601 - 1 3/4" - 2 1/8" x 6"
- 28-2691 - 2 1/8" x 7"



Oval Formed Custom

- 28-2471 - 2 1/4" x 8 1/4"



Baracuda

- 28-2181 - 1 3/4" - 2" x 7"

SuperGear. CLASSIC CHROME EXHAUST TIPS

Chrome exhaust extensions give any vehicle that rugged yet distinctive look. This practical and customizing accessory improves the look of the vehicle, while at the same time prevents residue on bumpers by extending the exhaust system. Made of heavy gauge metal with brilliant chrome plating.



Reso-Tube Scavengers

- 29-9301 - 2 1/4" x 3" x 12"
- 29-9331 - 2 1/4" x 3 1/2" x 12"
- 29-9341 - 2 1/4" x 3 1/2" x 18"
- 29-9351 - 2 1/4" x 3 1/2" x 24"



Slant Cut Dual Splitter

- 28-2031 - 2 1/4" x 12"



Rolled Edge Custom Straight Stubby

- 28-3011 - 2 1/8" x 4 1/2"
- 28-3021 - 2 1/2" x 4 1/2"
- 28-3061 - 3" x 7"



Rolled Edge Custom Oval

- 28-3031 - 2" x 4 1/2"
- 28-3041 - 2 1/4" x 4 1/2"



Slant Cut Stubby

- 28-3091 - 3" x 7"



Silvertip Universal

- 28-2541 - 1 1/2" - 2 1/4" x 9"



Airflow Universal

- 28-2761 - 1 1/2" - 2 1/4" x 9"



Baracuda Universal

- 28-2881 - 2 1/2" - 2 1/4" x 9"



Protector Chromed Metal

25-5010 - Carded
25-5011 - 2 in Poly Bag
25-501Z - 1 in Poly Bag
25-501E - 36 in Bulk Pack



Protector Black Metal

25-5010B - Carded
25-5011B - 2 In Poly Bag
25-501ZB - 1 In Poly Bag
25-502E - 36 In Bulk Pack

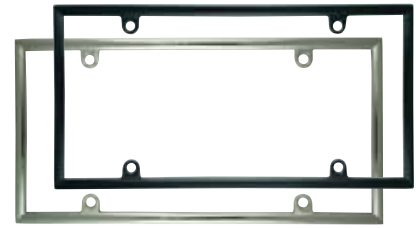

Award Continental

25-5200 - Chromed Metal Carded
25-5200B - Black Metal Carded



Euro Style Plastic

25-5101 - Black Carded
25-510E - 36 in Bulk Pack
25-5101W - White Carded
Includes Fasteners



Elite Series Metal

25-5450 - Black Carded
25-5455 - Chrome Carded



Perimeter with Inside Frame

25-5885 - Chrome Metal Carded



Reflective Plastic

25-5501 - Carded Reflective
Plastic Class "A" Reflective Frame
with Reflective Bolt Covers.



Classic Chrome Motorcycle

25-5648 - Chromed Metal Carded
Dimensions 7.25" x 4.25"



Protector Combo Kit

25-5131 - Chrome Metal Frame,
Clear Acrylic Bubble Shield
25-5131B - Black Metal Frame,
Clear Acrylic Bubble Shield



Award Combo Kit

25-5091 - Chrome with Metal
Back & Clear Acrylic
Flat Shield.



Protector Bubble Shield

25-5301 - Acrylic Bubble
Shield Clear



Protector Bubble Shield

25-5311 - Acrylic Bubble
Shield Smoke



Elite Flat Shield

25-5465 - Clear Acrylic



Elite Flat Shield

25-5470 - Smoke Acrylic



Twist

25-5621 - Chrome (Carded)

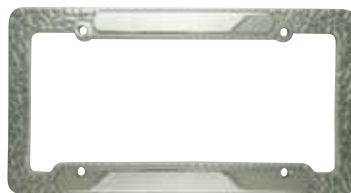

Nugget

25-5641 - Chrome (Carded)



Diamond Plate

25-5645 - Diamond Plate
Chromed Metal (Carded)



Eagle

*25-5616 - Eagle Chromed
Metal (Carded)*



Christian Fish

*25-5632 - Chromed
Metal (Carded)*



Palm Tree

*25-5638 - Chromed
Metal (Carded)*



Fused Chain

*25-5601 - Chromed
Metal (Carded)*



Titanium

*25-5034 - Metal Frame Titanium
Finish Over Heavy Duty Die Cast
Zinc Metal Corrosion Resistant (Carded)*



Victory

*25-5640 - Chromed
Metal (Carded)*



Cobra

*25-5644 - Chromed
Metal (Carded)*



25-4001
Nylon License
Plate Fasteners
(4 Per Package)



25-4005
Metric Nylon License
Plate Fasteners
6mm x 25mm Bolts
Designed for Use with
Import Vehicles.
(4 Per Package)

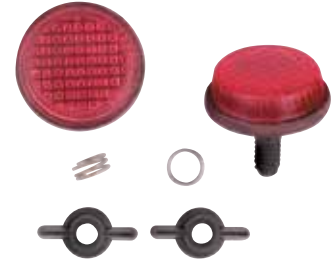

25-4011
Safety Reflector
License Plate
Fasteners
(2 Per Package)



**Metal License
Plate Fasteners**
25-4021
Domestic Vehicles (4 Per Package)
25-4025
Import Vehicles - 6mm x 25mm Bolts
(4 Per Package)
25-4061
Extra Long
Domestic Vehicles (4 Per Package)



25-4031
Lock-Nut License
Plate Fasteners
(4 Per Package)



**Screw Caps
(Black Shown)**
25-4041B - Black
25-4041V - Chrome
25-4041Z - Gold
(4 Per Package)



**Theft Resistant
License Plate Fasteners**
25-4045 - Metric
(6mm x 25mm Bolts for Imports)
25-4051B - Black
25-4051V - Silver
25-4051Z - Gold
(2 Per Package)



25-4101
License Plate
Mounting Bracket
Universal "H" Style

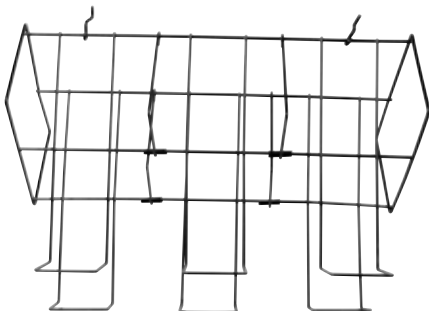

09-2591
20 1/2" Wide Wire Display
Black - 6 Pocket

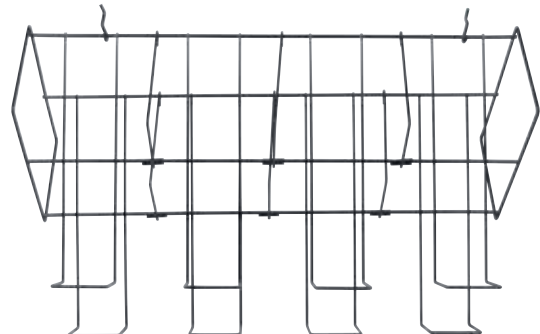

09-2592
27 1/2" Wide Wire Display
Black - 8 Pocket

COMING SOON!

1" & 2" Lift Block Kits in Heavy Duty Steel or Aluminum for Ford F-Series Trucks

For 2004 & Newer F-Series models with 3" wide leaf springs.
Kits for models having Single Center Pin or Dual Center Pin Bolted leaf springs.

- Designed to lift frame and body from axle mount
- Use with original blocks for added vehicle height
- Designed to lift Frame and Body from Axle mount
- Easy to install, no special tools required

DUAL PIN HEAVY DUTY STEEL LIFT BLOCK KITS

1" HD Steel Lift Block, Dual Center Bolt Pin kit
13-2050 Kit Contains: 2- Axle Wedge Shims, 2-Shock spacers,
2- 1" Blocks, 4- M14mm x 1.5mm x 82.55mm x 305mm U-Bolts

2" HD Steel Lift Block, Dual Center Bolt Pin kit
13-2060 Kit Contains: 2-shims, 2-Shock spacers,
2- 2" Blocks, 4- M14mm x 1.5mm x 82.55mm x 305mm U-Bolts

SINGLE PIN ALUMINUM LIFT BLOCK KITS

1" Aluminum Lift Block kit, Single Center Bolt Pin kit
13-2130 Kit Contains: 2- Axle Wedge Shims, 2-Shock spacers,
2- 1" Blocks, 4- M14mm x 1.5mm x 82.55mm x 305mm U-Bolts

2" Aluminum Lift Block kit, Single Center Bolt Pin kit
13-2140 Kit Contains: 2- Axle Wedge Shims, 2-Shock spacers,
2- 2" Blocks, 4- M14mm x 1.5mm x 82.55mm x 305mm U-Bolts



Lift Block Kit 2" Heavy Duty Steel



Lift Block Kit 2" Aluminum

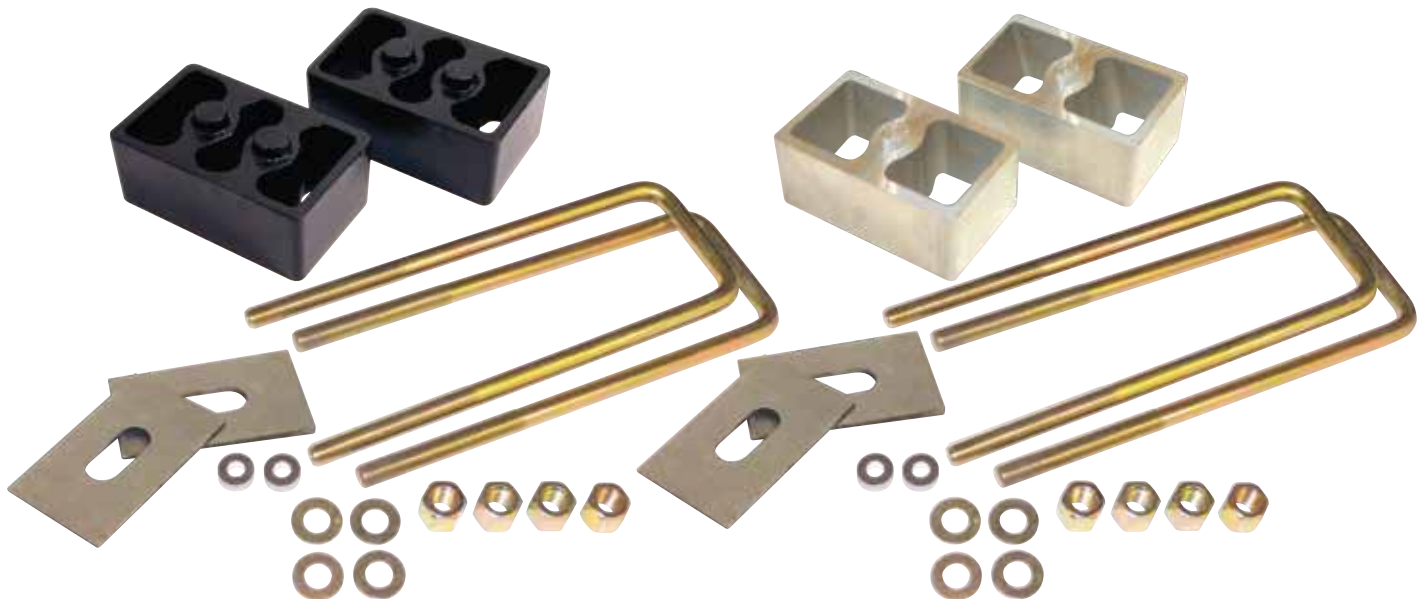

Kit Contains: 2- Axle Wedge Shims, 2-Shock spacers, 2-1" Blocks, 4- M14mm x 1.5mm x 82.55mm x 305mm U-Bolts

FORD F-150 U-Bolts, Lift Blocks & Lowering Shackles

COMING SOON!



PAIR PACK



4 PACK

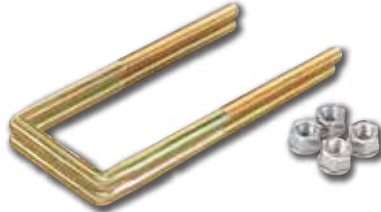

13-0190A - PAIR PACK - Square U-Bolt kit
Contains: 2 Square U-Bolts
4 Nuts and 4 Lock Washers

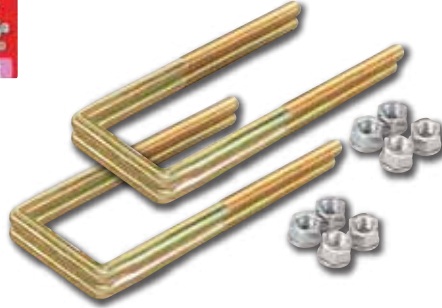

13-1190A - 4 PACK - Square U-Bolt kit
Contains: 4 Square U-Bolts
8 Nuts and 8 Lock Washers



Rear Lowering Shackle Kit

Lowering shackles provide a 1" or 2" drop to the rear of a vehicle for a more level look.

Made of heavy duty die stamped steel.

13-4100 - 2" Drop Rear Lowering Kit (Boxed)

13-4200 - 2" Drop **NEW** Rear Lowering Kit (Boxed)

13-4300 - 1" Drop **NEW** Rear Lowering Kit (Boxed)

| | |
|---|---------------|
| Use 13-4100 to Drop up to 2" | |
| Leaf Spring Width | Shackle Width |
| 2.5" | 3.0" |
| 73 - 06 Ford F150 Pickup 2 WD 4 WD w/2.5" | |

| | |
|---|---------------|
| Use 13-4200 to Drop up to 2" | |
| Leaf Spring Width | Shackle Width |
| 3.0" | 3.5" |
| 04 - 13 Ford F150 Model Pickup 2 & 4 WD | |
| 99 - 04 Ford F250SD, F350SD Pickup 2 WD | |
| 73 - 97 Ford F150, F250, F350 Pickup w/3" | |

| | |
|---|---------------|
| Use 13-4300 to Drop up to 1" | |
| Leaf Spring Width | Shackle Width |
| 2.5" | 3.0" |
| 73 - 06 Ford F150 Pickup 2 WD 4 WD w/2.5" | |



Shock Absorber Extender (2pcs) Rear 2" Lowering
Ford Lowering 1992 to 2003
Part No. 13-6560



Shock Absorber Extender (2pcs) Rear 2" Lowering
Ford Lowering 2004 to 2013
Part No. 13-6570



Shock Stud Extender

No need for larger shocks when making a lift kit installation.
Fits all stud mounted shock absorbers. (2 Per Card)



13-6501 With 3/8" x 24 TPI Fine Thread: Fits All Except '69 And Later Fords
13-6521 With 3/8" x 16 TPI Coarse Thread: Fords '69 and Later

AVAILABLE NOW!

2" Tall Lift Block Kits in Heavy Duty Steel or Medium Duty Aluminum for Ford F-Series Trucks with 3" Wide Leaf Springs.

For 2004 & Newer F-Series models with 3" wide leaf springs.
Kits for models having Single Center Pin or Dual Center Pin Bolted leaf springs.

- Designed to lift frame and body from axle mount
- Use with original blocks for added vehicle height
- Designed to lift Frame and Body from Axle mount
- Easy to install, no special tools required



Lift Block Kit 2" Heavy Duty Steel



13-2060



DUAL PIN HEAVY DUTY STEEL LIFT BLOCK KITS

2" HD Steel Lift Block, Dual Center Bolt Pin kit
13-2060 Kit Contains: 2-shims, 2-Shock spacers,
2 - 2" Blocks, 4 - M14mm x 1.5mm x 82.55mm x 305mm U-Bolts

SINGLE PIN ALUMINUM LIFT BLOCK KITS

2" Aluminum Lift Block kit, Single Center Bolt Pin kit
13-2140 Kit Contains: 2- Axle Wedge Shims, 2-Shock spacers,
2 - 2" Blocks, 4 - M14mm x 1.5mm x 82.55mm x 305mm U-Bolts



Lift Block Kit 2" Aluminum



13-2040



Kit Contains: 2- Axle Wedge Shims, 2-Shock spacers, 2-1" Blocks, 4 - M14mm x 1.5mm x 82.55mm x 305mm U-Bolts

AVAILABLE NOW!

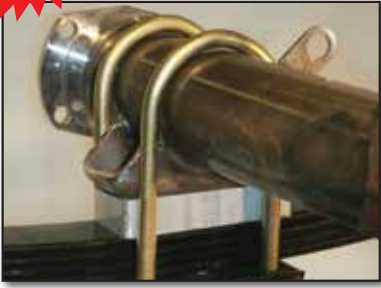

1", 2" & 3" Aluminum Lift Block Kits

- FOR REAR AXLE APPLICATION ONLY**
- Fits most mini-trucks, pick-up trucks, boat and utility trailers with leaf springs from 1-3/4" width to 2" width.
 - Easy to install, no special tools needed.
 - Tempered Aluminum

Kit Contains:
2 - Aluminum Blocks
2 - 2° Shims

13-1LiftA



13-2LiftA

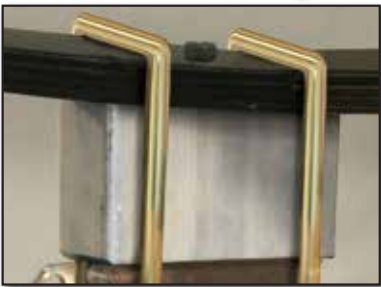

13-3LiftA

ROUND U-BOLT KIT

- Use for mounting leaf springs on cars, trucks, RVs, trailers, other home, farm and marine applications.
- Always use new U-Bolts when replacing springs.
- Use only parts built to original equipment quality
- After 300 miles retighten U-Bolts



**Kit Contains: 2 ROUND U-bolts,
4 nuts and 4 lock washers.**

SQUARE U-BOLT KIT

- Use for mounting leaf springs on cars, trucks, RVs, trailers, other home, farm and marine applications.
- Always use new U-Bolts when replacing springs.
- Use only parts built to original equipment quality
- After 300 miles retighten U-Bolts



**Kit Contains: 2 SQUARE U-bolts,
4 nuts and 4 lock washers.**



DISPLAY RACK



SIZE REFERENCE CHART

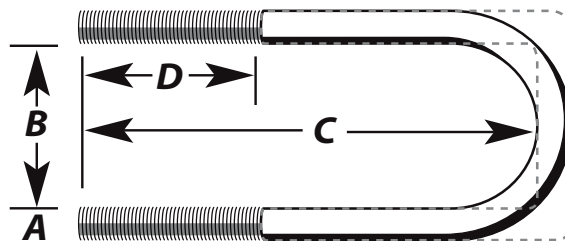

ROUND TYPE : TIPO DE RONDA

| PART# | A | B | C | D | TYPE |
|--------------|----------------|-----------------|-------------------|------------------|-------|
| 13-0112A | 7/16" (1.11cm) | 2 1/2" (6.35cm) | 6 1/2" (16.51cm) | 3" (7.62cm) | ROUND |
| 13-0170A | 7/16" (1.11cm) | 3 1/2" (8.89cm) | 7" (17.78cm) | 3" (7.62cm) | ROUND |
| 13-0180A | 1/2" (1.27cm) | 2 7/8" (7.30cm) | 7" (17.78cm) | 4" (10.16cm) | ROUND |
| 13-0133A | 1/2" (1.27cm) | 3" (7.62cm) | 11 3/4" (29.84cm) | 9 1/4" (23.49cm) | ROUND |
| 13-1110A | 1/2" (1.27cm) | 3 1/8" (7.93cm) | 10 1/4" (26.04cm) | 5 1/4" (13.34cm) | ROUND |
| 13-1111A 4pk | 1/2" (1.27cm) | 3 1/8" (7.93cm) | 10 1/4" (26.04cm) | 5 1/4" (13.34cm) | ROUND |
| 13-0131A | 1/2" (1.27cm) | 2 1/2" (6.35cm) | 8 1/4" (20.95cm) | 3" (7.62cm) | ROUND |
| 13-0134A | 1/2" (1.27cm) | 3 1/8" (7.93cm) | 6 1/2" (16.51cm) | 3" (7.62cm) | ROUND |
| 13-0136A | 1/2" (1.27cm) | 3 1/8" (7.93cm) | 8" (20.32cm) | 3" (7.62cm) | ROUND |
| 13-0137A | 1/2" (1.27cm) | 3 1/4" (8.25cm) | 9" (22.86cm) | 3" (7.62cm) | ROUND |
| 13-0135A | 1/2" (1.27cm) | 3 1/2" (8.89cm) | 7 1/2" (19.05cm) | 3" (7.62cm) | ROUND |
| 13-0115A | 9/16" (1.43cm) | 3 3/8" (8.57cm) | 10" (25.4cm) | 6 1/2" (16.51cm) | ROUND |
| 13-0120A | 9/16" (1.43cm) | 3" (7.62cm) | 7 1/4" (18.41cm) | 3" (7.62cm) | ROUND |
| 13-0125A | 5/8" (1.59cm) | 3" (7.62cm) | 7 1/2" (19.05cm) | 3" (7.62cm) | ROUND |

SIZE REFERENCE CHART

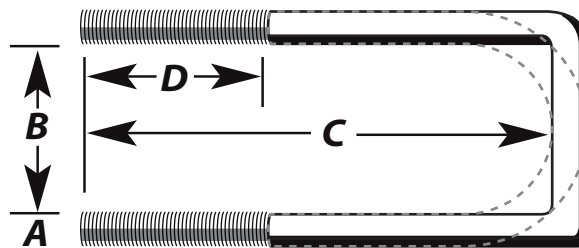

SQUARE TYPE : TIPO DE PLAZA

| PART# | A | B | C | D | TYPE |
|--------------|----------------|-----------------|-------------------|------------------|--------|
| 13-0146A | 1/2" (1.27cm) | 2 5/8" (6.66cm) | 9 1/4" (23.49cm) | 6 1/2" (16.51cm) | SQUARE |
| 13-1210A | 1/2" (1.27cm) | 2 3/4" (6.99cm) | 12 1/4" (31.11cm) | 9 3/4" (24.77cm) | SQUARE |
| 13-1211A 4pk | 1/2" (1.27cm) | 2 3/4" (6.99cm) | 12 1/4" (31.11cm) | 9 3/4" (24.77cm) | SQUARE |
| 13-0142A | 1/2" (1.27cm) | 2" (5.08cm) | 6" (15.24cm) | 3" (7.62cm) | SQUARE |
| 13-0144A | 1/2" (1.27cm) | 2 1/2" (6.35cm) | 7 3/4" (19.68cm) | 3" (7.62cm) | SQUARE |
| 13-0148A | 1/2" (1.27cm) | 3" (7.62cm) | 7 1/2" (19.05cm) | 3" (7.62cm) | SQUARE |
| 13-0138A | 9/16" (1.43cm) | 2 5/8" (6.66cm) | 12" (30.48cm) | 9 1/2" (24.13cm) | SQUARE |
| 13-0150A | 9/16" (1.43cm) | 2 1/2" (6.35cm) | 8" (20.32cm) | 3" (7.62cm) | SQUARE |
| 13-0160A | 9/16" (1.43cm) | 2 5/8" (6.66cm) | 8" (20.32cm) | 3" (7.62cm) | SQUARE |
| 13-0140A | 5/8" (1.59cm) | 2 5/8" (6.66cm) | 12.2" (30.98cm) | 9 1/2" (24.13cm) | SQUARE |
| 13-0141A | 5/8" (1.59cm) | 2 5/8" (6.66cm) | 9 1/2" (24.13cm) | 3" (7.62cm) | SQUARE |
| 13-0190A | M14 x 1.5 mm | 3 1/4" (8.25cm) | 12" (30.48 cm) | 4" (10.16cm) | SQUARE |
| 13-1190A 4pk | M14 x 1.5 mm | 3 1/4" (8.25cm) | 12" (30.48 cm) | 4" (10.16cm) | SQUARE |

SAE Grade 5 Dry Torque in Foot-Pounds:

7/16 = 54 ft·lb, 1/2 = 78 ft·lb, 9/16 = 114 ft·lb, 5/8 = 154 ft·lb

SAE Grado 5 Dry Torque en libras-pie:

7/16 = 54 ft · lb, 1/2 = 78 ft · lb, 9/16 = 114 ft · lb, 5/8 = 154 ft · lb



Universal Lift / Lowering Block Kits

Increases or decreases suspension height on most leaf spring applications.

Kits include aluminum blocks that can be installed below the leaf spring to raise the vehicle or on top of the leaf spring to lower the vehicle.

Heavy duty hardware and lift blocks are also available separately.

Complete visual card kits contain necessary hardware for one axle (2 Blocks, 4 U-Bolts, Nuts & Washers).



- 13-1000 kit - 1", Round U-Bolts (Boxed)
- 13-1001 kit - 1", Round U-Bolts
- 13-1030 kit - 2", Round U-Bolts (Boxed)
- 13-1031 kit - 2", Round U-Bolts (Visual Card)
- 13-1040 kit - 3", Round U-Bolts (Boxed)
- 13-1041 kit - 3", Round U-Bolts (Visual Card)
- 13-1131 Kit - 2", Square U-Bolts (Visual Card)



**Universal Lift / Lowering Blocks
Tempured Aluminum**

- 13-1081 2" Blocks, 2/1 Card
- 13-1091 3" Blocks, 2/1 Card

**Universal Lift / Lowering Blocks
Heavy Duty Steel**

- 13-1050 2" Blocks, 2/1 Box
- 13-1060 3" Blocks, 2/1 Box



Rear Axle Wedge Kit

2 Degree Pinion Shim Brings Pinion Angle Back When Using Lift Blocks.

NOTE! Should be used with all of our Lift and Lowering kits
13-1250 (2 Per Package)



Rear Lowering Shackle Kit

Lowering shackles provide a 1" or 2" drop to the rear of a vehicle for a more level look. Made of heavy duty die stamped steel.

- 13-4100 - 2" Drop Rear Lowering Kit (Boxed)
- 13-4200 - 2" Drop **NEW** Rear Lowering Kit (Boxed)
- 13-4300 - 1" Drop **NEW** Rear Lowering Kit (Boxed)



"500" Lift Kit

Designed For Additional Tire and Fender Clearance. For Most Cars Equipped with Leaf Springs. Easy To Install With A Choice Of Three Positions.

- 13-4000 Silver Finish (Boxed)



Shock Absorber Extender (2pcs) Front 2" Lifting
Chevy/GMC Lifting 2000 to 2006
Part No. 13-6520



Shock Absorber Extender (2pcs) Rear 2" Lifting
Chevy/GMC Lifting 1999 to 2014
Part No. 13-6530



Shock Absorber Extender (2pcs) Rear 2" Lowering
Chevy/GMC Lowering 2007 to 2014
Part No. 13-6540



Shock Absorber Extender (2pcs) Rear 2" Lowering
Chevy/GMC Lowering 1999-2006
Part No. 13-6550



Shock Absorber Extender (2pcs) Rear 2" Lowering
Ford Lowering 1992 to 2003
Part No. 13-6560



Shock Absorber Extender (2pcs) Rear 2" Lowering
Ford Lowering 2004 to 2013
Part No. 13-6570

Shock Stud Extender

No need for larger shocks when making a lift kit installation.
Fits all stud mounted shock absorbers.(2 Per Card)



13-6501 With 3/8" x 24 TPI Fine Thread: Fits All Except '69 And Later Fords
13-6521 With 3/8" x 16 TPI Coarse Thread: Fords '69 and Later

Adjustable Coil Spring Lower or Leveling Clamps



- Lowers Springs
- Improves handling
- Zinc plated, SAE grade 5 steel

18-1220A (4 Sets Per Clamshell)

Coil Spring Two Way Adjustable EXPANDER/TENSIONER



Adjustable unique device which spreads or compresses coil springs by turning nuts with a wrench. Dual saddles hold coil spring in proper alignment.

Adds 1"-2" Lift
18-1201 (2 Per Card)
18-1201A (4 Per Clamshell)

Regular Rubber Coil Spring Boosters



1 1/2" thick strong rubber coil spring boosters add or restores lift to sagging springs and reduces bottoming out. Adds approximately 1" lift

18-1601 (4 Per Card)

Heavy Duty Coil Spring Spacers



Spring Spacers are inserted between coils with a light tap of a hammer. They increase spring tension to prevent bottoming.

Adds 1" - 1 1/2" Lift
18-6001 (4 Per Card)

Heavy Duty Rubber Coil Spring Boosters



Strong rubber coil spring booster adds or restores lift to sagging springs and reduces bottoming out.

Adds 2" - 2 1/2" Lift
18-1701 (2 Per Card)
18-1701A (4 Per Clamshell)

Twist-In Coil Spring Spacers



Design allows for easy installation. A light tap with a hammer traps the unit between coils and a wrench is used to screw in the unit to obtain increased tension.

Adds 1" - 1 1/2" Lift
18-8001 Front (4 Per Card)
18-9001 Rear (4 Per Card)

Round Base Rubber Coil Spring Booster

Strong rubber coil spring booster adds or restores lift to sagging springs and reduces bottoming out.



H-SHAPE Used Inside Coil Spring

18-1901 - 1.5" Thick H-Shape, Adds 1" lift - 1 Per Card
18-1920 - 2 1/4" Thick H-Shape, Adds 3" Lift - 1 Per Card
18-1950 - 2" Thick H-Shape, Adds 2" Lift - 1 Per Card



U-SHAPE Used on Top or Below Coil Spring

18-1930 - 1/2" Thick U-Shape, Adds 1" Lift - 2 Per Card
18-1960 - 2" Thick U-Shape, Adds 2" Lift - 1 Per Card

Boost-O-Matic Adjustable Spring Boosters

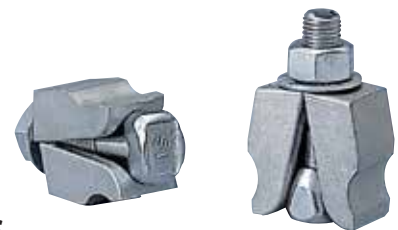

Adjustable mechanical boosters are inserted between coils. By tightening adjustable nut, the assembly wedges in tight to spread the coils and restore spring action.

Adds 1" - 1 1/2" Lift
18-1101 Rear (2 Per Card)
18-7001 Front (2 Per Card)



Universal Add-A-Leaf Kit
Fits Small Trucks
Toyota - Rangers - S10 - Dakota
Part No. 11-1060



Universal Add-A-Leaf Kit
Fits most vehicles with
2 1/4" Leaf Spring Assemblies
Part No. 11-1070



Universal Add-A-Leaf Kit
Fits most vehicles with
2 1/2" Leaf Spring Assemblies
Part No. 11-1080



Universal Add-A-Leaf Kit
Fits most vehicles with
3" Leaf Spring Assemblies
Part No. 11-1090



Leaf Springs Tie Bolt
(2 Sets Per Clamshell)
13-1260 Center Leaf Spring Tie Bolt 5/16" x 3"
13-1270 Center Leaf Spring Tie Bolt 3/8" x 3"
13-1280 Center Leaf Spring Tie Bolt 3/8" x 5"
13-1290 Center Leaf Spring Tie Bolt 1/2" x 8"



Leaf Spring Clamp Kit
Individual Leaf Springs Are Locked Together And Stabilized With These Clamps. Better Control For Rear Axle Torque Is Provided.
13-1401 Zinc Plated (1 Set Per Card) Up to 2 1/2" Leaf Springs
13-1401A Zinc Plated (2 Per Clamshell) Up to 2 1/2" Leaf Springs
13-1501A For New 11-1035 3" Overleaf Spring Assist. (2 Sets Per Clamshell)



**Adjustable Underleaf
Helper Spring Leaf Design**

These 3-way adjustable rear leaf helper springs provide increased load capacity and stability. Available for cars, station wagons, pickups, vans and trailers using 1 3/4", to 2 1/2" leaf sizes. (Boxed)

- 11-1010 Up to 1,000 lbs. for Passenger Car
- 11-1020 Up to 1,500 lbs. for Light Trucks
- 11-1050 Up to 500 Lbs. for compact and import cars. (Not Shown)



Over Leaf Spring Assist

Increase level load carrying capacity by 1,000 lbs. with one pair. Add additional capacity by 1,500 lbs. or more with two pair (Sold Separately). Hardware included.

- 11-1030 Fits 1 3/4" to 2 1/2", Up to 1,000 lbs. (Boxed)
- 11-1035 Fits 3" Up to 1,500 lbs. (Boxed)



**R.V. Heavy Duty
Underleaf Helper Springs**

Helps to eliminate sagging from soft suspension, providing better performance and improved handling. Gives added life for larger tires and custom wheels. Provides up to 2,000 lbs. overload capacity. Used for off-highway where additional clearance is required. Easy to install or remove. Hardware included. Fits up to 2 1/2" leaf spring.

- 11-1040 Up to 2,000 lbs. (Boxed)

Load Control Springs for Rear Shock Absorbers

The following are designed with a unique variable pitch to ensure a safe and comfortable ride regardless of load or road conditions. Adjustable spring fits easily over O.E.M. shock absorbers. (Boxed)

Loadmaster
14-0490 Up to 750 lbs.

Best Ride
Heavy enamel coating prevents squeaks and rattles.
14-0890 Up to 1,250 lbs. for Light Trucks

Heavy Duty Best Ride
Fits most heavy duty shock absorbers. Protected with a heavy enamel coating.
14-1890 Up to 1,250 lbs.

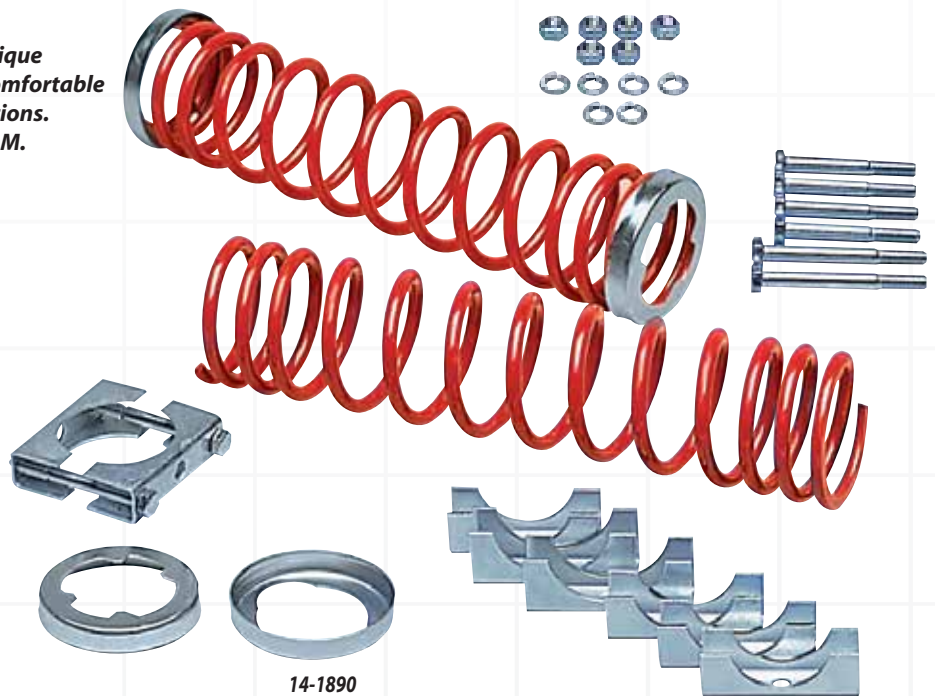

Heavy Duty Helper Springs Coil Design

These specially engineered helper springs provide new life and safety to sagging springs, while offering a "softer" ride when not overloaded. (Boxed)

12-0750 Up to 1,000 lbs. for Passenger Car
12-1500 Up to 1,500 lbs. for Vans & Light Trucks
12-1600 Up to 2,000 lbs. for Light Trucks & RV's

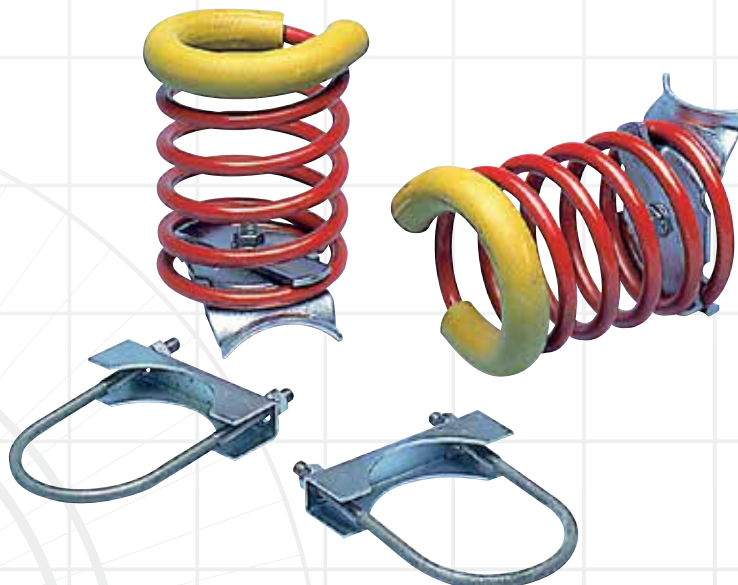



Tie Rod End Dust Boot 1 3/8"
Black 20-0500B



Tie Rod End Dust Boot 1 3/8"
Red 20-0500R



Shock Eye Bushing Set
Black 20-0600B



Bump Stop 2 1/8"
Black - 20-0100B



Bump Stop 11/16"
Black - 20-0110B



End Link Grommet Set
Black 20-0200B

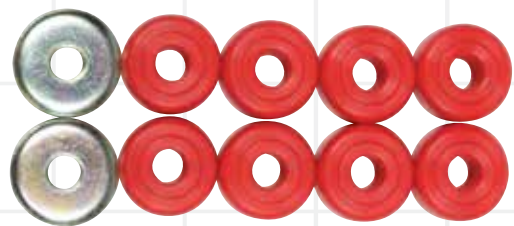

End Link Grommet Set
Red 20-0200R

SEAT BELT EXTENSIONS

This is the safest and most economic way to extend the length of your existing seat belt. Item installs on the beginning end and attaches to your existing belt to make the extension. Your safety is our top priority. Our seat belt products meet D.O.T. Federal Safety Standards, are Quality Tested and Customer Proven Safe. Superior® Automotive manufactures the highest-quality, OEM style replacement seat belts, seat belt extension kits and vehicle related safety products.



Model 1
3" Universal Seat Belt Extension
7/8" Locking Tab Width
Solid Construction

46-3331 - 1 per hanging card



Model 2
3" Universal Seat Belt Extension
1" Locking Tab Width
Solid Construction

46-3332 - 1 per hanging card

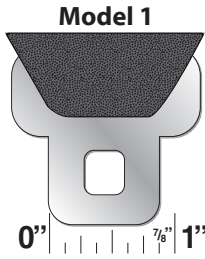

Model 1
7" Universal Seat Belt Extension
7/8" Locking Tab Width
Webbing Construction

46-3371 - 1 per hanging card

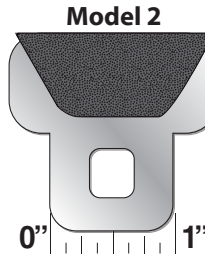

Model 2
7" Universal Seat Belt Extension
1" Locking Tab Width
Webbing Construction

46-3372 - 1 per hanging card

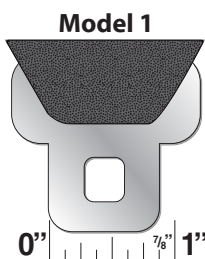

Model 1
10" Universal Seat Belt Extension
7/8" Locking Tab Width
Webbing Construction

46-3101 - 1 per hanging card

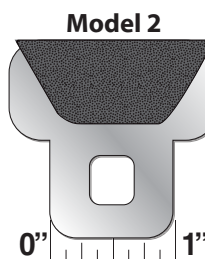

Model 2
10" Universal Seat Belt Extension
1" Locking Tab Width
Webbing Construction

46-3102 - 1 per hanging card





12" Universal Seat Belt Extender

This is the safest and most economic way to extend the length of your existing seat belt. Item installs on the beginning end by extending the mounting point. It attaches to your existing seat belt to make the extension. Extends seat belt length by 12 inches, hardware included.

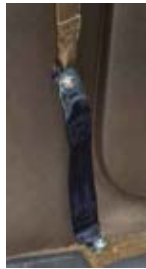

46-3300B 1 per package



Pet Seat Belt Restraint

Easily attaches to your pets own harness and universally fits into your cars seat belt system. Required by law in some states.



46-3400B - 1 per card

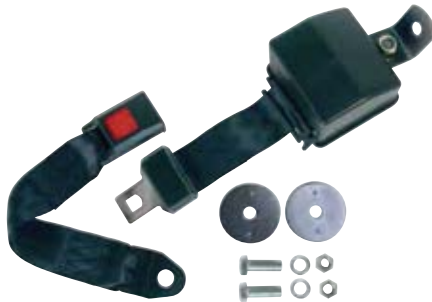

2 Point Retractable Seat Belt

Heavy-duty seat belt complete with self-adjusting ratchet assembly. O.E.M. design with push button safety buckle & herring bone webbing.

46-2050B Black 67" Length (1 per box)



3 Point Waist/Shoulder Seat Belt

These seat belts are attractively designed with a handy push button buckle, herring bone webbing and tough construction for passenger safety.

46-2100B Black 94" Length.(1 per package)

SUPERIOR® Seat Belts & Seat Belt Extenders



46-3250B
90" Length

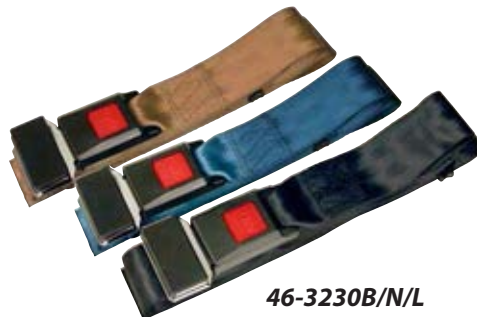

46-3230B/N/L
74" Length



46-3270B
107" Length

- 46-3230B - Auto/RV Seat Belt, 74" Length, Black
- 46-3230L - Auto/RV Seat Belt, 74" Length, Blue
- 46-3230N - Auto/RV Seat Belt, 74" Length, Brown
- 46-3250B - Auto/RV Seat Belt, XL - 90" Length, Black
- 46-3270B - Auto/RV Seat Belt, XXL - 107" Length, Black

25 Unit Bulk Pack for Production Builders - Not Packaged for Retail

- 46-078GB - Auto/RV Seat Belt, 60" Length, Black, with Sewn 45° Swivel Floor Anchors, Bulk (25 Units, Bulk Pack, Poly Bag)
- 46-078HB - Auto/RV Seat Belt, 74" Length, Black, with Sewn 45° Swivel Floor Anchors, Bulk (25 Units, Bulk Pack, Poly Bag)
- 46-078EX - Hardware kit for 46-078GB, 46-078HB: Two Each - Lock Washers, Floor Washers, Nuts, 2 - 7/16" Grade 5 Bolts, Bulk (25 Units, Bulk Pack, Poly Bag)

Truckline[®]

Original Supertherm[®]
Product fits
16" to 18"
diameter
steering wheels.









3 1/2" Wide Truckline[®]
Original Supertherm[®] Lace-On
58-0470B - (BLACK ONLY)
Fits Larger Wheels, 16" to 18"



MEASURING IS EASY!

1. Outside Diameter and
 2. "Grip Circumference = Width" is needed to find your size.
- Measure wheel circumference at multiple points for variances, use thickest points if wheel has finger grooves for proper width fit.

Color Reference Guide
(ACTUAL PRODUCT COLOR MAY VARY)

| | | | |
|---|---------|---|---------|
|  | (BLACK) |  | (TAN) |
|  | (BLUE) |  | (GRAY) |
|  | (RED) |  | (WHITE) |

SPORT GRIP[®]

Original Supertherm[®] Products fit 14 1/2" to 15 1/2" diameter steering wheels.



Grip Size "A"
is 3 1/4" Wide

Original Supertherm[™] Lace-On
Size A = 58-0450B - (BLACK)
Size A = 58-0450L - (BLUE)
Size A = 58-0450T - (TAN)
Size A = 58-0450Y - (GRAY)
Size A = 58-0450R - (RED)
Size A = 58-0450W - (WHITE)

Grip Size "B"
is 3 1/2" Wide

Original Supertherm[™] Lace-On
Size B = 58-0550B - (BLACK)
Size B = 58-0550T - (TAN)
Size B = 58-0550Y - (GRAY)
Size B = 58-0550R - (RED)

Grip Size "C"
is 4" Wide

Original Supertherm[™] Lace-On
Size C = 58-0500B - (BLACK)
Size C = 58-0500T - (TAN)
Size C = 58-0500Y - (GRAY)

Grip Size "D"
is 4 1/4" Wide

Original Supertherm[™] Lace-On
Size D = 58-0350B - (BLACK)
Size D = 58-0350T - (TAN)
Size D = 58-0350Y - (GRAY)

SPORT GRIP Products fit 14 1/2" to 15 1/2" diameter steering wheels.



Memory Foam
58-0925B - Black



Memory Foam
58-0925Y - Gray



Memory Foam
58-0925T - Tan



Classic Massage Faux Leather
58-0900B - Black
58-0900T - Tan
58-0900Y - Gray



Classic Massage Wood Grain
58-0910 - Burl Wood Finish



Classic Massage Velour
58-1100B - Black Velour with Black Grips
58-1100Y - Grey Velour with Black Grips



Comfort Plus
58-0930B - Black
58-0930T - Tan
58-0930Y - Gray
58-0940B - Black with Tan Grips



Contour
58-0950B - Black
58-0950T - Tan
58-0950Y - Gray
58-1110 - Wood Grain



Comfort Cloth
58-1960B - Black
58-1960T - Tan
58-1960Y - Gray



Natural Sheepskin
58-1800N - Brown
58-1800Y - Gray



Faux Ostrich
58-1810B - Black
58-1810T - Tan



Genuine Leather

STEERING WHEEL SKIN COVERS

Superskin® Genuine Leather Sew-On Steering Wheel Skin Covers instantly enhances the look of your steering wheel and complements all interiors. Our covers reduce the feel of road vibrations while ensuring a firm grip for added safety. Your steering wheel surface will feel warmer in the winter and cooler in the summer with the use of this product. Superskin® Genuine Leather Steering Wheel Skin Covers are hand crafted from selected skins of top grain leather.

Fits 14 1/2" to 15 1/2" diameter steering wheels.

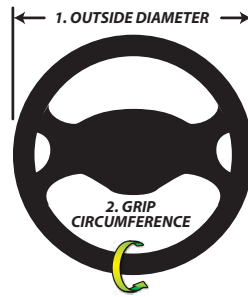

MEASURING IS EASY!

1. Outside Diameter and
2. "Grip Circumference = Width" is needed to find your size. Measure wheel circumference at multiple points for variances, use thickest points if wheel has finger grooves for proper width fit.



Kits Include:

- 1 - Premium Leather Wheel Skin Cover,
- 2 - Sewing Needles, Heavy Duty Thread, Instructions & techniques for Straight Stich, Slant Stich or Cross Stching.

All sizes are available in 3 colors: Black, Gray & Tan



Grip Size "A"
is 3 1/8" Wide

Superskin® Leather Sew-On
Size A = 58-0650B - (BLACK)
Size A = 58-0650T - (TAN)
Size A = 58-0650Y - (GRAY)

Grip Size "B"
is 3 5/8" Wide

Superskin® Leather Sew-On
Size B = 58-0600B - (BLACK)
Size B = 58-0600T - (TAN)
Size B = 58-0600Y - (GRAY)

Grip Size "C"
is 3 7/8" Wide

Superskin® Leather Sew-On
Size C = 58-0700B - (BLACK)
Size C = 58-0700T - (TAN)
Size C = 58-0700Y - (GRAY)

Grip Size "D"
is 4 1/8" Wide

Superskin® Leather Sew-On
Size D = 58-0800B - (BLACK)
Size D = 58-0800T - (TAN)
Size D = 58-0800Y - (GRAY)

THE "ORIGINAL" BUG SCREEN

Washable and durable,
fits over the front of your
auto or radiator.
Prevents bug damage to
paint or chrome and protects
against Radiator/Cooling
system failure.

**FITS OVER THE FRONT OR BEHIND THE
GRILLE OF ANY AUTO OR TRUCK.
PREVENTS BUG DAMAGE TO PAINT, CHROME
AND PROTECTS AGAINST
RADIATOR/COOLING SYSTEM FAILURE.**



**PREVENT YOUR AUTO FROM LOOKING LIKE THIS.
PROTECT YOUR PAINT JOB
WITH THE "ORIGINAL" BUG SCREEN!**



Part No. 56-6011
Inner Pack - 12 Pcs.
Master Pack - 48 Pcs.
UPC: 07770566018
Size: 22" x 24"



Part No. 56-6051
Inner Pack - 12 Pcs.
Master Pack - 48 Pcs.
UPC: 07770566056
Size: 18" x 32"



Part No. 56-6061
Inner Pack - 12 Pcs.
Master Pack - 48 Pcs.
UPC: 07770566063
Size: 24" x 84"



This is the safest and most economic way to extend the length of your existing seat belt. Item installs on the beginning end and attaches to your existing belt to make the extension. Your safety is our top priority. Our seat belt products meet D.O.T. Federal Safety Standards, are Quality Tested and Customer Proven Safe. Superior® Automotive manufactures the highest-quality, OEM style replacement seat belts, seat belt extension kits and vehicle related safety products.



Model 1
3" Universal Seat Belt Extension
7/8" Locking Tab Width
Solid Construction
46-3331 - 1 per hanging card

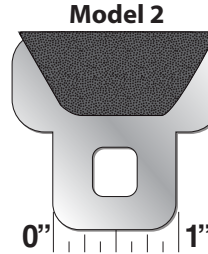

Model 2
3" Universal Seat Belt Extension
1" Locking Tab Width
Solid Construction
46-3332 - 1 per hanging card

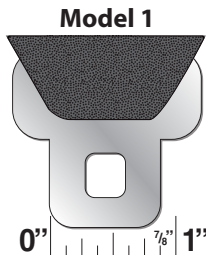

Model 1
7" Universal Seat Belt Extension
7/8" Locking Tab Width
Webbing Construction
46-3371 - 1 per hanging card

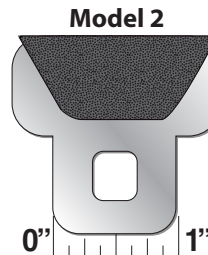
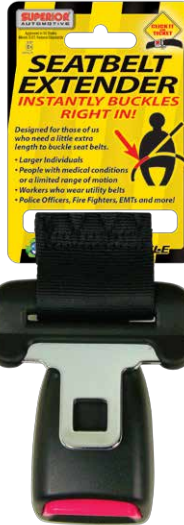

Model 2
7" Universal Seat Belt Extension
1" Locking Tab Width
Webbing Construction
46-3372 - 1 per hanging card

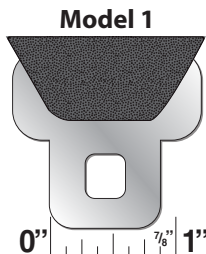

Model 1
10" Universal Seat Belt Extension
7/8" Locking Tab Width
Webbing Construction
46-3101 - 1 per hanging card

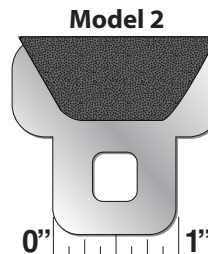

Model 2
10" Universal Seat Belt Extension
1" Locking Tab Width
Webbing Construction
46-3102 - 1 per hanging card





12" Universal Seat Belt Extender

This is the safest and most economic way to extend the length of your existing seat belt. Item installs on the beginning end by extending the mounting point. It attaches to your existing seat belt to make the extension. Extends seat belt length by 12 inches, hardware included.



46-3300B 1 per package



Pet Seat Belt Restraint

Easily attaches to your pets own harness and universally fits into your cars seat belt system. Required by law in some states.



46-3400B - 1 per card



2 Point Retractable Seat Belt
Heavy-duty seat belt complete with self-adjusting ratchet assembly. O.E.M. design with push button safety buckle & herring bone webbing.

46-2050B Black 67" Length (1 per box)



3 Point Waist/Shoulder Seat Belt
These seat belts are attractively designed with a handy push button buckle, herring bone webbing and tough construction for passenger safety.

46-2100B Black 94" Length.(1 per package)

SUPERIOR® Seat Belts & Seat Belt Extenders



46-3250B
90" Length



46-3230B/N/L
74" Length



46-3270B
107" Length

- 46-3230B - Auto/RV Seat Belt, 74" Length, Black
- 46-3230L - Auto/RV Seat Belt, 74" Length, Blue
- 46-3230N - Auto/RV Seat Belt, 74" Length, Brown
- 46-3250B - Auto/RV Seat Belt, XL - 90" Length, Black
- 46-3270B - Auto/RV Seat Belt, XXL - 107" Length, Black

25 Unit Bulk Pack for Production Builders - Not Packaged for Retail

- 46-078GB - Auto/RV Seat Belt, 60" Length, Black, with Sewn 45° Swivel Floor Anchors, Bulk (25 Units, Bulk Pack, Poly Bag)
- 46-078HB - Auto/RV Seat Belt, 74" Length, Black, with Sewn 45° Swivel Floor Anchors, Bulk (25 Units, Bulk Pack, Poly Bag)
- 46-078EX - Hardware kit for 46-078GB, 46-078HB: Two Each - Lock Washers, Floor Washers, Nuts, 2 - 7/16" Grade 5 Bolts, Bulk (25 Units, Bulk Pack, Poly Bag)

HIGH POWER 4 & 5 PORT USB CHARGERS

PLUGS INTO YOUR AUTO 12V POWER SOURCE

CHARGE ANY USB DEVICE

- **Compatible with: Phone/Tablet, Android, Blackberry, iPhone iPad, iPod, Kindle, Mobile, MP3, Players, Samsung, Galaxy**
- **Super fast charging, saves time!**
- **Charge while on the phone or tablet**

PRODUCT FEATURES:

- **4 or 5 USB jack ports Max 8 Amps**
- **Charge while on the phone or tablet**
- **USB large current 8A Total**
- **Super fast charging, saves time!**
- **Safety insurance circuit design, safe and secure during charge time**
- **High voltage & high-temp protection design prevents damage to electronics.**
- **Independent power switch & indicator light.**
- **12V vehicles can be used**
- **Adhesive strip on back allows for mounting**

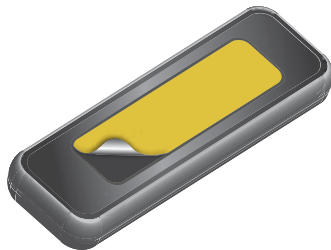

**ADHESIVE STRIP ON BACK
ALLOWS FOR EASY MOUNTING!**

4 Port USB Charger

Fast Charge for Apple and Android



Fast Charge for Samsung and Android

Part No. 35-1140
Inner Pack - 12 Pcs.
Master Pack - 48 Pcs.
UPC: 077705351140
Size: 4.5" x 7.25" x 1.5"

5 Port USB Charger

Fast Charge for Apple and Android

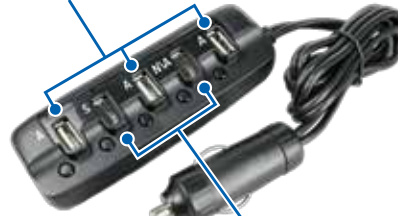

Fast Charge for Samsung and Android

Part No. 35-1150
Inner Pack - 12 Pcs.
Master Pack - 48 Pcs.
UPC: 077705351157
Size: 4.5" x 8.75" x 1.5"





***Protect your tires, wheels and fenders from damage when you park.
Chrome Plated, and fully adjustable to fit any car fender.***

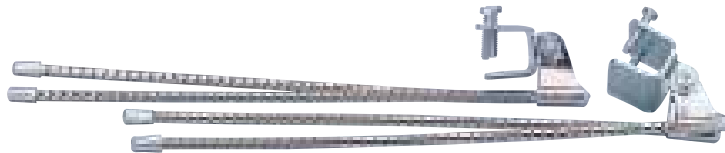

Duplex Curb Feeler

Protects tires,wheels and fenders from damage when parking. Fully adjustable to fit any car fender.

26-6331 Chrome,Duplex Twin,Length:10 1/2"(2 per card)

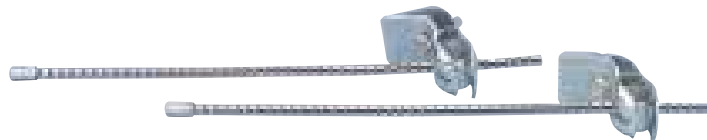

Adjust-O-Matic Curb Feeler

Chrome, Adjustable Length and Height.

26-6441 Length:10"(2 per card)

ROUND U-BOLT KIT

- Use for mounting leaf springs on cars, trucks, RVs, trailers, other home, farm and marine applications.
- Always use new U-Bolts when replacing springs.
- Use only parts built to original equipment quality
- After 300 miles retighten U-Bolts



**Kit Contains: 2 ROUND U-bolts,
4 nuts and 4 lock washers.**

SQUARE U-BOLT KIT

- Use for mounting leaf springs on cars, trucks, RVs, trailers, other home, farm and marine applications.
- Always use new U-Bolts when replacing springs.
- Use only parts built to original equipment quality
- After 300 miles retighten U-Bolts



**Kit Contains: 2 SQUARE U-bolts,
4 nuts and 4 lock washers.**

DISPLAY RACK



SIZE REFERENCE CHART

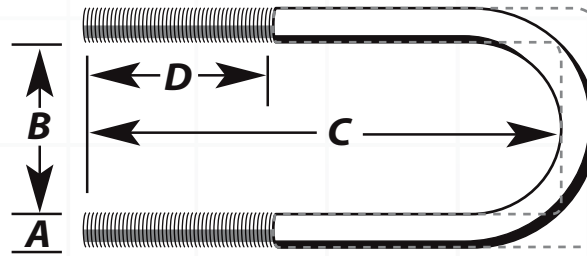

ROUND TYPE : TIPO DE RONDA

| PART# | A | B | C | D | TYPE |
|--------------|----------------|-----------------|-------------------|------------------|-------|
| 13-0112A | 7/16" (1.11cm) | 2 1/2" (6.35cm) | 6 1/2" (16.51cm) | 3" (7.62cm) | ROUND |
| 13-0170A | 7/16" (1.11cm) | 3 1/2" (8.89cm) | 7" (17.78cm) | 3" (7.62cm) | ROUND |
| 13-0180A | 1/2" (1.27cm) | 2 7/8" (7.30cm) | 7" (17.78cm) | 4" (10.16cm) | ROUND |
| 13-0133A | 1/2" (1.27cm) | 3" (7.62cm) | 11 3/4" (29.84cm) | 9 1/4" (23.49cm) | ROUND |
| 13-1110A | 1/2" (1.27cm) | 3 1/8" (7.93cm) | 10 1/4" (26.04cm) | 5 1/4" (13.34cm) | ROUND |
| 13-1111A 4pk | 1/2" (1.27cm) | 3 1/8" (7.93cm) | 10 1/4" (26.04cm) | 5 1/4" (13.34cm) | ROUND |
| 13-0131A | 1/2" (1.27cm) | 2 1/2" (6.35cm) | 8 1/4" (20.95cm) | 3" (7.62cm) | ROUND |
| 13-0134A | 1/2" (1.27cm) | 3 1/8" (7.93cm) | 6 1/2" (16.51cm) | 3" (7.62cm) | ROUND |
| 13-0136A | 1/2" (1.27cm) | 3 1/8" (7.93cm) | 8" (20.32cm) | 3" (7.62cm) | ROUND |
| 13-0137A | 1/2" (1.27cm) | 3 1/4" (8.25cm) | 9" (22.86cm) | 3" (7.62cm) | ROUND |
| 13-0135A | 1/2" (1.27cm) | 3 1/2" (8.89cm) | 7 1/2" (19.05cm) | 3" (7.62cm) | ROUND |
| 13-0115A | 9/16" (1.43cm) | 3 3/8" (8.57cm) | 10" (25.4cm) | 6 1/2" (16.51cm) | ROUND |
| 13-0120A | 9/16" (1.43cm) | 3" (7.62cm) | 7 1/4" (18.41cm) | 3" (7.62cm) | ROUND |
| 13-0125A | 5/8" (1.59cm) | 3" (7.62cm) | 7 1/2" (19.05cm) | 3" (7.62cm) | ROUND |

SIZE REFERENCE CHART

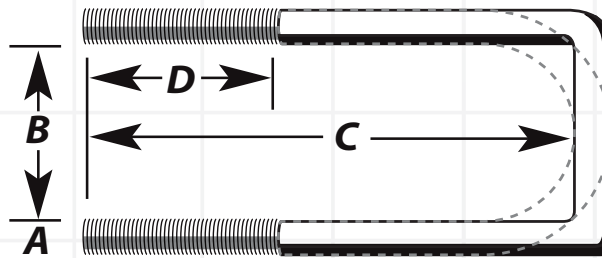

SQUARE TYPE : TIPO DE PLAZA

| PART# | A | B | C | D | TYPE |
|--------------|----------------|-----------------|-------------------|------------------|--------|
| 13-0146A | 1/2" (1.27cm) | 2 5/8" (6.66cm) | 9 1/4" (23.49cm) | 6 1/2" (16.51cm) | SQUARE |
| 13-1210A | 1/2" (1.27cm) | 2 3/4" (6.99cm) | 12 1/4" (31.11cm) | 9 3/4" (24.77cm) | SQUARE |
| 13-1211A 4pk | 1/2" (1.27cm) | 2 3/4" (6.99cm) | 12 1/4" (31.11cm) | 9 3/4" (24.77cm) | SQUARE |
| 13-0142A | 1/2" (1.27cm) | 2" (5.08cm) | 6" (15.24cm) | 3" (7.62cm) | SQUARE |
| 13-0144A | 1/2" (1.27cm) | 2 1/2" (6.35cm) | 7 3/4" (19.68cm) | 3" (7.62cm) | SQUARE |
| 13-0148A | 1/2" (1.27cm) | 3" (7.62cm) | 7 1/2" (19.05cm) | 3" (7.62cm) | SQUARE |
| 13-0138A | 9/16" (1.43cm) | 2 5/8" (6.66cm) | 12" (30.48cm) | 9 1/2" (24.13cm) | SQUARE |
| 13-0150A | 9/16" (1.43cm) | 2 1/2" (6.35cm) | 8" (20.32cm) | 3" (7.62cm) | SQUARE |
| 13-0160A | 9/16" (1.43cm) | 2 5/8" (6.66cm) | 8" (20.32cm) | 3" (7.62cm) | SQUARE |
| 13-0140A | 5/8" (1.59cm) | 2 5/8" (6.66cm) | 13" (33.02cm) | 9 1/2" (24.13cm) | SQUARE |
| 13-0141A | 5/8" (1.59cm) | 2 5/8" (6.66cm) | 9 1/2" (24.13cm) | 3" (7.62cm) | SQUARE |

SAE Grade 5 Dry Torque in Foot-Pounds:

7/16 = 54 ft·lb, 1/2 = 78 ft·lb, 9/16 = 114 ft·lb, 5/8 = 154 ft·lb

SAE Grado 5 Dry Torque en libras-pie:

7/16 = 54 ft · lb, 1/2 = 78 ft · lb, 9/16 = 114 ft · lb, 5/8 = 154 ft · lb



Universal Lift / Lowering Block Kits

Increases or decreases suspension height on most leaf spring applications.

Kits include aluminum blocks that can be installed below the leaf spring to raise the vehicle or on top of the leaf spring to lower the vehicle.

Heavy duty hardware and lift blocks are also available separately.

Complete visual card kits contain necessary hardware for one axle (2 Blocks, 4 U-Bolts, Nuts & Washers).



- 13-1000 kit - 1", Round U-Bolts (Boxed)
- 13-1001 kit - 1", Round U-Bolts
- 13-1030 kit - 2", Round U-Bolts (Boxed)
- 13-1031 kit - 2", Round U-Bolts (Visual Card)
- 13-1040 kit - 3", Round U-Bolts (Boxed)
- 13-1041 kit - 3", Round U-Bolts (Visual Card)
- 13-1131 Kit - 2", Square U-Bolts (Visual Card)



**Universal Lift / Lowering Blocks
Tempered Aluminum**

- 13-1081 2" Blocks, 2/1 Card
- 13-1091 3" Blocks, 2/1 Card

**Universal Lift / Lowering Blocks
Heavy Duty Steel**

- 13-1050 2" Blocks, 2/1 Box
- 13-1060 3" Blocks, 2/1 Box



Rear Axle Wedge Kit

2 Degree Pinion Shim Brings Pinion Angle Back When Using Lift Blocks.

NOTE! Should be used with all of our Lift and Lowering kits
13-1250 (2 Per Package)



Rear Lowering Shackle Kit

Lowering shackles provide a 1" or 2" drop to the rear of a vehicle for a more level look. Made of heavy duty die stamped steel.

- 13-4100 - 2" Drop Rear Lowering Kit (Boxed)
- 13-4200 - 2" Drop **NEW** Rear Lowering Kit (Boxed)
- 13-4300 - 1" Drop **NEW** Rear Lowering Kit (Boxed)



"500" Lift Kit

Designed For Additional Tire and Fender Clearance. For Most Cars Equipped with Leaf Springs. Easy To Install With A Choice Of Three Positions.

- 13-4000 Silver Finish (Boxed)



Shock Absorber Extender (2pcs) Front 2" Lifting
Chevy/GMC Lifting 2000 to 2006
Part No. 13-6520



Shock Absorber Extender (2pcs) Rear 2" Lifting
Chevy/GMC Lifting 1999 to 2014
Part No. 13-6530



Shock Absorber Extender (2pcs) Rear 2" Lowering
Chevy/GMC Lowering 2007 to 2014
Part No. 13-6540



Shock Absorber Extender (2pcs) Rear 2" Lowering
Chevy/GMC Lowering 1999-2006
Part No. 13-6550



Shock Absorber Extender (2pcs) Rear 2" Lowering
Ford Lowering 1992 to 2003
Part No. 13-6560



Shock Absorber Extender (2pcs) Rear 2" Lowering
Ford Lowering 2004 to 2013
Part No. 13-6570

Shock Stud Extender

No need for larger shocks when making a lift kit installation.
Fits all stud mounted shock absorbers.(2 Per Card)



13-6501 With 3/8" x 24 TPI Fine Thread: Fits All Except '69 And Later Fords
13-6521 With 3/8" x 16 TPI Coarse Thread: Fords '69 and Later

**Adjustable
Coil Spring
Lower or
Leveling Clamps**



- Lowers Springs
- Improves handling
- Zinc plated, SAE grade 5 steel

18-1220A (4 Sets Per Clamshell)

**Coil Spring
Two Way Adjustable
EXPANDER/TENSIONER**

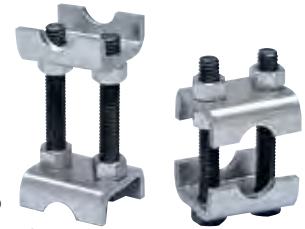

Adjustable unique device which spreads or compresses coil springs by turning nuts with a wrench. Dual saddles hold coil spring in proper alignment.

Adds 1"-2" Lift
18-1201 (2 Per Card)
18-1201A (4 Per Clamshell)

**Regular Rubber
Coil Spring Boosters**



1 1/2" thick strong rubber coil spring boosters add or restores lift to sagging springs and reduces bottoming out. Adds approximately 1" lift

18-1601 (4 Per Card)

**Heavy Duty
Coil Spring Spacers**



Spring Spacers are inserted between coils with a light tap of a hammer. They increase spring tension to prevent bottoming.

Adds 1" - 1 1/2" Lift
18-6001 (4 Per Card)

**Heavy Duty
Rubber Coil Spring
Boosters**

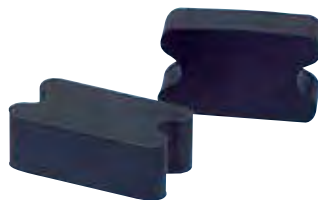

Strong rubber coil spring booster adds or restores lift to sagging springs and reduces bottoming out.

Adds 2" - 2 1/2" Lift
18-1701 (2 Per Card)
18-1701A (4 Per Clamshell)

**Twist-In Coil
Spring Spacers**

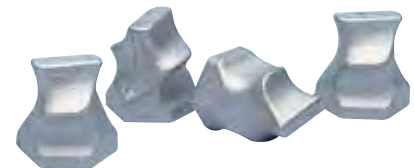

Design allows for easy installation. A light tap with a hammer traps the unit between coils and a wrench is used to screw in the unit to obtain increased tension.

Adds 1" - 1 1/2" Lift
18-8001 Front (4 Per Card)
18-9001 Rear (4 Per Card)

**Round Base Rubber
Coil Spring Booster**

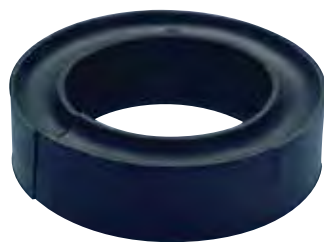

Strong rubber coil spring booster adds or restores lift to sagging springs and reduces bottoming out.

18-1901 - 1.5" Thick Adds 1" lift - 1 Per Card
18-1920 - 2 1/4" Thick adds up to 3" Lift - 1 Per Card

**Boost-O-Matic
Adjustable
Spring Boosters**

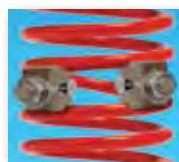
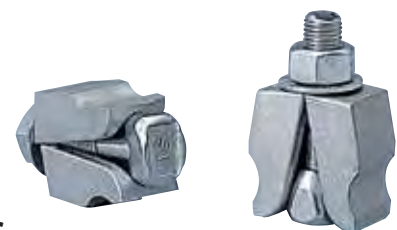

Adjustable mechanical boosters are inserted between coils. By tightening adjustable nut, the assembly wedges in tight to spread the coils and restore spring action.

Adds 1" - 1 1/2" Lift
18-1101 Rear (2 Per Card)
18-7001 Front (2 Per Card)



Universal Add-A-Leaf Kit
Fits Small Trucks
Toyota - Rangers - S10 - Dakota
Part No. 11-1060



Universal Add-A-Leaf Kit
Fits most vehicles with
2 1/4" Leaf Spring Assemblies
Part No. 11-1070



Universal Add-A-Leaf Kit
Fits most vehicles with
2 1/2" Leaf Spring Assemblies
Part No. 11-1080



Universal Add-A-Leaf Kit
Fits most vehicles with
3" Leaf Spring Assemblies
Part No. 11-1090



Leaf Springs Tie Bolt
(2 Sets Per Clamshell)
13-1260 Center Leaf Spring Tie Bolt 5/16" x 3"
13-1270 Center Leaf Spring Tie Bolt 3/8" x 3"
13-1280 Center Leaf Spring Tie Bolt 3/8" x 5"
13-1290 Center Leaf Spring Tie Bolt 1/2" x 8"



Leaf Spring Clamp Kit
Individual Leaf Springs Are Locked Together And Stabilized With These Clamps. Better Control For Rear Axle Torque Is Provided.
13-1401 Zinc Plated (1 Set Per Card) Up to 2 1/2" Leaf Springs
13-1401A Zinc Plated (2 Per Clamshell) Up to 2 1/2" Leaf Springs
13-1501A For New 11-1035 3" Overleaf Spring Assist. (2 Sets Per Clamshell)



**Adjustable Underleaf
Helper Spring Leaf Design**

These 3-way adjustable rear leaf helper springs provide increased load capacity and stability. Available for cars, station wagons, pickups, vans and trailers using 1 3/4", to 2 1/2" leaf sizes. (Boxed)

- 11-1010 Up to 1,000 lbs. for Passenger Car
- 11-1020 Up to 1,500 lbs. for Light Trucks
- 11-1050 Up to 500 Lbs. for compact and import cars. (Not Shown)



Over Leaf Spring Assist

Increase level load carrying capacity by 1,000 lbs. with one pair. Add additional capacity by 1,500 lbs. or more with two pair (Sold Separately). Hardware included.

- 11-1030 Fits 1 3/4" to 2 1/2", Up to 1,000 lbs. (Boxed)
- 11-1035 Fits 3" Up to 1,500 lbs. (Boxed)

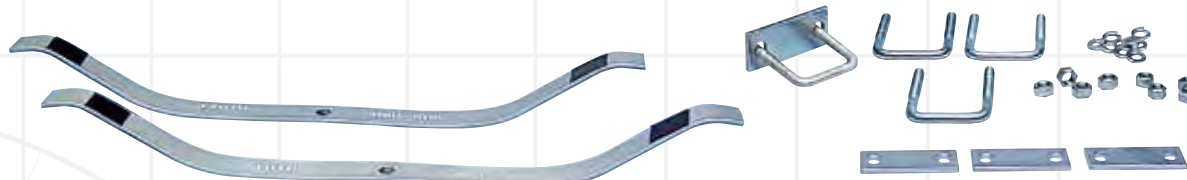

**R.V. Heavy Duty
Underleaf Helper Springs**

Helps to eliminate sagging from soft suspension, providing better performance and improved handling. Gives added life for larger tires and custom wheels. Provides up to 2,000 lbs. overload capacity. Used for off-highway where additional clearance is required. Easy to install or remove. Hardware included. Fits up to 2 1/2" leaf spring.

- 11-1040 Up to 2,000 lbs. (Boxed)

Load Control Springs for Rear Shock Absorbers

The following are designed with a unique variable pitch to ensure a safe and comfortable ride regardless of load or road conditions. Adjustable spring fits easily over O.E.M. shock absorbers. (Boxed)

Loadmaster

14-0490 Up to 750 lbs.

Best Ride

Heavy enamel coating prevents squeaks and rattles. 14-0890 Up to 1,250 lbs. for Light Trucks

Heavy Duty Best Ride

Fits most heavy duty shock absorbers. Protected with a heavy enamel coating. 14-1890 Up to 1,250 lbs.

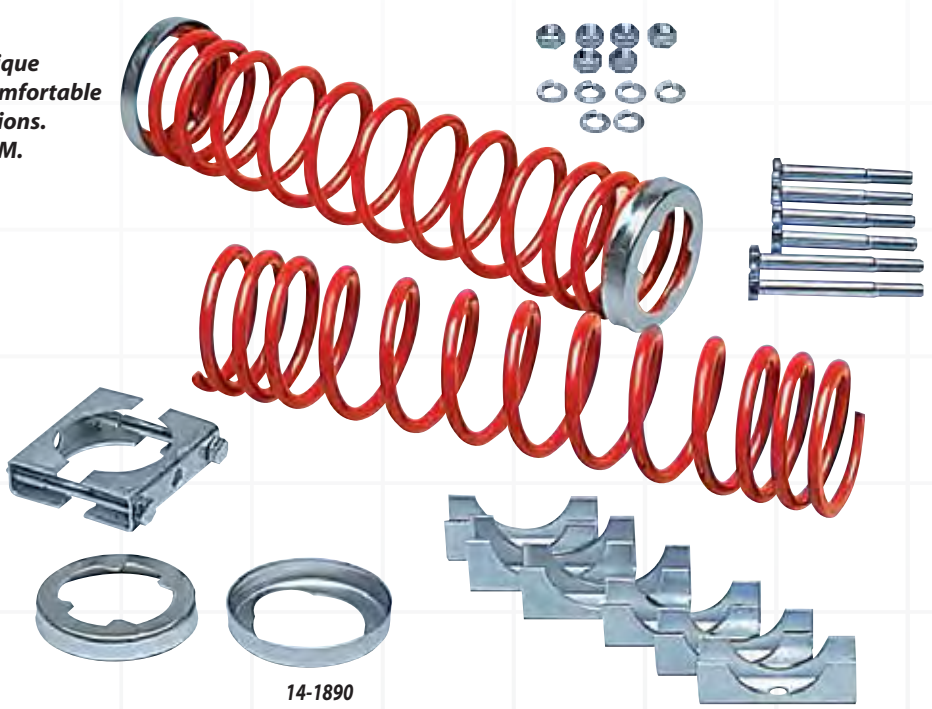

Heavy Duty Helper Springs Coil Design

These specially engineered helper springs provide new life and safety to sagging springs, while offering a "softer" ride when not overloaded. (Boxed)

- 12-0750 Up to 1,000 lbs. for Passenger Car
- 12-1500 Up to 1,500 lbs. for Vans & Light Trucks
- 12-1600 Up to 2,000 lbs. for Light Trucks & RV's

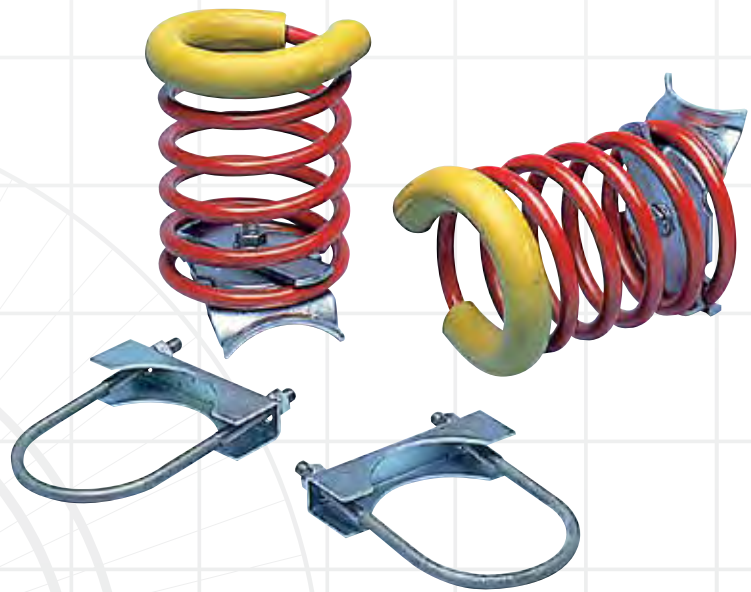



Tie Rod End Dust Boot 1 3/8"
Black 20-0500B



Tie Rod End Dust Boot 1 3/8"
Red 20-0500R



Shock Eye Bushing Set
Black 20-0600B



Bump Stop 2 1/8"
Black - 20-0100B



Bump Stop 11/16"
Black - 20-0110B

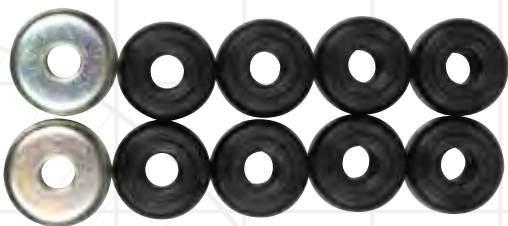

End Link Grommet Set
Black 20-0200B

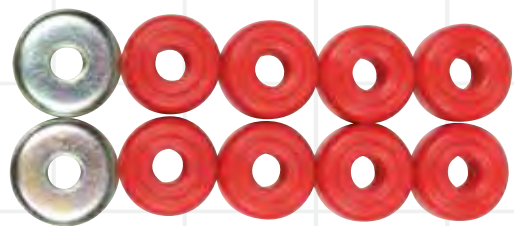

End Link Grommet Set
Red 20-0200R

COMING SOON!

TRAILER HUB KIT
4 - Lug on 4" Bolt Pattern Hub
Fits 1-1/16" Spindle, 4 stud, 1250lbs.

KIT INCLUDES:
1 Hub, 2 Bearings, Axle Seal, Studs, Lugs & Caps.
Cast Iron hub is rated at 1250 lbs. capacity for added safety
Wheel Hub Kits make hub and bearing repair/replacement a snap.
Part No. 15-0440



TRAILER HUB KIT
5 - Lug on 4.5" Bolt Pattern Hub
Fits 1-1/16" Spindle, 5 stud, 1250lbs.

KIT INCLUDES:
1 Hub, 2 Bearings, Axle Seal, Studs, Lugs & Caps.
Cast Iron hub is rated at 1250 lbs. capacity for added safety
Wheel Hub Kits make hub and bearing repair/replacement a snap.
Part No. 15-0545



TRAILER HUB KIT
5 - Lug on 5" Bolt Pattern Hub
Fits 1-3/8" Spindle, 5 stud, 1750lbs.

KIT INCLUDES:
1 Hub, 2 Bearings, Axle Seal, Studs, Lugs & Caps.
Cast Iron hub is rated at 1750 lbs. capacity for added safety
Wheel Hub Kits make hub and bearing repair/replacement a snap.
Part No. 15-0550

