

ALL PARTS ARE TO BE INSTALLED BY A CERTIFIED ASE TECHNICIAN



**1995 - 2002 Lincoln Continental**  
Rear Gas Shock Replacement

**39F-12-R**

**Installation Instructions**



Before you begin the removal or installation, please read all or the instructions thoroughly!  
The warranty will be void if instructions are not followed exactly. Do not work under a vehicle supported by a jack.  
Always support the vehicle safety standards.



BEFORE YOU BEGIN THE REMOVAL OR INSTALLATION, PLEASE READ ALL OF THE INSTRUCTIONS THOROUGHLY!

THE WARRANTY WILL BE VOID IF INSTRUCTIONS ARE NOT FOLLOWED EXACTLY. DO NOT WORK UNDER A VEHICLE SUPPORTED BY A JACK.

**ALWAYS SUPPORT THE VEHICLE ON SAFETY STANDS.**

## Removal

**WARNING:** These vehicles are equipped with gas-pressurized shock absorbers which will extend unassisted. Do not apply heat or flame to the shock absorber tube during removal. Failure to follow these instructions can result in personal injury.

**CAUTION:** The shock absorbers act as the rebound stops for the rear suspension. When rear shock absorbers are removed, the lower suspension arms and air suspension height sensor must be restrained to prevent damage to these components.

**NOTE:** The shock absorber's electronic actuator mechanism is not serviceable. Install a new shock absorber.

**NOTE:** The semi-active shock absorber is shown in the following procedure. The procedure for the non-semi-active shock absorber is similar.

**1. WARNING:** The electrical power to the air suspension system must be turned off prior to hoisting, jacking or towing an air suspension vehicle. Failure to do so can result in unexpected inflation or deflation of the air springs, which can result in shifting of the vehicle during these operations.

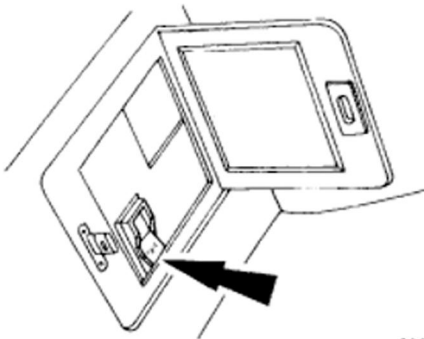

AY0003-B

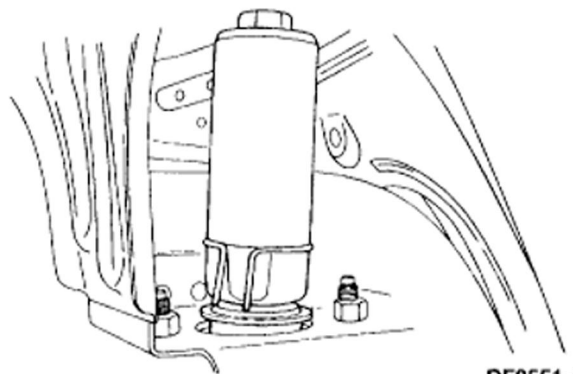

DF0551-A

**Turn off the air suspension service switch.**

- 2. Remove the side trim panel in the trunk, and remove and discard the mass damper retaining clip.**
- 3. Raise the vehicle on a hoist.**
- 4. Remove the wheel and tire assembly.**
- 5. WARNING: Do not remove an air spring under any circumstance when there is pressure in the air springs. Do not remove any components supporting an air spring without exhausting the air. Failure to follow these instructions can cause personal injury. Deflate the air spring**

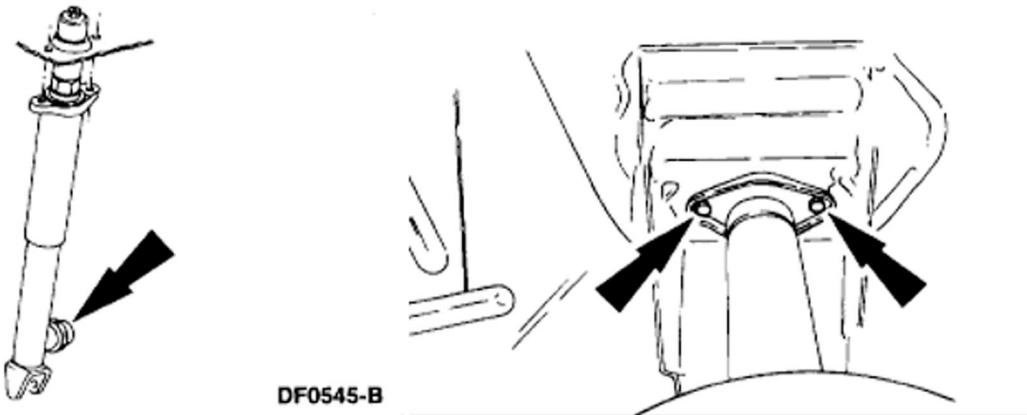

- 6. If so equipped, disconnect the shock absorber electrical connector and wiring routing retaining clips.**

- 7. Remove the two upper shock absorber mounting bolts.**

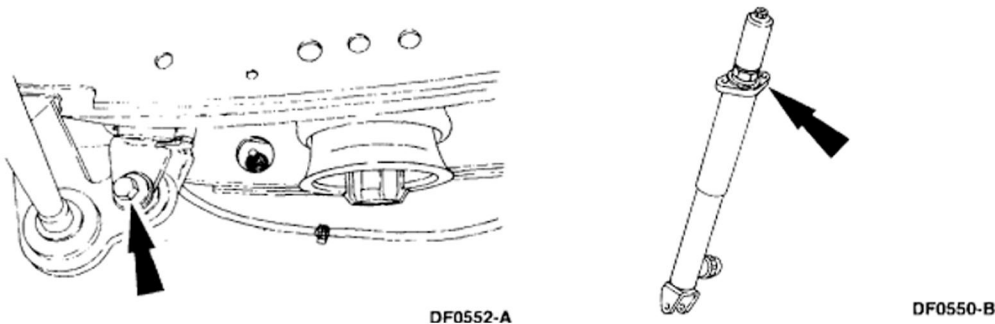

- 8. Remove the lower shock absorber mounting nut and bolt.**

- 9. Remove the shock absorber, the mounting bracket and the mass damper assembly.**

## Installation

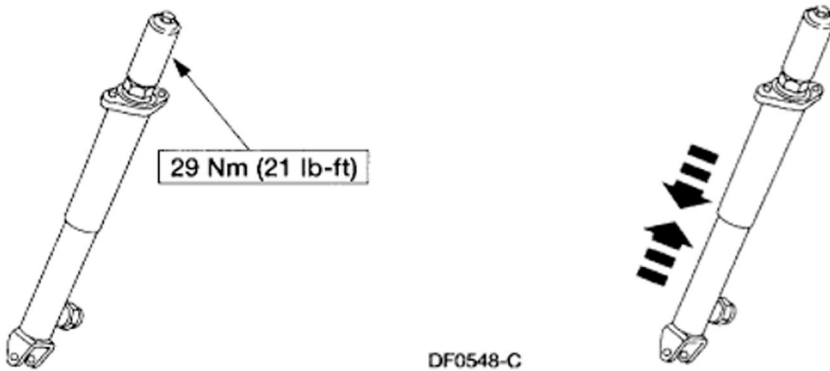

1. Install the rear shock absorber mounting bracket and the mass damper.
2. Hold the shock absorber upright. Stroke the shock absorber several times to remove air from the working cylinder.
3. **NOTE:** If so equipped, the electronic actuator must face the rear of the vehicle.

### Position the shock absorber in the vehicle.

1. Position the shock absorber through the shock tower mounting hole.
2. Compress the shock absorber, and align the shock absorber mounting clevis with the rear wheel spindle.
3. install the lower shock absorber mounting bolt and nut.

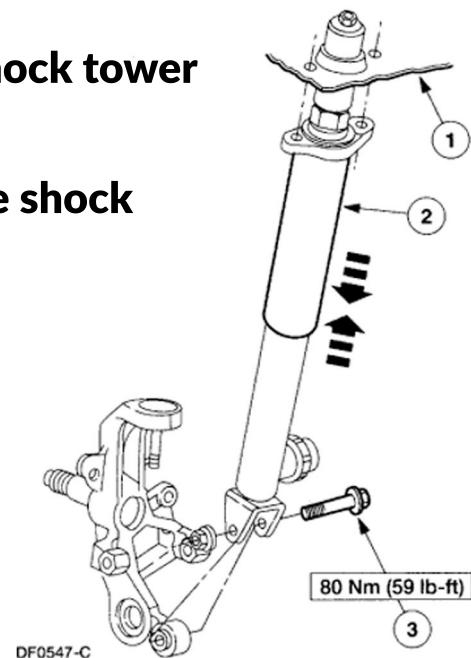



BEFORE YOU BEGIN THE REMOVAL OR INSTALLATION, PLEASE READ ALL OF THE INSTRUCTIONS THOROUGHLY!

THE WARRANTY WILL BE VOID IF INSTRUCTIONS ARE NOT FOLLOWED EXACTLY. DO NOT WORK UNDER A VEHICLE SUPPORTED BY A JACK.

**ALWAYS SUPPORT THE VEHICLE ON SAFETY STANDS.**

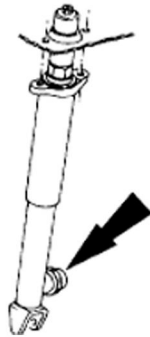
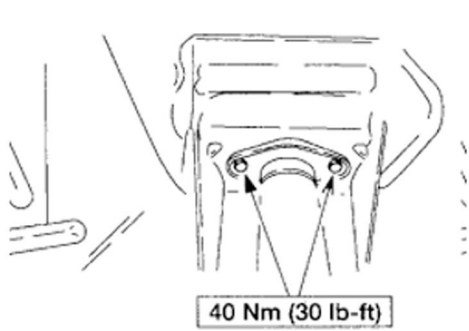

DF0545-R

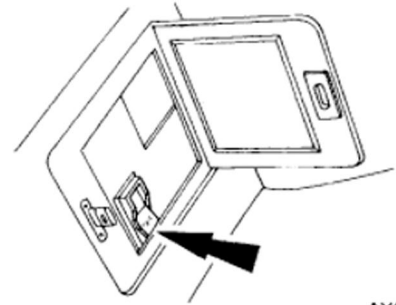

AY0003-B

- 4. Install the two upper mounting bolts.**
- 5. If so equipped, connect the shock absorber electrical connector and install the wiring retaining clips to the lower arm.**
- 6. Install the wheel and tire assembly.**
- 7. Lower the vehicle.**
- 8. Turn on the air suspension service switch.**
- 9. Install the side trim panels.**