

ALL PARTS ARE TO BE INSTALLED BY A CERTIFIED ASE TECHNICIAN



2005-2009 Jaguar Super 8

2004-2009 Jaguar Vanden Plas

2010 Jaguar XJ

2004-2009 XJ8

2004-2009 XJR

Air Suspension Compressor

117J-20

Installation Guide

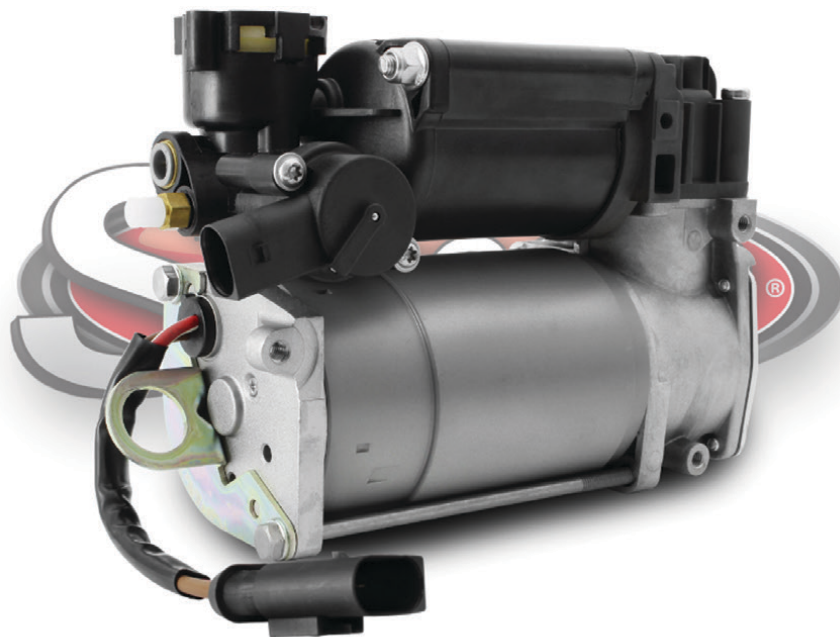

Revision 2417

BEFORE YOU BEGIN THE REMOVAL OR INSTALLATION, PLEASE READ ALL OF THE INSTRUCTIONS THOROUGHLY!

THE WARRANTY WILL BE VOID IF INSTRUCTIONS ARE NOT FOLLOWED EXACTLY. DO NOT WORK UNDER A VEHICLE SUPPORTED BY A JACK.

ALWAYS SUPPORT THE VEHICLE ON SAFETY STANDS.



BEFORE YOU BEGIN THE REMOVAL OR INSTALLATION, PLEASE READ ALL OF THE INSTRUCTIONS THOROUGHLY!

THE WARRANTY WILL BE VOID IF INSTRUCTIONS ARE NOT FOLLOWED EXACTLY. DO NOT WORK UNDER A VEHICLE SUPPORTED BY A JACK.

ALWAYS SUPPORT THE VEHICLE ON SAFETY STANDS.

1. Disconnect Battery

2. Remove Front Driver Side Wheel



3. Remove Front Skid Plate

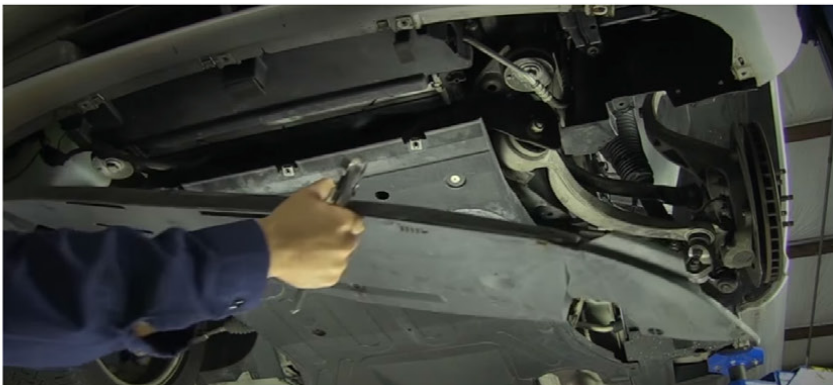

4. Remove Inner Wheel Well



5. Disconnect Electrical Connectors and Air Line. Loosen Hose Clamp and Disconnect Large Air Hose.

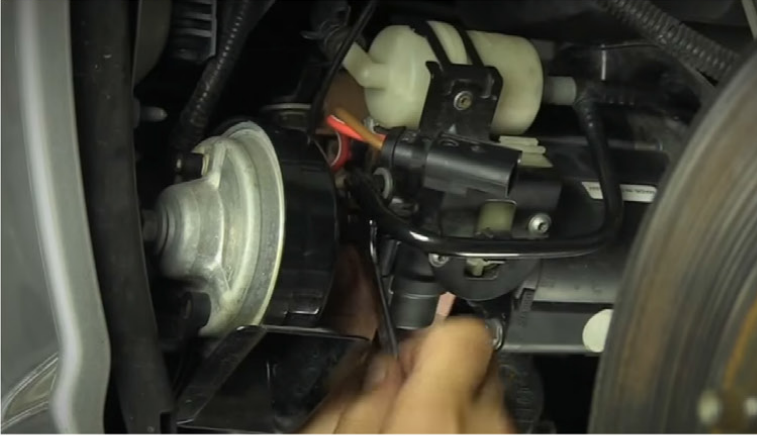

6. Remove Retaining Bolts to Remove Compressor.



7. Remove Brass Fitting From Air Line by First Opening the Collet and Then Sliding Off.



8. Remove Torx Screws to Release Air Filter Bracket.



9. Remove Intake Pipe by Pushing In Bezel Around Tube and Pull Out at the Same Time.

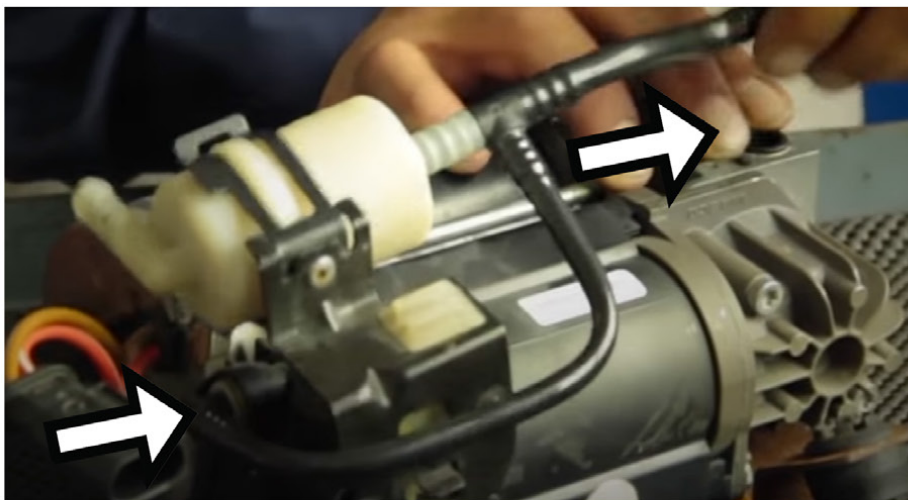

10. Replace Air Filter Bracket on New Compressor. Push in Intake Pipe and Install Torx Screws to Secure.



11. Transfer Vibration Isolators and Hardware to New Compressor.

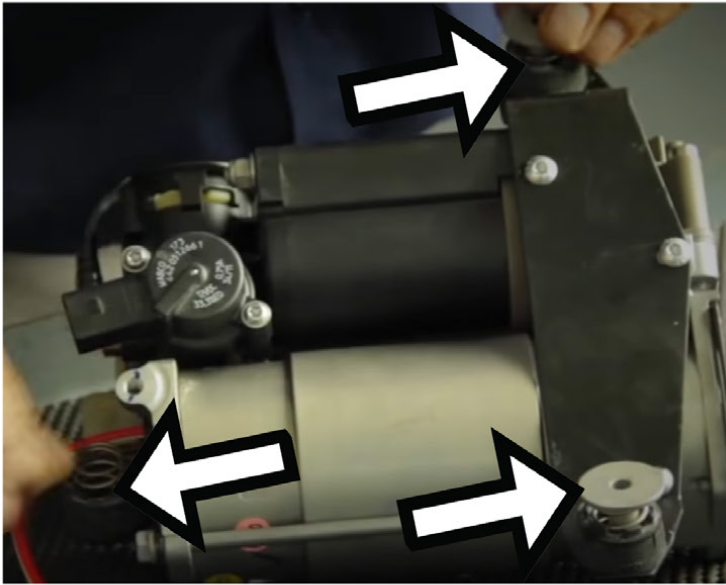

12. Install Compressor in to Vehicle and Secure Using Retaining Bolts.

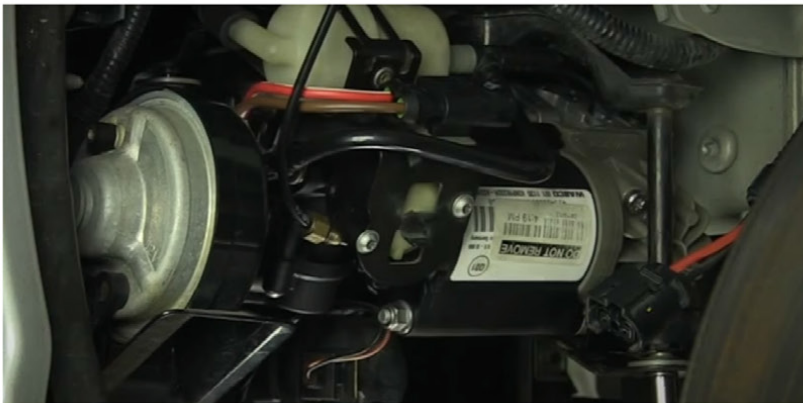

13. Reconnect Electrical Connectors, Large Rubber Hose With Clamp, and Push Air Line in to Fitting on Compressor.





BEFORE YOU BEGIN THE REMOVAL OR INSTALLATION, PLEASE READ ALL OF THE INSTRUCTIONS THOROUGHLY!

THE WARRANTY WILL BE VOID IF INSTRUCTIONS ARE NOT FOLLOWED EXACTLY. DO NOT WORK UNDER A VEHICLE SUPPORTED BY A JACK.

ALWAYS SUPPORT THE VEHICLE ON SAFETY STANDS.

14. Reinstall Inner Wheel Well and Front Skid Plate.



15. Reconnect Battery.

Mandatory Relay Replacement

NOT REPLACING AIR SUSPENSION RELAY WILL VOID WARRANTY

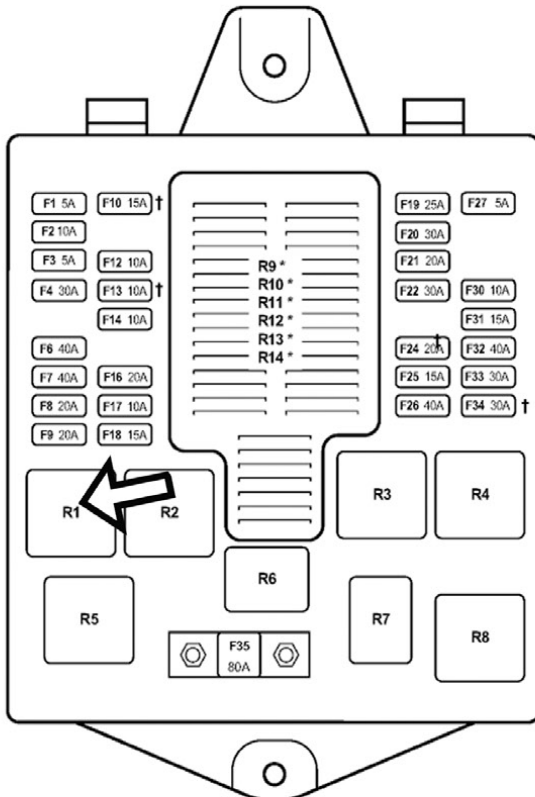

**XJ
Front Distribution Fuse Box**

FRONT POWER DISTRIBUTION FUSE BOX
* NON-SERVICEABLE PCB RELAYS

ALL PARTS ARE TO BE INSTALLED BY A CERTIFIED ASE TECHNICIAN

Learn more about suspension parts on our website.