

ALL PARTS ARE TO BE INSTALLED BY A CERTIFIED ASE TECHNICIAN



- 2000 Cadillac Escalade**
- 2002-2014 Cadillac Escalade**
- 2003-2014 Cadillac Escalade ESV**
- 2002-2013 Cadillac Escalade EXT**
- 2007-2013 Chevrolet Avalanche**
- 2003-2006 Chevrolet Avalanche 1500**
- 2003-2006 Chevrolet Avalanche 2500**
- 2000-2013 Chevrolet Suburban 1500**
- 2000-2013 Chevrolet Suburban 2500**
- 2000-2014 Chevrolet Tahoe**
- 2000-2014 GMC Yukon**
- 2000-2014 GMC Yukon XL 1500**
- 2000-2013 GMC Yukon XL 2500**

Rear Air Shocks Z55 Autoride Suspension - W/ Bypass

**109G-14-R**

## **Installation Instructions**



BEFORE YOU BEGIN THE REMOVAL OR INSTALLATION, PLEASE READ ALL OF THE INSTRUCTIONS THOROUGHLY!

THE WARRANTY WILL BE VOID IF INSTRUCTIONS ARE NOT FOLLOWED EXACTLY. DO NOT WORK UNDER A VEHICLE SUPPORTED BY A JACK.

**ALWAYS SUPPORT THE VEHICLE ON SAFETY STANDS.**

## Removal Procedure

- 1. Raise and support the vehicle. Refer to Lifting and Jacking the Vehicle**
- 2. Support the rear axle.**

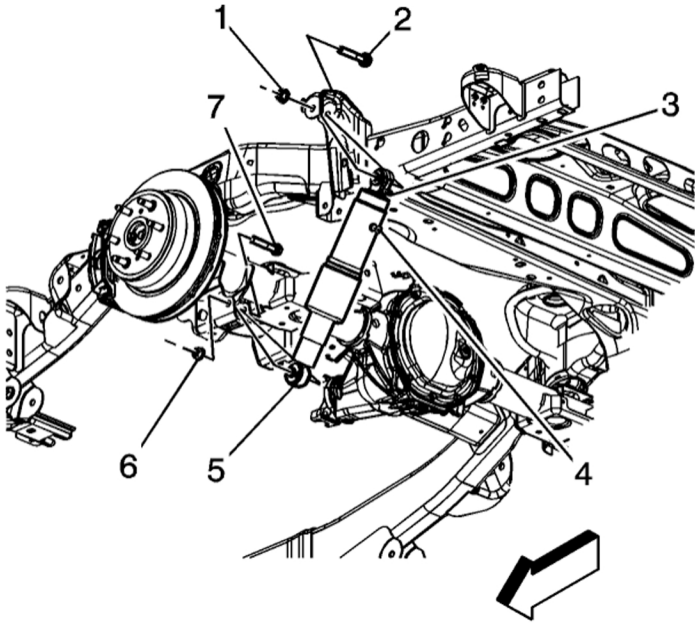

- 3. Disconnect the electronic suspension control connector (3), if equipped.**
- 4. If the vehicle is equipped with air leveling, perform the following:**
  - Turn the ignition On, with the engine off.**
  - Install a scan tool.**
  - With the scan tool, exhaust the air from the system for at least 60 seconds.**

**Note: There will be a minimal amount still in the air in the air lines.**

- 5. Disconnect the air line, if equipped (4).**
- 6. Remove the upper shock absorber nut (1) and the bolt (2).**
- 7. Remove the lower shock absorber nut (6) and the bolt (7).**
- 8. Remove the shock absorber (5).**



BEFORE YOU BEGIN THE REMOVAL OR INSTALLATION, PLEASE READ ALL OF THE INSTRUCTIONS THOROUGHLY!

THE WARRANTY WILL BE VOID IF INSTRUCTIONS ARE NOT FOLLOWED EXACTLY. DO NOT WORK UNDER A VEHICLE SUPPORTED BY A JACK.

**ALWAYS SUPPORT THE VEHICLE ON SAFETY STANDS.**

## Installation Procedure

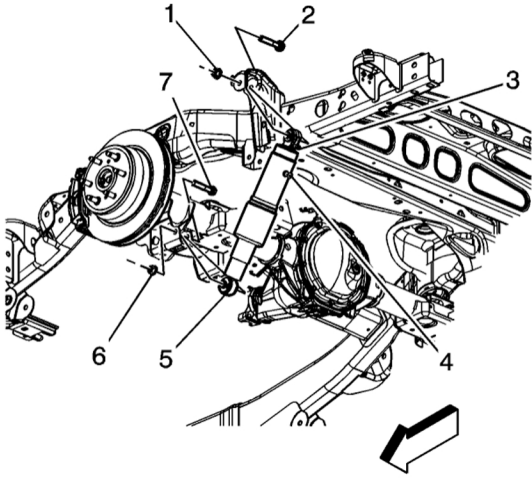

- 1. Install the shock absorber (5).**
- 2. Install the upper shock absorber nut (1) and the bolt (2).**
- 3. Install the lower shock absorber nut (6) and bolt (7).**
- 4. Tighten the upper and lower shock absorber nuts (1) and (5) to 115 Nm (85 lb ft).**
- 5. Reconnect the electronic suspension control connector, if equipped (3).**
- 6. Reconnect the air line (4), if equipped.**
- 7. Remove the support from the rear axle.**
- 8. Lower the vehicle.**
- 9. If the vehicle is equipped with air leveling, perform the following:**
  - Turn the ignition ON, with the engine OFF.**
  - Install a scan tool.**
  - With the scan tool, operate the air compressor for 30 seconds or until rear of the vehicle begins to rise.**
  - Remove the scan tool.**
  - Cycle the ignition OFF, then back ON, with the engine ON to allow the air suspension system to regain the desired rear suspension position.**