

STEMCO Hubodometer and Bracket Installation Instructions

NOTE: LUBRICANT MAY NEED TO BE ADDED PRIOR TO BRACKET INSTALLATION.

1. Install hubcap with proper gaskets and installation methods provided by hubcap manufacturer.
2. Split lock washers are recommended to secure the hubcap bolts in place.
3. Fill to proper lubricant level.
4. Mount Hubodometer® to face of bracket using the supplied flat washer and lock nut.
5. Use 15-ft lbs. of torque to tighten locknut.
DO NOT USE AIR IMPACT WRENCH. DO NOT EXCEED 15-ft. lbs. OF TORQUE.
6. If necessary, use strap wrench to hold Hubodometer® while tightening.
7. **DO NOT USE PAINTS, SOLVENTS OR THINNERS ON THE HUBODOMETER® FACE, GRILAMID HUB CAP OR HUBODOMETER® HUB CAP WINDOW.**
8. Remove necessary bolts for bracket installation.
SOME LUBRICANT MAY DRAIN. REFILL AS NECESSARY.
9. Mount bracket and Hubodometer® assembly.
10. Split lock washers are recommended to secure the bolts in place.
11. Proper length grade 5 or higher bolts are recommended to secure hubodometer bracket.
See chart below.
12. Torque bolts to the recommended Hubcap Torque specifications, see figure below for STEMCO hubcap bolt torque specifications.

The recommended torque for the 3/8" pipe plug for aluminum hub caps is 9 ft.-lbs. A suitable sealant may be used on the pipe plug threads if desired. On Grilamid hub caps with plastic fill plug and o-ring, tighten to torque not to exceed 10 in.-lbs. *See Figure for Assembly example.*

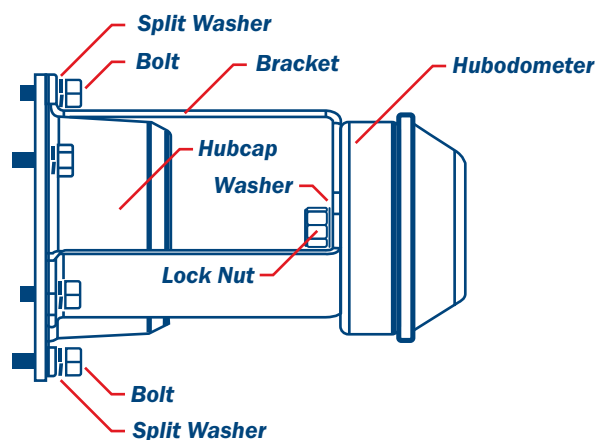

Hub Cap Mounting Bolts		
Bolt Size	Torque	Bolt Length
3/16"	8-10 ft. lbs.	1"
1/4"	8-12 ft. lbs.	1"
5/16"	12-16 ft. lbs.	1-1/4"
3/8"	16-20 ft. lbs.	1-1/4"
7/16"	18-22 ft. lbs.	1-1/4"
1/2"	20-24 ft. lbs.	1-1/2"
3/4"	24-28 ft. lbs.	1-3/4"
7/8"	26-30 ft. lbs.	2"
6 MM	8-12 ft. lbs.	25 MM
8.5 MM	12-16 ft. lbs.	30 MM

IMPORTANT: HUBODOMETER® MUST BE ACCURATELY CENTERED ON WHEEL.

Installation Instructions for STEMCO Hubodometer® - Rear Wheel Truck or Bus Mount

Part Numbers 610-0011 and 610-0025

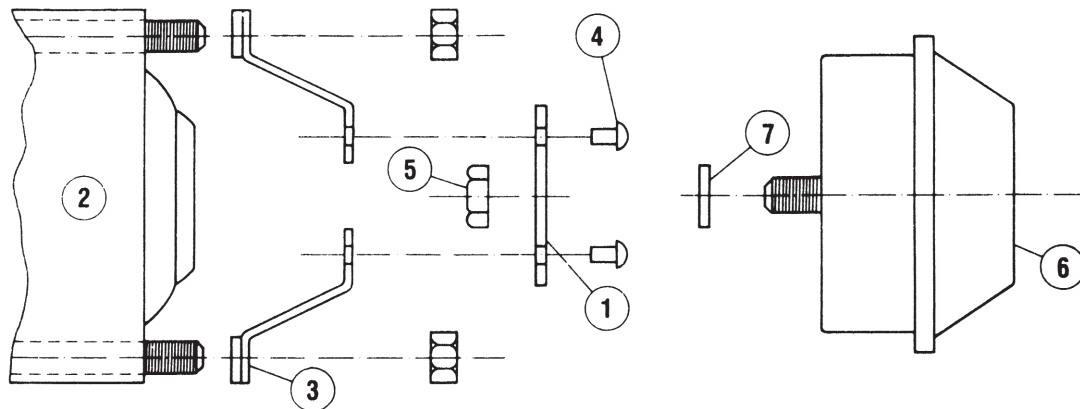

1. Drill two 3/16" holes on each end of mounting strap (#1) at marks corresponding to bolt circle diameter of rear wheel axle (#2).
2. Open single hole in support angles (#3) if necessary to fit axle studs or bolts.
3. Cut and trim strap 3/8" beyond rivet holes on both ends.
4. Assemble angles (#3) to mounting strap (#1) as per drawing, using 4 rivets (#4) supplied. Trim angles to conform to contour of axle if necessary.
- 5 **IMPORTANT:** Place washer (#7) on Hubodometer® stud.
6. Mount Hubodometer® (#6) on strap using 1/2" locknut (#5) supplied. It is recommended that a strap wrench be used to hold Hubodometer® while tightening. Do not clamp Hubodometer® flange in a vise. Do not exceed 15 ft/lbs torque.
7. Mount strap assembly to axle.
8. To clean Hubodometer® face, use a damp cloth to prevent scratches. Do not use solvents, paints or thinners.



STEMCO®

A Higher Standard of Performance.™

TQM™
TOTAL QUALITY MAINTENANCE™

Learn more about wheels & tires accessories we have.