

DLXTH SERIES



DLXTHR SERIES



DLXTHU SERIES



Thinline
ONLY 0.84"

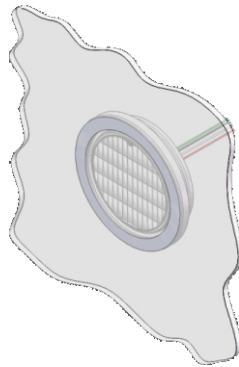

DLXTHR-7



DLXTHU-8



DLXTHU-9

Specs & Features:

Flush mount warning [LED light](#)

- 25 customer selectable flash patterns, including steady-on
- 6 STAR Generation 4 LEDs
- Circuitry is fully encapsulated within housing
- Trapezoidal optics (DLXTHR)
- Window mount option available
- Also available with weatherproof connector pre-installed on heads
- Ambulance retrofit kit also available
- 10-30VDC input
- SAE Class I & California Title 13 available
- Steady Burn cool white: 315LM @ 24°C
- S-Link System™ synchronizing capability with other Star LED units



LED DLXTH MODEL NUMBER GENERATOR

DL TH _ - _ _ _

Pattern

- X = Flashing
- N = Steady Burn

Series

- R = 4" Round
- U = Oval

Mount Type

- 1 = Flush Mount Bezel
- 2 = No Mount (lighthouse only)
- 4 = Rubber Grommet
- 5 = Recessed Chrome Ring
- 7 = Window Bezel
- 8 = Rubber Grommet w/Weatherproof Connector
- 9 = Ambulance Retrofit Kit (oval only)

Plating

- = Black
- C = Chrome

Color

- A = Amber (1),(13 DLXTHR)
- W = Cool White (1)
- R = Red (2)
- BC = Blue LED Clear Lens (1,13)
- GC = Green LED Clear Lens
- RC = Red LED Clear Lens (1,13)

DLXTHR SERIES

Mount Type	Overall Diameter (in)	Overall Height (in)	Hole Size (in)
Flush Mount Bezel	5.09	0.84	N/A
Rubber Grommet	5.35	N/A	4.50
Recessed Chrome Ring	5.43	N/A	4.50

DLXTHU SERIES

Mount Type	Overall Width (in)	Overall Length (in)	Overall Height (in)
Flush Mount Bezel	0.84	7.20	3.05
Rubber Grommet	1.00	7.50	3.34



Rubber Grommet



Flush Mount Bezel



Recessed Chrome Ring

1: SAE Class 1

2: SAE Class 2

13: California Title 13