

256TCL

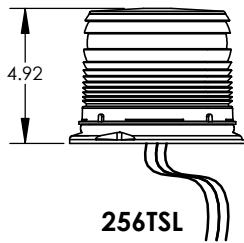

256TSL

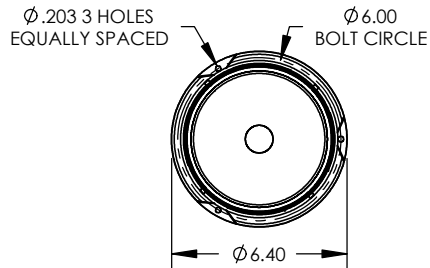

FLANGE or PIPE MOUNT - PIPE SIZE - 1-11¹/₂ NPT

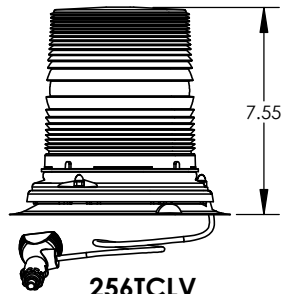

256TCLV

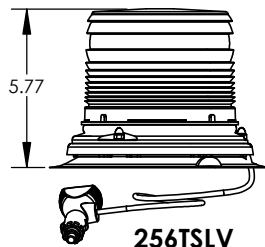

256TSLV

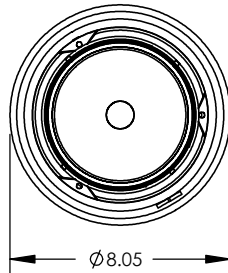

VACUUM MAGNET MOUNT

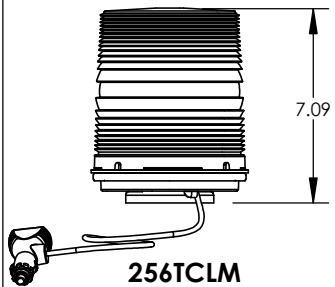

256TCLM

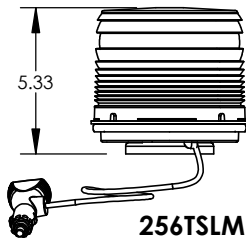

256TSLM

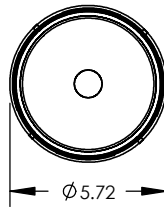

MAGNET MOUNT

REV.	ECR	DESCRIPTION	DATE
-	12178	INITIAL DRAWING REQUEST	8/21/14
A	12428	ADDED 12V ONLY MODEL INFORMATION	01/07/15

12-24V MODELS AVAILABLE

MODEL	DESCRIPTION
256TCL-A	256 C-2 LED TALL DOME BEACON - AMBER
256TCL-C	256 C-2 LED TALL DOME BEACON - CLEAR
256TSL-A	256 C-2 LED SHORT DOME BEACON - AMBER
256TSL-C	256 C-2 LED SHORT DOME BEACON - CLEAR
256TCLV-A	256 C-2 LED VAC MAGNET TALL DOME BEACON - AMBER
256TCLV-C	256 C-2 LED VAC MAGNET TALL DOME BEACON - CLEAR
256TSLV-A	256 C-2 LED VAC MAGNET SHORT DOME BEACON - AMBER
256TSLV-C	256 C-2 LED VAC MAGNET SHORT DOME BEACON - CLEAR
256TCLM-A	256 C-2 LED MAGNET TALL DOME BEACON - AMBER
256TCLM-C	256 C-2 LED MAGNET TALL DOME BEACON - CLEAR
256TSLM-A	256 C-2 LED MAGNET SHORT DOME BEACON - AMBER
256TSLM-C	256 C-2 LED MAGNET SHORT DOME BEACON - CLEAR

12V ONLY MODELS AVAILABLE

MODEL	DESCRIPTION
256TCL-12V-A	256 C-2 LED TALL DOME BEACON - AMBER
256TSL-12V-A	256 C-2 LED SHORT DOME BEACON - AMBER
256TSL-12V-C	256 C-2 LED SHORT DOME BEACON - CLEAR

UNLESS OTHERWISE SPECIFIED

DIMENSIONS ARE IN INCHES

TOLERANCES:

ANGULAR: ± 2 DEG.

.X ± .100

.XX ± .020

.XXX ± .005

.XXXX ± .001

RoHS COMPLIANT: Yes

MATERIAL:

N/A

FINISH:

N/A

DRAWN BY: SWN

DRAWING APPROVED BY ECR

THE INFORMATION CONTAINED IN THIS DRAWING IS THE SOLE PROPERTY OF STAR HEADLIGHT & LANTERN CO., INC.. ANY REPRODUCTION IN PART OR AS A WHOLE WITHOUT THE WRITTEN PERMISSION OF STAR HEADLIGHT & LANTERN CO., INC. IS STRICTLY PROHIBITED.

STAR HEADLIGHT & LANTERN CO., INC.

MODEL: 256TSL, TCL, TSLM, TCLM, TSLV, TCLV

TITLE:
256 SERIES CLASS 2 MODEL DRAWING

DWG. NO.

256 C-2

REV

A

SCALE: 1:12

DO NOT SCALE FROM DRAWING

SHEET 1 OF 2



REV.	ECR	DESCRIPTION	DATE
-	12178	INITIAL DRAWING REQUEST	8/21/14
A	12428	ADDED 12V ONLY MODEL INFORMATION	01/07/15

FOR OTHER CLASS 2 BEACONS
SEE MODEL DRAWING 240 C-2

-- 12V ONLY PRODUCT INFORMATION --

- ELECTRICAL
 - VOLTAGE: 10 -16VDC
 - AMP DRAW: 0.43 MAX
 - REQUIRES 5 AMP FUSE
 - 3-WIRE CONNECTION or CIG PLUG
 - BLACK - NEG. GROUND
 - RED - + POWER
 - GREEN - PATTERN SELECT
 - WIRE - 18AWG 6" LONG
 - CIG PLUG LENGTH - 12'
 - 28 FLASH PATTERNS
- APPROVALS
 - SAE CLASS II
- MECHANICAL:
 - BASE: POLYCARBONATE
 - DOME: POLYCARBONATE
 - MOUNTING: SURFACE OR POLE or MAGNET
 - GASKET and MOUNTING HARWARE INCLUDED

-- 12-24V PRODUCT INFORMATION --

- ELECTRICAL
 - VOLTAGE: 10 -30VDC
 - AMP DRAW: AVG. 0.4A
 - REQUIRES 5 AMP FUSE
 - 3-WIRE CONNECTION or CIG PLUG
 - BLACK - NEG. GROUND
 - RED - + POWER
 - GREEN - PATTERN SELECT
 - WIRE - 18AWG 6" LONG
 - CIG PLUG LENGTH - 12'
 - 28 FLASH PATTERNS
- APPROVALS
 - SAE CLASS II
- MECHANICAL:
 - BASE: POLYCARBONATE
 - DOME: POLYCARBONATE
 - MOUNTING: SURFACE OR POLE or MAGNET
 - GASKET and MOUNTING HARWARE INCLUDED

UNLESS OTHERWISE SPECIFIED DIMENSIONS ARE IN INCHES TOLERANCES: ANGULAR: ± 2 DEG. .X ± .100 .XX ± .020 .XXX ± .005 .XXXX ± .001	DRAWN BY: SWN	STAR HEADLIGHT & LANTERN CO., INC.	
	DRAWING APPROVED BY ECR		
RoHS COMPLIANT: Yes	THE INFORMATION CONTAINED IN THIS DRAWING IS THE SOLE PROPERTY OF STAR HEADLIGHT & LANTERN CO., INC.. ANY REPRODUCTION IN PART OR AS A WHOLE WITHOUT THE WRITTEN PERMISSION OF STAR HEADLIGHT & LANTERN CO., INC. IS STRICTLY PROHIBITED.		MODEL: 256TSL, TCL, TSLM, TCLM, TSLV, TCLV
MATERIAL: N/A	FINISH: N/A		TITLE: 256 SERIES CLASS 2 MODEL DRAWING
DWG. NO. 256 C-2		REV A	
SCALE: 1:12	DO NOT SCALE FROM DRAWING	SHEET 2 OF 2	