

GF11038A

MASS AIR FLOW SENSOR INSTALLATION GUIDE

Please refer to the vehicle service manual for detailed instructions.

REMOVAL:

1. Disconnect the battery ground cable.
2. Remove air filter and replace as necessary. For oiled air filters, thoroughly clean re-usable filter with minimal oil to prevent sensor contamination.
3. Unplug MAF sensor connector. Ensure the weather seal is retained on the connector.
4. Remove sensor and save hardware for re-use.

INSTALLATION:

1. Clean mounting surfaces.
2. Install new quality air filter or thoroughly clean an existing reusable one.
3. Remove protective cover(s).
4. Replace sensor and tighten retained hardware per service manual. **DO NOT OVER TIGHTEN.**
5. Push the connector back on ensuring good electrical connection.
6. Reconnect the battery cable.
7. Clear any Diagnostic Trouble Codes (DTC's) stored in the PCM and reset any learned fuel trim values.

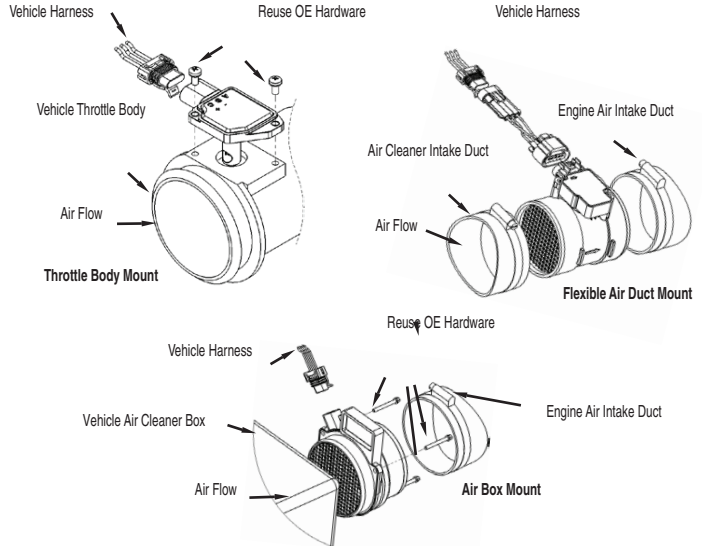

Looking for dependable replacement air intake parts?
Rely on Standard for quality and long-lasting products.