

## GF10666B

### Integral door lock actuator and multi-function switch replacement (Power door lock/switch/latch assembly)

#### REMOVAL

1. Disconnect negative battery cable.
2. Remove door lock/switch/latch assembly from door.
3. Unplug electrical connectors.
4. Remove two Torx screws (5).
5. Pivot door lock/switch assembly (1) downward to the right (or left for LH unit) to disengage actuating arm(2) and rubber bumper (3) from cavity of locking lever (8).

#### INSTALLATION

1. Latch assembly (4) must be in fully open position as shown in illustration. If not, push up on key cylinder rod lever (7) and then push down on the outside handle lever (6).
2. Before attaching new door lock/switch assembly (1) to latch assembly (4), rotate switch teeth (11) toward actuating arm (2) side of door lock/switch assembly (1) until stopped. Switch teeth (11) will then mesh correctly with fork bolt teeth (10) when both assemblies are mated.
3. Verify that rubber bumper (3) is on actuating arm (2)
4. Engage rubber bumper (3) and actuating arm (2) in cavity of locking lever (8), then pivot door lock/switch assembly (1) so that attaching screw holes are aligned with holes of latch assembly (4). Check that rubber bumper (3) and actuating arm (2) are fully seated in cavity.
5. Install two Torx screws (5).
6. Push inward on fork bolt (9) to check that it snaps into fully closed position without interference. Then return latch assembly 4 to fully open position as instructed in Step 1.
7. Remove and replace ALL rod attachment clips.
8. Plug in electrical connectors.
9. Assemble door lock/switch/latch assembly to door.
10. Reconnect negative battery cables.
11. Check door lock/switch latch for proper operations.

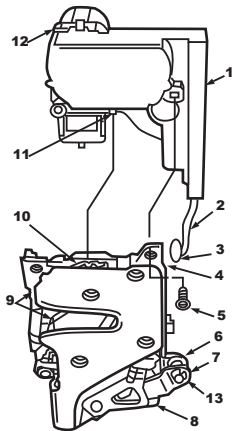

**STANDARD**