

# SHT999521B

## REPLACING A DOOR LOCK

### REMOVAL

1. Remove the lock button, inside trim screws, door handle and window crank with appropriate tools.
2. Using a trim pad removal tool between the trim panel and the door, pry the panel away from door. Don't pull on the door panel. Do not damage any fasteners. (See figure #1)
3. Peel back the paper/plastic watershield. Try not to tear the watershield, you will be reusing it. Only peel it as far as you need to work inside the door. Make sure you don't disturb any wiring. (See figure #2)
4. With an appropriate tool, pry off the door retaining clip. (See figure #3)
5. Pull lock cylinder from the door. Note the relative position of the lock pawl, lock rod and indexing boss on the lock cylinder. By twisting the lock cylinder you can free the lock pawl from the "Z" shaped lock rod. (See figure #4)

With some GM vehicles, however it may be necessary to remove a lock-to-pawl retaining clip before you are able to remove the lock assembly.

### REPLACEMENT

6. Transfer the pawl from the original lock to the new one if necessary. Make sure the gasket is in place and install the "Z" end of the lock rod into the door lock pawl, be sure that it engages properly. (See figure #5)
7. Insert the lock cylinder into the door and hold it in place. (See figure #6)
8. Reach inside the door and install the lock retaining clip. (See figure #7). Check operation of door/lock with key and by hand before reassembling door panel.

9. Replace the paper/plastic watershield and replace trim panel. (See figure #8)
10. Align the fasteners in the door panel with holes in the door. Firmly press the panel at each fastener to be sure they engage the door holes. (See figure #9)
11. Reinstall the arm rest, window crank, inside trim screws and lock button. (See figure #10)

### Ford Differences

On some Ford vehicles, it is necessary to remove the door trim panel to replace a door lock. Remove the "U" shaped door lock retainer clip from the edge of the door with an appropriate tool. (See figure #11)

The lock assembly can now be removed. (See figure #12)

If the lock assembly will not come out far enough to disconnect the lock from the pawl, remove the "E" clip from the end of the lock cylinder. (See figure #13)

Late model vehicles often have the door lock cylinder mounted into the door handle. Remove the inner door panel and trim to reach lock. The lock cylinder is retained by a small bolt, screw or spring clip. Remove screws or bolt to remove the lock and then proceed in the normal fashion. Transfer necessary clips or pawls from original lock to the replacement lock. When lock is retained by a spring clip, carefully note the position of the clip before removing it.

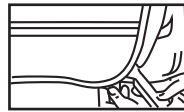

Fig. 1



Fig. 2



Fig. 3



Fig. 4

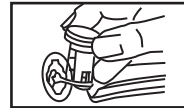

Fig. 5

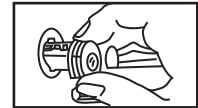

Fig. 6



Fig. 7

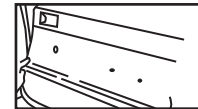

Fig. 8



Fig. 9

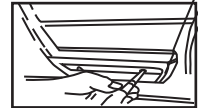

Fig. 10

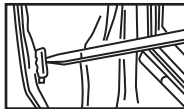

Fig. 11

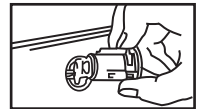

Fig. 12

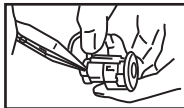

Fig. 13