

# FUEL SYSTEM SERVICE INSTRUCTION WORKSHEET

## TO REPAIR SOLEX CARBURETORS

GF1444V-2

### IMPORT CARS CARBURETOR ADJUSTMENT SPECIFICATIONS

**DISASSEMBLY:** Remove Carburetor parts as shown in the exploded view drawing. Replace all old parts with contents of repair kit.

**CAUTION:** Do not attempt to dismantle or adjust the Auto Starter (32). Correct adjustment is made during assembly at the factory, and once set does not change.

To insure proper setting of Viton Needle & Seat: bend the float arm so it just rests against the needle, Do not apply pressure on needle as the synthetic rubber can be so dented that an incorrect setting may result, thus affecting the proper fuel level in the bowl. After being compressed, the Viton very slowly recovers its original shape.

**CLEANING:** Cover manifold hole while the carburetor is off, to prevent dirt or dust from entering. Any approved carburetor cleaning solvent may be used. Use sufficient amount to cover the body assembly as well as all other parts, and allow to soak for ten minutes. Use a small stiff bristle brush to loosen or remove all dirt, carbon or gummy deposits. After soaking, rinse with clean solvent and blow out all openings and passages with compressed air. Reassemble carburetor.

To Repair Carburetor	Eng. Idle	
	Turns Open	R.P.M.
28PCI	3/4	-
22BIC,22ICBT, 28IBT	-	-
32PBIC	-	550 RPM
26ZIC,B26ZIC-2	-	-
28PICT	2,0	550-650
28.IDT-205	-	600

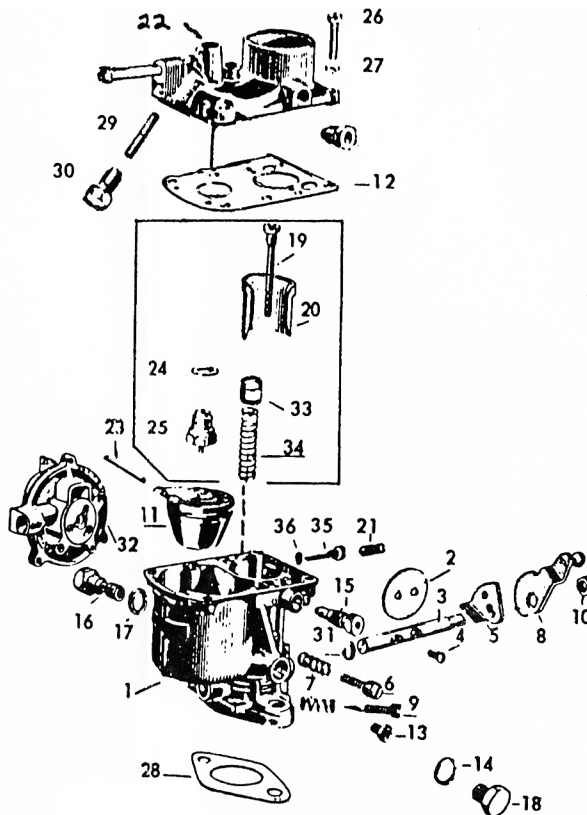

### TYPICAL ILLUSTRATION

☞ PARTS LIST SHOWN DOES NOT REFLECT THE CONTENTS OF THE KIT.

### PARTS LIST

Ref.	Description
1	BODY
2	Throttle butterfly
3	Throttle spindle
4	Throttle butterfly fixing screw
5	Throttle spindle abutment plate
6	Idle adjustment screw
7	Springs
8	Throttle lever
9	Volume control screw
10	Throttle nut
11	Float
12	Float cover gasket
13	Main jet
14	Washer, sealing plug
15	Pilot jet
16	Starter jet
17	Starter jet washer
18	Sealing plug
19	Emulsion tube
20	Choke tube
21	Choke tube screw
22	FLOAT CHAMBER COVER
23	Float pin
24	Needle valve washer
25	Needle valve complete
26	Float chamber screw
27	Washer
28	Flange gasket
29	Filter gauze
30	Filter plug
31	Dust proof ring
32	AUTO-STARTER
33	Auto-starter piston
34	Auto-starter piston spring
35	Piston stop screw
36	Washer
37	Bi-metal casing
38	Casing collar