

# INSTRUCTION SHEET

## OFF VEHICLE CARBURETOR SERVICE

### MIKUNI (FEEDBACK) - MODEL 30-32 DIDTF

08050-712

#### GENERAL EXPLODED VIEW

THE GENERAL DESIGN AND PARTS SHOWN WILL VARY TO  
INDIVIDUAL UNITS COVERED ON THIS INSTRUCTION SHEET.

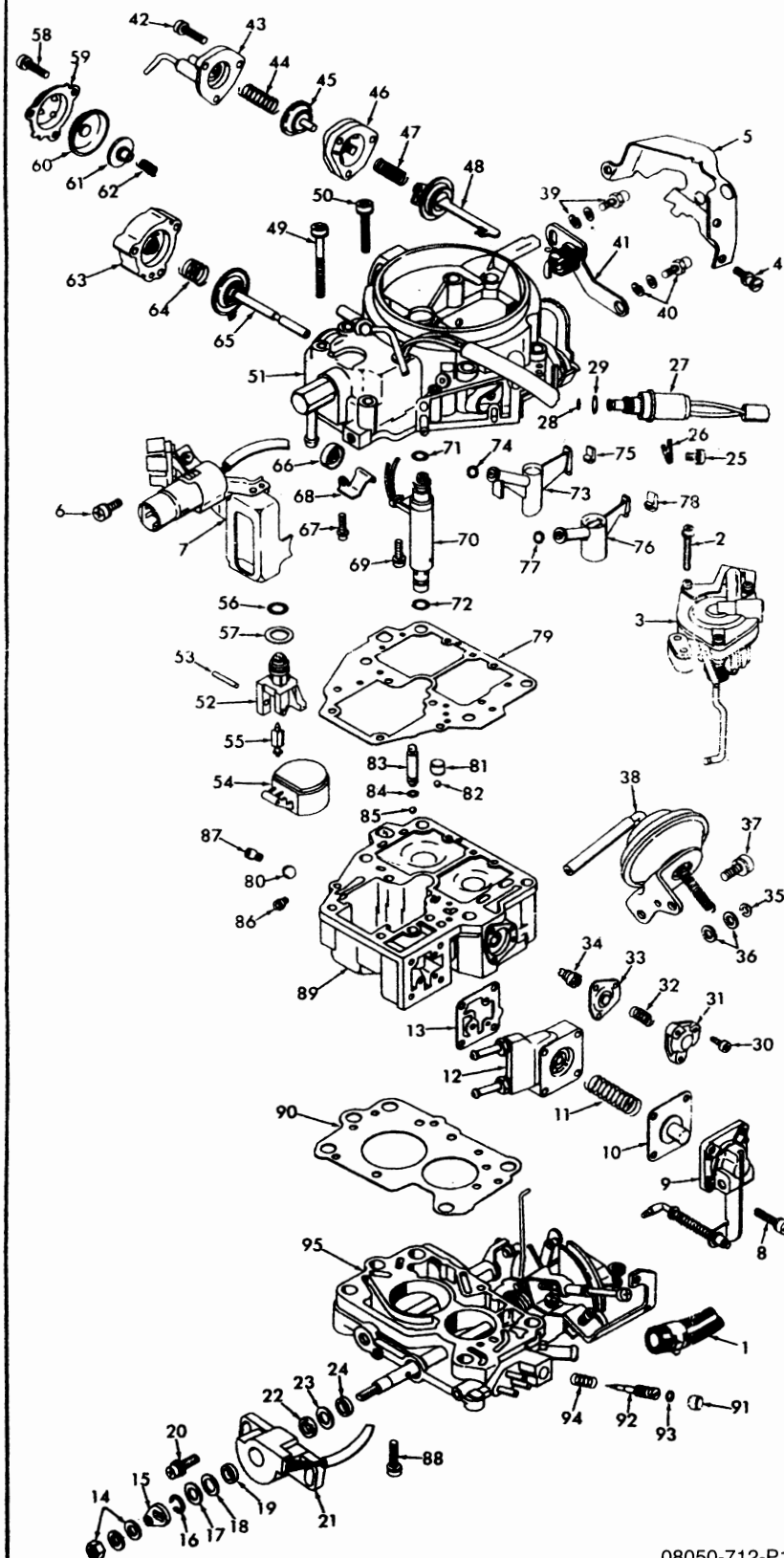

#### DISASSEMBLY

USE EXPLODED VIEW AS A GUIDE. THE NUMERICAL SEQUENCE MAY GENERALLY BE FOLLOWED TO DISASSEMBLE UNIT FAR ENOUGH TO PERMIT CLEANING AND INSPECTION. CAUTION: ALL DIAPHRAGMS AND SHAFT SEALS ARE NOT REPAIR KIT REPLACEMENT PARTS. HANDLE CAREFULLY. THEY WILL BE USED OVER.

#### SPECIAL NOTES

MARK AND DISCONNECT LEADS FROM HARNESS CONNECTORS WHERE NECESSARY.

TO REMOVE CHOKE COVER, GRIND OR FILE OFF (DO NOT DRILL) THE 2 ROLLED OVER SCREW HEADS ON SIDE OF COVER. SAW A SCREWDRIVER SLOT IN THE 3 BREAKAWAY SCREW HEADS. REMOVE SCREWS AND COVER.

ROD & LINK ENDS OR A SNAP FIT IN PLASTIC BRUSHINGS.

AFTER REMOVING CHOKE PINION & BRACKET ASSY. REMOVE CHOKE BREAKER DIAPHRAGM ASSY. THEN TEMPORARILY INSTALL BRACKET WITH LOWER SCREW TO RETAIN LEVER AND LARGE SPRING.

TO REMOVE IDLE ADJUSTING NEEDLE PLUG, DRILL AS SHOWN AND KNOCK OUT WITH A PIN PUNCH. BEFORE REMOVING IDLE ADJUSTING NEEDLE, TURN IN COUNTING THE NUMBER OF TURNS IT TAKES TO LIGHTLY SEAT NEEDLE AND RECORD FOR REASSEMBLY.

NEEDLE & SEAT (52) - SEAT IS A MOLDED PLASTIC PART. TAKE CARE IN CLEANING AND HANDLING FOR IT WILL BE USED OVER. KIT WILL FURNISH A NEW NEEDLE ONLY.

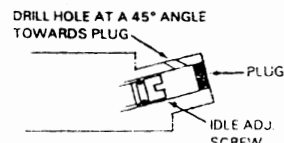

#### NOMENCLATURE

REF. NO.		REF. NO.	
1.	WATER HOSE & CLAMPS	46.	HOUSING - CHOKE BREAKER
2.	SCREW & LOCKWASHER (2) - ACTUATOR	47.	SPRING - INNER DIAPHRAGM
3.	DASHPOET & BLEUP ACTUATOR W/RETURN SPRING & BRACKET	48.	DIAPHRAGM ASSY. - CHOKE BREAKER (INNER)
4.	SCREW (3) - COVER	49.	SCREW & LOCKWASHER (3) - BOWL COVER (LONG)
5.	COVER - CHOKE	50.	SCREW & LOCKWASHER (2) - BOWL COVER (SHORT)
6.	SCREW & LOCKWASHER (2) - BRACKET	51.	BOWL COVER ASSY.
7.	BRACKET - HARNESS CONNECTORS	52.	SEAT, NEEDLE & FLOAT ASSY.
8.	SCREW & LOCKWASHER (4) - PUMP COVER	53.	PIN - FLOAT
9.	COVER LEVER & LINK ASSY. - PUMP	54.	FLOAT ASSY.
10.	DIAPHRAGM ASSY. - PUMP	55.	NEEDLE - FUEL
11.	SPRING - PUMP DIAPHRAGM	56.	O-RING - NEEDLE SEAT
12.	HOUSING - PUMP	57.	WASHER - NEEDLE SEAT
13.	GASKET - PUMP HOUSING	58.	SCREW & LOCKWASHER (3) - VENT VALVE
14.	NUT, LOCKWASHER, FLAT WASHER - LEVER	59.	COVER - VENT VALVE
15.	LEVER - PUMP ROD	60.	DIAPHRAGM (OUTER) - VENT VALVE
16.	C-CLIP - WASHER	61.	CENTER WASHER (PLASTIC) - DIAPHRAGM
17.	WASHER - PLASTIC (SEAL)	62.	SPRING - OUTER DIAPHRAGM (VENT VALVE)
18.	WASHER - METAL (SEAL)	63.	HOUSING & VALVE ASSY. - VENT VALVE
19.	SEAL - THROTTLE SENSOR	64.	SPRING - INNER DIAPHRAGM (VENT VALVE)
20.	SCREW & WASHERS (2) - THROTTLE SENSOR	65.	DIAPHRAGM (INNER) - VENT VALVE
21.	THROTTLE SENSOR ASSY.	66.	VALVE - VENT
22.	SEAL - THROTTLE SENSOR	67.	SCREW & LOCKWASHER - CLAMP
23.	WASHER - SEAL	68.	CLAMP - FEED BACK SOLENOID LOOM
24.	SEAL - THROTTLE SHAFT	69.	SCREW & LOCKWASHER - SOLENOID
25.	SCREW & LOCKWASHER - CLAMP	70.	SOLENOID ASSY. - FEED BACK
26.	CLAMP - SOLENOID	71.	O-RING - SOLENOID (UPPER)
27.	SOLENOID ASSY. - DECELERATION VALVE	72.	O-RING - SOLENOID (LOWER)
28.	O-RING - SOLENOID (INNER)	73.	VENTURI - SECONDARY
29.	O-RING - SOLENOID (OUTER)	74.	O-RING - SEC. VENTURI
30.	SCREW & LOCKWASHER (3) - COVER	75.	RETAINER - SEC. VENTURI
31.	COVER - POWER VALVE	76.	VENTURI - PRIMARY
32.	SPRING - DIAPHRAGM	77.	O-RING - PRI. VENTURI
33.	DIAPHRAGM ASSY. - POWER VALVE	78.	RETAINER - PRI. VENTURI
34.	POWER VALVE ASSY.	79.	GASKET - BOWL COVER
35.	E-CLIP - SECONDARY DIAPHRAGM LINK	80.	BALL - ANTI OVERFILL DEVICE
36.	WASHER (2) - LINK PIN	81.	WEIGHT - PUMP CHECK BALL
37.	SCREW & LOCKWASHER - SEC. DIAPHRAGM ASSY.	82.	BALL - PUMP CHECK (DISC)
38.	SECONDARY DIAPHRAGM & HOSE ASSY.	83.	PLUG - PUMP CHECK BALL (PLASTIC)
39.	SCREW & WASHERS - BRACKET (UPPER)	84.	O-RING - PLUG
40.	SCREW & WASHERS - BRACKET (LOWER)	85.	BALL - PUMP CHECK (INLET)
41.	CHOKE PINION & BRACKET ASSY.	86.	JET - PRI. MAIN
42.	SCREW & LOCKWASHER (3) - COVER	87.	JET - SEC. MAIN
43.	COVER - CHOKE BREAKER	88.	SCREW & WASHER - THROTTLE BODY
44.	SPRING - OUTER DIAPHRAGM	89.	BOWL - FUEL
45.	DIAPHRAGM ASSY. - CHOKE BREAKER (OUTER)	90.	GASKET - THROTTLE BODY
		91.	PLUG - IDLE NEEDLE CONCEALMENT
		92.	NEEDLE - IDLE ADJUSTING
		93.	O-RING - IDLE ADJ. NEEDLE
		94.	SPRING - IDLE NEEDLE
		95.	THROTTLE BODY ASSY.

#### CLEANING

CLEANING MUST BE DONE WITH CARBURETOR DISASSEMBLED. (DO NOT SOAK IN CARBURETOR CLEANER) CLEAN ALL THE PASSAGES AND BODIES OF THE CARBURETOR WITH SPRAY CARBURETOR CLEANER. MAKE CERTAIN THE THROTTLE BODY IS FREE OF ALL CARBON DEPOSITS. WASH OFF IN SUITABLE SOLVENT. BLOW OUT ALL PASSAGES AND JETS IN CASTINGS WITH COMPRESSED AIR AND CHECK CAREFULLY TO INSURE THOROUGH CLEANING OF OBSCURE AREAS. CAUTION: DO NOT USE CLEANING FLUIDS ON SOLENOIDS, DIAPHRAGMS, RUBBER PARTS, FLOAT OR SWITCHES.

# ADJUSTMENTS

## REASSEMBLY

RESEMBLE IN REVERSE ORDER OF DISASSEMBLY. NOTE SPECIAL INSTRUCTIONS AND ADJUSTMENTS

## SPECIAL INSTRUCTIONS

IDLE ADJUSTING NEEDLE (90) - TURN IN UNTIL LIGHTLY SEATED. THEN BACK OUT NUMBER OF TURNS RECORDED ON DISASSEMBLY.

## SMALL SPRING GUIDE

REF. NO.	LENGTH	DIAMETER
11	17/32"	27/64"
32	23/32"	5/16"
44	7/8"	11/32"
47	23/32"	11/32"
62	13/16"	1/4"
64	5/8"	7/16"

