

1. Clean hood shield mounting location.
2. Peel back tape liner.
3. Center hood shield and attach outer flanges with exposed tape. Remove tape liner. Attach center flanges with screws.
4. Apply pressure to tape flange.
5. **Optional Screw Attachment:** See detail below. **NOTE:** Use caution not to push too hard on self tapping screw and puncture outer hood surface!
6. Lower hood, adjust hood bumper stops if necessary. Apply bump-ons to hood surface.

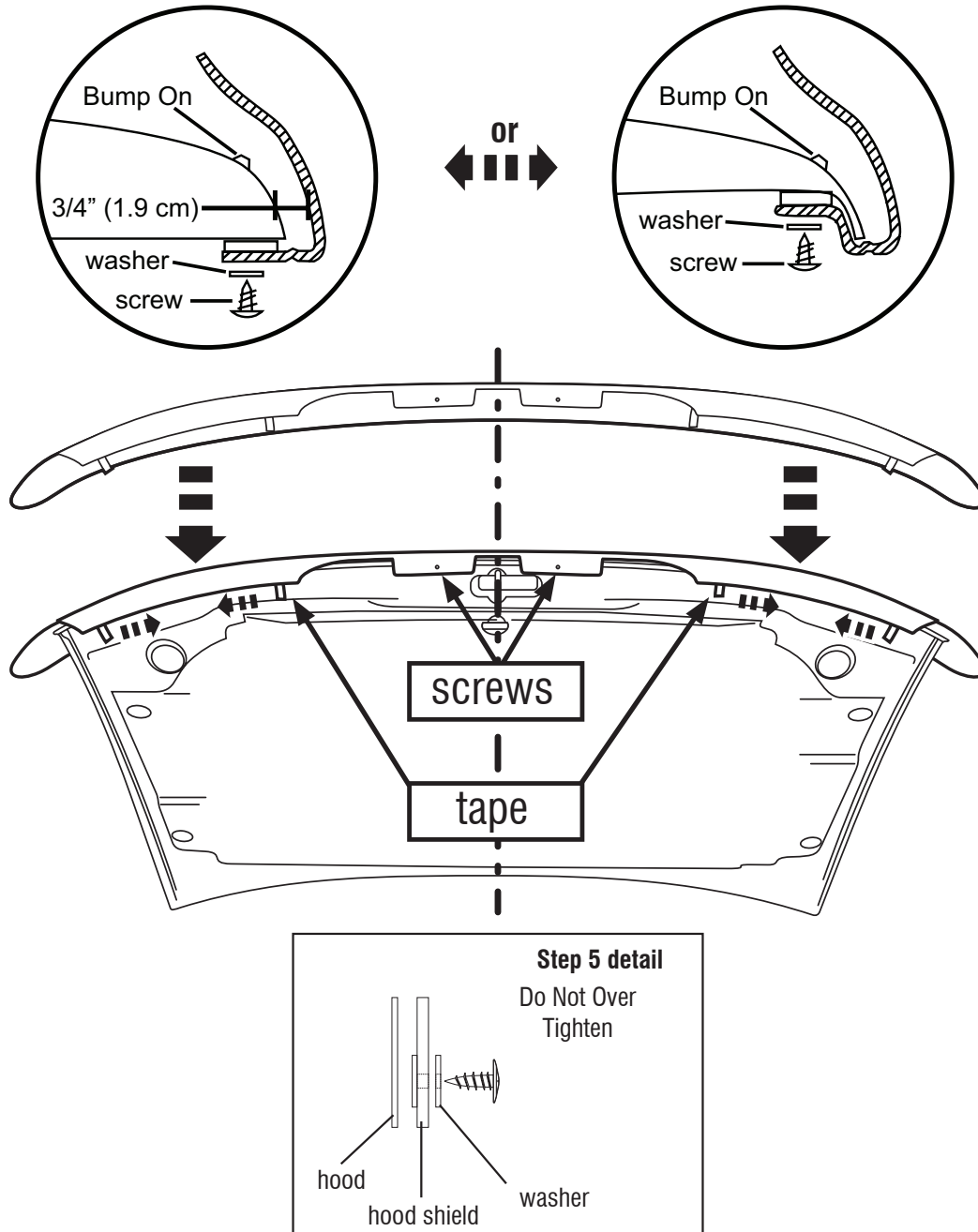

**IMPORTANT:** Before driving, ensure the hood shield is properly secured to vehicle. Clean with a **SOFT** cloth and soap and water **ONLY!** Using abrasive cleaners, chemicals, or solvents will **VOID** the warranty on this product.