

1. Open hood. Remove the rubber trim piece from the leading edge of hood. Discard rubber trim.
2. Align hood shield holes with holes in hood.
3. Assemble faster by threading screw into receptacle. Insert (1) fastener and screw until snug. Repeat for remaining (3) fasteners. (See detail below.)
4. Close hood and Install bump ons at pre-cleaned locations on the painted hood/fender surface.

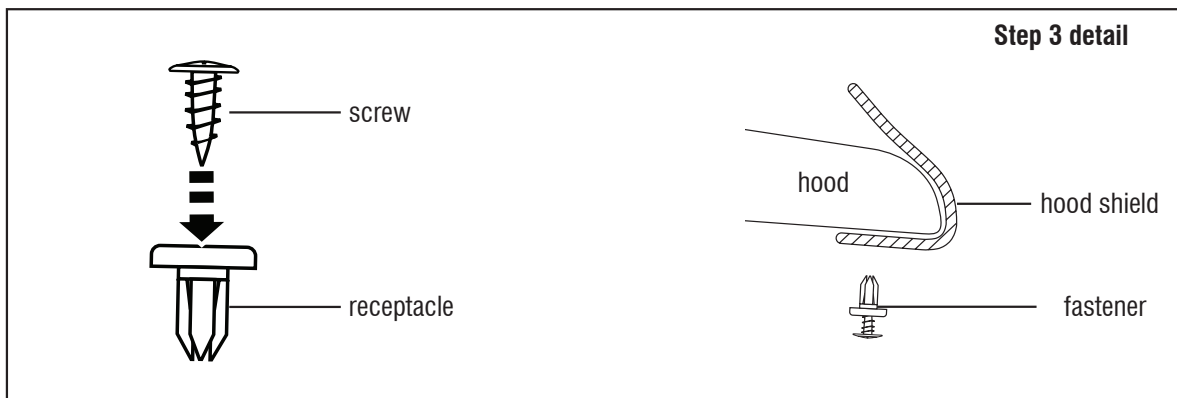
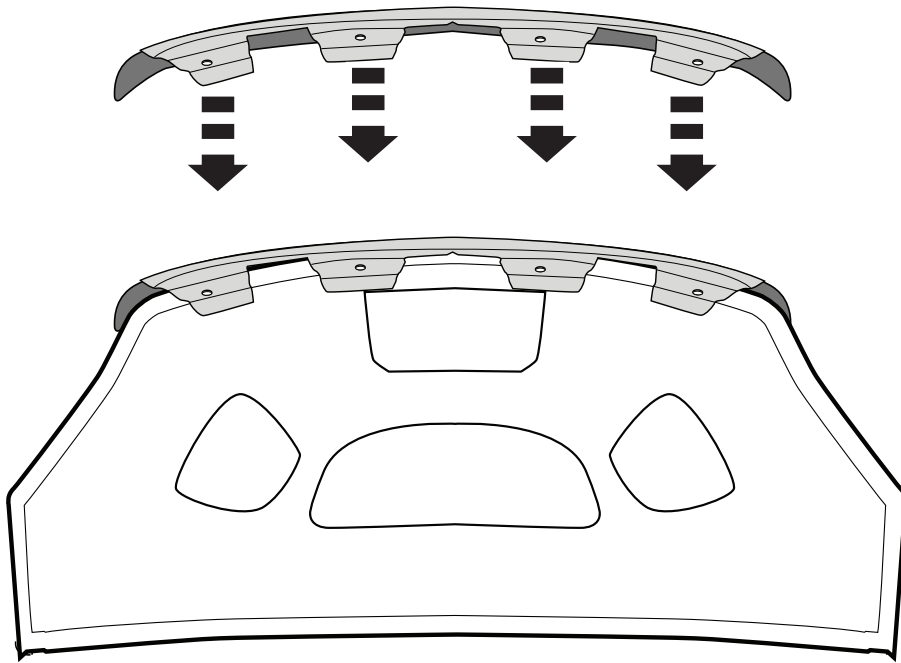

**IMPORTANT:** Before driving, ensure the hood shield is properly secured to vehicle. Clean with a **SOFT** cloth and soap and water **ONLY!** Using abrasive cleaners, chemicals, or solvents will **VOID** the warranty on this product.