

1. Open Hood.
2. If equipped, remove and discard rubber trim piece from front edge of hood.
3. Install (2) wellnuts on hood shield flanges using (2) machine screws and (2) washers. Tighten finger tight only at this point.
4. Align holes in hood shield with holes in hood in order to center part in place.
5. NOTE: observe the alignment from the side view in order to guide the hood shield with its attached well nut into the proper hole in the hood.
6. With the well nut inserted into hole in hood, secure hood shield to hood by tightening screw to expand well nut. Repeat for remaining fastener.
7. Insert (2) fasteners through the hood shield and into the hood and securely tighten.
8. Close hood. Clean four (4) locations on the painted hood surface with an alcohol pad. Apply four (4) bump ons as indicated.

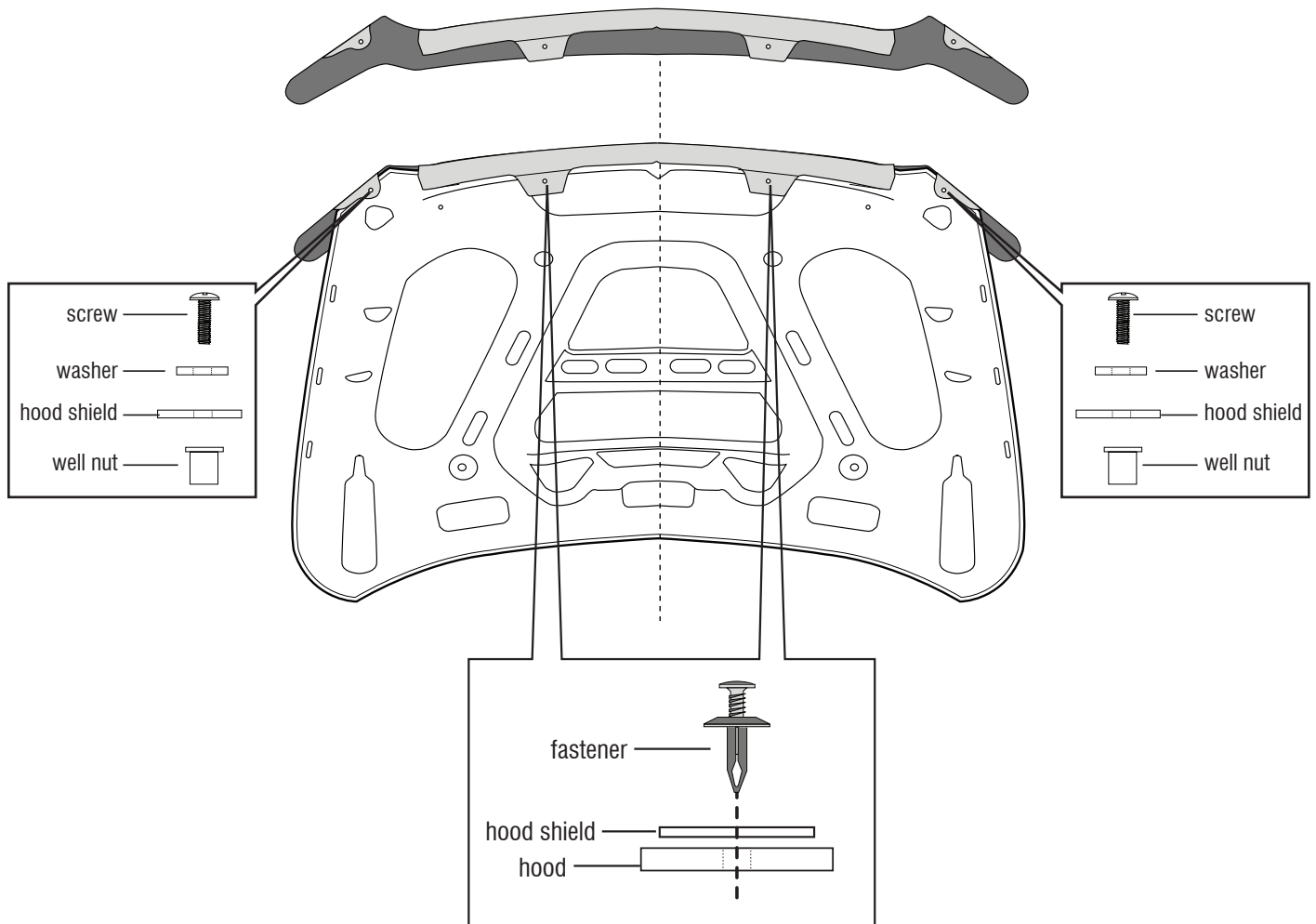

IMPORTANT: Before driving, ensure the hood shield is properly secured to vehicle. Clean with a **SOFT** cloth and soap and water **ONLY!** Using abrasive cleaners, chemicals, or solvents will **VOID** the warranty on this product.