

1. Open hood. Note the location of the rubber seal on leading edge of hood.
2. Center hood shield in place on hood. Use a grease pencil to mark the locations on rubber seal that correspond to holes in hood shield flange.
3. Remove hood shield from hood. Remove the corresponding factory installed rubber seal retaining fasteners that were marked in **Step 2**. **NOTE: Some applications may require additional fasteners to be removed in order to fully access the holes underneath.**
4. Center hood shield on hood, and slide hood shield flanges **UNDER** the rubber seal. Align hood shield flanges with holes in hood.
5. Install a fastener at each flange location. (See detail below.)
6. Close hood. Adjust hood bump stops to raise hood as needed.
7. Install bump ons at pre-cleaned locations on the painted hood surface.

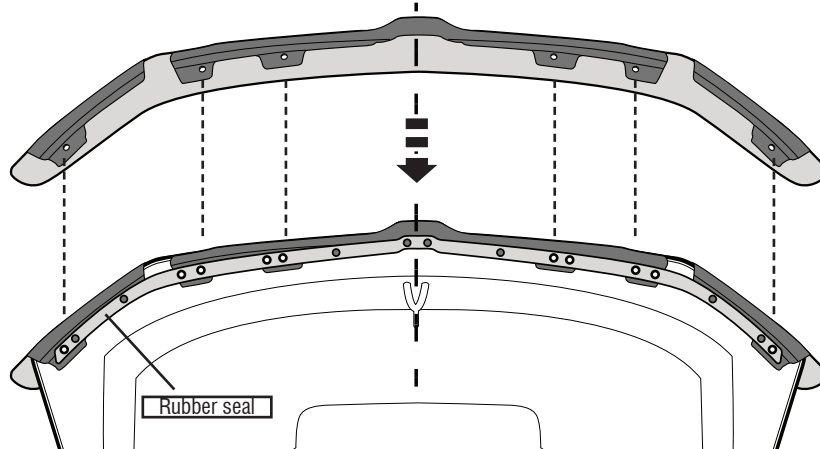

NOTE: Exercise extreme caution not to tear or damage the rubber seal when separating from hood.



Step 5

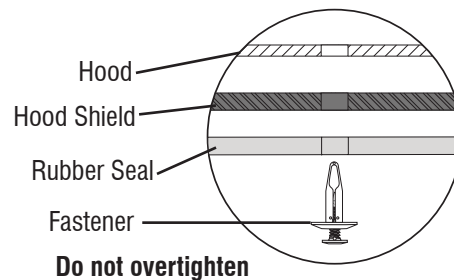
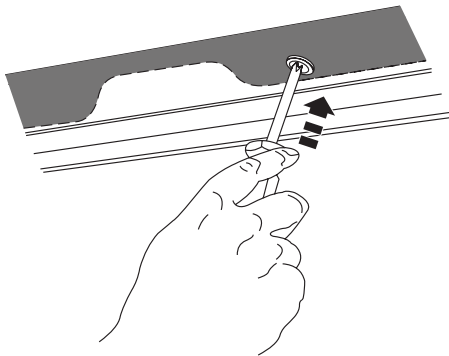

Step 7

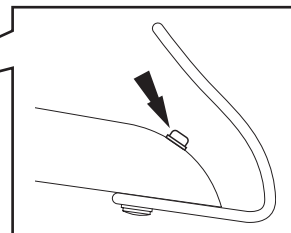
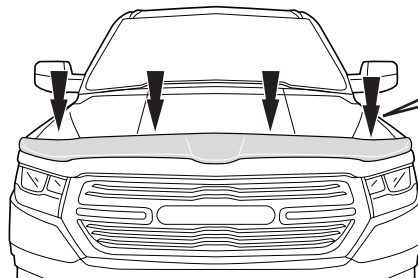

The material that your product is made from can be recycled. Please also consider recycling the packaging that your product came in.



IMPORTANT: Before driving, ensure the hood shield is properly secured to vehicle. Clean with a **SOFT** cloth and soap and water **ONLY!** Using abrasive cleaners, chemicals, or solvents will **VOID** the warranty on this product.

Learn more about wind deflectors on our website.