



SPYDER

WWW.SPYDERAUTO.COM

INSTALLATION GUIDE: ALT-YD-MITEVO1008-LED-(All)

Tools Needed:

- ¼" ratchet
- 10mm socket
- Panel popper

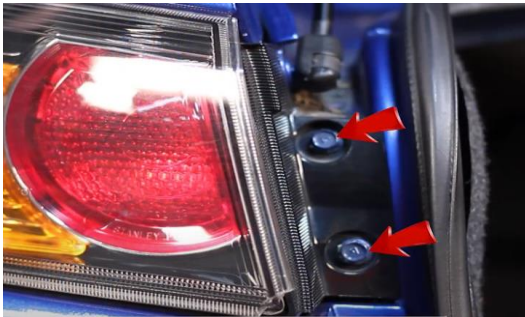

1. Remove (2x) 10mm bolts.



2. Remove (2x) plastic retainers.



3. Pull back trunk liner to access outer tail light harness.



4. Disconnect outer tail light harness.



5. Unseat outer tail light.

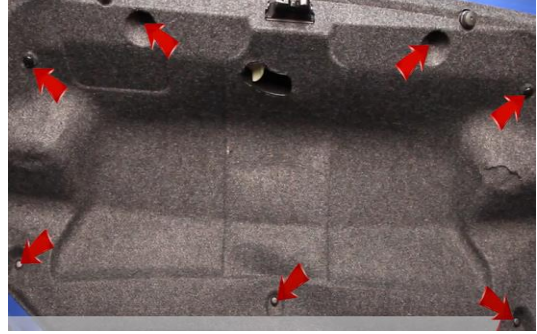

6. Remove (7x) plastic retainers on trunk lid.



7. Remove trunk lid liner.

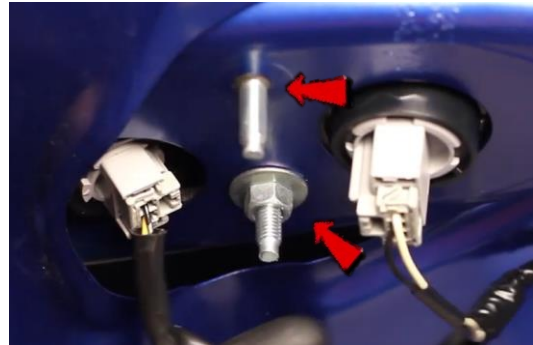

8. Remove (2x) 10mm nuts securing inner tail light.



9. Disconnect inner tail light harness.



10. Unseat inner tail light.

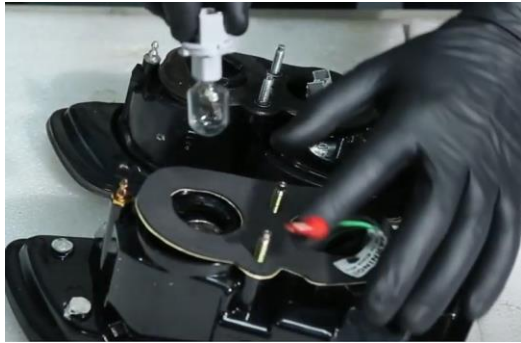

11. Transfer reverse light bulb and socket to Spyder inner tail light.



12. Unseat tail light socket and remove bulb. Transfer socket to Spyder tail light and install socket insert.



13. Peel backing from weather seal and stick to Spyder trail light.

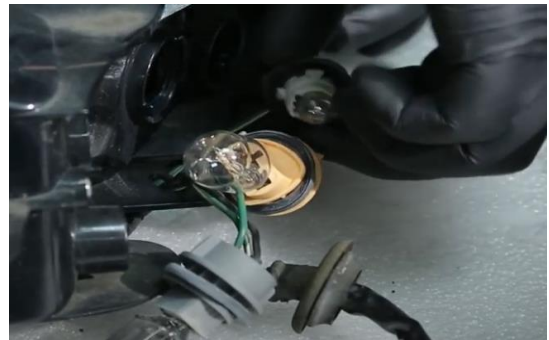

14. Remove (3x) bulb sockets from outer tail light.



15. Replace turn signal bulb with provided amber bulb. (Never touch bulb with bare hands)

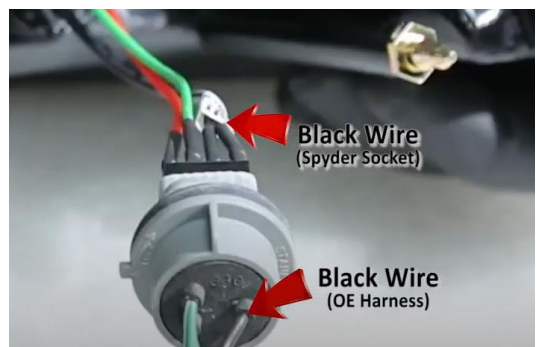

16. Remove brake bulb and replace with Spyder tail light bulb insert. (Align black wire of harness to black wire of socket insert)



17. Seat brake, signal and side marker sockets into Spyder tail light.

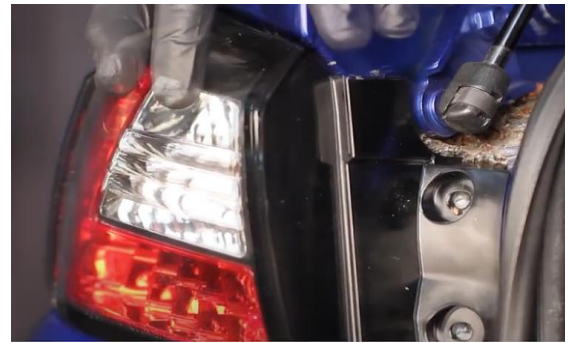

18. Seat outer Spyder tail light.



19. Reinstall (2x) 10mm bolts.



20. Connect outer tail light harness.



21. Reinstall trunk liner and (2x) plastic retaining screws.



22. Seat Spyder inner tail light.

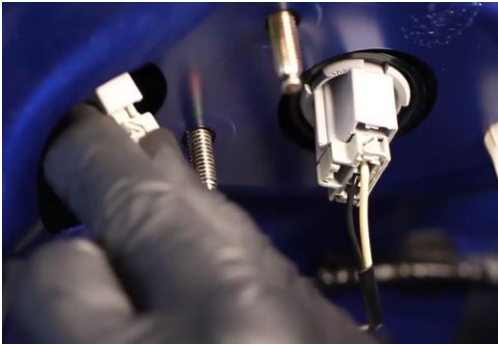

23. Connect inner tail light harnesses.

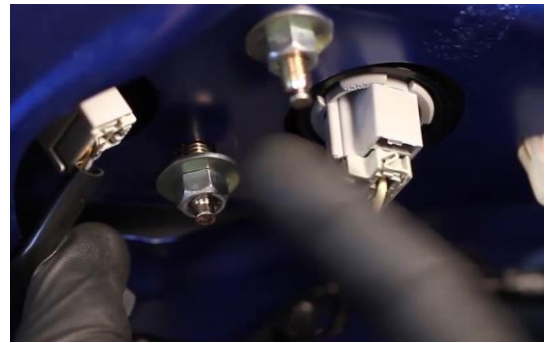

24. Reinstall (2x) 10mm nuts.



25. Align and seat trunk lid liner.

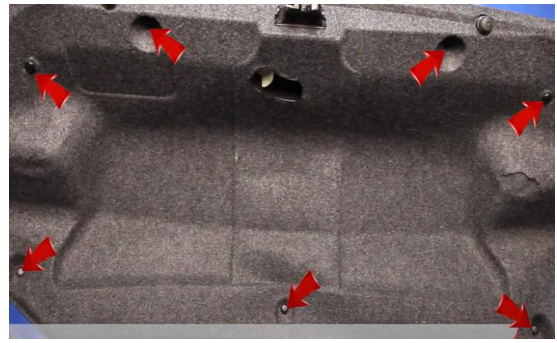

26. Reinstall (7x) plastic retainers.



27. Turn on lights and confirm all functions are working properly. You have successfully completed the install of your new Spyder LED tail lights.



SPYDER

WWW.SPYDERAUTO.COM

For further help with installation, please watch our installation video.

Follow the direct link below to our YouTube channel for more information:

<http://www.youtube.com/watch>

DISCLAIMER

Spyder Auto Installation Guide is not liable for damages, injuries, and death while installing the product. This is intended to be an installation guide, to reduce installation time. We have no responsibility for improper installation. If you do not know how to install, please have a professional install it.