

MAIN CONTROL SCREEN

"OFF ROAD" MODE ENABLES THE FLASH AND STROBE FEATURES. "ON ROAD" MODE DISABLES THE FLASH AND STROBE FEATURES.

SLIDER USED FOR DIMMING YOUR OFFROAD LIGHTS

TOUCH TO TURN SCREEN OFF. HOLD FOR 1 SECOND TO TURN ALL ACCESSORIES OFF TOUCH IN AREA OF WHERE OFF BUTTON IS TO TURN SCREEN ON



SELECT TO ENTER PROGRAMMING MODE

SOURCE BOARD TEMP NORMAL RANGE IS BETWEEN 0 DEG F & 220 DEG F

BATTERY VOLTAGE MONITOR SYSTEM WILL SHUT DOWN WHEN VOLTAGE DROPS BELOW 11V FOR LONGER THAN 2 MINUTES MUST RESTART ENGINE TO RE-INITIALIZE SYSTEM

SWITCH PROGRAMMING SELECTION SCREEN

SELECT SWITCH TO CUSTOMIZE

ADJUST THE BRIGHTNESS OF THE SCREEN



CREATE A MASTER SWITCH THAT WILL ACTIVATE ALL LINKED SWITCHES IN THE GROUP WHEN TURNED ON.

DEFAULT SOURCE IS 1 THIS IS WHERE YOU SELECT WHICH SOURCE TO CONTROL IF YOU HAVE MULTIPLE SOURCES

SWITCH CUSTOMIZATION SCREEN

SELECT EACH LINE AND ENTER TEXT. 8 CHAR. MAX PER LINE



USE THIS BUTTON TO ENTER INTO SWITCH FEATURE SCREEN

TOUCH SAVE BUTTON WHEN DONE AND WAIT 1 SECOND FOR BUTTON TO FLASH RED TO SAVE

SWITCH FEATURE SCREEN

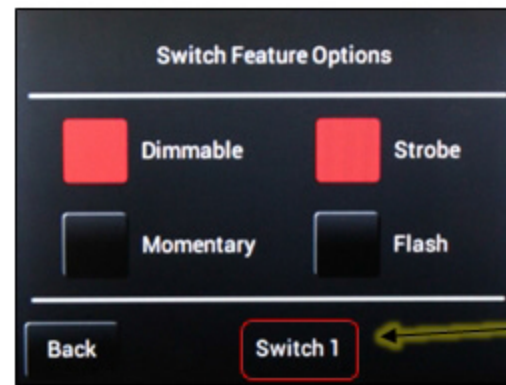

THIS SHOWS WHAT SWITCH YOU ARE CURRENTLY PROGRAMMING

"OFF ROAD" / "ON ROAD" MODE:

Off Road

Selecting the "Off Road" mode enables you to use all of the flash and strobe features that you have programed to use for certain switches (in the "Switch Feature Options" menu.)

On Road

Selecting the "On Road" mode disables all the flash and strobe features. Switching to "On Road" will change ALL switches currently in flash or strobe mode to solid on.

