

SPICER®

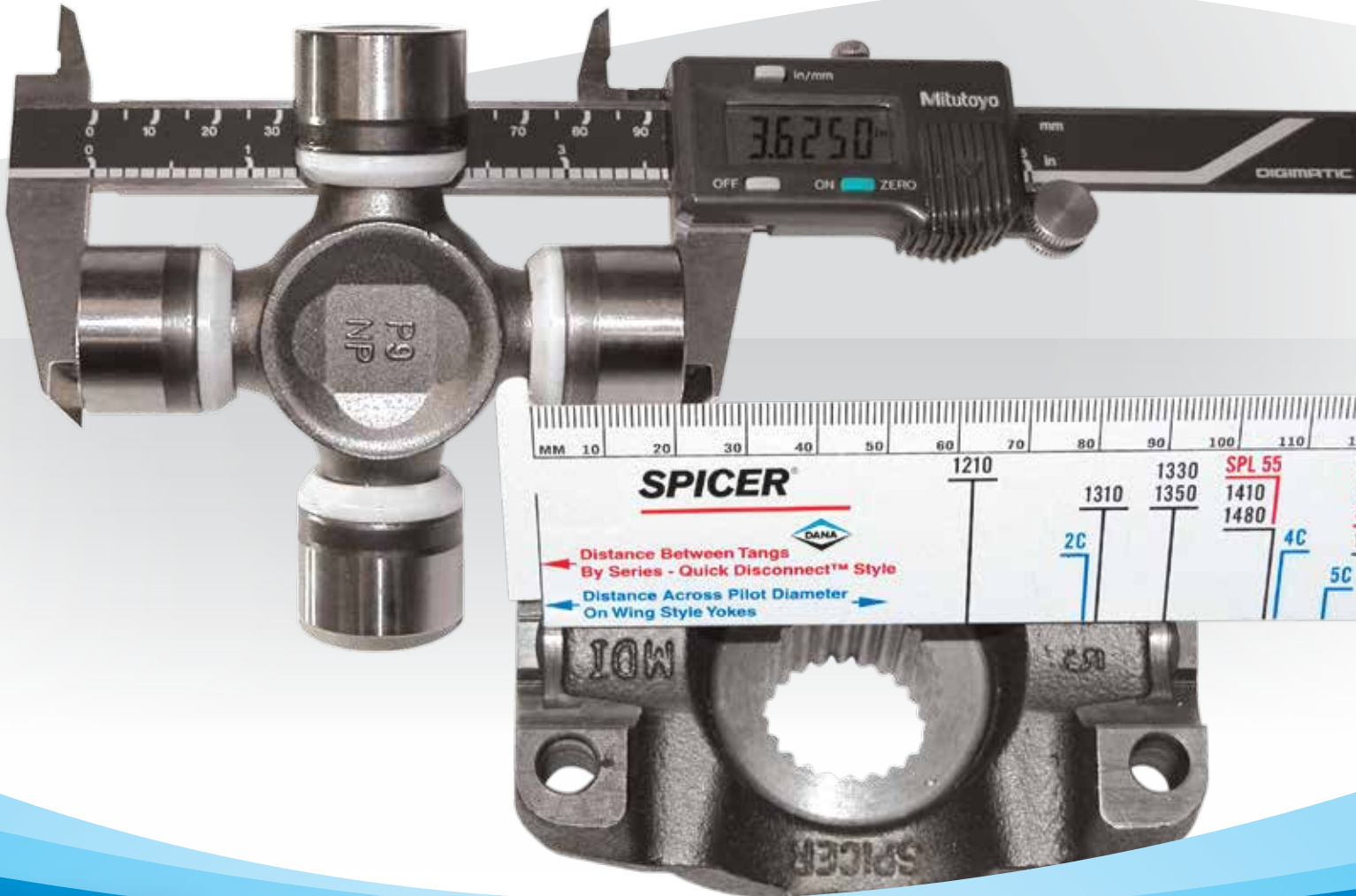

Spicer®

Yoke & U-Joint Measuring



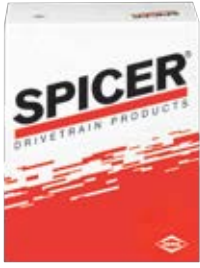

Get the right u-joint right away. With the Spicer® [Yoke Ruler](#), you can quickly and easily measure a driveshaft yoke to determine the series of a driveshaft and then refer to the chart to the right to determine the correct u-joint kits for that series. This guide shows you how to find the part you need, no matter what information you have in front of you. **NOTE:** The Spicer Yoke Ruler is used to determine the series of driveshaft that is compatible with your yoke. Measurements for u-joint kits should be made with a caliper or micrometer and determined by using the dimensional charts in Spicer's K350 catalog.

How to Measure a Yoke

This section will demonstrate how to use the Spicer Yoke Ruler to determine the correct Spicer driveshaft series when all you have is a yoke from a driveshaft. **NOTE:** This ruler will only measure Spicer Series yokes and is not inclusive of all driveshaft series. Refer to chart on the next page for u-joint kit number choices.

With a Full-Round Driveshaft Yoke

1. Measure from the outside of the yoke ears as shown
2. The correct driveshaft/u-joint series will be indicated on the opposite ear – **1310 in this example**

The correct u-joint kit options are listed in the chart to the right, and include **5-153X** (Spicer service kit – greaseable), **5-1310-1X** (Spicer Life/SPL greaseable), and **5-1310X** Spicer Life/SPL non-greaseable). **For measurements showing multiple series, refer to the K350 catalog.**



With a Half-Round Driveshaft Yoke

1. Measure from the inside of the tab as shown
2. The correct driveshaft/u-joint series will be indicated on the opposite tab – **SPL170 in this example.**

For measurements showing multiple series, refer to the K350 catalog.

With a Wing™ Series Yoke

1. Measure across the inside of the pilot diameter. **CAUTION:** Make sure your ruler is directly over the center of the bolt holes on the yoke as shown
2. Read result on **opposite** pilot diameter
3. Wing™ Series u-joint kit part numbers can be found in the Wing™ Series brochure (J3312-WINGBRO-52105)



Common U-Joint Kits by Series

Once you've determined the driveshaft/u-joint series, the chart below provides options for easily identifying the appropriate Spicer® u-joint kit part number.

Vehicle Type	Driveshaft Series	Spicer® Service Kit (Greaseable unless noted)	Spicer Life® OE Kit (Greaseable)	Spicer Life® OE Kit (Non-Greaseable)	
Light & Medium Vehicles	1210	5-443X	-	-	
	1310	5-153X	5-1310-1X**	5-1310X	
	1310 aluminum	-	-	5-3613X†	
	1310/7260*	-	-	5-788X	
	1310 (Wheel Joint)	-	-	5-760X	
	1310SPEC	5-1201X	-	5-7439X	
	1330	5-213X	5-1330-1X**	5-1330X	
	1330 aluminum	-	-	5-3614X†	
	1330SPEC	5-1204X	-	5-7438X	
	1330/S44*	5-212X	-	5-793X	
	1330/7290*	-	-	5-7437X	
	1350	5-178X	5-1350-1X**	5-1350X	
	1350 (Wheel Joint)*	-	-	5-7166X	
	1350/SPL30 aluminum	-	-	5-3615X†	
	1350 x S44*	5-3205X	-	-	
	1355 AAM*	5-3208X ***	-	-	
	1410	5-160X	5-1410-1X**	5-1410X	
	1410 aluminum	-	-	5-3616X†	
	1415 AAM*	5-3207X***	-	-	
	1480/SPL55	5-188X	SPL55-1X	SPL55X	
	1480/SPL55 (Wheel Joint)*	-	SPL55-4X	SPL55-3X	
	1485 AAM*	5-3206X***	-	-	
	1485 AAM (Wheel Joint)*	-	-	5006813	
	1550/SPL70	5-155X	SPL70-1X	SPL70X	
	SPL70 (Wheel Joint)*	-	SPL70-4X	-	
	7260*	5-1306X	-	5-789X	
	7290*	5-1309X	-	5-811X	
	S44*	5-3147X	-	5-795X	
	Commercial Vehicles	SPL90/SPL100	-	SPL100-1X	-
		SPL140	-	SPL140X	-
SPL170		-	SPL170-4X	SPL170-SF4X	
SPL250		-	SPL250-3X	SPL250-SF3X	
SPL350		-	SPL350X	SPL350SFX	
1610 (Full Round)		5-279X	-	-	
1610 (Half Round)		5-674X	-	-	
1650		5-165X	-	-	
1710 (Full Round)		5-280X	-	-	
1710 (Half Round)		5-675X	-	-	
1760 (Full Round)		5-407X	-	-	
1760 (Half Round)		5-677X	-	-	
1800 (Full Round)		5-124X	-	-	
1810 (Full Round)		5-281X	-	-	
1810 (Half Round)		5-676X	-	-	
1880 (Full Round)		5-308X	-	-	

* Wheel joint or non-Spicer series - will not be on yoke ruler. Identify u-joint kit using Spicer K-350 Catalog. ** Zerk in Cap ***Non-Greaseable
† Used in aluminum driveshafts. U-joint has coated caps.

Measuring U-Joint Kits (Spicer Yoke Ruler does not apply.)

The illustrations below show appropriate measurements required to identify the most common styles of u-joint kits. Illustrations for the other styles of u-joint kits can be found in the last section of the K350 catalog. We recommend using a caliper or micrometer to most accurately measure u-joints. U-Joint caps must be compressed when measuring dimension over the caps. Once you have recorded your measurements, refer to the dimensional charts by u-joint type which can be found in the last section of the K350 catalog.

Outside Snap Rings

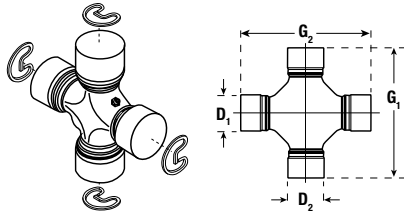

Wing™ Series

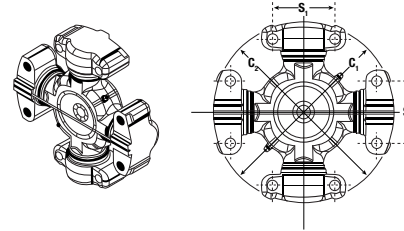

Inside Snap Rings

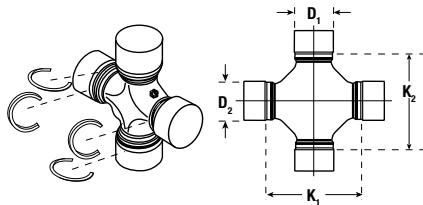

Bearing Plate Style

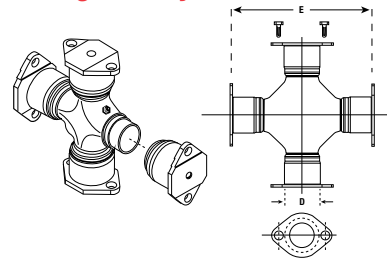

Spicer Life Series® (SPL® 140, 170, 250, and 350)

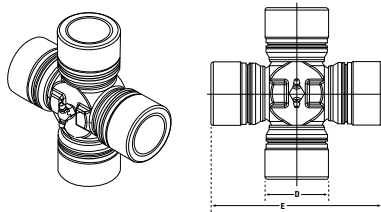

Half Round Style

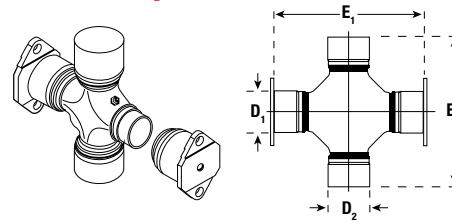

Sample of the K350 Dimensional Pages

Bearing Plate (BP) Style

E Between Caps	E Bearing cap Diameter	OE Mfg.	OE Series	Greasefit (Type Size)	Spicer Part Number
4.562	1.562	SPICER	1500	Y	5-115X*
5.312	1.875	SPICER	1610	Y	5-279K
6.094	1.938	SPICER	1710	Y	5-280X
6.094	1.938	SPICER	1710	Y	5-280-4X*

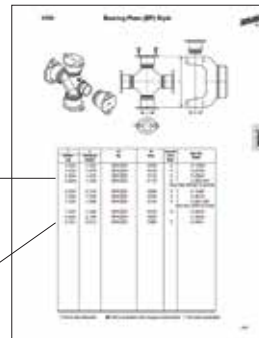

SPICER®

