

**CONTOUR/MYSTIQUE FRONT CASTER/CAMBER KIT**

*This part should only be installed by personnel who have the necessary skill, training and tools to do the job correctly and safely. Incorrect installation can result in personal injury, vehicle damage and / or loss of vehicle control.*

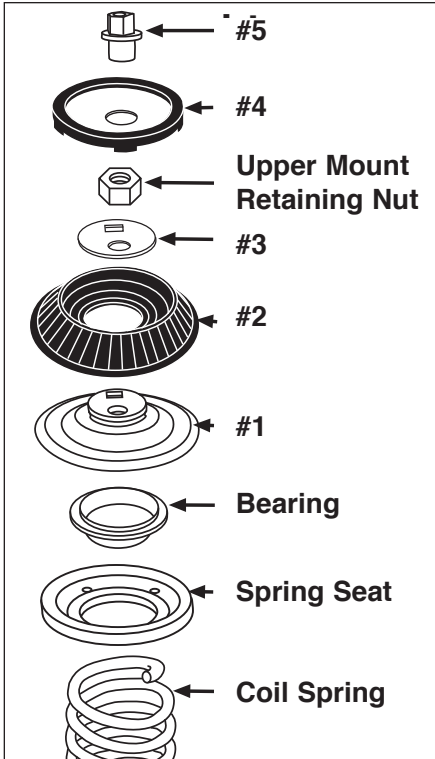

1. Always check for loose or worn parts, tire pressure and tire wear. Determine camber change needed
2. Raise vehicle by body pinch welds. Remove tire and wheel assembly.
3. Remove strut assembly from vehicle by following manufacturer's recommended procedure.
4. Place strut assembly in strut vise, compress spring, and remove upper mounting plate. Leave bearing plate on spring.
5. Install cam plate (#1) into mount (#2) (see Figure). Install assembly onto strut making sure cam plate is centered on the strut bearing.
6. Install cap (#3) onto strut shaft making sure square adjusting hole is lined up with square hole in cam plate and the shoulder is facing down into the mount. Install strut nut and torque to manufacturer's specifications.
7. Remove strut from vise and reinstall into vehicle using manufacturer's recommended procedure. Use cover (#4) and top nut (#5) to help hold strut in place.
8. Reinstall wheel, alignment equipment, and recompensate.
9. To adjust strut for camber and caster change remove the top nut and cover. Rotate the cam plate by installing a 3/8"

ratchet and extension in the square hole. All of the weight must be off of the wheel and the suspension must be hanging before rotating cam plate.

10. Caster and camber correction will be determined by the location of the strut shaft. (e.g. if the strut shaft is towards the engine you will get negative camber change, if the strut shaft is towards the front of the car you will get negative caster change.)
11. When adjustments are complete lower vehicle, reinstall cover plate and top nut and torque to 45 lb-ft.

**Always check for proper clearance between suspension components and other components of the vehicle.**

12. Recheck alignment readings and road test vehicle.



**Specialty Products Company®**