

EZ CAM XR™ Instruction Sheet

US Patent Nos. 8,544,861 B2 • 8,469,375
Additional Patents Pending

1. Take alignment readings and determine amount of camber change needed.
2. Raise vehicle by chassis. Remove tire and wheel assembly.
3. Remove the upper strut-spindle bolt.
4. Line up formed upset with cam on bolt. **Install bolt with large tab out (toward wheel) for positive camber or in (away from wheel) for negative camber (See Figures 1 and 2).** Install EZ Cam bolt into strut hole making sure the formed upset on the washer is in the hole and the washer is flush on the strut. Add lock nut and snug, but do not tighten.
5. **Loosen the lower strut bolt**
6. Reinstall tire and wheel assembly and recompensate alignment equipment. Rotate EZ Cam XR bolt to obtain desired camber reading.
7. Torque lower bolt to manufacturer's specification
8. Torque the 81295 EZ cam bolt to 231 lb-ft (313 N-m).
9. Complete alignment and road test vehicle.

Always check for proper clearance between suspension components and other components of the vehicle.

Figure 1

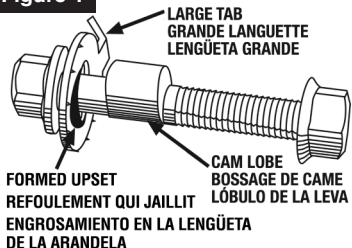
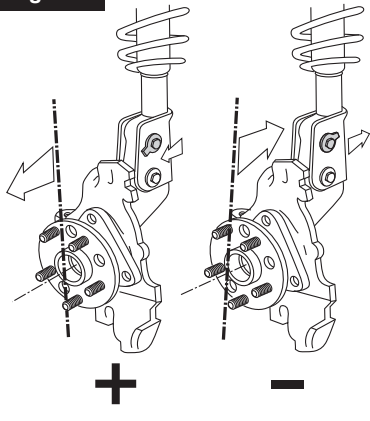

Figure 2



**Specialty
Products
Company**