

PART NO. 25450

Instruction Sheet TOYOTA CAM BOLT KIT (2)

This part should only be installed by personnel who have the necessary skill, training and tools to do the job correctly and safely. Incorrect installation can result in personal injury, vehicle damage and / or loss of vehicle control.

Plan Ahead - Read All Instructions **BEFORE** installing part.

Check for loose or worn parts, proper tire pressure, and odd tire wear patterns before beginning alignment.

1. Raise vehicle and support by frame.
2. Pre-assemble SPC cam assemblies by first installing appropriate cam on each bolt, then a tube spacer on large bolt as shown in **Figure 1**.
3. One at a time, note OE bolt & nut orientation and remove original cam assemblies from lower control arm and replace with SPC assemblies, installing new assemblies in same orientation as OE.

NOTE: SPC tool 40915 may help with removal of OEM cams. However, if tubes are solidly seized in bushings, you may not be able to remove them. To achieve camber/caster change, you may need to replace upper control arms with SPC part No. 25485 or 25490 (check applications).

4. Install appropriate remaining cam and nut on each bolt and tighten slightly.
NOTE: Fully tightening fasteners with vehicle in raised position may cause premature bushing failure.
NOTE: Ensure that washer is between cam and nut on M20 bolt as shown in **Figure 1**.
5. Lower vehicle and adjust alignment to desired settings by turning bolts.
NOTE: If cam bolt binds while rotating, it may be necessary to raise vehicle by frame to unload suspension. Start with cam bolt positioned for max positive camber.
6. When finished adjusting:
While holding bolts/cams secure, torque rear (M18) nut to **198 lb-ft (268 N-m)**.
While holding bolts/cams secure, torque front (M20) nut to **227 lb-ft (308 N-m)**.
7. Complete alignment and road test vehicle.

Always check for proper clearance between suspension components and other components of vehicle.

Figure 1

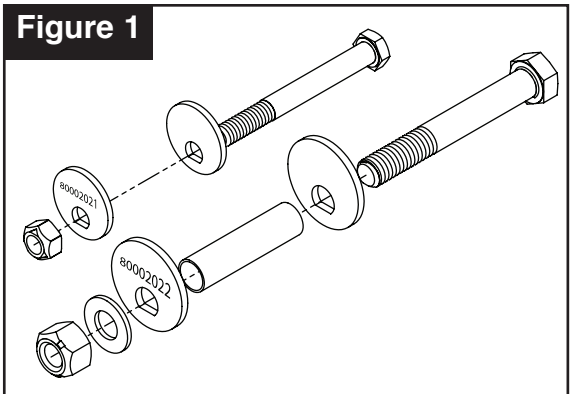

Specialty Products Company®