

# INSTALLATION & CARE

## 2007-2013 GMC SIERRA LED TAIL LIGHTS INSTALLATION INSTRUCTIONS

### BEFORE INSTALLATION:

- If you experience any difficulties that the instructions did not cover, please seek assistance at a local automotive shop.
- Please wear proper protective equipment before you work on any vehicle.
- An assistant is recommended when removing the front bumper from your vehicle.
- Please be cautious when working with the bumper or any parts belonging to the vehicle's body to prevent scratching.
- Do not make direct contact with the halogen bulbs or the wire assembly until the unit has cooled down after use.

### TOOLS AND SUPPLIES REQUIRED

Plastic Pry bar	Flathead screwdriver		
			

### PRODUCT NUMBER

LT-SIE07JMLED-G2-TM  
 LT-SIE07GLED-G2-TM  
 LT-SIE07BBLED-G2-TM  
 LT-SIE07RLED-G2-TM  
 LT-SIE07BKLED-G2-TM



### LET'S START THE INSTALLATION

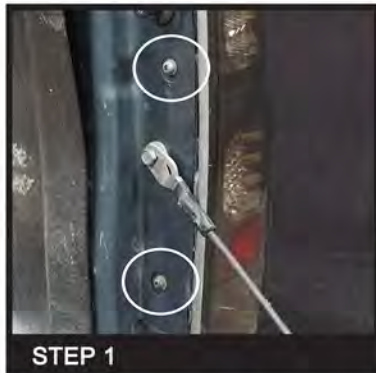

**STEP 1**

Remove the two Phillips head screws

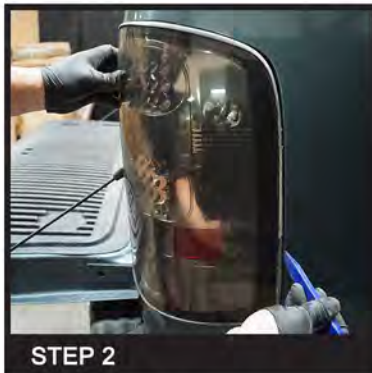

**STEP 2**

Unseat the tail light housing

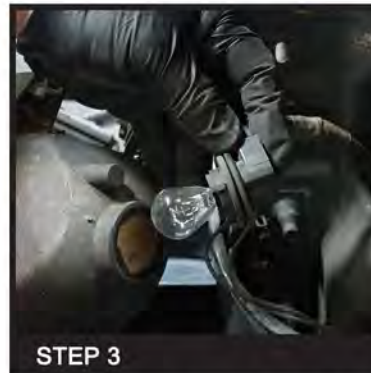

**STEP 3**

Disconnect all the light bulb sockets and unseat the tail light housing

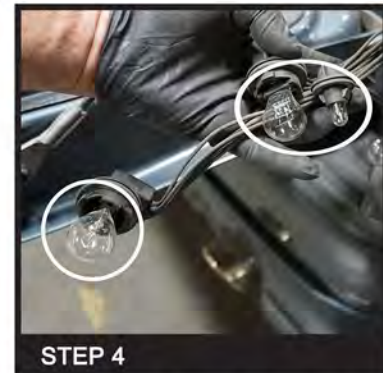

**STEP 4**

Remove all the light bulbs from the light socket except the back up light bulb

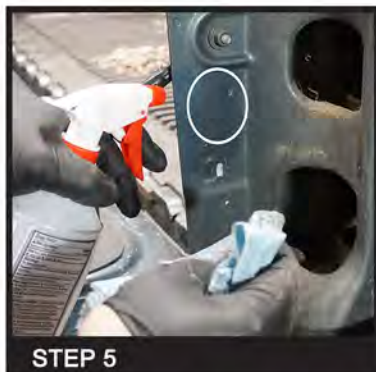

**STEP 5**

Use alcohol to clean the metal surface to apply resistor



**STEP 6**

Set the new tail light resistor on the metal area

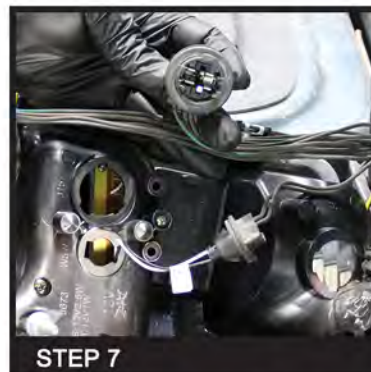

**STEP 7**

Connect the LED connector to the bulb socket, the middle bulb socket does not need to be connected to the LED connector

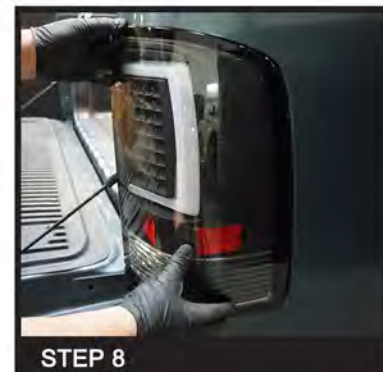

**STEP 8**

Reinstall the new tail light housing

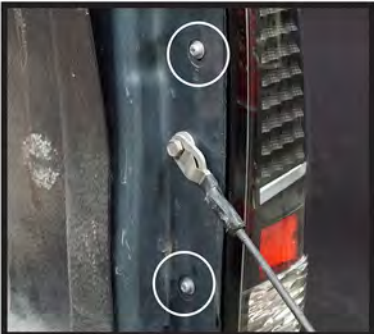

**STEP 9**

Tighten the two phillips head screws

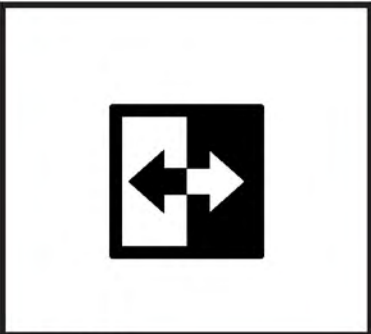

**STEP 10**

Please repeat the steps from 1 to 9 for the opposite side



**STEP 11**

Close the tailgate to complete the installation





# INSTALLATION & CARE

## 2007-2013 GMC SIERRA LED TAIL LIGHTS INSTALLATION INSTRUCTIONS

### BEFORE INSTALLATION:

- If you experience any difficulties that the instructions did not cover, please seek assistance at a local automotive shop.
- Please wear proper protective equipment before you work on any vehicle.
- An assistant is recommended when removing the front bumper from your vehicle.
- Please be cautious when working with the bumper or any parts belonging to the vehicle's body to prevent scratching.
- Do not make direct contact with the halogen bulbs or the wire assembly until the unit has cooled down after use.

## 2007-2013 GMC SIERRA LED TAIL LIGHTS INSTALLATION INSTRUCTIONS

