

Installation & CARE

2011-2013 MINI COOPER LED TAILLIGHTS INSTALLATION

BEFORE INSTALLATION

- If you experience any difficulties that the instruction did not cover, please seek assistance at local automotive shop.
- Please wear protection before you work on any vehicle.
- An assistant is useful when removing the front bumper from your vehicle.
- Please be cautious when working with the bumper or any parts belonging to the vehicles's body to prevent scratching.
- Do not make direct contact with the halogen bulbs or the wire assembly until the unit has cooled down after use.

TOOLS AND SUPPLIES REQUIRED

T20 Driver	Handy Remover		
			

PRODUCT NUMBER

LT-MINI11RLED-TM
LT-MINI11RGLED-TM



LET'S START THE INSTALLATIONS



STEP 1

Before installation

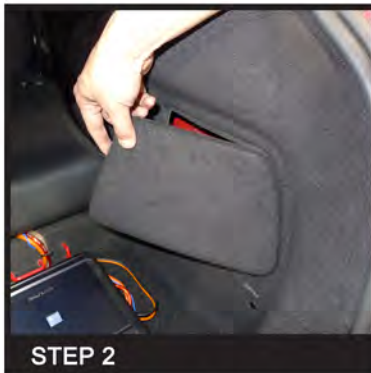

STEP 2

Remove the access hole cover

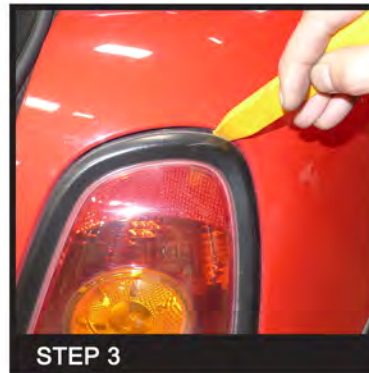

STEP 3

Remove the taillight trim



STEP 4

Remove the taillight trim

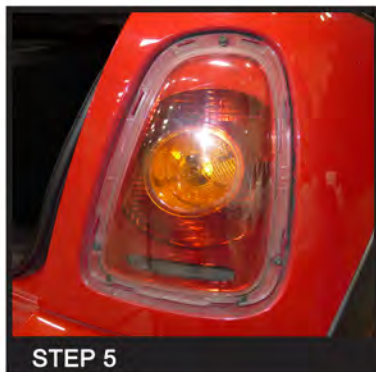

STEP 5

(3) T20 bolts location

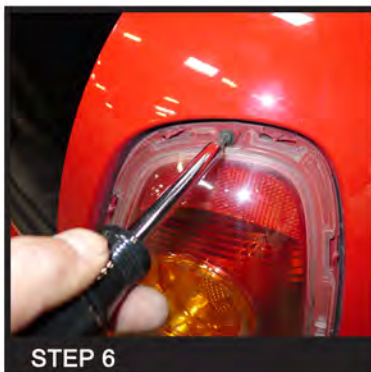

STEP 6

Remove (3) T20 bolts

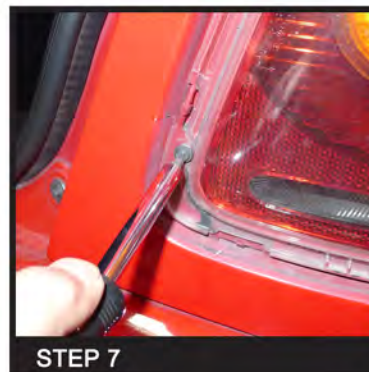

STEP 7

Remove (3) T20 bolts

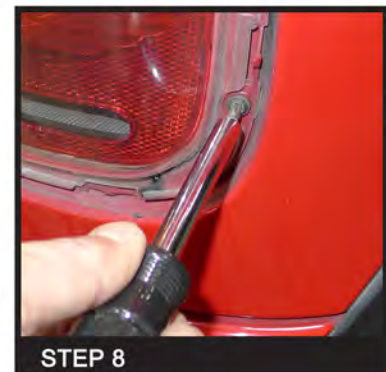

STEP 8

Remove (3) T20 bolts



STEP 9

Remove the factory taillight



STEP 10

Disconnect the taillight harness



STEP 11

Connect the taillight harness to the LED taillight. Please see the " L.E.D. tail lights installation instruction" If your tail lights don't have L.E.D. You can skip the installation instruction.



STEP 12

Place the LED taillight in the stock location

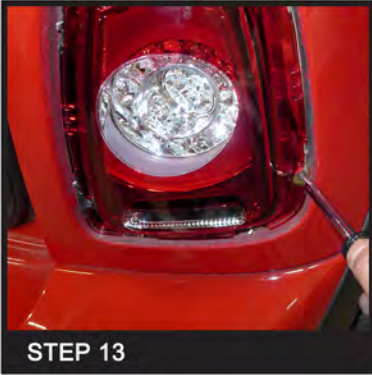

STEP 13

Tighten (3) T20 bolts



STEP 14

Install the taillight trim

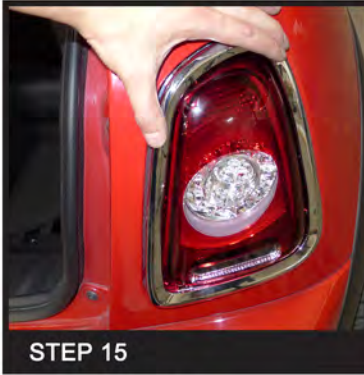

STEP 15

Install the taillight trim

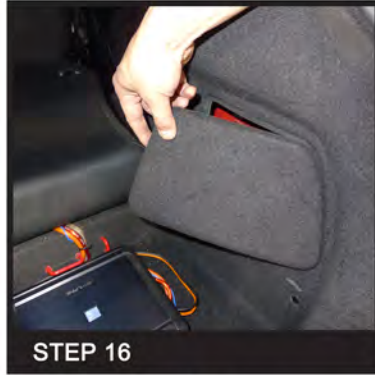

STEP 16

Replace the access hole cover

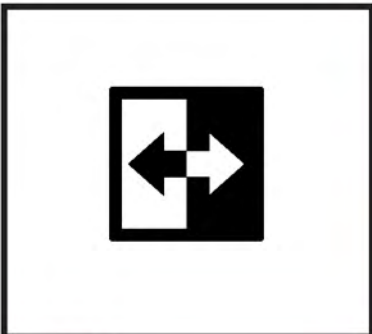

STEP 17

Please repeat the steps from 1 to 16 for the opposite side



STEP 18

The installation is now complete