

Installation & CARE

1997-2000 BMW 5 SERIES E39 LED TAIL LIGHTS INSTALLATION

BEFORE INSTALLATION

- If you experience any difficulties that the instruction did not cover, please seek assistance at local automotive shop.
- Please wear protection before you work on any vehicle.
- An assistant is useful when removing the front bumper from your vehicle.
- Please be cautious when working with the bumper or any parts belonging to the vehicles's body to prevent scratching.
- Do not make direct contact with the halogen bulbs or the wire assembly until the unit has cooled down after use.

TOOLS AND SUPPLIES REQUIRED

¼" Ratchet	Plastic Pry bar	8 mm socket	
			

PRODUCT NUMBER

LT-E3997RLED-TM
 LT-E3997GLED-TM
 LT-E3997RGLED-TM



LET'S START THE INSTALLATIONS



STEP 1

Raise the trunk



STEP 2

Pull tab to lower access panel

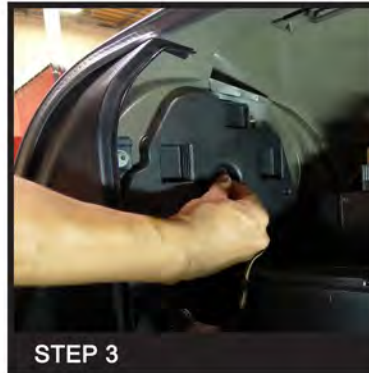

STEP 3

Unfasten bulb plate

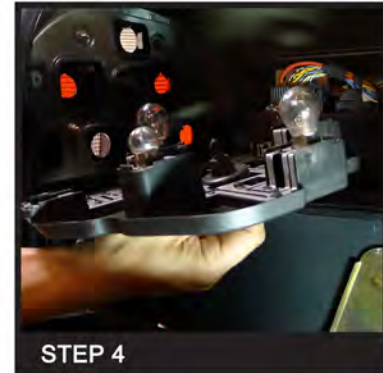

STEP 4

Remove bulb plate

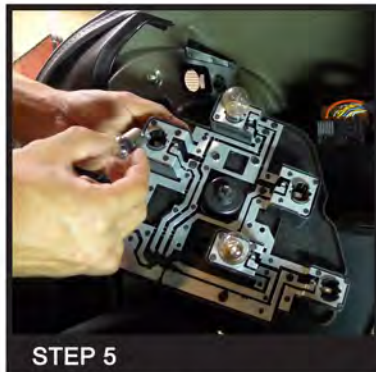

STEP 5

Remove (2) driving light bulbs from bulb plate

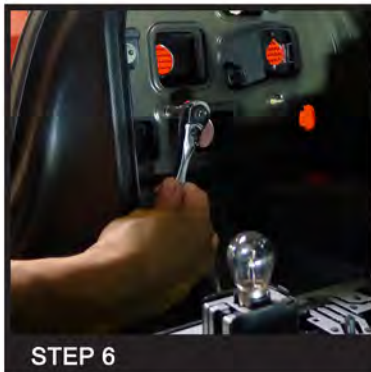

STEP 6

Unfasten (4) 8mm nuts

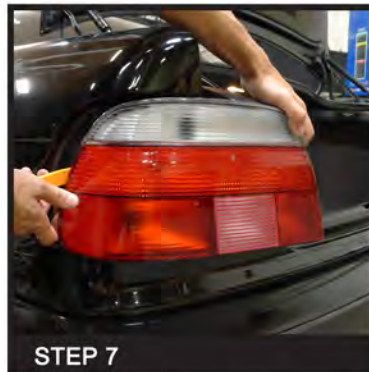

STEP 7

Remove tail light housing



STEP 8

Install LED tail light housing

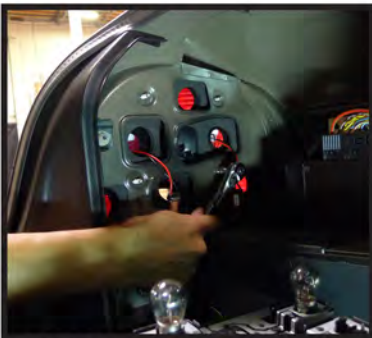

STEP 9

Fasten (4) 8mm nuts to secure LED tail light



STEP 10

Attach (2) LED connectors to resistor harness

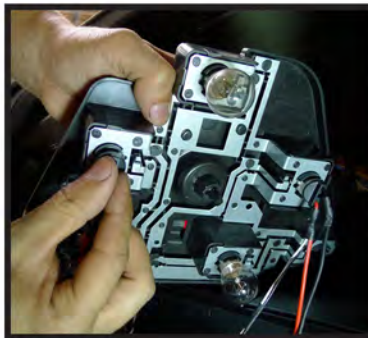

STEP 11

Attach resistor harness connectors to bulb plate



STEP 12

Position and fasten bulb plate



STEP 13

Re-secure access panel

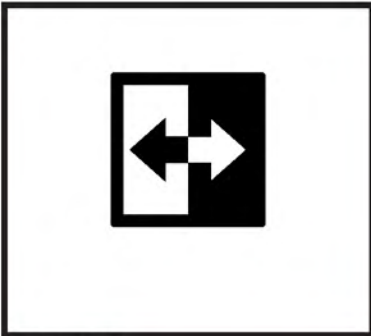

STEP 14

Please repeat the steps from 2 to 13 for the opposite side



STEP 15

The installation is now complete