

Installation & CARE

1998-2006 MERCEDES-BENZ W220 S-CLASS LED PROJECTOR HEADLIGHTS INSTALLATION

BEFORE INSTALLATION

- If you experience any difficulties that the instruction did not cover, please seek assistance at local automotive shop.
- Please wear protection before you work on any vehicle.
- An assistant is useful when removing the front bumper from your vehicle.
- Please be cautious when working with the bumper or any parts belonging to the vehicles's body to prevent scratching.
- Do not make direct contact with the halogen bulbs or the wire assembly until the unit has cooled down after use.

TOOLS AND SUPPLIES REQUIRED

1/4" Ratchet	6" Extension	10 mm socket	8 mm socket
			

PRODUCT NUMBER

LHP-BW22000JM-TM
LHP-BW22000-TM



LET'S START THE INSTALLATIONS



STEP 1

Before installation



STEP 2

Metal bracket



STEP 3

Remove the (2) 10mm bolts

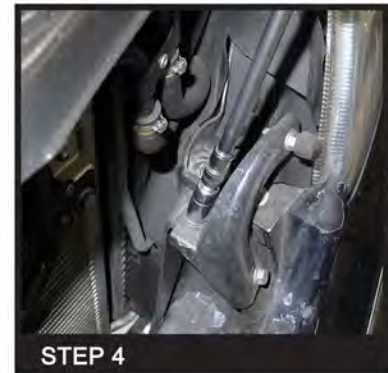

STEP 4

Remove the (2) 10mm bolts

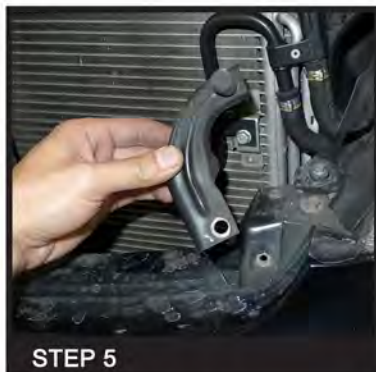

STEP 5

Remove the metal bracket

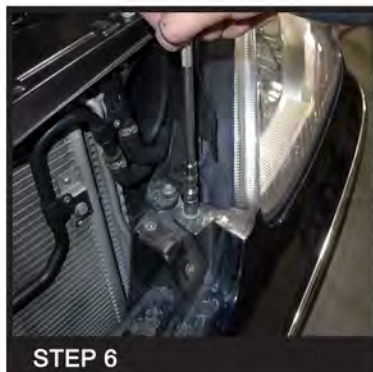

STEP 6

Remove the 10mm bolt



STEP 7

(2) 8mm bolts location

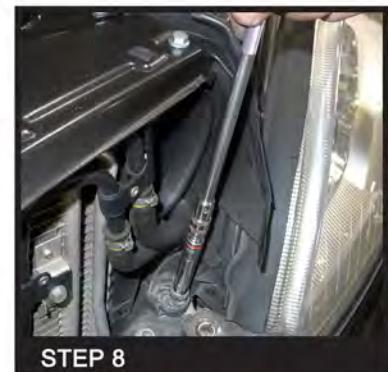

STEP 8

Remove the (2) 8mm bolts

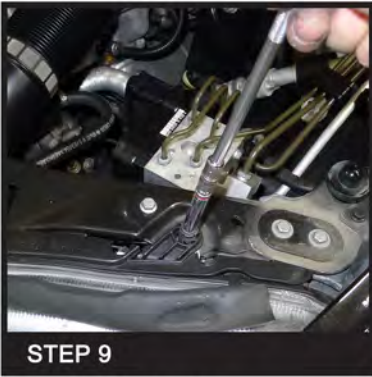

STEP 9

Remove the (2) 8mm bolts

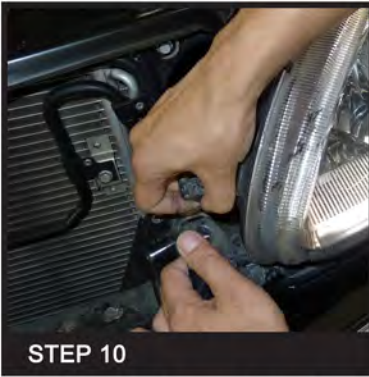

STEP 10

Pull the top of the bumper forward

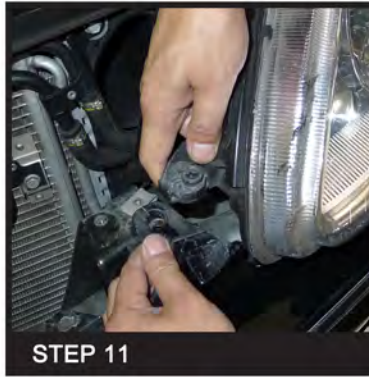

STEP 11

Remove the headlight



STEP 12

Disconnect the headlight harness



STEP 13

Connect headlight harness to new headlight. Please see the "Halo & LED headlights installation instructions" If your headlights don't have Halo and led, you can skip the instruction



STEP 14

Place the new headlight in the stock location

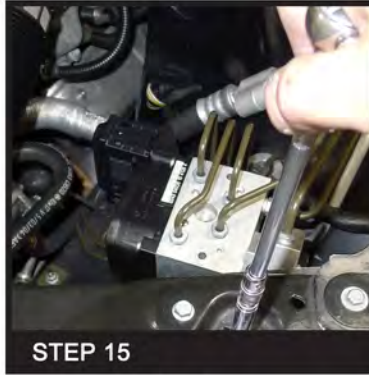

STEP 15

Tighten the (2) 8mm bolt



STEP 16

Tighten the (2) 8mm bolt

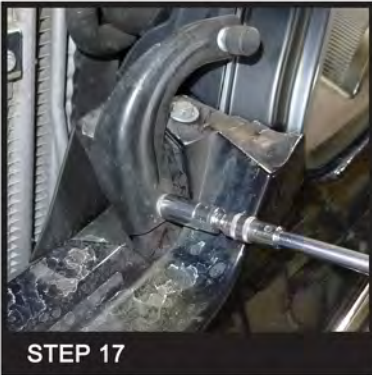

STEP 17

Secure metal bracket with the (2) 10mm bolts

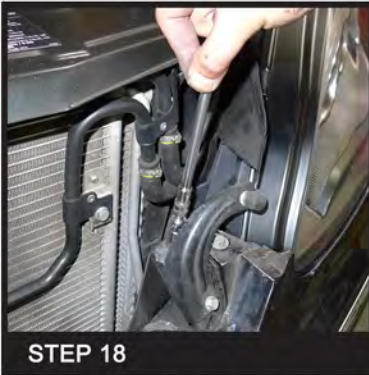

STEP 18

Secure the metal bracket with the (2) 10mm bolts



STEP 19

Please repeat the steps from 1 to 18 for the opposite side

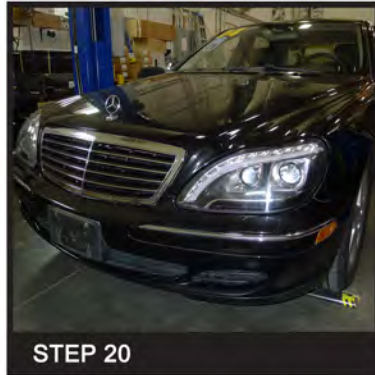

STEP 20

The installation now is complete