

INSTALLATION & CARE

1997-2004 PORSCHE BOXSTER 986 SWITCHBACK HEADLIGHT INSTALLATION INSTRUCTION

BEFORE INSTALLATION:

- If you experience any difficulties that the instructions did not cover, please seek assistance at a local automotive shop.
- Please wear proper protective equipment before you work on any vehicle.
- An assistant is recommended when removing the front bumper from your vehicle.
- Please be cautious when working with the bumper or any parts belonging to the vehicle's body to prevent scratching.
- Do not make direct contact with the halogen bulbs or the wire assembly until the unit has cooled down after use.

TOOLS AND SUPPLIES REQUIRED

¼" Ratchet	5 mm Socket	10 mm Socket	¼" Socket Extension
			
Alcohol Wipes			
			

PRODUCT NUMBER

LHP-BOX97-TM
LHP-BOX97G-TM
LHP-BOX97JM-TM



LET'S START THE INSTALLATION

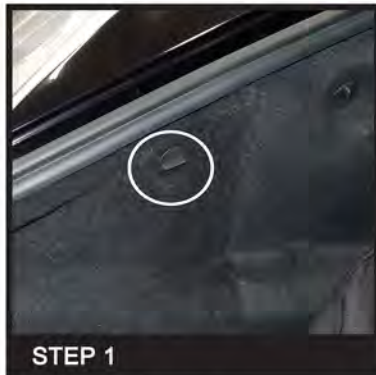

STEP 1

Remove the plastic retainer



STEP 2

Open up the hood lining carpet



STEP 3

Remove the rubber grommets



STEP 4

Turn clockwise with the 5mm socket to unseat and remove the factory headlight housing

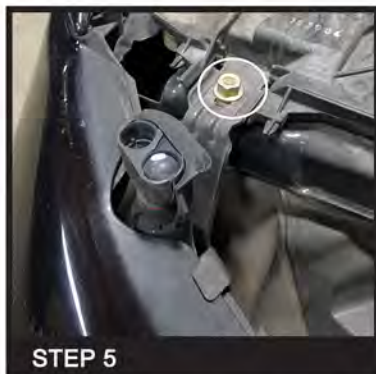

STEP 5

Remove the 10mm headlight washer mounting nut



STEP 6

Set aside the headlight washer, the new headlight housing will no longer use the headlight washer



STEP 7A

Clean the surface with alcohol before applying the rubber seal



STEP 7B

Clean the surface with alcohol before applying the rubber seal



STEP 8

Seat the new headlight assembly in place



STEP 9

Turn counterclockwise with the 5mm socket to lock the new headlight housing in place



STEP 10

Reinstall the rubber grommet



STEP 11

Reinstall the hood lining carpet and the plastic retainer



STEP 12

Please repeat the steps from 1 to 11 for the opposite side

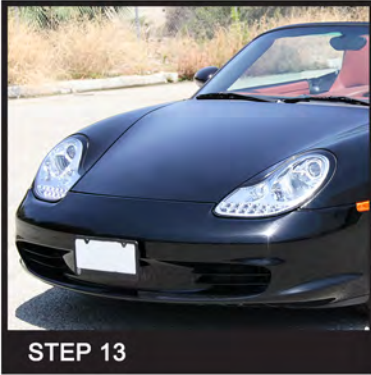

STEP 13



INSTALLATION & CARE

1997-2004 PORSCHE BOXSTER 986 SWITCHBACK HEADLIGHT INSTALLATION INSTRUCTION

BEFORE INSTALLATION:

- If you experience any difficulties that the instructions did not cover, please seek assistance at a local automotive shop.
- Please wear proper protective equipment before you work on any vehicle.
- An assistant is recommended when removing the front bumper from your vehicle.
- Please be cautious when working with the bumper or any parts belonging to the vehicle's body to prevent scratching.
- Do not make direct contact with the halogen bulbs or the wire assembly until the unit has cooled down after use.

1997-2004 PORSCHE BOXSTER 986 SWITCHBACK HEADLIGHT INSTALLATION INSTRUCTION



 HIGH BEAM / LOW BEAM ADJUSTER