

INSTALLATION & CARE

1999-2002 SILVERADO LED HEADLIGHT PARKING LIGHT INSTALLATION INSTRUCTIONS

BEFORE INSTALLATION:

- If you experience any difficulties that the instructions did not cover, please seek assistance at a local automotive shop.
- Please wear proper protective equipment before you work on any vehicle.
- An assistant is recommended when removing the front bumper from your vehicle.
- Please be cautious when working with the bumper or any parts belonging to the vehicle's body to prevent scratching.
- Do not make direct contact with the halogen bulbs or the wire assembly until the unit has cooled down after use.

TOOLS AND SUPPLIES REQUIRED

Needle Nose Pliers	Flathead Screwdriver		
			

PRODUCT NUMBER

2LBLH-SIV99-G3-RS
2LBLH-SIV99G-G3-RS
2LBLH-SIV99JM-G3-RS
2LBLH-SIV99SM-G3-RS

LBLH-SIV99-G3-RS
LBLH-SIV99G-G3-RS
LBLH-SIV99JM-G3-RS
LBLH-SIV99SM-G3-RS



LET'S START THE INSTALLATION



STEP 1

Turn to remove the two headlight supporting pins



STEP 2

Disconnect the headlight harness and uninstall the factory headlight housing

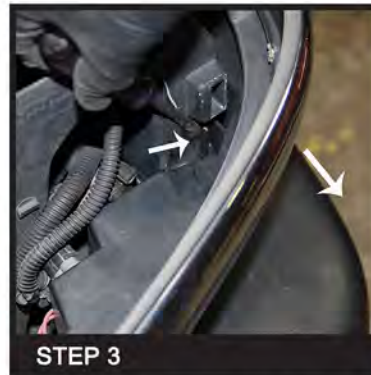

STEP 3

Uninstall the factory parking light housing

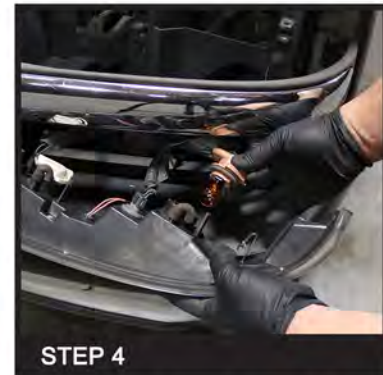

STEP 4

Remove the light sockets on the factory parking light housing



STEP 5

Connect the two wire quick connectors on the amber signal bulbs socket to get power for the LED light bar, the middle for (+) and black for (-)

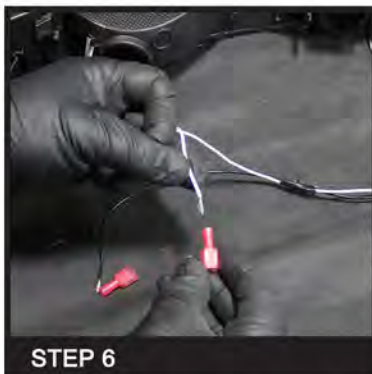

STEP 6

Connect the two wire connectors on the new parking light LED wires, the white for (+) and the black for (-)

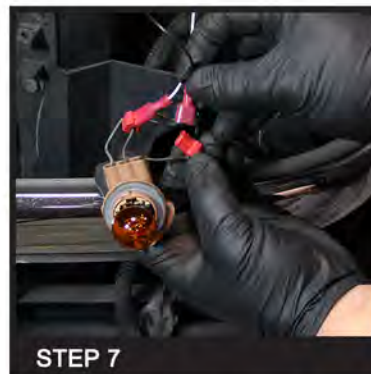

STEP 7

Connect the LED wires from the new parking light housing to the light socket

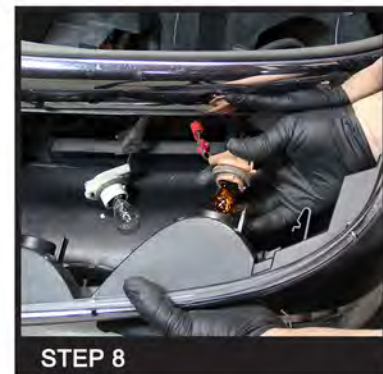

STEP 8

Reinstall the parking light sockets



STEP 9

Seat the new parking light assembly in place



STEP 10

Connect the two wire quick connectors on the parking light LED wires to get power for the headlight LED, the white for (+) and the black for (-)



STEP 11

Remove the high beam and the low beam headlight bulbs from the factory headlight housing



STEP 12

Reinstall the high beam and the low beam headlight bulbs to the new headlight housing

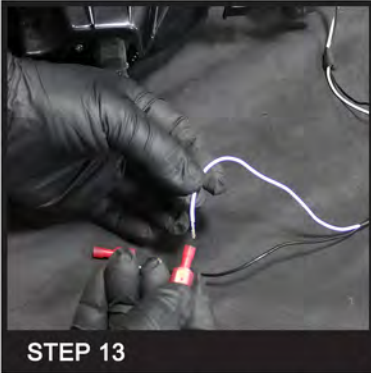

STEP 13

Connect the two wire connectors on the new headlight LED wires, the white for (+) and the black for (-)



STEP 14

Connect the headlight LED wires

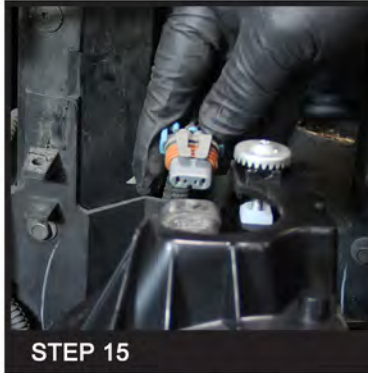

STEP 15

Connect the headlight harness

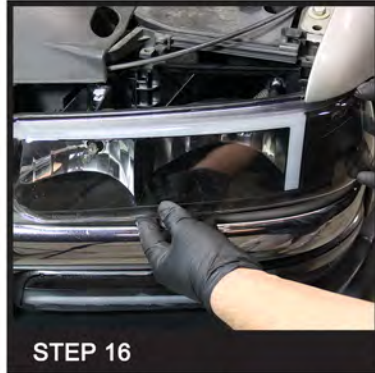

STEP 16

Seat the new headlight assembly in place

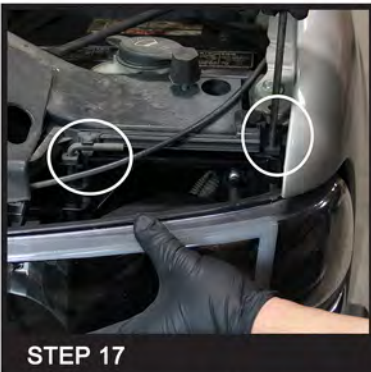

STEP 17

Reinstall the two headlight support pins



STEP 18

Please repeat the steps from 1 to 17 for the opposite side



STEP 19

Close the hood and complete the installation



INSTALLATION & CARE

1999-2002 SILVERADO LED HEADLIGHT PARKING LIGHT INSTALLATION INSTRUCTIONS

BEFORE INSTALLATION:

- If you experience any difficulties that the instructions did not cover, please seek assistance at a local automotive shop.
- Please wear proper protective equipment before you work on any vehicle.
- An assistant is recommended when removing the front bumper from your vehicle.
- Please be cautious when working with the bumper or any parts belonging to the vehicle's body to prevent scratching.
- Do not make direct contact with the halogen bulbs or the wire assembly until the unit has cooled down after use.

1999-2002 SILVERADO LED HEADLIGHT PARKING LIGHT INSTALLATION INSTRUCTIONS



 **BEAM ADJUSTERS**

Learn more about custom and factory headlights we have.