

# INSTALLATION & CARE

## 2019-UP DODGE RAM 1500 PROJECTOR SEQUENTIAL HEADLIGHT WITH SWITCHBACK/BREATHING LIGHT EFFECT

### BEFORE INSTALLATION:

- If you experience any difficulties that the instructions did not cover, please seek assistance at a local automotive shop.
- Please wear proper protective equipment before you work on any vehicle.
- An assistant is recommended when removing the front bumper from your vehicle.
- Please be cautious when working with the bumper or any parts belonging to the vehicle's body to prevent scratching.
- Do not make direct contact with the halogen bulbs or the wire assembly until the unit has cooled down after use.

### TOOLS AND SUPPLIES REQUIRED

1/4" Ratchet	10 mm Socket	8 mm Socket	6" Socket Extension
			
Trim Pad Remover	10mm Wrench		
			

### PRODUCT NUMBER

2LHP-RAM1915-SQ-RS  
2LHP-RAM1915JM-SQ-RS  
2LHP-RAM1915SM-SQ-RS



### LET'S START THE INSTALLATION



Remove the twelve plastic fasteners on the radiator upper support cover



Remove the radiator upper support cover



Remove the eight 10mm bolts at the top of the upper grille trim



Remove the upper grille trim



Remove the four 8mm bolts on the fender liner

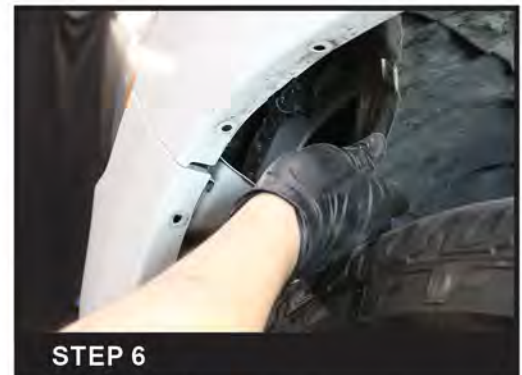

Pull away the fender liner



**STEP 7**

Remove the 10mm bolt

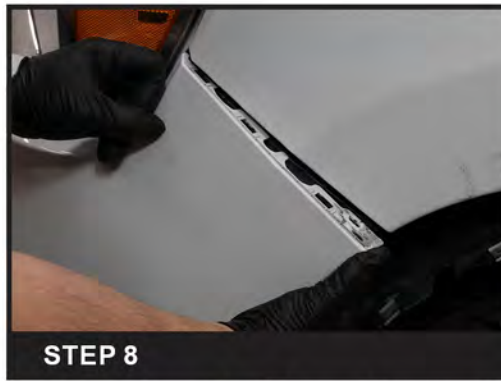

**STEP 8**

Grab the edge and pull forward to unseat the filler panel



**STEP 9**

Grab the other end and pull out to remove the filler panel, repeat for the other side



**STEP 10**

Remove the three 10mm bolts at the bottom of the front grille



**STEP 11**

Remove the four 10mm bolts at the top of the front grille



**STEP 12**

Unseat the front grille upper leg for both side



**STEP 13**

Remove the front grille



**STEP 14**

Remove the 10mm bolt at the bottom of the headlight

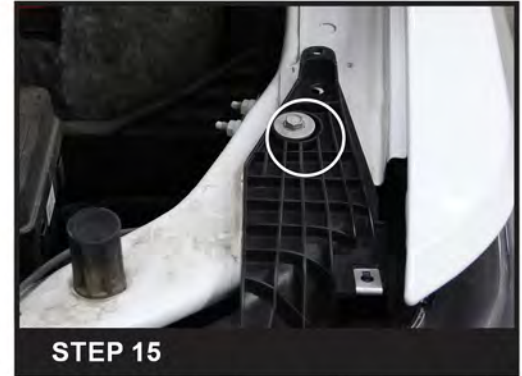

**STEP 15**

Remove the 10mm bolt at the top of the headlight



**STEP 16**

Unseat the factory headlight housing



**STEP 17**

Disconnect the headlight harness and remove the factory headlight housing



**STEP 18**

Remove the parking light socket from the factory headlight housing



**STEP 19**

Remove the parking light bulb from the parking light socket



**STEP 20**

Insert the parking light connector from the new headlight housing to the parking light socket, (+) to (+) and (-) to (-)



**STEP 21**

Reinstall the parking light socket to the new headlight housing



**STEP 22**

Connect the headlight harness



**STEP 23**

Seat the new headlight assembly in place



**STEP 24**

Reinstall the 10mm headlight bolt at the top of the headlight



**STEP 25**

Reinstall the 10mm headlight bolt at the bottom of the headlight

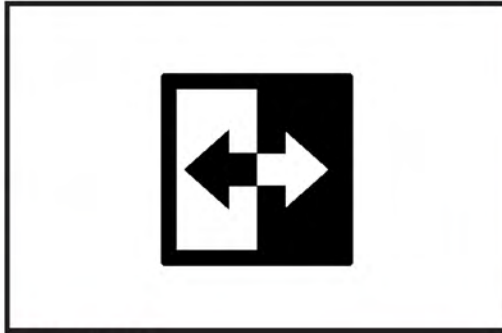

**STEP 26**

Please repeat the steps from 13 to 25 for the opposite side

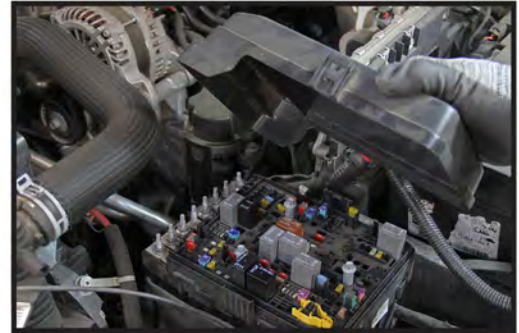

**STEP 27**

Remove the fuse box cover



**STEP 28**

Locate the #35 fuse



**STEP 29**

Remove the #35 fuse



**STEP 30A**

Install the ACC wire fuse to the #35 fuse spot



**STEP 30B**

Install the ACC wire fuse to the #35 fuse spot



**STEP 31**

Reinstall the fuse box cover



**STEP 32**

Connect the ACC wire to the LH headlight connector



**STEP 33**

Connect the ACC wire to the RH headlight connector



**STEP 34**

Start the car to make sure the LED light bar is working before reinstall the front grille



**STEP 35A**

Cable tie the loose wires



**STEP 35B**

Cable tie the loose wires



**STEP 36**

Reinstall the front grille



**STEP 37**

Reinstall the three 10mm bolts at the bottom of the front grille



**STEP 38**

Reinstall the four 10mm bolts at the top of the front grille

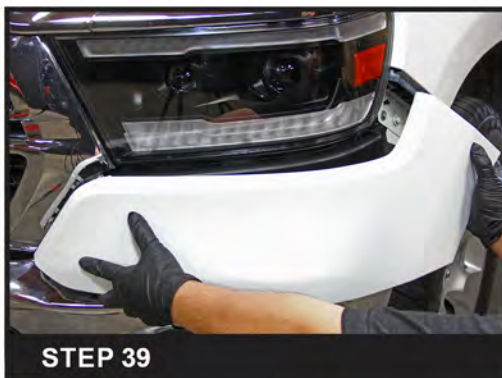

**STEP 39**

Reinstall the filler panel



**STEP 40**

Pull away the fender liner and reinstall the 10mm bolt



**STEP 41**

Reinstall the fender liner and the four 8mm bolts



**STEP 42**

Reinstall the upper grille trim



**STEP 43**

Reinstall the eight 10mm bolts at the top of the upper grille trim



**STEP 44**

Reinstall the radiator upper support cover



**STEP 45**

Reinstall the twelve plastic fasteners on the radiator upper support cover



**STEP 46**

Close the hood to complete the installation



# INSTALLATION & CARE

## 2019-UP DODGE RAM 1500 PROJECTOR SEQUENTIAL HEADLIGHT WITH SWITCHBACK/BREATHING LIGHT EFFECT

### BEFORE INSTALLATION:

- If you experience any difficulties that the instructions did not cover, please seek assistance at a local automotive shop.
- Please wear proper protective equipment before you work on any vehicle.
- An assistant is recommended when removing the front bumper from your vehicle.
- Please be cautious when working with the bumper or any parts belonging to the vehicle's body to prevent scratching.
- Do not make direct contact with the halogen bulbs or the wire assembly until the unit has cooled down after use.

## 2019-UP DODGE RAM 1500 PROJECTOR SEQUENTIAL HEADLIGHT WITH SWITCHBACK/BREATHING LIGHT EFFECT



 **BEAM ADJUSTER**