

Installation & CARE

2009-2019 DODGE RAM LIGHT BAR STYLE PROJECTOR HEADLIGHTS INSTALLATION INSTRUCTIONS

BEFORE INSTALLATION:

- If you experience any difficulties that the instructions did not cover, please seek assistance at a local automotive shop.
- Please wear proper protective equipment before you work on any vehicle.
- An assistant is recommended when removing the front bumper from your vehicle.
- Please be cautious when working with the bumper or any parts belonging to the vehicle's body to prevent scratching.
- Do not make direct contact with the halogen bulbs or the wire assembly until the unit has cooled down after use.

TOOLS AND SUPPLIES REQUIRED

1/4" Ratchet	8 mm Socket	10 mm Socket	Plastic Pry bar
			
Trim Pad Remover			
			

PRODUCT NUMBER

2LHP-RAM09-G2-TM
 2LHP-RAM09G-G2-TM
 2LHP-RAM09JM-G2-TM
 2LHP-RAM09BK-G2-TM



LET'S START THE INSTALLATION



STEP 1

Remove the six plastic clips

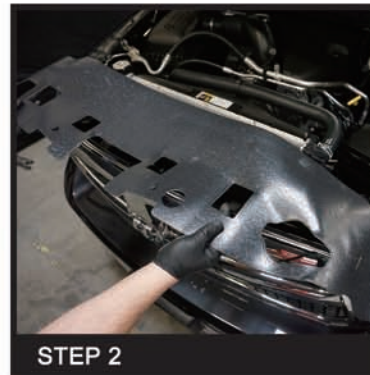

STEP 2

Remove the radiator cover



STEP 3

Remove the four 10mm bolts



STEP 4

Pull from the bottom of the grill to remove the front grill

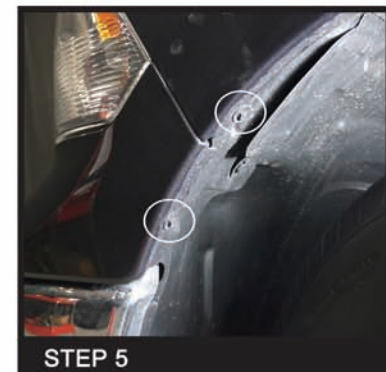

STEP 5

Remove the two 8mm bolts at the side of the front bumper



STEP 6

Pull out the wheel liner to access the headlight retainer, push up the retainer to unlock the headlight housing



STEP 7

Remove the two 10mm headlight mounting bolts



STEP 8

Unseat the factory headlight housing



STEP 9

Disconnect the headlight harness and remove the factory headlight housing



STEP 10

Remove the signal light socket from the factory headlight



STEP 11

Reinstall the signal light socket to the new headlight housing



STEP 12

Install the wire connector to connect the LED light bar wires to the car's parking light



STEP 13

White to the white/brown for positive and black to black for negative light

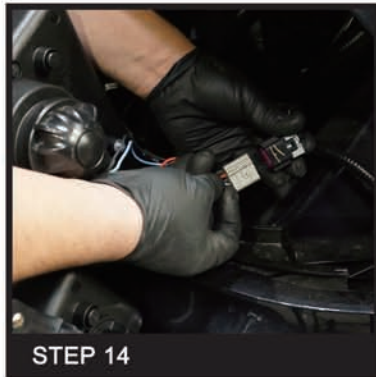

STEP 14

Connect the headlight harness and seat the new headlight assembly in place



STEP 15

Pull down the retainer to lock the headlight housing



STEP 16

Reinstall the two 10mm headlight mounting bolts

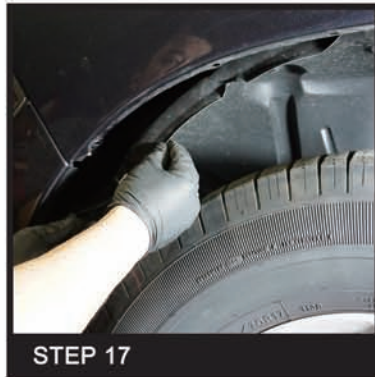

STEP 17

Reinstall the wheel liner



STEP 18

Reinstall the two 8mm bolts at the side of the front bumper



STEP 19

Please repeat the steps from 5 to 18 for the opposite side



STEP 20

Reinstall the front grill



STEP 21

Reinstall the four 10mm bolts

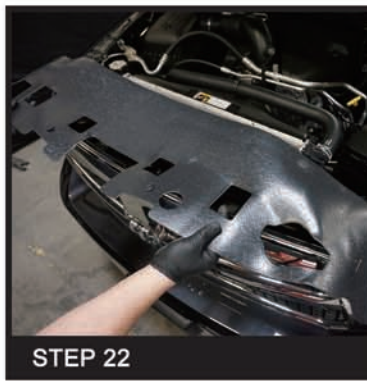

STEP 22

Reinstall the radiator cover



STEP 23

Reinstall the six plastic clips

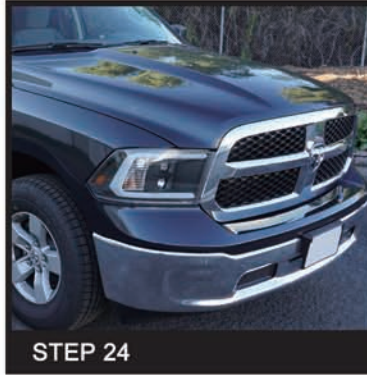

STEP 24

Close the hood to complete installation

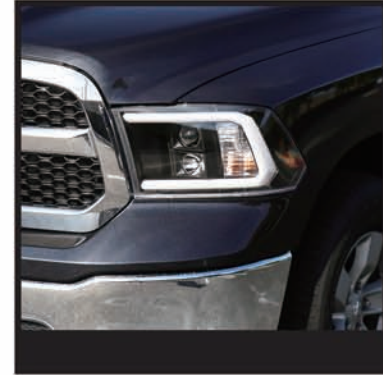

Installation & CARE

2009-2019 DODGE RAM LIGHT BAR STYLE PROJECTOR HEADLIGHTS INSTALLATION INSTRUCTIONS

BEFORE INSTALLATION:

- If you experience any difficulties that the instructions did not cover, please seek assistance at a local automotive shop.
- Please wear proper protective equipment before you work on any vehicle.
- An assistant is recommended when removing the front bumper from your vehicle.
- Please be cautious when working with the bumper or any parts belonging to the vehicle's body to prevent scratching.
- Do not make direct contact with the halogen bulbs or the wire assembly until the unit has cooled down after use.

2009-2019 DODGE RAM LIGHT BAR STYLE PROJECTOR HEADLIGHTS INSTALLATION INSTRUCTIONS

→ **High/Low Beam
Adjustment screws**

HORIZONTAL BEAM ADJUSTER



VERTICAL BEAM ADJUSTER