

Installation & CARE

2001-2005 LEXUS IS300 PROJECTOR HEADLIGHTS INSTALLATION

BEFORE INSTALLATION

- If you experience any difficulties that the instruction did not cover, please seek assistance at local automotive shop.
- Please wear protection before you work on any vehicle.
- An assistant is useful when removing the front bumper from your vehicle.
- Please be cautious when working with the bumper or any parts belonging to the vehicles's body to prevent scratching.
- Do not make direct contact with the halogen bulbs or the wire assembly until the unit has cooled down after use.

TOOLS AND SUPPLIES REQUIRED

1/4" Ratchet	6" Extension	10 mm socket	Phillips Screwdriver
			
Trim Pad Remover	Flat Tipped Screwdriver		
			

PRODUCT NUMBER

2LHP-IS30001JM-TM
2LHP-IS30001G-TM
2LHP-IS30001-TM



LET'S START THE INSTALLATIONS

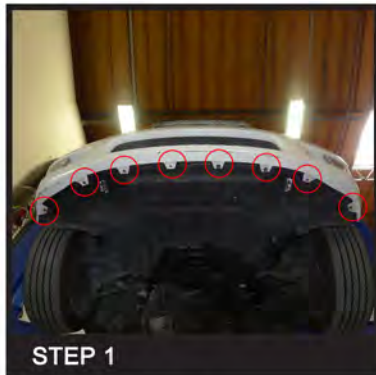

STEP 1

(8) 10mm bolts location



STEP 2

Remove (8) 10mm bolts

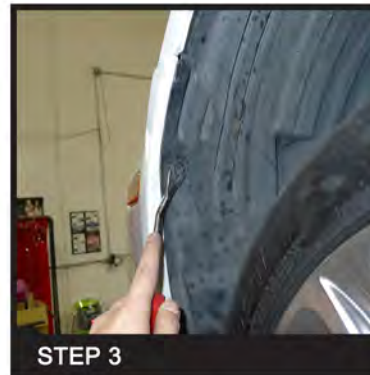

STEP 3

Remove the plastic clip

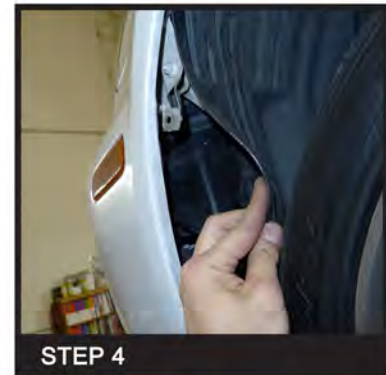

STEP 4

Pull back the fender liner



STEP 5

(2) 10mm bolts location



STEP 6

Remove (2) 10mm bolts

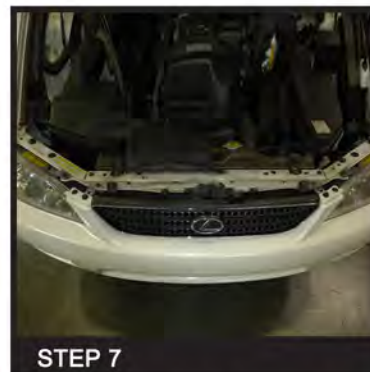

STEP 7

Phillips head screw and (4) plastic clips location



STEP 8

Remove the phillips head screw

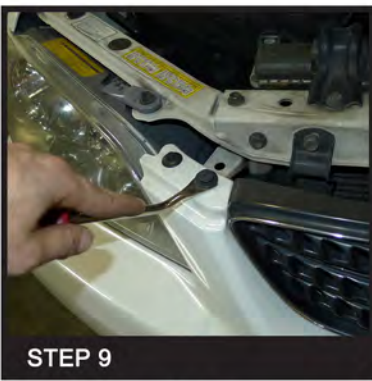

STEP 9

Remove (4) plastic clips

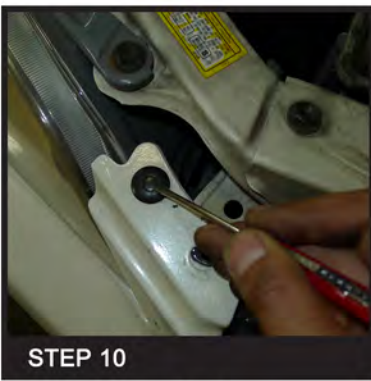

STEP 10

Remove (4) plastic clips



STEP 11

Remove (4) plastic clips

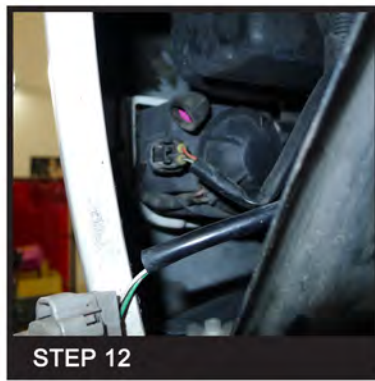

STEP 12

Fog light harness

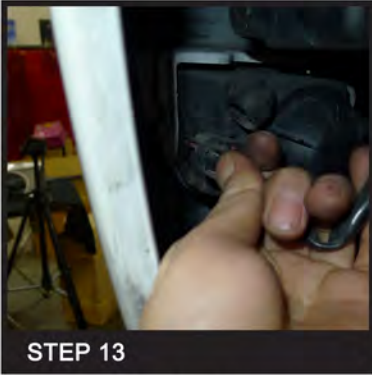

STEP 13

Disconnect the fog light harness



STEP 14

Remove the bumper light socket



STEP 15

Remove the front bumper

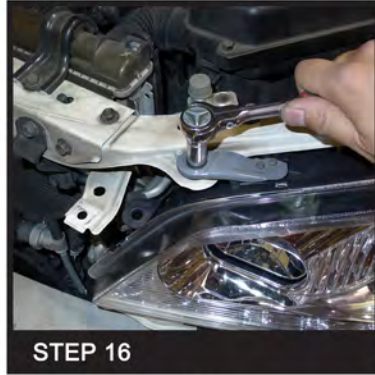

STEP 16

Remove the 10mm bolt

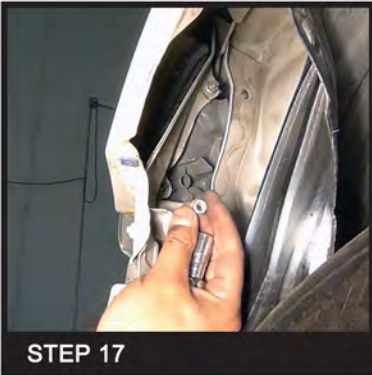

STEP 17

Remove (2) 10mm nuts



STEP 18

Remove the headlight

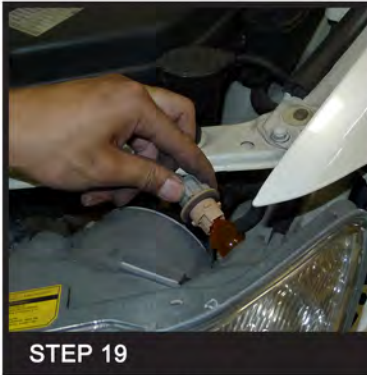

STEP 19

Remove all the light socket

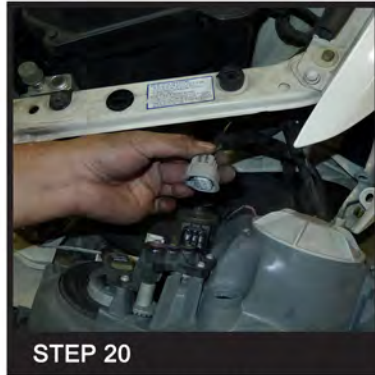

STEP 20

Disconnect the headlight harness



STEP 21

Back of the factory headlight



STEP 22

Remove the connector from the headlight housing



STEP 23

Ballast cover

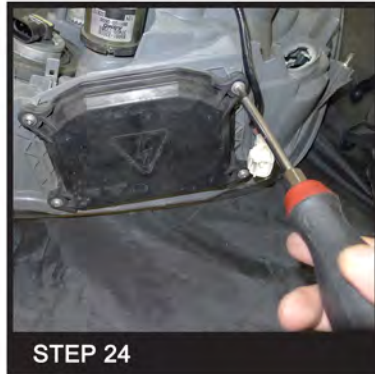

STEP 24

Remove (4) phillips head screws

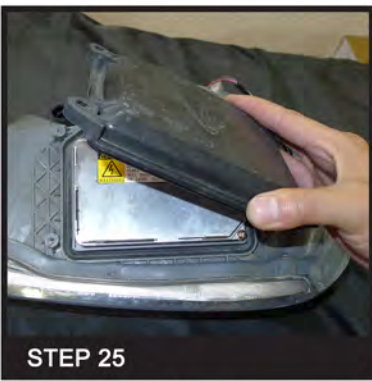

STEP 25

Remove the ballast cover



STEP 26

Remove the gasket



STEP 27

Remove (3) Phillips head screws

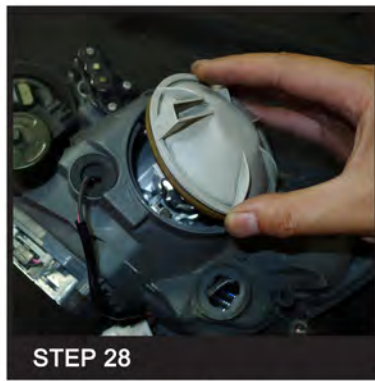

STEP 28

Remove the access hole cover

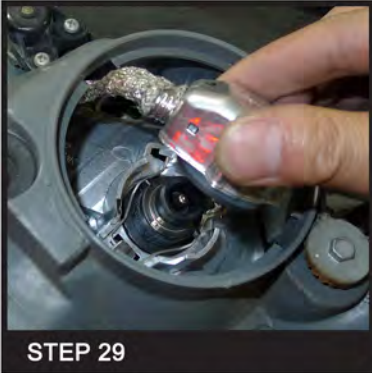

STEP 29

Disconnect the HID bulb socket

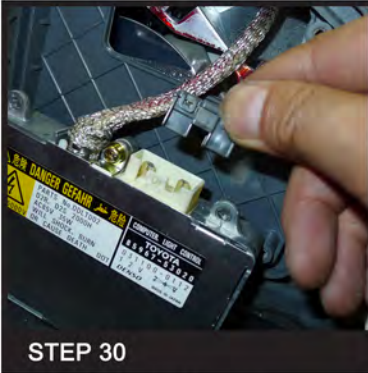

STEP 30

Disconnect the HID harness

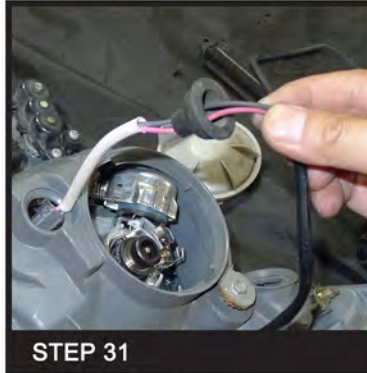

STEP 31

Remove the HID harness

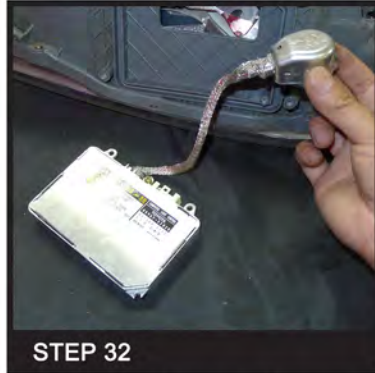

STEP 32

Remove the HID socket and ballast assembly



STEP 33

Remove the HID bulb

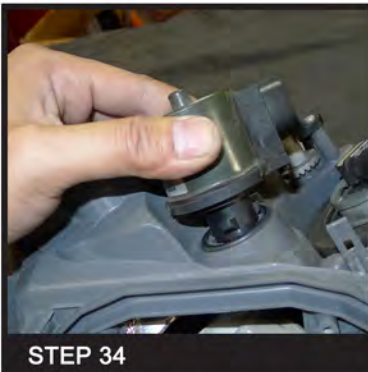

STEP 34

Remove the auto leveling motor

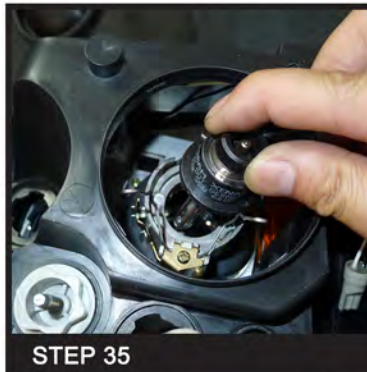

STEP 35

Install the HID bulb in new headlight



STEP 36

Install the HID harness into the new headlight



STEP 37

Remove the manual level adjuster from the new headlight

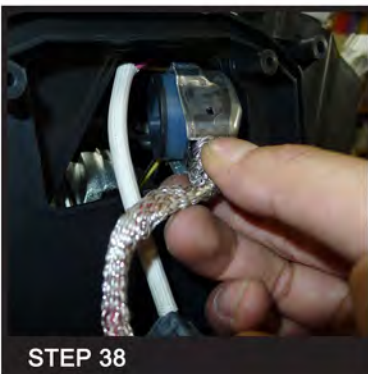

STEP 38

Run the HID bulb socket into the new headlight

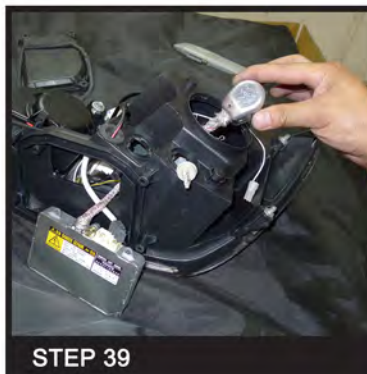

STEP 39

Run the HID bulb socket through the new headlight

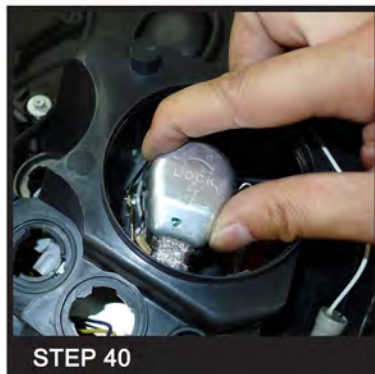

STEP 40

Connect the HID socket to HID bulb



STEP 41

Connect the HID harness to the ballast

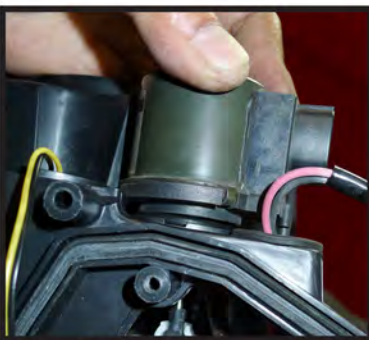

STEP 42

Install the auto leveling motor into the new headlight



STEP 43

Lock the auto leveling motor into the position



STEP 44

Secure the ballast with (3) Phillips head screws



STEP 45

Install the gasket



STEP 46

Secure the ballast cover with (4) Phillips head screws

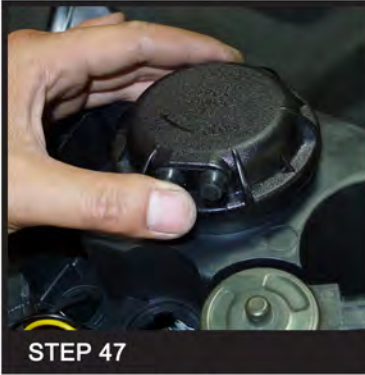

STEP 47

Install the access hole cover

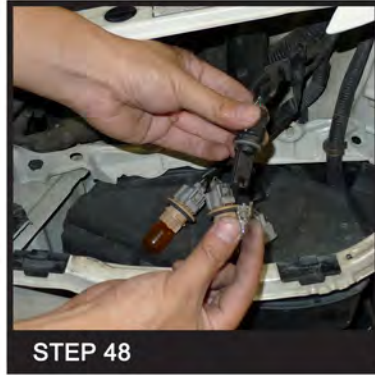

STEP 48

Remove the light bulb

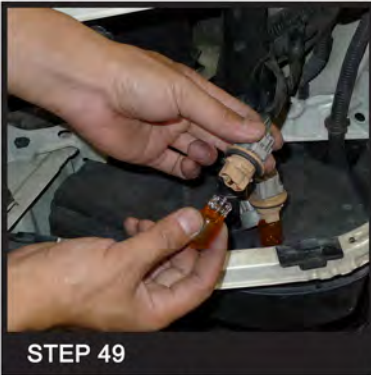

STEP 49

Remove all the light bulbs



STEP 50

Connect the headlight harness to the new headlight. Please see the "L.E.D. tail lights installation instruction" If your tail lights don't have L.E.D. You can skip the installation instruction.



STEP 51

Place the new headlight in the stock location

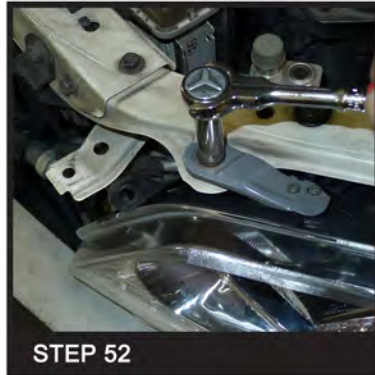

STEP 52

Tighten the 10mm bolt

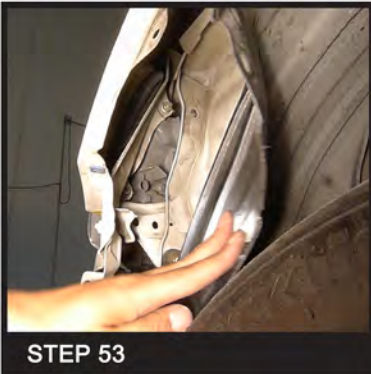

STEP 53

Tighten (2) 10mm nuts

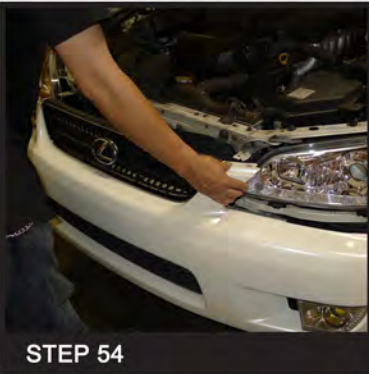

STEP 54

Replace the front bumper



STEP 55

Replace (4) plastic clips

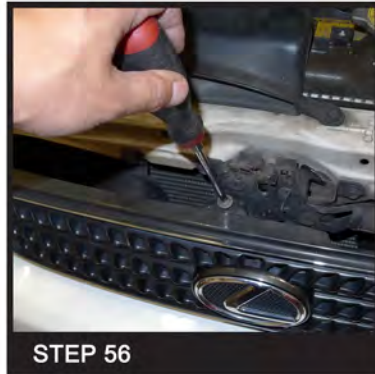

STEP 56

Tighten the Phillips head screw



STEP 57

Tighten (2) 10mm

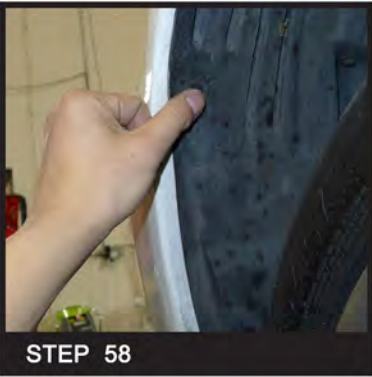

STEP 58

Replace the plastic clip

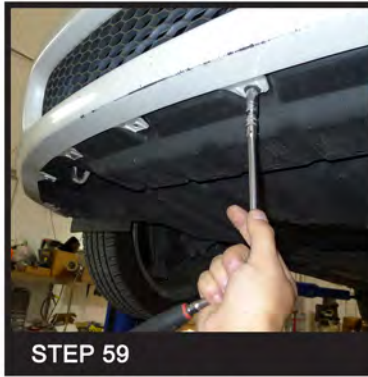

STEP 59

Tighten (8) 10mm bolts



STEP 60

Please repeat the steps from 1 to 59 for the opposite side



STEP 61

The installation is now complete