

# Installation & CARE

## 2007-2013 TOYOTA TUNDRA EURO HEADLIGHTS INSTALLATION

### BEFORE INSTALLATION

- If you experience any difficulties that the instruction did not cover, please seek assistance at local automotive shop.
- Please wear protection before you work on any vehicle.
- An assistant is useful when removing the front bumper from your vehicle.
- Please be cautious when working with the bumper or any parts belonging to the vehicles's body to prevent scratching.
- Do not make direct contact with the halogen bulbs or the wire assembly until the unit has cooled down after use.

### TOOLS AND SUPPLIES REQUIRED

1/4" Ratchet	6" Extension	10 mm socket	Handy Remover
			
			Flat Tipped Screwdriver
			

### PRODUCT NUMBER

2LH-TUN07JM-RS  
2LH-TUN07G-RS  
2LH-TUN07-RS



### LET'S START THE INSTALLATIONS

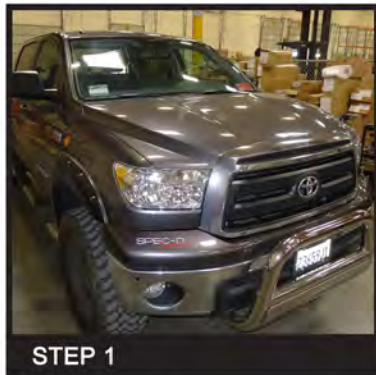

STEP 1

Before installation



STEP 2

(2) plastic clips location



STEP 3

Remove the (2) plastic clips

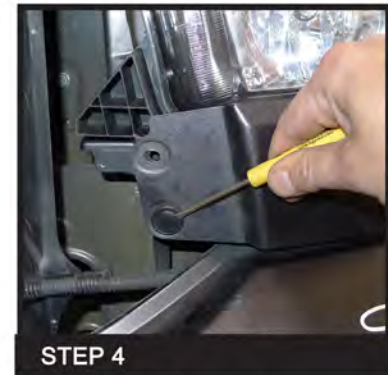

STEP 4

Remove the (2) plastic clips

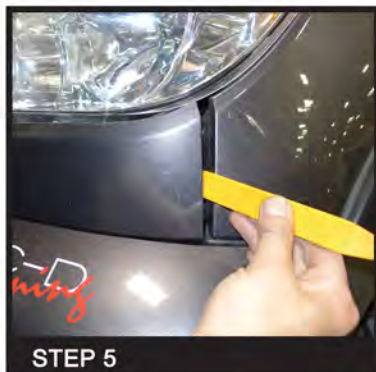

STEP 5

Remove the headlight trim

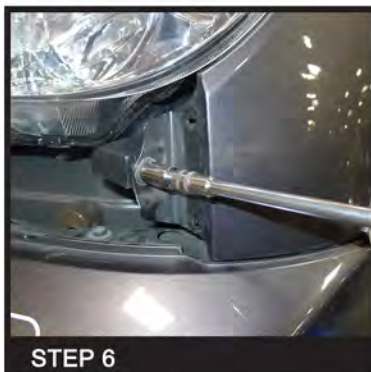

STEP 6

Remove the 10mm bolt

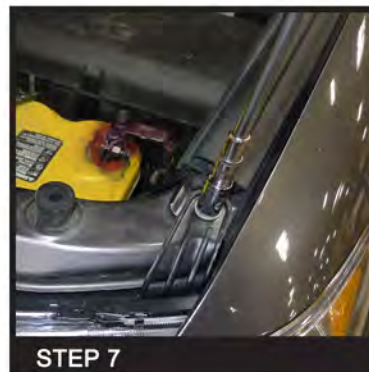

STEP 7

(2) 10mm bolts location

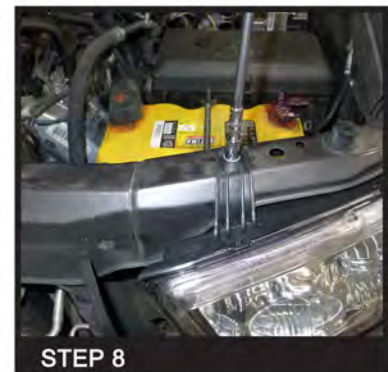

STEP 8

Remove the (2) 10mm bolts





STEP 9

Remove the (2) 10mm bolts



STEP 10

Remove the factory headlight



STEP 11

Remove the light socket



STEP 12

Disconnect the headlight harness



STEP 13

Disconnect the headlight harness

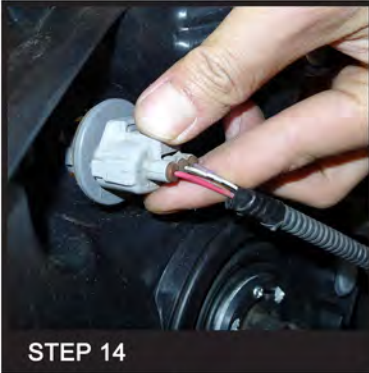

STEP 14

Remove the light socket

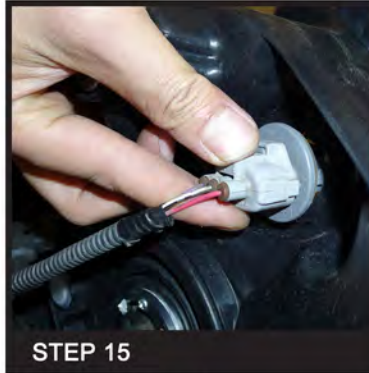

STEP 15

Install the light socket

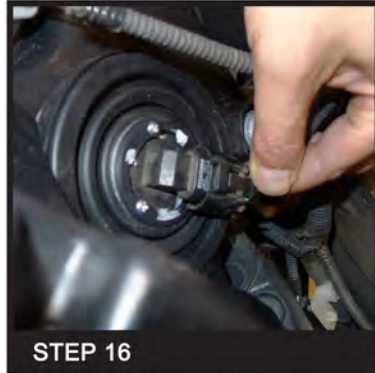

STEP 16

Connect the headlight harness. Please see the "Halo & LED headlights installation instructions" If your headlights don't have Halo and led, you can skip the instruction

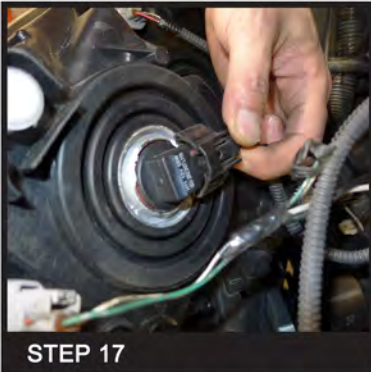

STEP 17

Connect the headlight harness



STEP 18

Install the light socket

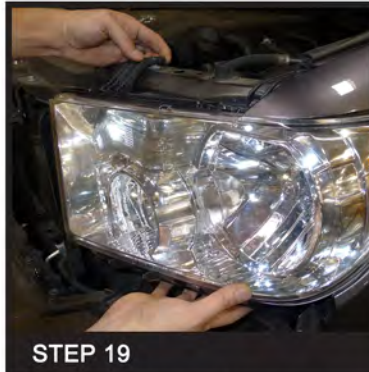

STEP 19

Place the new headlight in the stock location

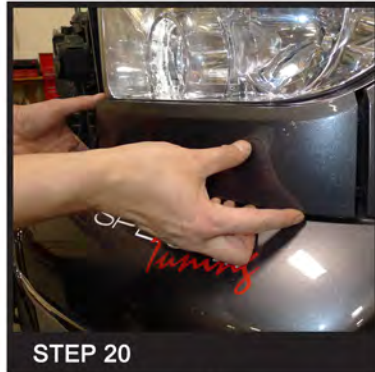

STEP 20

Replace the headlight trim



STEP 21

Replace the (2) plastic clips



STEP 22

Replace the (2) plastic clips



STEP 23

Please repeat the steps from 1 to 22 for the opposite side

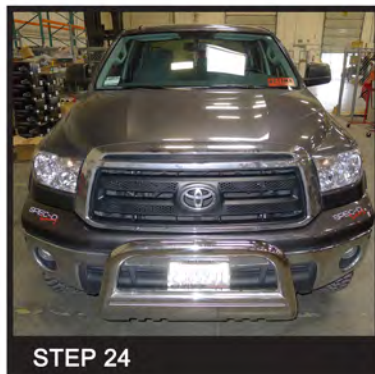

STEP 24

The installation now is complete