

Installation & CARE

2005-2010 PONTIAC G6 EURO HEADLIGHTS INSTALLATION

BEFORE INSTALLATION

- If you experience any difficulties that the instruction did not cover, please seek assistance at local automotive shop.
- Please wear protection before you work on any vehicle.
- An assistant is useful when removing the front bumper from your vehicle.
- Please be cautious when working with the bumper or any parts belonging to the vehicles's body to prevent scratching.
- Do not make direct contact with the halogen bulbs or the wire assembly until the unit has cooled down after use.

TOOLS AND SUPPLIES REQUIRED

¼" Ratchet	Plastic Pry bar	8 mm socket	
			

PRODUCT NUMBER

2LH-G605-ABM
2LH-G605JM-ABM
2LH-G605G-ABM



LET'S START THE INSTALLATIONS



STEP 1

Raise the hood



STEP 2

Remove (6) front bumper fasteners



STEP 3

Remove (2) 8mm bolts

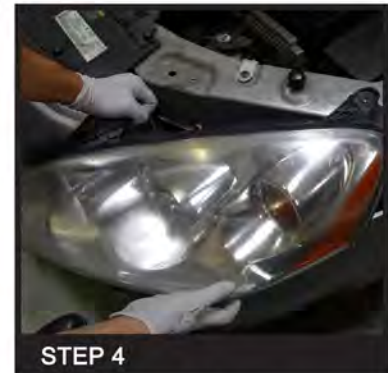

STEP 4

Remove the headlight housing

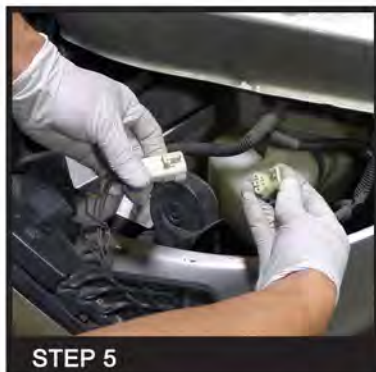

STEP 5

Disconnect headlight connector from chassis connector

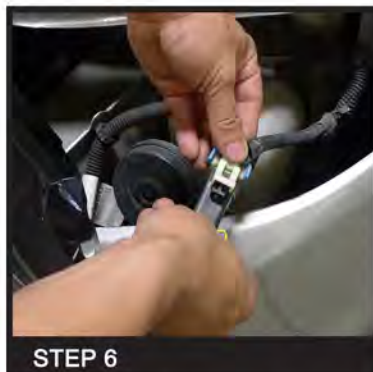

STEP 6

Replace all bulbs - Connect headlight connector to chassis connector



STEP 7

Install headlight housing

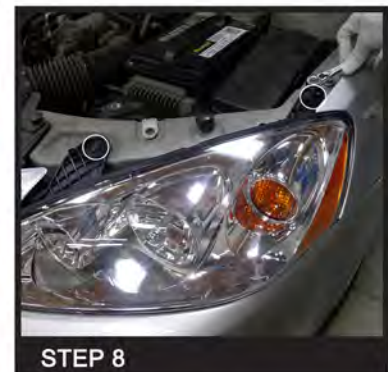

STEP 8

Secure (2) 8mm bolts

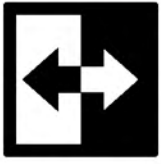

STEP 9

Please repeat the steps from 3 to 8 for the opposite side



STEP 10

Secure (6) front bumper fasteners



STEP 11

The installation is now complete

BACK VIEW

High/Low Beam Adjustment Screws

