

INSTALLATION & CARE

2011-2016 FORD F250/F350 HEADLIGHT INSTALLATION INSTRUCTION

BEFORE INSTALLATION:

- If you experience any difficulties that the instructions did not cover, please seek assistance at a local automotive shop.
- Please wear proper protective equipment before you work on any vehicle.
- An assistant is recommended when removing the front bumper from your vehicle.
- Please be cautious when working with the bumper or any parts belonging to the vehicle's body to prevent scratching.
- Do not make direct contact with the halogen bulbs or the wire assembly until the unit has cooled down after use.

TOOLS AND SUPPLIES REQUIRED

1/4" Ratchet	10 mm Deep Socket	6" Socket Extension	Flathead Screwdriver
			
Trim Pad Remover	Plastic Pry Bar		
			

PRODUCT NUMBER

2LH-F25011-G3-RS
2LH-F25011G-G3-RS
2LH-F25011JM-G3-RS
2LH-F25011SM-G3-RS

LET'S START THE INSTALLATION



Raise the hood



Remove the two fasteners and the four 10mm bolts on the top of the front grille



Press down the five clips on the bottom of the front grille



Press down the five clips on the bottom of the front grille



Remove the front grille



Remove the 10mm headlight bolt at the bottom of the headlight



STEP 6

Remove the two 10mm headlight bolts at the side of the headlight



STEP 7

Remove the 10mm headlight bolt at the top of the headlight



STEP 8

Unseat the factory headlight housing



STEP 9

Disconnect the headlight harness and remove the factory headlight housing



STEP 10

Remove the parking light socket and the signal light socket from the harness



STEP 11

Remove the parking light bulb from the parking light socket



STEP 12

Insert the parking light connector from the new headlight housing to the parking light socket, (+) to (+) and (-) to (-)



STEP 13

Install the parking light socket to the new headlight housing



STEP 14

Install the signal light socket with the signal light bulbs to the new headlight housing



STEP 15

Remove the H13 headlight from the factory headlight housing and install to the new headlight housing



STEP 16

Connect the headlight harness



STEP 17

Seat the new headlight assembly in place



STEP 18

Reinstall the 10mm headlight bolt at the top of the headlight



STEP 19

Reinstall the 10mm headlight bolt at the bottom of the headlight



STEP 20

Reinstall the two 10mm headlight bolts at the side of the headlight

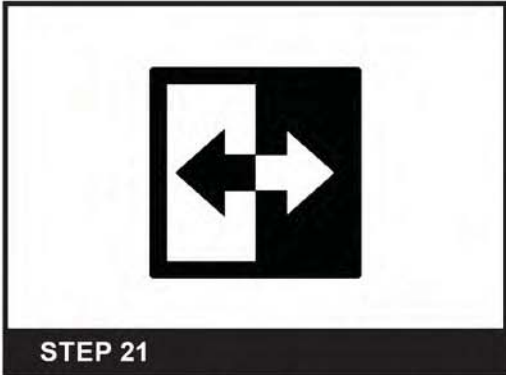

STEP 21

Please repeat the steps from 5 to 20 for the opposite side



STEP 22

Reinstall the front grille



STEP 23

Reinstall the two fasteners and the four 10mm bolts on top of the front grille



STEP 24

Close the hood to complete the installation

